



FR3

Crossover Motorhome

Specifications

GVWR (Gross Vehicle Weight Rating) is the maximum permissible weight of the unit when fully loaded. It includes all weights, inclusive of all fluids, occupants, cargo, optional equipment and accessories. For safety and product performance do NOT exceed the GVWR.

GCWR (Gross Combined Weight Rating) is the maximum permissible loaded weight of your motor home and any towed trailer or towed vehicle. Actual GCWR of this vehicle may be limited by the sum of the GVWR and the installed hitch receiver maximum capacity rating; see hitch rating label for detail.

GAWR (Gross Axle Weight Rating) is the maximum permissible weight, including cargo, fluids, optional equipment and accessories that can be safely supported by each axle.

UVW (Unloaded Vehicle Weight)* is the typical weight of the unit as manufactured at the factory. It includes all weight at the unit's axle(s), including full fuel, all fluids and LP Gas. The UVW does not include cargo, fresh potable water, additional optional equipment or dealer installed accessories.

*Estimated Average based on standard build optional equipment.

CCC (Cargo Carrying Capacity)** is the amount of weight available for fresh potable water, cargo, passengers, additional optional equipment and accessories. CCC is equal to GVWR minus UVW. Available CCC should accommodate fresh potable water (8.3 lbs per gallon). Before filling the fresh water tank, empty the black and gray tanks to provide for more cargo capacity.

** Estimated average based on standard build optional equipment

Each Forest River RV is weighed at the manufacturing facility prior to shipping. A label identifying the unloaded vehicle weight of the actual unit and the cargo carrying capacity is applied to every Forest River RV prior to leaving our facilities.

The load capacity of your unit is designated by weight, not by volume, so you cannot necessarily use all available space when loading your unit.

Actual towing capacity is dependent upon your particular loading and towing circumstances, which includes the GVWR, GAWR and GCWR as well as adequate trailer brakes. Please refer to the Operator's Manual of your vehicle for further towing information.

	30DS	32DS	33DS	34DS
Chassis	Ford	Ford	Ford	Ford
Engine	V-10	V-10	V-10	V-10
Horsepower	320 HP	320 HP	320 HP	320 HP
Torque	460 ft-lbs	460 ft-lbs	460 ft-lbs	460 ft-lbs
Wheelbase	190"	228"	228"	228"
Fuel Capacity	80 gal	80 gal	80 gal	80 gal
Tire Size	245/ 70R19.5	245/ 70R19.5	245/ 70R19.5	245/ 70R19.5
GVWR	18,000 lbs	20,500 lbs	20,500 lbs	20,500 lbs
GCWR	23,000 lbs	26,000 lbs	26,000 lbs	26,000 lbs
GAWR Front	7,000 lbs	7,500 lbs	7,500 lbs	7,500 lbs
GAWR Rear	12,000 lbs	13,500 lbs	13,500 lbs	13,500 lbs
Exterior Storage	121 cu ft	159 cu ft	161 cu ft	195 cu ft
Safety Belts	8	8	6	6
LP Tank	24.5 gal	24.5 gal	24.5 gal	24.5 gal
Water Heater	6 gal	6 gal	6 gal	6 gal
Furnace	35,000 BTU	35,000 BTU	35,000 BTU	35,000 BTU
Fresh Water	52 gal	52 gal	52 gal	52 gal
Grey Tank	42 gal	42 gal	42 gal	52 gal
Black Tank	42 gal	42 gal	42 gal	52 gal
Length	31' 8"	33' 11"	34' 10"	35' 11"
Exterior Width	99.5"	99.5"	99.5"	99.5"
Exterior Height w/ A/C	12' 3"	12' 5"	12' 5"	12' 5"
Interior Width	95.5"	95.5"	95.5"	95.5"
Interior Height	82"	82"	82"	82"
Awning Length	16'	12'	19'	17'

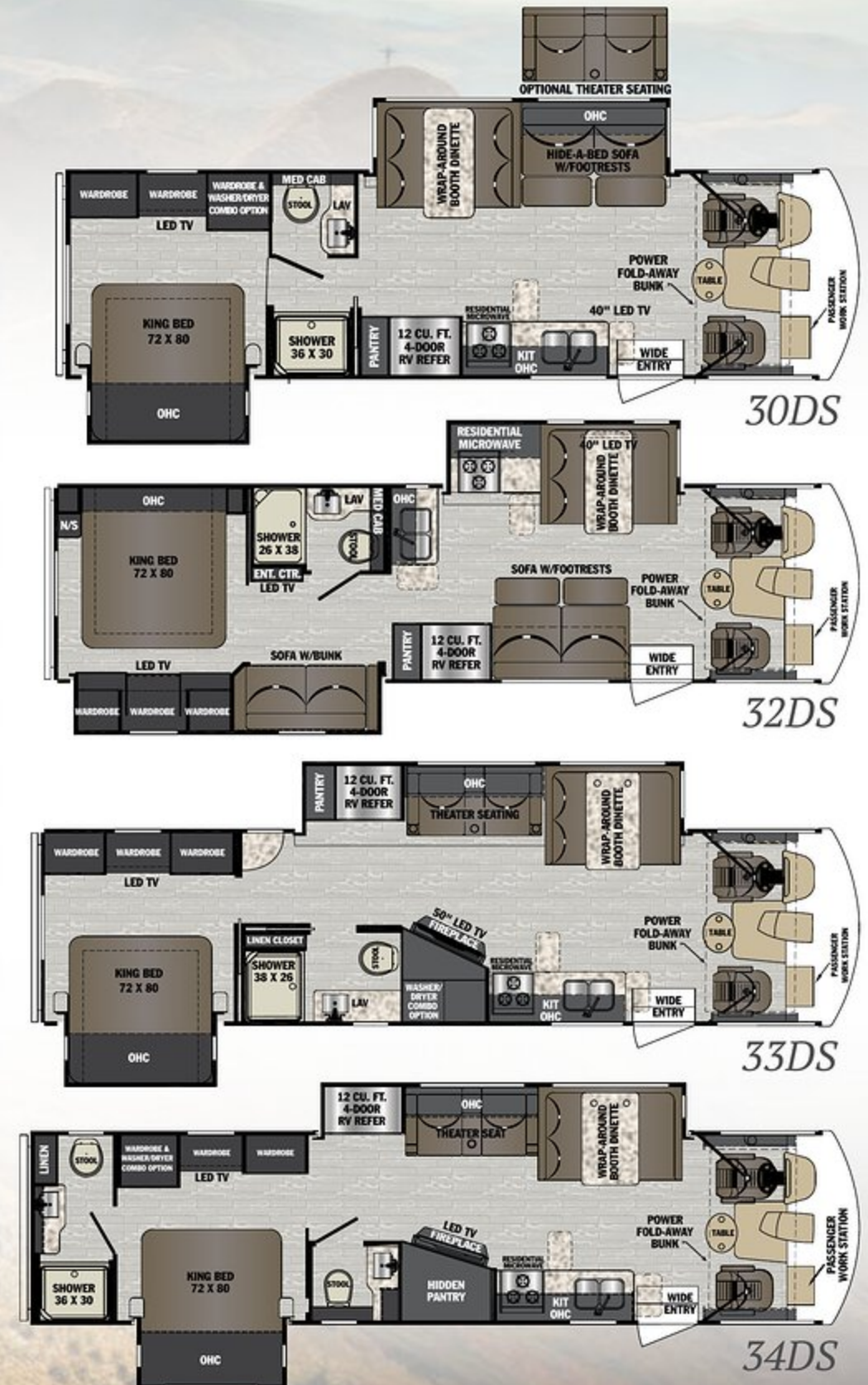

TOP FEATURES

- Exclusive Hide-Away Power Front Overhead Bunk
- Fiberglass Roof
- 12 Cu Ft Norcold RV Refrigerator (Gas/Electric) with Pantry
- MorRyde® Upfitted Flush Floor Construction
- 50 Amp Service (Onan 5.5KW Generator)
- Dual Air Command Ducted Roof A/C's (Front 18K equivalent with Heat Pump/Rear 16K equivalent)
- Arctic Package (Enclosed Holding Tanks, 12V Heat Pads, Forced Air Heat and Insulation Package)
- 72"x 80" King Size Walk Around Residential King Beds
- Pass Through Super Storage (All Models)
- 30" Wide Entry Door
- Power Front Sun/Privacy Shade with Manual Shades
- Exterior Entertainment Center
- Exterior LP Quick Connect Compartment
- Washer/Dryer Prep (N/A 32DS)
- Steel Constructed Cockpit Framing
- Automotive Bonded Windshield with Integrated Backlit Logo
- Large Kitchen Storage Drawers with Countertop Extensions
- Wrap Around (Comfort Lounge) Booth Dinette and Sofa with Footrests
- Raised Panel Hardwood Cabinet Doors and Drawer Fronts
- Deep Slide-Outs
- Undermounted Double Bowl Stainless Steel Kitchen Sink (Pull Out Faucet)
- Residential Microwave
- Recessed 3-Burner Cooktop with Glass Top Cover and 22" Oven
- Landis Ash Cabinetry
- Solar Prep

OPTIONS

Decor

Oakley Seal
Pebble

Options

Theatre Seating
(Standard on 33DS and 34DS)
Washer/Dryer Combo (N/A 32DS)



30DS shown with Oakley Seal interior



30DS shown with Oakley Seal interior

for more photos and the latest model standards and options, visit
forestriverinc.com/fr3



33DS shown with Pebble interior



www.ForestRiverBuyLocal.com

FREE MEMBERSHIP
to Forest River Owners' Group

www.forestriverfrog.com



F53 Class A motorhome chassis

FR3

Forest River, Inc.
FR3 Division
902 County Road 1
Elkhart, IN 46515
(574) 367.3285

YOUR FR3 DEALER

**24/7 EMERGENCY
ROADSIDE ASSISTANCE
WITH VEHICLE PURCHASE***

TOWING
JUMP STARTS
TIRE CHANGES
FLUID DELIVERY
LOCKOUT
SERVICE

WINCH-OUT
MOBILE MECHANIC
TECHNICAL
SUPPORT
DEALER LOCATOR
SERVICES



*VALID FOR 1 YEAR FROM DATE OF PURCHASE



All information contained in this brochure is believed to be accurate at the time of publication. However, during the model year, it may be necessary to make revisions and Forest River, Inc. reserves the right to make all such changes without notice, including prices, colors, materials, equipment and specifications as well as the addition of new models and the discontinuance of models shown in this brochure. Therefore, please consult with your Forest River, Inc., dealer and confirm the existence of any materials, design or specifications that are material to your purchase decision. 02/20

©2020 FR3

a Division of Forest River, Inc., a Berkshire Hathaway company. All Rights Reserved.



Learn More

Scan this barcode using a QR Reader on your smart phone to learn more about Forest River.



A Berkshire Hathaway company.