

20 **XLR** 20
TOY HAULERS

ACTION CAMPING™

NITRO & HYPERLITE

REDEFINING VALUE-PACKED





WELCOME TO ACTION CAMPING™



From Side-by-Sides to golf carts, mobile offices to kids' rooms, kayaks to four legged friends, we are focused on the toy hauler breed of RVers. Action Camping™ is what you do, and Action Campers is who you are. Every XLR we build is focused on making your dreams and adventures come true. At XLR, we choose the path less traveled because it's right alongside you—our customers.



CHOOSE FROM TWO DISTINCT BRANDS DESIGNED WITH YOU IN MIND



NITRO

Nitro has redefined what a mid-priced Fifth Wheel Toy Hauler should look and feel. Our 2020 exteriors feature a front windshield giving you free views of every sunrise & sunset. Inside, we've designed our new interiors to warmly greet and comfort you the instant you walk in.

HYPERLITE

Hyperlite single-handedly created the lightweight laminated travel trailer market back in 2010. Our legacy continues with a simplified 96" wide feature packed model offering. The "bigger brother" 102" wide-body Hyperlite HD models offer premium features and slides on all four models.



TOP FEATURES



Quad Entry Steps on BOTH Entry Doors



Full Window Treatments Throughout Roller & Night Shades



"Quick Clean" Central Vac with Dual Sweep Pans



4G LTE and Wifi Prep

TOP FEATURES



Standard Ramp Patio Cable Kit



Generator Prep with Large 20-Gallon Fuel Station



Dexter Axles with Nev-R-Adjust® Brakes



Improved Loading/Unloading Angle

NITRO

AFFORDABLE LUXURY

With an all new modern rustic interior design, Nitro provides key features like ZERO carpet and barn-style wood passage doors. A unique front windshield brings the outdoors into your bedroom and eliminates "cave sleeping." The interior decor complements Mother Nature with an industry first slate back-splash and more earth tone colors/accents throughout.





Model 321 show in Aspen decor.



321 shown with standard 50" TV, custom audio system, 5K BTU fireplace, black privacy roller shades, and LED lit pantry storage.



Spacious First-Class recliner seating with easy clean soft touch vinyl.



Industry first! DUAL VacPort sweep pans on main level & master bedroom feature LED lighting and a lifetime warranty.



Premium 48" shower with seat and shelves.



Every Nitro master suite offers a spacious wardrobe closet with drawers, dual nightstands with chargers, and a "star-gazer" automotive windshield w/ roller shade.

NITRO

ACTION FLOORPLANS

Our Nitro series has you covered with 11'-17'6" of available storage space. This comprehensive lineup offers something for everyone with 2, 3, or 4 slides! Nitro doesn't limit any of your Action Camping needs.



LUXURY INTERIOR

All of the luxuries and conveniences of home.



LARGE STORAGE

You'll find spacious pass-through storage in the riser area of all Fifth Wheels. They're lighted, lockable and finished interior spaces.





The all-new 405 model has already received numerous awards from within the RV Industry!



HYPERLITE

LIGHTWEIGHT

The Hyperlite's rustic yet modern decor makes you feel at home even while you're out exploring. Custom styling and quality features are all packed into this lightweight design. Today's tow vehicles can handle more and Hyperlite certainly gives you more.



Every Hyperlite HD model offers a minimum of 74" storage width



a standard 39" TV, solid surface countertops, and maintains
for the larger toys even with the slide room in (2815 shown).



Our 2217 gives you one of the largest garage lengths in the industry and is just
over 26' total length! A large 39" TV, spacious overhead storage, and 25% more
countertop space make this a great model.



Spacious First-Class recliner seating with
easy clean soft touch vinyl.



Each Hyperlite HD model offers an
INDUSTRY FIRST central vacuum in
a travel trailer! (2815 shown).



Each Hyperlite bathroom is
designed to maximize functionality
and convenience (2815 shown).



Every Hyperlite HD model showcases our front windshield maximizing
your view of nature.

HYPERLITE

STANDARD MODELS

Engineered and built for "lighter weight" was our goal. So non-slides are 96" wide for half-ton pickups. Not everyone has a big truck or needs to haul a four-seat Side-by-Side, but with 14' to 17' garages mean you can get a lot of toys to your destination. Canoes, two ATVs or just use it as a Bunkhouse.



QUEEN BED DINETTE

Our HappiJac® electric bed is a multi-function system that allows you to create four different configurations. Transform into two queen beds or one queen bed and dinette. Or just the dinette with queen bed tucked up to the ceiling. When you're ready to go, electrically stow up and out of the way before you load your toys.

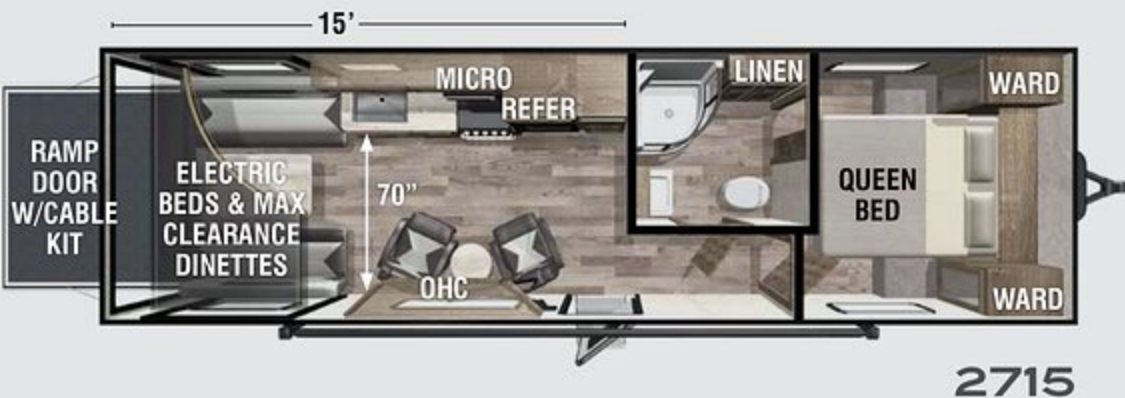
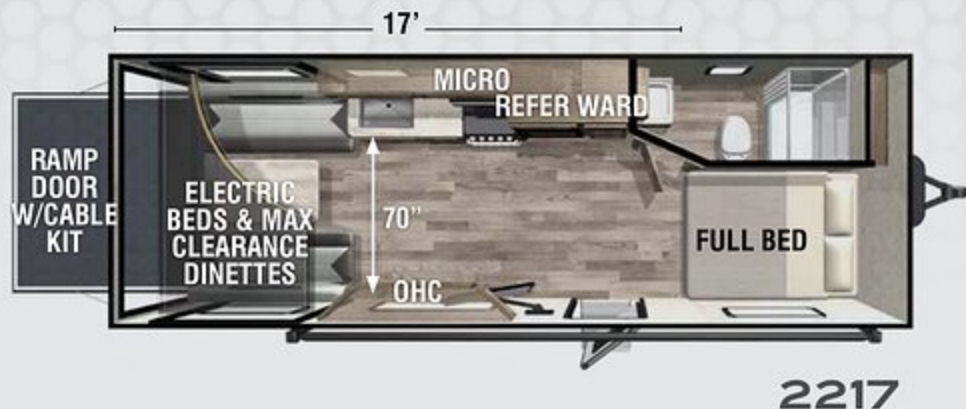

3310 MODEL

An industry first in the Toy Hauler segment - a front kitchen with three slides! This has all the amenities of a Fifth Wheel packed into a Travel Trailer design so there's no need to sacrifice your comfort.



NEV-R-ADJUST BRAKES

Dexter® Nev-R-Adjust™ brakes automatically adjust to proper clearances during travel allowing you to stop with confidence.





HYPERLITE

HD MODELS

Big on styling and smart design, but still light on weight sums up these Hyperlite HD models. Standard slide rooms, large garages, and more value added on each floorplan.



74 INCH WIDTH

WIDER INTERIOR

Each HD model maintains a minimum 74" interior width even with the slides retracted in.

The all-new 3310 model has already received Best Of Show from within the RV Industry!



STANDARDS & OPTIONS

EXTERIOR PACKAGE

- Fiberglass Front Cap w/ Automotive Window
- Friction Hinge Entry Door(s) w/ Window, Dual Split 30# LP Tanks
- 50AMP Service w/ Transfer Switch
- Black Tank Flush
- UV Resistant Gel-Coated Fiberglass Exterior
- Radius Fully-Walkable Roof
- Singular Roof Membrane w/ 12 Year Warranty
- Insulated Storage Compartment Doors
- Vacuum-Bonded Aluminum-Framed Sidewalls
- Laminated & Insulated Slide Room Walls
- Fully Enclosed "Body-Armor" Underbelly w/ Radiant Foil Layer
- Electric Awning w/ LED Lights
- Full-LED Rear Taillights
- Undercarriage Lighting
- Alumi-Tread Quad Entry Steps
- 12V Heated Holding Tanks

CHASSIS & SUSPENSION PACKAGE

- MORryde CRE3000 Suspension Enhancement
- Electric Rear Stabilizer Jacks
- 16" Radial Tires w/ Nitrofill™
- Aluminum Wheels

- Dexter EZ-Lube® Axles
- Full-Sized Spare Tire
- Nev-R-Adjust® Brakes

SAFETY PACKAGE

- 12V Battery Disconnect Switch
- 80% Tint Radius Safety Glass Windows
- LP/CO Detector
- Fire Extinguisher
- No Excuses Lionshead® Tire Warranty

INTERIOR PACKAGE

- Contemporary Interior Design Package
- Theater Seating
- Residential Microwave
- 100 Gallons Fresh Water Tank
- 17" Oven w/ Cast Iron Cooktop
- Bathroom Skylight
- Lumber Core Cabinet Stiles
- Adjustable Hidden Hinge Cabinet Hardware
- Full Extension Four-Sided Craftsman Drawers
- Radiant Foil Insulation Technology (Ceiling, Floors, & Front Cap)
- Stainless Steel Single Basin Kitchen Sink
- 15,000 BTU Ducted Air Conditioning Distribution System
- Grate Style Sink Cover/Drying Rack
- Hardwood Cabinet Doors
- Gas/Electric Refrigerator

- LED Accent Lighting, Metropolitan Grey Bathroom Countertops
- Master Suite w/ King Bed
- 72" Solid Passage Doors
- Master Bedroom Accent Wall
- Black Cabinet Hardware, Mixed Finish Kitchen Faucet
- Congoleum™ Stain-Resistant Vinyl Flooring
- Window Trim Package
- Roller Shades in Bedroom & Living Areas
- "Quick Clean" Central Vac w/ Dual Sweep Pans
- Solid Surface Kitchen Countertop
- Electric Fireplace (N/A 28DK5)

GARAGE PACKAGE

- Generator Prep
- 30 Gallon Fuel Station
- Single Electric Queen Bed w/ Max Clearance Sofa/Dinette
- 5,000# Cargo Tie Downs
- Insulated Floor
- Retractable Panoramic Screen
- Insulated Ramp Door
- Black Night Shades
- Washer/Dryer Hookups
- Ramp Patio Cable Kit
- Prep for Garage Air Conditioner
- Alumi-Tread Entry Steps

TECHNOLOGY PACKAGE

- Backup Camera Prep
- Multi-Zone Soundbar w/ Built-in Subwoofer
- TV and Cable Connections in Bedroom & Garage
- Exterior Speakers
- Convenient USB Charging Stations
- Winegard Air 360 Antenna w/ WiFi & 4G LTE Prep
- 50" Living Room TV

OPTIONAL EQUIPMENT

- 5.5 Onan Generator
- Second A/C 13.5K BTU
- Second Electric Awning
- Dual Pane Windows
- Ground Control 3.0 Electric Auto Leveling System
- Solar Package
- Rear Patio Package: Railing, Elec Awning & Stairs
- 3 Season Rear Patio Door

	XLF28DK5	XLF321	XLF33DK5	XLF351	XLF35DK5	XLF405	XLF407
Hitch Weight	2,295 lb	2,585 lb	2,520 lb	2,995	2,810 lb	3,552	TBD
UVW	10,259 lb	12,234 lb	12,454 lb	12,844	13,299 lb	15,519	TBD
CCC	6,036 lb	4,351 lb	4,066 lb	4,146	3,511 lb	5,481	TBD
Exterior Length	32' 8"	36' 10"	41' 1"	39' 11"	43' 8"	44' 2"	44' 2"
Exterior Height	13' 4"	13' 4"	13' 4"	13' 4"	13' 4"	13' 4"	13' 4"
Exterior Width	102"	102"	102"	102"	102"	102"	102"
Fresh Water	102 gal	102 gal	102 gal	102 gal	102 gal	102 gal	102 gal
Gray Water	80 gal	71 gal	80 gal	71 gal	80 gal	60 gal	60 gal
Black Water	50 gal	82 gal	50 gal	82 gal	100 gal	80 gal	TBD
Awning Size	18'	18'	18'	18'	20'	20'	20'

STANDARDS & OPTIONS

EXTERIOR PACKAGE

- Friction Hinge Entry Door(s) w/ Window
- Dual 20# LP Tanks w/ Cover
- 30AMP Service w/ Transfer Switch
- Black Tank Flush
- UV Resistant Gel-Coated Fiberglass Exterior
- Radius Fully-Walkable Roof
- Singular Roof Membrane w/ 12 Year Warranty
- Insulated Storage Compartment Doors
- Vacuum-Bonded Aluminum-Framed Sidewalls
- Laminated & Insulated Slide Room Walls
- Fully Enclosed "Body-Armor" Underbelly w/ Radiant Foil Layer
- Electric Awning w/ LED Lights
- Full-LED Rear Taillights
- Alumi-Tread Main Entry Steps

CHASSIS & SUSPENSION PACKAGE

- MORryde CRE3000 Suspension Enhancement
- Aluminum Wheels
- Dexter EZLube® Axles
- Full-Sized Spare Tire
- Nev-R-Adjust® Brakes
- Radial Tires w/ Nitrofill™

SAFETY PACKAGE

- Power Tongue Jack
- 12V Battery Disconnect Switch
- 80% Tint Radius Safety Glass Windows
- LP/CO Detector
- Fire Extinguisher
- No Excuses Lionshead® Tire Warranty

INTERIOR PACKAGE

- 17" Oven w/ Cast Iron Three Burner Cooktop
- Bathroom Skylight
- Lumber Core Cabinet Stiles
- Adjustable Hidden Hinge Cabinet Hardware
- Full Extension Four-Sided Craftsman Drawers
- Radiant Foil Insulation Technology - Ceiling, Floors, Front
- Stainless Steel Single Basin Sink
- 15,000 BTU Ducted Air Conditioning Distribution System
- Grate Style Sink Cover/Drying Rack
- Hardwood Cabinet Doors
- Gas/Electric Refrigerator
- LED Accent Lighting
- Metropolitan Grey Countertops
- Master Suite w/ Queen Bed
- 72" Solid Passage Doors
- Master Bedroom Accent Wall
- Black Cabinet Hardware

- Underbed Storage Shelf
- Black Faucets
- Congoleum™ Stain-Resistant Vinyl Flooring
- Roller Shades in Bedroom & Living Room

HD PACKAGE

(N/A 2217, 2414, 2715)

- Fiberglass Front Cap w/ Automotive Window
- Residential Microwave
- Solid Surface Kitchen Countertop
- 100 Gallons Fresh Water Tank
- 16" Radial Tires
- "Quick Clean" Central Vac
- Electric Fireplace (N/A 2815)
- Rubber Garage Flooring (3212 & 3310 only)

GARAGE PACKAGE

- Generator Prep
- 20 Gallon Fuel Station
- Single Electric Queen Bed w/ Max Clearance Sofa/Dinette
- 5,000# Cargo Tie Downs
- Insulated Floor
- Black Rear Privacy Screen
- Insulated Ramp Door
- Black Night Shades
- Ramp Patio Cable Kit
- Alumi-Tread Rear Entry Steps

TECHNOLOGY PACKAGE

- Winegard Air 360 Antenna w/ WiFi & 4G LTE Prep
- Backup Camera Prep
- Dual Zone Soundbar w/ Built-in Subwoofer
- TV and Cable Connections in Bedroom & Garage
- Exterior Speakers
- Convenient USB Charging Stations
- 39" Living Room TV

OPTIONAL EQUIPMENT

- 4.0 Onan Generator
- VIP Party Deck (Railing Only)
- U-shaped Booth Dinette (3212 & 3310 only)
- Quick Cool Package
- Solar Package
- 12V Heated Holding Tanks

	STANDARD MODELS			HD MODELS			
	2217	2414	2715	2815	3016	3212	3310
Hitch Weight	955 lb	1,050 lb	940 lb	1,230 lb	1,410	1,485 lb	1,580
UVW	5,993 lb	6,398 lb	6,963 lb	7,718 lb	8,853	8,593 lb	9,998
CCC	3,762 lb	3,452 lb	2,777 lb	3,712 lb	2,757	3,092 lb	1,782
Exterior Length	26' 3"	28'	31' 2"	32' 2"	33'	36' 1"	37' 4"
Exterior Height	11' 6"	11' 6"	11' 6"	12' 1"	12' 1"	12' 1"	12' 1"
Exterior Width	96"	96"	96"	102"	102"	102"	102"
Fresh Water	50 gal	50 gal	50 gal	102 gal	102 gal	102 gal	102 gal
Gray Water	64 gal	64 gal	64 gal	64 gal	64 gal	64 gal	64 gal
Black Water	32 gal	32 gal	32 gal	32 gal	32 gal	32 gal	32 gal
Awning Size	14'	18'	18'	20'	20'	20'	20'

WHY XTRA MATTERS?

What's XTRA BUILT? If you compare us to other Travel Trailers and Fifth Wheels, you'll see that an XLR Toy Hauler simply built right. We know that Action Campers use their RV's the way they play—harder. So stronger construction and features mean you'll be ready for the road (or offroad).



At XLR, we choose not to cut corners to reduce cost. "Xtra Built" is our commitment to you to provide an Action Camping™ Toy Hauler that can stand up to anything you're going to throw at it. These items listed are included on every XLR Nitro, providing you with extra value as well.



XTRA CONSTRUCTION FEATURES

- 1 Body Armor Protective Underbelly
- 2 Ducted Loop A/C Distribution System
- 3 Laminated & Insulated Slide Room End Walls
- 4 Best in Class 5,000-lb. Tie-Down System
- 5 Dexter® Axles
- 6 Aluminum Framing Around All Sidewall Openings
- 7 Tongue & Groove Plywood Floor Decking
- 8 Gelcoat Fiberglass Exterior



Our radiant-reflective insulation layers are 97% efficient keeping you comfortable all year round.



A MORryde® CRE3000 premium suspension smooths out even the toughest of North America's roads.



Heavy-duty Dexter® axles offer you the best in class carrying capacities.



A Wide-Track frame design provides a more stable and stronger foundation over our skinnier competition.



Our Nitro-Fill™ radial tires offer a "No Excuses Guarantee" unmatched in the industry.



XLR utilizes weather resistant tongue-and-groove plywood in all main living areas.



The XLR fully enclosed "Body Armor" underbelly is insulated and uses a panel system for ease of access.



XLR has offered the strongest 5,000-lb. tie-down anchor system in the industry since day one to secure your precious cargo.



Our vacuum-bonded technology provides superior adhesion and durability.



Our 1.5" fresh water drain provides a lightning fast way to empty your tank.



Like the Nitro series models, we don't skimp at XLR. Overbuilt has been our motto for years, so Xtra Built just makes sense. Especially when you see the value peeled back.

AXLES AND TIRES

Dexter® axles and Lionshead® tires are the best in the business. With Lionshead "No Excuses Guarantee," we have your back when it comes to tires and wheels.



PRE-DELIVERY INSPECTION FACILITY

20,000 square feet of quality assurance. The bare essentials for a premium product. This state-of-the-art facility gives immediate feedback to production for quality assurance in every unit built.



24/7 EMERGENCY ROADSIDE ASSISTANCE WITH VEHICLE PURCHASE*

TOWING
JUMP-STARTS
TIRE CHANGES
FLUID DELIVERY
LOCKOUT
SERVICE

WINCH-OUT
MOBILE MECHANIC
TECHNICAL
SUPPORT
DEALER LOCATOR
SERVICES



*VALID FOR 1 YEAR FROM DATE OF PURCHASE

FREE MEMBERSHIP to Forest River Owners' Group

www.forestriverfrog.com



Learn More
Scan this barcode using
a QR Reader on your
smart phone to learn
more about Forest River.



A Berkshire Hathaway company.

FOREST RIVER OWNER DIGITAL KIT APP

Now you can have your Owner's Manual with you where ever you are. Download our FREE app from the App Store or Google Play and you'll have the information at your fingertips.



www.ForestRiverBuyLocal.com



Actual towing capacity is dependent on your particular loading and towing circumstances, which includes GVWR, GAWR and GCWR, as well as adequate trailer brakes. Please refer to the Owner's Manual of your vehicle for further information. All information contained in this brochure is believed to be accurate at the time of publication. However, during the model year, it may be necessary to make revisions and Forest River, Inc., reserves the right to make all such changes without notice, including prices, colors, materials, equipment and specifications as well as the addition of new models and the discontinuance of models shown in this brochure. Therefore, please consult with your Forest River dealer and confirm the existence of any materials, design or specifications that are material to your purchase decision. ©2020 XLR, a Division of Forest River, Inc., a Berkshire Hathaway company. All Rights Reserved. 01/20



ACTION CAMPING™

2421 Century Drive / Goshen, IN 46528

Phone: 574-642-0438

E-mail: XLRinfo@forestriverinc.com



Visit our website at: forestriverinc.com/rvs/brand/XLR/toy-haulers
for everything Nitro and Hyperlite have to offer.

YOUR XLR ACTION CAMPING™ DEALER: