

The top-selling  
Class B in  
North America.



## Nimble and Efficient, Meet Easy-Going Comfort

- **FLEXIBLE ENTERTAINING** After a long day of hiking, put your feet up and relax in the Travato's two bench seats with pivoting table (59G/GL). Or invite over the whole crew with a center table and bench seating for up to six with our 59K/KL floorplan.
- **ALL WEATHER** Extend camping season with the fuel-efficient Truma Combi® Eco Plus heating, above-floor waterlines, heated tanks, roof and sidewall insulation and available insulated windows.\*
- **STOW & GO** Underbed, roof and bike rack storage hold big gear, our Anything Keepers™ store books and other small accessories overhead, and RAM® Tough-Track™ mounts keep electronics right where you want them.
- **AT YOUR FINGERTIPS** Control your Coleman®-Mach® 10 NDQ A/C and the Carefree awning with the Bluetooth app, while the MyVolta app monitors the Pure³ Advanced Energy System.
- **EXTENDED POWER** Run virtually any appliance longer with the standard lithium Pure³ Advanced Energy System (59GL/KL) cranking out 9,500 watt-hours of stored energy.

**WINNEBAGO**

TRAVATO

QUALITY INNOVATION SERVICE

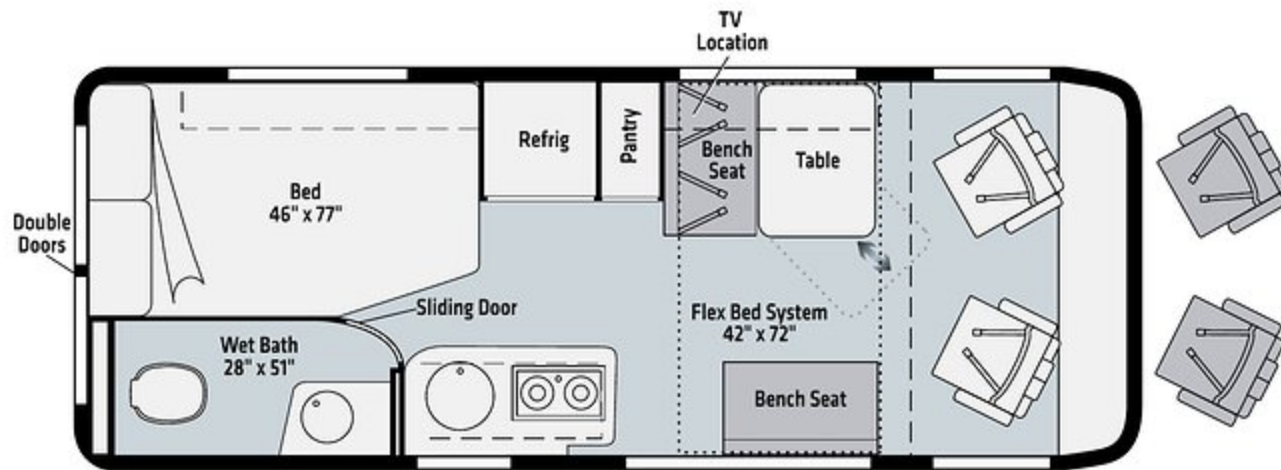

**59G / 59GL**

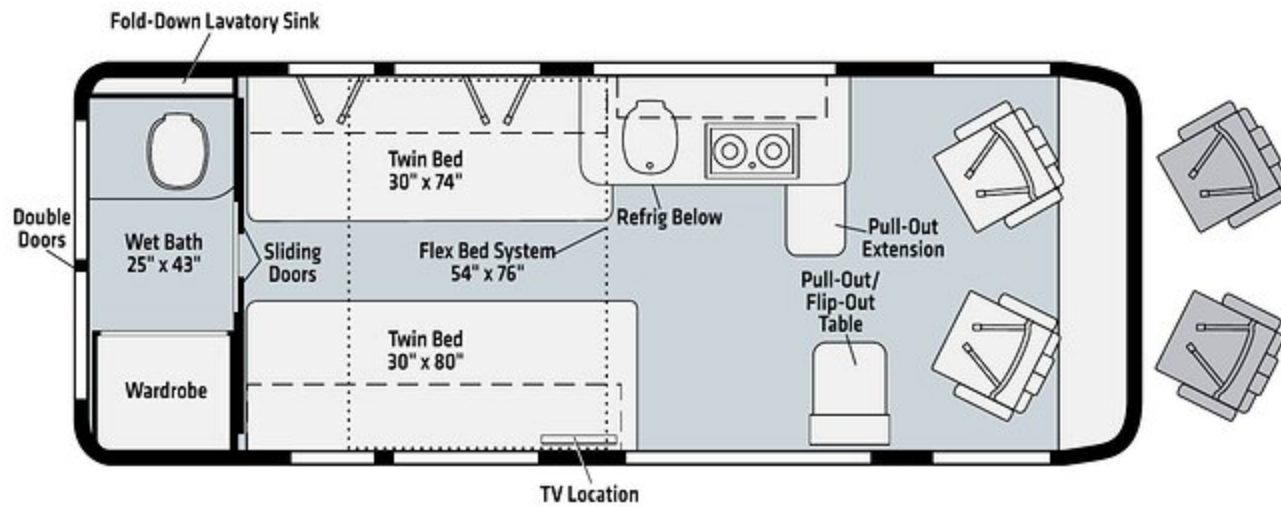

**59K / 59KL**

Ultra leather

Vinyl

Dashed lines denote overhead storage areas. Floorplans and specifications are also available online at [Winnebago.com](http://Winnebago.com)

**WEIGHTS | MEASURES**

	<b>59G</b>	<b>59GL</b>	<b>59K</b>	<b>59KL</b>
Length	21'	21'	21'	21'
Exterior Height <sup>1</sup>	9'4"	9'4"	9'4"	9'4"
Exterior Width	6'9"	6'9"	6'9"	6'9"
Awning Length	13'	13'	13'	13'
Interior Height	6'3"	6'3"	6'3"	6'3"
Interior Width	6'2"	6'2"	6'2"	6'2"
Freshwater Tank Capacity <sup>2</sup> (gal.)	21	18	25	18
Water Heater Capacity (gal.)	2.6*	2.6*	2.6*	2.6*
Holding Tank Capacity - Black/Gray <sup>2</sup> (gal.)	11/15	11/15	13/13	12/13
LP Capacity <sup>3</sup> (lbs.)	25.38	25.38	25.38	25.38
Fuel Capacity (gal.)	24	24	24	24
GCWR <sup>4</sup> (lbs.)	11,500	11,500	11,500	11,500
GVWR (lbs.)	9,350	9,350	9,350	9,350
GAWR - Front (lbs.)	4,629	4,629	4,629	4,629
GAWR - Rear (lbs.)	5,291	5,291	5,291	5,291
Wheelbase	159"	159"	159"	159"

**Note:** Dimensions shown are for sleeping and shower space only and may vary due to styling differences.

1. The height of each model is measured to the top of the tallest standard feature and is based on the curb weight of a typically equipped unit. The actual height of your vehicle may vary by several inches depending on chassis or equipment variations. Please contact your dealer for further information.
2. Capacities are based on measurements prior to tank installation. Slight capacity variations can result due to installation applications.
3. Capacities shown are tank manufacturer's listed water capacity (W.C.) Actual filled LP capacity is 80% of listing due to overfilling prevention device on tank.
4. Actual towing capacity is dependent upon your particular loading and towing circumstances, which includes the GVWR, GAWR and GCWR as well as adequate trailer brakes. Please refer to the Operator's Manual of your vehicle for further towing information.

**\*Disclaimer:** Winnebago recommends following the winter use guidelines and winterization procedures outlined in your owner's manual whenever camping in freezing conditions.

Because features, specifications, equipment, and options may vary from those highlighted in this brochure, the buyer is responsible for confirming with the dealer the features, specifications, equipment, and options included on their specific vehicle. In addition, Winnebago's program of continuous product improvement may result in changes to vehicle specifications, equipment, model availability, and price without notice