

COACHMEN BROOKSTONE 5TH WHEELS

# BROOKSTONE



STANDARD  
WITH WEATHER  
SHIELD PLUS



SCAN HERE FOR ADDITIONAL PHOTOS, 360  
VIRTUAL TOURS, VIDEOS, & A COMPLETE  
LIST OF STANDARDS, OPTIONS & MORE

[WWW.COACHMENRV.COM/FIFTHWHEELS](http://WWW.COACHMENRV.COM/FIFTHWHEELS)



COACHMEN BROOKSTONE 5TH WHEELS

# BROOKSTONE



STANDARD  
WITH WEATHER  
SHIELD PLUS



SCAN HERE FOR ADDITIONAL PHOTOS, 360  
VIRTUAL TOURS, VIDEOS, & A COMPLETE  
LIST OF STANDARDS, OPTIONS & MORE

[WWW.COACHMENRV.COM/FIFTHWHEELS](http://WWW.COACHMENRV.COM/FIFTHWHEELS)





## SPECIFICATIONS

Model	290RL	344FL	350RL	374RK	398MBL
Shipping Weight	11,412	12,729	12,230	12,960	13,095
Carrying Capacity	3,028	2,211	2,710	2,480	2,345
IUVW	11,472	12,789	12,290	13,020	13,155
GVWR	14,500	15,000	15,000	15,500	15,500
Hitch Weight	2,466	2,823	2,276	2,212	2,239
Exterior Height (Includes A/C)	13' 5"	13' 5"	13' 5"	13' 5"	13' 5"
Fresh Water Capacity (gal.)	60	60	60	60	60
Grey Water Capacity (gal.)	90	90	90	90	85
Waste Water Capacity (gal.)	45	90	45	45	45
Awning Length	17'	14'	20'	18' (11')	20'
Wheel Size	16"	16"	16"	16"	16"
Exterior Length (Bumper to Cap)	36' 4"	42' 2"	41' 3"	42' 2"	42' 2"
Interior Height (Coach)	96"	96"	96"	96"	96"
Axles	7000	7000	7000	7000	7000
Tire Size	ST235/80R16G	ST235/80R16G	ST235/80R16G	ST235/80R16G	ST235/80R16G

## WIDE-BODY LUXURY

## FOUR-SEASON COMFORT





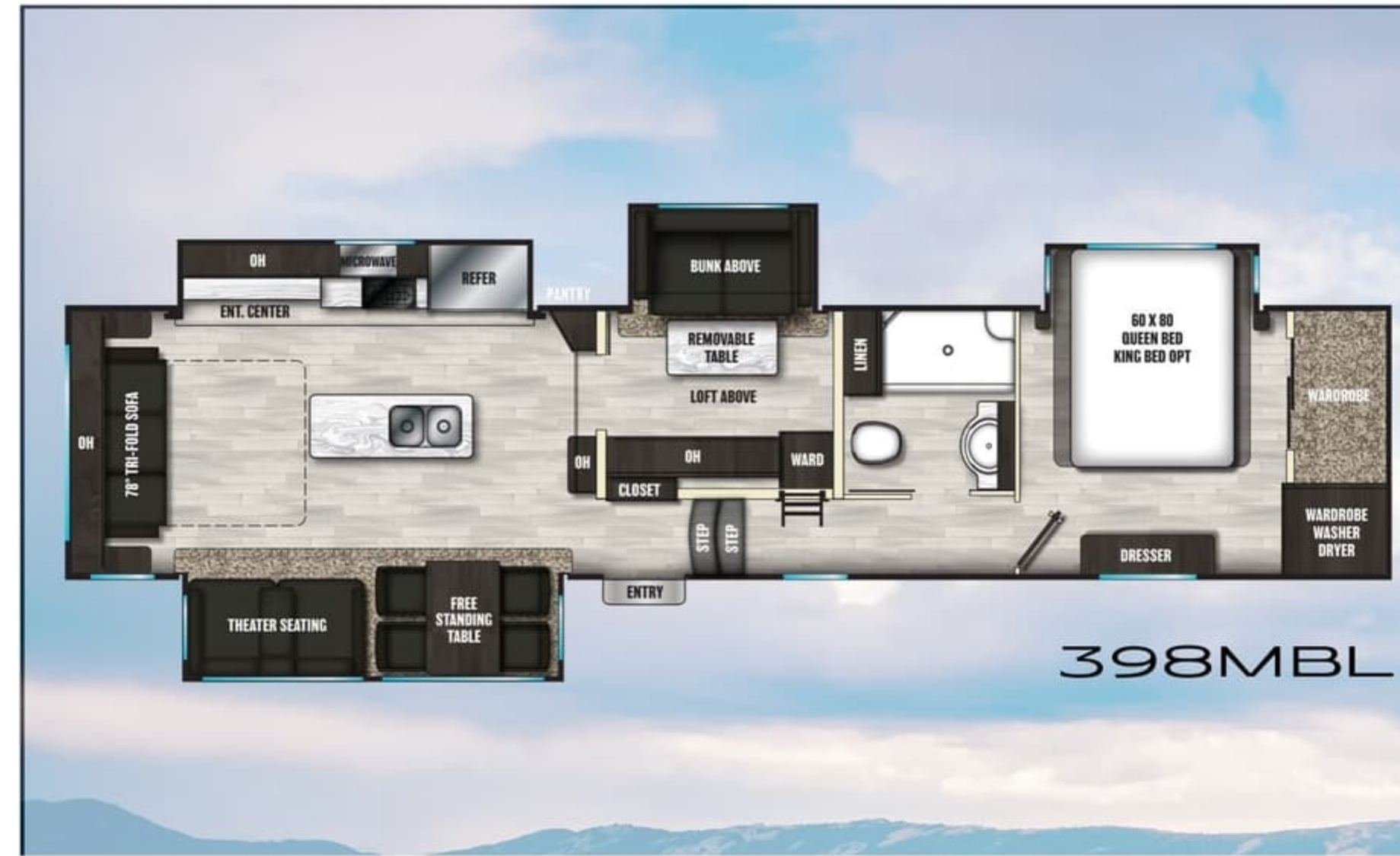

### SPECIFICATIONS

Model	290RL	344FL	350RL	374RK	398MBL
Shipping Weight	11,412	12,729	12,230	12,960	13,095
Carrying Capacity	3,028	2,211	2,710	2,480	2,345
UVW	11,472	12,789	12,290	13,020	13,155
GVWR	14,500	15,000	15,000	15,500	15,500
Hitch Weight	2,466	2,823	2,276	2,212	2,239
Exterior Height (Includes A/C)	13' 5"	13' 5"	13' 5"	13' 5"	13' 5"
Fresh Water Capacity (gal.)	60	60	60	60	60
Grey Water Capacity (gal.)	90	90	90	90	85
Waste Water Capacity (gal.)	45	90	45	45	45
Awning Length	17'	14'	20'	18' (11')	20'
Wheel Size	16"	16"	16"	16"	16"
Exterior Length (Bumper to Cap)	36' 4"	42' 2"	41' 3"	42' 2"	42' 2"
Interior Height (Coach)	96"	96"	96"	96"	96"
Axles	7000	7000	7000	7000	7000
Tire Size	ST235/80R16G	ST235/80R16G	ST235/80R16G	ST235/80R16G	ST235/80R16G

## WIDE-BODY LUXURY

## FOUR-SEASON COMFORT







WIDE-BODY COMFORT



ROOM TO ENTERTAIN



DINE WITH THE BEST VIEWS

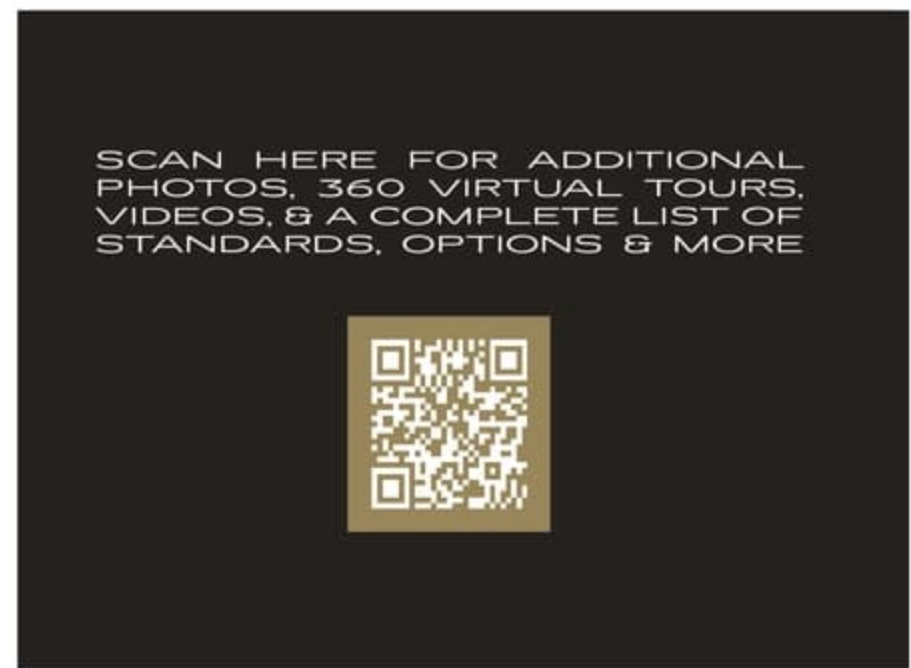

COACHMEN RV - FOR OVER 50 YEARS...

YOUR LEADER TO THE GREAT OUTDOORS

B R O O K S T O N E

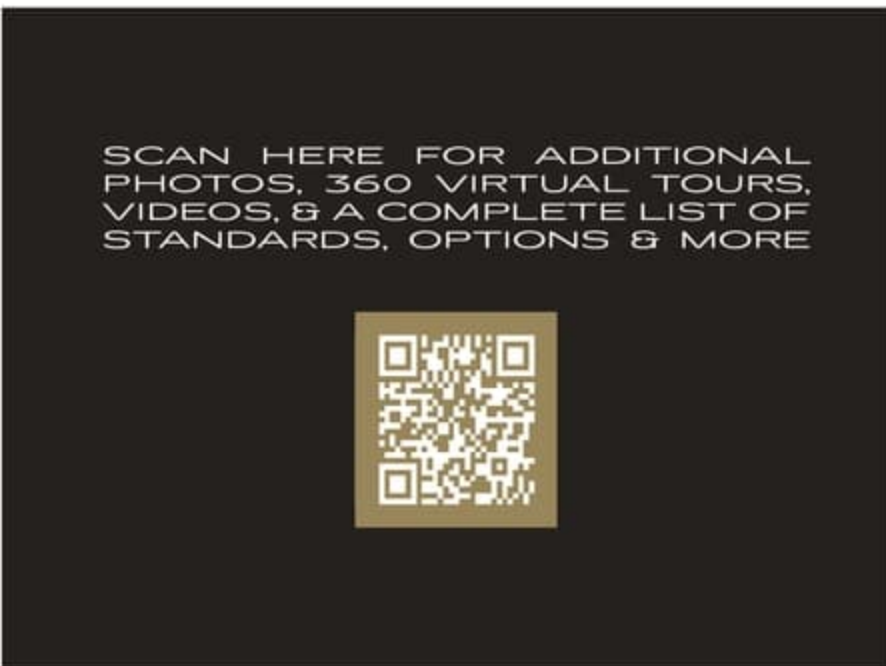

CHEF'S DREAM KITCHENS



UNIQUE DESIGNS



HOME-LIKE AMENITIES





WIDE-BODY COMFORT



ROOM TO ENTERTAIN



DINE WITH THE BEST VIEWS

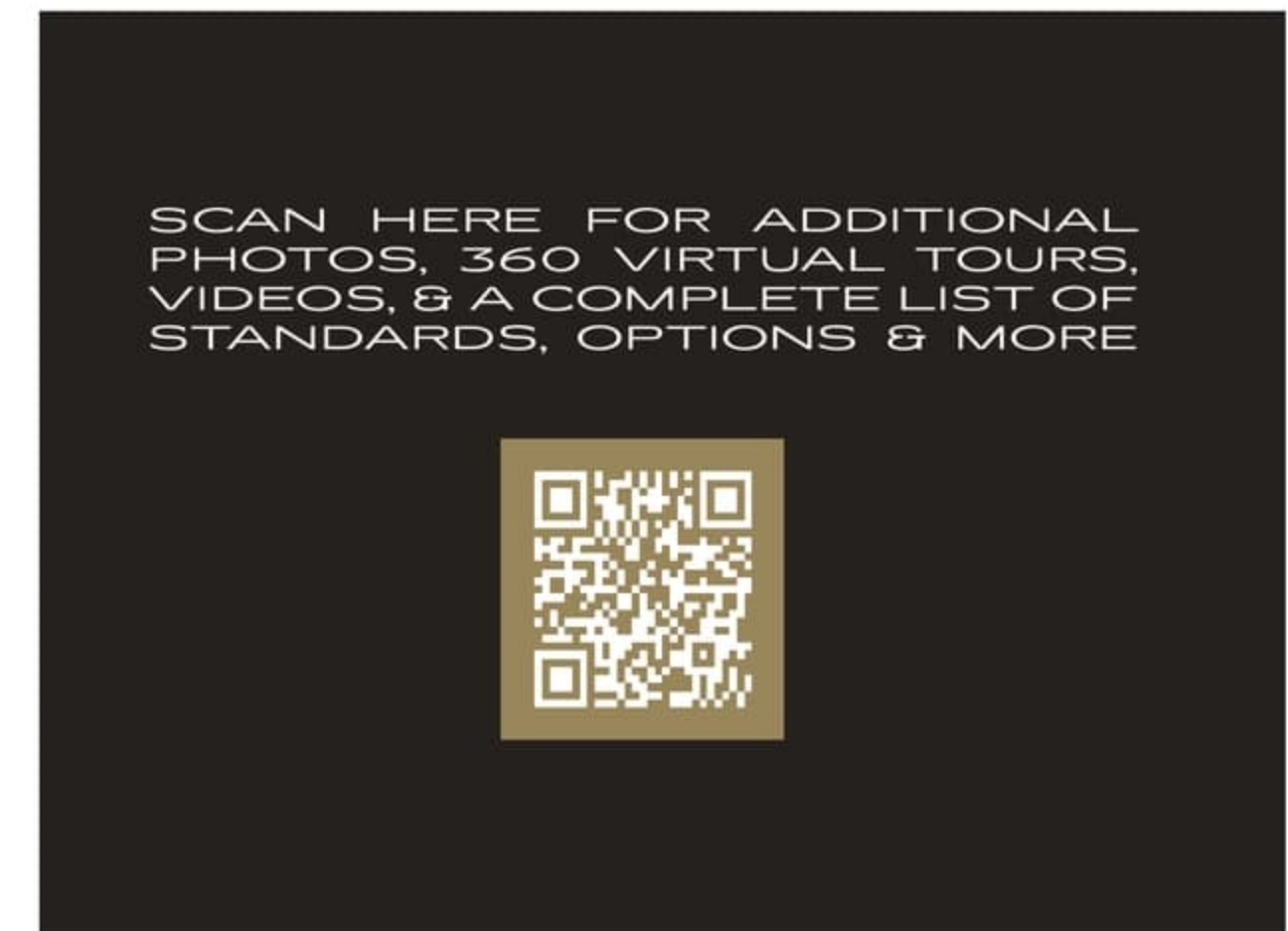

COACHMEN RV - FOR OVER 50 YEARS...

YOUR LEADER TO THE GREAT OUTDOORS

B R O O K S T O N E

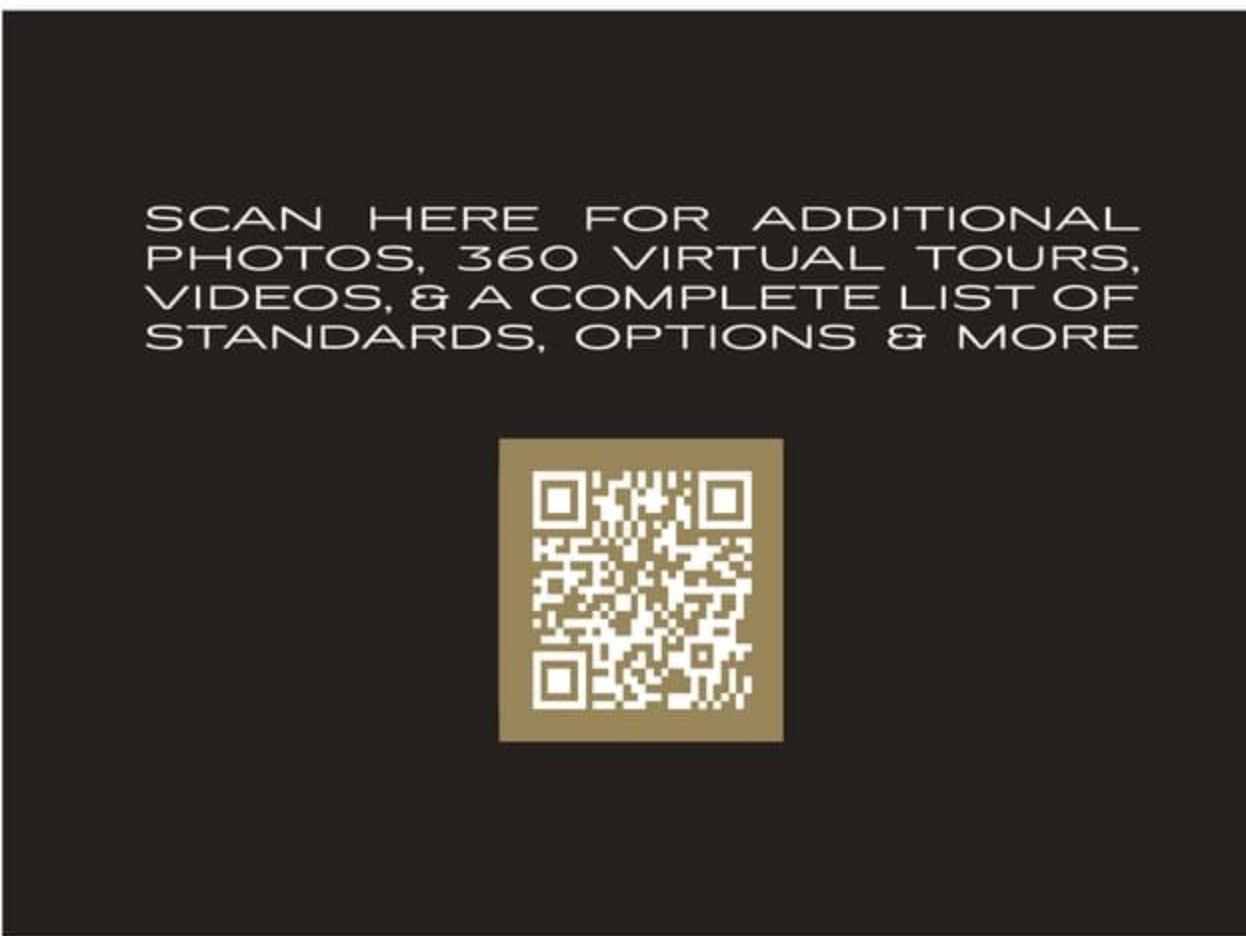

CHEF'S DREAM KITCHENS



UNIQUE DESIGNS



HOME-LIKE AMENITIES





**FREE MEMBERSHIP**  
www.coachmenowners.com

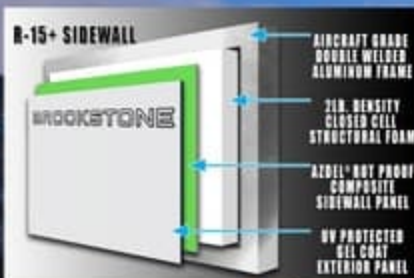

AZDEL COMPOSITE SIDE WALL PANELS



5 YEAR NO EXCUSE GUARANTEE



USA-MADE DEXTER AXLES



**PRE-DELIVERY INSPECTION FACILITY**  
20,000 square feet of quality assurance. The key essential for a premium product. This state-of-the-art facility gives immediate daily feedback to production for quality assurance in every unit built.

# BROOKSTONE

## STAND OUT FEATURES



- ALL NEW AUTOMOTIVE PAINTED FRONT CAP W/ L.E.D. LIGHTING
- VACUUM BONDED & ALUMINUM FRAMED SIDE WALLS W/ ROT-PROOF AZDEL COMPOSITE SIDE WALL PANELS (X2)
- UV-TREATED, WEATHER-RESISTANT DECALS W/ MODERN BROOKSTONE LOGOS (3-5 YEAR WARRANTY BASED ON LOCATION)
- WEATHER SHIELD PLUS (SUPERIOR PROTECTION FROM THE ELEMENTS)
- 0° COLD TESTED & 110° HOT TESTED (EXTREME TEMPERATURE CHAMBER)
- SECTIONALIZED UNDERBELLY FOR EASE OF SERVICE (I-BEAM TOP MOUNTED & SEALED)
- SPACE AGE RADIANT BARRIER REFLECTIVE TECHNOLOGY (UNDERBELLY, ROOF, SLIDES & MORE!)
- UNOBSTRUCTED & INSULATED DROP FRAME PASS-THROUGH STORAGE W/ BUILT-IN TOOL STORAGE
- HEATED, INSULATED, & ENCLOSED TANKS & GATE VALVES (ELECTRIC TANK HEAT PADS STANDARD)
- ROOF-MOUNTED SOLAR PANEL PREP (ROOF-MOUNTED SOLAR PANEL OPT. AVAIL.)
- WINEGUARD AIR 360 HDTV/RADIO DOME ANTENNA (PRE-WIRED FOR OPT. CONNECT 2.0 WIFI EXTENDER)
- HIGH CAPACITY, DUAL DUCTED A/C UNITS (X2)
- 100% GEAR-DRIVEN SLIDES (NO CABLE SLIDES!)
- 7,000 LB. USA-MADE DEXTER AXLES W/ E-Z LUBE HUBS
- ROAD ARMOR SUSPENSION BY TRAIL AIR W/ HEAVY DUTY SHACKLES & WET BOLTS
- 6-POINT ELECTRIC AUTO-LEVELING SYSTEM (GEAR DRIVEN)
- FRAME-LESS AUTOMOTIVE STYLE WINDOWS (80% PRIVACY TINT SAFETY GLASS)
- THOMAS PAYNE TRI-FOLD HAB\*/THEATRE SEATING W/ HEAT, MASSAGE, & LED LIGHTING\*
- STAINLESS STEEL APPLIANCES THROUGHOUT
- 12 AND 17 CU. FT. REFRIGERATOR OPTIONS\* (GAS/ELECTRIC & RESIDENTIAL OPTIONS AVAILABLE\*)
- MODERN, HIGH BTU OUTPUT ELECTRIC FIREPLACE
- MODERN ENTERTAINMENT CENTER W/ EXTRA LARGE ARTICULATING LED TV (LIVING)
- SIDE-BY-SIDE/STACKABLE WASHER/DRYER PREP

**GVWR (GROSS VEHICLE WEIGHT RATING)** - IS THE MAXIMUM PERMISSIBLE WEIGHT OF THE UNIT WHEN FULLY LOADED. IT INCLUDES ALL WEIGHTS, INCLUSIVE OF ALL FLUIDS, CARGO, OPTIONAL EQUIPMENT AND ACCESSORIES. FOR SAFETY AND PRODUCT PERFORMANCE DO NOT EXCEED THE GVWR.

**GAWR (GROSS AXLE WEIGHT RATING)** - IS THE MAXIMUM PERMISSIBLE WEIGHT, INCLUDING CARGO, FLUIDS, OPTIONAL EQUIPMENT, AND ACCESSORIES THAT CAN BE SAFELY SUPPORTED BY A COMBINATION OF ALL AXLES.

**UVW (UNLOADED VEHICLE WEIGHT)** - IS THE TYPICAL WEIGHT OF THE UNIT AS MANUFACTURED AT THE FACTORY. IT INCLUDES ALL WEIGHT AT THE UNIT'S AXLE(S) AND TONGUE OR PIN AND LP GAS. THE UVW DOES NOT INCLUDE CARGO, FRESH POTABLE WATER, ADDITIONAL OPTIONAL EQUIPMENT OR DEALER INSTALLED ACCESSORIES. \*ESTIMATED AVERAGE BASED ON STANDARD BUILD OPTIONAL EQUIPMENT.

**CCC (CARGO CARRYING CAPACITY)\*\*** - IS THE AMOUNT OF WEIGHT AVAILABLE FOR FRESH POTABLE WATER, CARGO, ADDITIONAL OPTIONAL EQUIPMENT AND ACCESSORIES. CCC IS EQUAL TO GVWR MINUS UVW. AVAILABLE CCC SHOULD ACCOMMODATE FRESH POTABLE WATER (8.3 LBS PER GALLON). BEFORE FILLING THE FRESH WATER TANK, EMPTY THE BLACK AND GRAY TANKS TO PROVIDE FOR MORE CARGO CAPACITY.

\*\* ESTIMATED AVERAGE BASED ON STANDARD BUILD OPTIONAL EQUIPMENT. EACH FOREST RIVER RV IS WEIGHED AT THE MANUFACTURING FACILITY PRIOR TO SHIPPING. A LABEL IDENTIFYING THE UNLOADED VEHICLE WEIGHT OF THE ACTUAL UNIT AND THE CARGO CARRYING CAPACITY IS APPLIED TO EVERY FOREST RIVER RV PRIOR TO LEAVING OUR FACILITIES.

THE LOAD CAPACITY OF YOUR UNIT IS DESIGNATED BY WEIGHT, NOT BY VOLUME, SO YOU CANNOT NECESSARILY USE ALL AVAILABLE SPACE WHEN LOADING YOUR UNIT.

ALL INFORMATION CONTAINED IN THIS BROCHURE IS BELIEVED TO BE ACCURATE AT THE TIME OF PUBLICATION. HOWEVER, DURING THE MODEL YEAR IT MAY BE NECESSARY TO MAKE REVISIONS. FOREST RIVER, INC., RESERVES THE RIGHT TO MAKE ALL SUCH CHANGES WITHOUT NOTICE, INCLUDING PRICES, COLORS, MATERIALS, EQUIPMENT, AND SPECIFICATIONS, AS WELL AS THE ADDITION OF NEW MODELS AND THE DISCONTINUANCE OF MODELS SHOWN IN THIS BROCHURE. THEREFORE, PLEASE CONSULT WITH YOUR FOREST RIVER DEALER AND CONFIRM THE EXISTENCE OF ANY MATERIALS, DESIGN, OR SPECIFICATIONS THAT ARE MATERIAL TO YOUR PURCHASE DECISION. \* = WHERE APPLICABLE.

24/7 EMERGENCY  
ROADSIDE ASSISTANCE  
WITH VEHICLE PURCHASE\*

TOWING  
JUMP-STARTS  
TIRE CHANGES  
FLUID DELIVERY  
LOCKOUT  
SERVICE

WINCH-OUT  
MOBILE MECHANIC  
TECHNICAL  
SUPPORT  
DEALER LOCATOR  
SERVICES

**SAFERIDERV**  
MOTOR CLUB

\*VALID FOR 1 YEAR FROM DATE OF PURCHASE

CUSTOMER SATISFACTION

FOREST RIVER encourages you to

**BUY LOCAL**

PREFERENTIAL SERVICE

PRODUCT INFORMATION

www.ForestRiverBuyLocal.com

2021/2022 COACHMEN RV  
A DIVISION OF FOREST RIVER, INC.,  
A BERKSHIRE HATHAWAY COMPANY  
ALL RIGHTS RESERVED

Learn More  
Scan this barcode using  
a QR Reader on your  
smart phone to learn  
more about Forest River.

**FOREST RIVER**  
A Berkshire Hathaway company.

YOUR LOCAL DEALER





**FREE MEMBERSHIP**  
www.coachmenowners.com

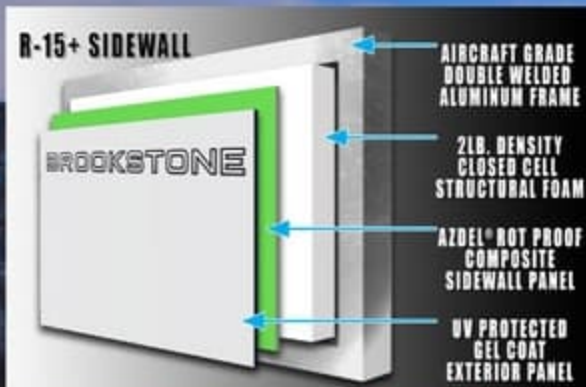

AZDEL COMPOSITE SIDE WALL PANELS



5 YEAR NO EXCUSE GUARANTEE



USA-MADE DEXTER AXLES



**PRE-DELIVERY INSPECTION FACILITY**  
20,000 square feet of quality assurance. The bare essentials for a premium product. This state-of-the-art facility gives immediate daily feedback to production for quality assurance in every unit built.

# BROOKSTONE

## STAND OUT FEATURES



- ALL NEW AUTOMOTIVE PAINTED FRONT CAP W/ L.E.D. LIGHTING
- VACUUM BONDED & ALUMINUM FRAMED SIDE WALLS W/ ROT-PROOF AZDEL COMPOSITE SIDE WALL PANELS (X2)
- UV-TREATED, WEATHER-RESISTANT DECALS W/ MODERN BROOKSTONE LOGOS (3-5 YEAR WARRANTY BASED ON LOCATION)
- WEATHER SHIELD PLUS (SUPERIOR PROTECTION FROM THE ELEMENTS)
- 0° COLD TESTED & 110° HOT TESTED (EXTREME TEMPERATURE CHAMBER)
- SECTIONALIZED UNDERBELLY FOR EASE OF SERVICE (I-BEAM TOP MOUNTED & SEALED)
- SPACE AGE RADIANT BARRIER REFLECTIVE TECHNOLOGY (UNDERBELLY, ROOF, SLIDES & MORE!)
- UNOBSTRUCTED & INSULATED DROP FRAME PASS-THROUGH STORAGE W/ BUILT-IN TOOL STORAGE
- HEATED, INSULATED, & ENCLOSED TANKS & GATE VALVES (ELECTRIC TANK HEAT PADS STANDARD)
- ROOF-MOUNTED SOLAR PANEL PREP (ROOF-MOUNTED SOLAR PANEL OPT. AVAIL.)
- WINEGUARD AIR 360 HDTV/RADIO DOME ANTENNA (PRE-WIRED FOR OPT. CONNECT 2.0 WIFI EXTENDER)
- HIGH CAPACITY, DUAL DUCTED A/C UNITS (X2)
- 100% GEAR-DRIVEN SLIDES (NO CABLE SLIDES!)
- 7,000 LB. USA-MADE DEXTER AXLES W/ E-Z LUBE HUBS
- ROAD ARMOR SUSPENSION BY TRAIL AIR W/ HEAVY DUTY SHACKLES & WET BOLTS
- 6-POINT ELECTRIC AUTO-LEVELING SYSTEM (GEAR DRIVEN)
- FRAME-LESS AUTOMOTIVE STYLE WINDOWS (80% PRIVACY TINT SAFETY GLASS)
- THOMAS PAYNE TRI-FOLD HAB\*/THEATRE SEATING W/ HEAT, MASSAGE, & LED LIGHTING\*
- STAINLESS STEEL APPLIANCES THROUGHOUT
- 12 AND 17 CU. FT. REFRIGERATOR OPTIONS\* (GAS/ELECTRIC & RESIDENTIAL OPTIONS AVAILABLE\*)
- MODERN, HIGH BTU OUTPUT ELECTRIC FIREPLACE
- MODERN ENTERTAINMENT CENTER W/ EXTRA LARGE ARTICULATING LED TV (LIVING)
- SIDE-BY-SIDE/STACKABLE WASHER/DRYER PREP

**GVWR (GROSS VEHICLE WEIGHT RATING)** - IS THE MAXIMUM PERMISSIBLE WEIGHT OF THE UNIT WHEN FULLY LOADED. IT INCLUDES ALL WEIGHTS, INCLUSIVE OF ALL FLUIDS, CARGO, OPTIONAL EQUIPMENT AND ACCESSORIES. FOR SAFETY AND PRODUCT PERFORMANCE DO NOT EXCEED THE GVWR.

**GAWR (GROSS AXLE WEIGHT RATING)** - IS THE MAXIMUM PERMISSIBLE WEIGHT, INCLUDING CARGO, FLUIDS, OPTIONAL EQUIPMENT, AND ACCESSORIES THAT CAN BE SAFELY SUPPORTED BY A COMBINATION OF ALL AXLES.

**UVW (UNLOADED VEHICLE WEIGHT)\*** - IS THE TYPICAL WEIGHT OF THE UNIT AS MANUFACTURED AT THE FACTORY. IT INCLUDES ALL WEIGHT AT THE UNIT'S AXLE(S) AND TONGUE OR PIN AND LP GAS. THE UVW DOES NOT INCLUDE CARGO, FRESH POTABLE WATER, ADDITIONAL OPTIONAL EQUIPMENT OR DEALER INSTALLED ACCESSORIES. \*ESTIMATED AVERAGE BASED ON STANDARD BUILD OPTIONAL EQUIPMENT.

**CCC (CARGO CARRYING CAPACITY)\*\*** - IS THE AMOUNT OF WEIGHT AVAILABLE FOR FRESH POTABLE WATER, CARGO, ADDITIONAL OPTIONAL EQUIPMENT AND ACCESSORIES. CCC IS EQUAL TO GVWR MINUS UVW. AVAILABLE CCC SHOULD ACCOMMODATE FRESH POTABLE WATER (8.3 LBS PER GALLON). BEFORE FILLING THE FRESH WATER TANK, EMPTY THE BLACK AND GRAY TANKS TO PROVIDE FOR MORE CARGO CAPACITY.

\*\* ESTIMATED AVERAGE BASED ON STANDARD BUILD OPTIONAL EQUIPMENT. EACH FOREST RIVER RV IS WEIGHED AT THE MANUFACTURING FACILITY PRIOR TO SHIPPING. A LABEL IDENTIFYING THE UNLOADED VEHICLE WEIGHT OF THE ACTUAL UNIT AND THE CARGO CARRYING CAPACITY IS APPLIED TO EVERY FOREST RIVER RV PRIOR TO LEAVING OUR FACILITIES.

THE LOAD CAPACITY OF YOUR UNIT IS DESIGNATED BY WEIGHT, NOT BY VOLUME, SO YOU CANNOT NECESSARILY USE ALL AVAILABLE SPACE WHEN LOADING YOUR UNIT.

ALL INFORMATION CONTAINED IN THIS BROCHURE IS BELIEVED TO BE ACCURATE AT THE TIME OF PUBLICATION. HOWEVER, DURING THE MODEL YEAR IT MAY BE NECESSARY TO MAKE REVISIONS. FOREST RIVER, INC., RESERVES THE RIGHT TO MAKE ALL SUCH CHANGES WITHOUT NOTICE, INCLUDING PRICES, COLORS, MATERIALS, EQUIPMENT, AND SPECIFICATIONS, AS WELL AS THE ADDITION OF NEW MODELS AND THE DISCONTINUANCE OF MODELS SHOWN IN THIS BROCHURE. THEREFORE, PLEASE CONSULT WITH YOUR FOREST RIVER DEALER AND CONFIRM THE EXISTENCE OF ANY MATERIALS, DESIGN, OR SPECIFICATIONS THAT ARE MATERIAL TO YOUR PURCHASE DECISION. \* =WHERE APPLICABLE.

24/7 EMERGENCY  
ROADSIDE ASSISTANCE  
WITH VEHICLE PURCHASE\*

TOWING  
JUMP-STARTS  
TIRE CHANGES  
FLUID DELIVERY  
LOCKOUT  
SERVICE

WINCH-OUT  
MOBILE MECHANIC  
TECHNICAL  
SUPPORT  
DEALER LOCATOR  
SERVICES



\*VALID FOR 1 YEAR FROM DATE OF PURCHASE

CUSTOMER SATISFACTION



www.ForestRiverBuyLocal.com

2021/2022 COACHMEN RV  
A DIVISION OF FOREST RIVER, INC.,  
A BERKSHIRE HATHAWAY COMPANY  
ALL RIGHTS RESERVED



Learn More  
Scan this barcode using  
a QR Reader on your  
smart phone to learn  
more about Forest River.



A Berkshire Hathaway company.

YOUR LOCAL DEALER