



FLAIR 28A  
Shown in Granite Standard Graphics

### CHASSIS | ENGINE | TIRES

- Ford® Chassis  
7.3L, 350HP Engine | 468 lb/ft Torque w/6 Speed Torq-Shift® Automatic Transmission w/Overdrive & Tow/Haul Mode
- Truss Platform
- Electronic Instrument Panel
- Auto Head Lights
- Standard Traction Control
- 4-Point Fully Automatic Hydraulic Leveling Jacks
- Tow Hitch Rating 8,000#
- Frame: Ladder Type, Single Channel  
36,000psi - 50,000psi Steel, E-Coated

### CHASSIS & TIRE SIZES

28A	16K CHASSIS	245/70R 19.5" TIRES
29M	18K CHASSIS	245/70R 19.5" TIRES
32S	22K CHASSIS	245/70R 19.5" TIRES
34J	22K CHASSIS	245/70R 19.5" TIRES
35R	22K CHASSIS	245/70R 19.5" TIRES

### EXTERIOR

- Aerodynamic Front Cap w/Hood & Automotive Headlights
- Automotive, Bonded, One Piece Windshield
- Exterior Mounted Sideview Cameras
- Power Entry Step w/Light
- Pass Through Storage
- One Piece Fiberglass Wall w/No Luan Backer
- Exterior Entertainment Center w/LED TV
- 50 Amp Service
- Frameless Windows
- Exterior Kitchen (29M, 34J)

### INTERIOR

- Digital Dash, Low Engine Cover and Center Console
- Hide-A-Loft™ Electric Drop Down Bed (600# Capacity)
- Sony® Dash Stereo
- Ducted A/C System
- Surf-X Tops
- Solid Surface Galley Countertops & Sink Covers (32S, 34J, 35R)
- Residential Refrigerator
- 3-Burner Range w/Glass Covers
- IllumaPlex Control System w/4.3" Touch Screen Panel and Mobile App (32S, 34J, 35R)
- Pre-Wired Solar Prep
- 1000W Inverter (28A, 29M), 2000W (32S, 34J, 35R)
- King Bed

### OPTIONS

- Full Body Paint (32S, 34J, 35R)
- Partial Paint (29M, 32S, 34J, 35R)
- Steering Stabilizer System
- Roof Vent Rain Covers
- Manual Theater Seating (28A, 32S, 34J)
- KING® Universal Satellite System
- Dream Dinette (29M)
- LP Refrigerator 8 Ft<sup>3</sup>
- Dual 13,500 BTU A/C (29M) (Standard, 34J, 35R)
- Dual 11,000 BTU A/C w/4.0 Generator/EMS (28A)
- 5.5kW Onan Generator (29M) (Standard, 34J, 35R)
- W/D All-In-One Combo (35R)
- Stackable Washer & Dryer (35R)



28A | 29M | 32S | 34J | 35R

Options: 096, 105, 194, 230, 342, 343, 435, 471

**TOP FLOORPLAN FEATURES**

**28A**

1. Open Living Room
2. Sleeps up to 6
3. King Bed
4. Private Lavys
5. Residential Refrigerator
6. 16,000K Chassis

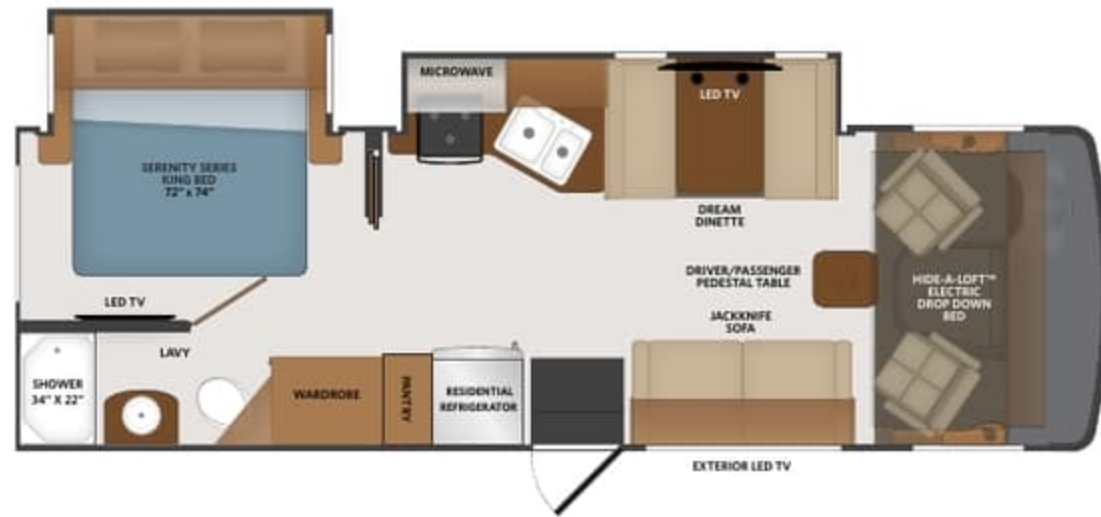

Options: 096, 105, 230, 331, 435, 471, 830

**TOP FLOORPLAN FEATURES**

**29M**

1. Family Friendly Galley
2. Sleeps up to 6
3. Exterior Kitchen w/Mini Frig, Microwave, Sink and Storage
4. L-shaped Dinette
5. Hide-A-Loft™ Electric Drop Down Bed
6. Pedestal Table between the Driver and Passenger Seats
7. 18,000K Chassis

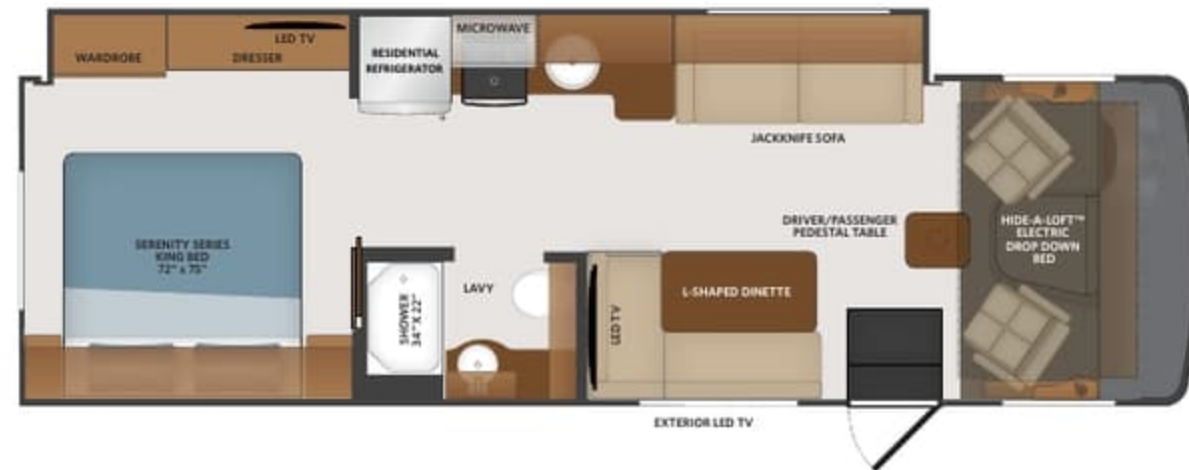

Options: 096, 105, 194, 230, 435, 471

**TOP FLOORPLAN FEATURES**

**32S**

1. Sleeps up to 6
2. Two Full Lavys
3. Exterior Entertainment Center w/LED TV
4. Full Wall Slide
5. Dream Dinette
6. 22,000K Chassis



**FLAIR  
 OPTIONS**

096	KING® Universal Satellite System	230	Roof Vent Rain Covers	435	Ford® CSA Package
105	Dometic 8CF Double Door Refrierator - LP	331	5.5KW Generator w/Dual A/C (29M, 32S)	471	Steering Stabilizer System
126	Washer/Dryer — All In One combo (35R)	342	Dual A/C w/EMS — LP Refrigerator (28A)	830	Dream Dinette
131	Stackable Washer/Dryer (35R)	343	Dual A/C w/EMS — Residential Refrigerator (28A)		
194	Manual Theater Seating (28A, 32S, 34J)				

28A | 29M | 32S | 34J | 35R

Options: 096, 105, 194, 230, 435, 471

**TOP FLOORPLAN FEATURES**

**34J**

1. Sleeps up to 8
2. Bunk Beds
3. Full Length Wardrobe
4. Jackknife Sofa
5. Pass through Exterior Storage
6. Exterior Kitchen w/Mini Frig, Microwave, Sink and Storage
7. 22,000K Chassis

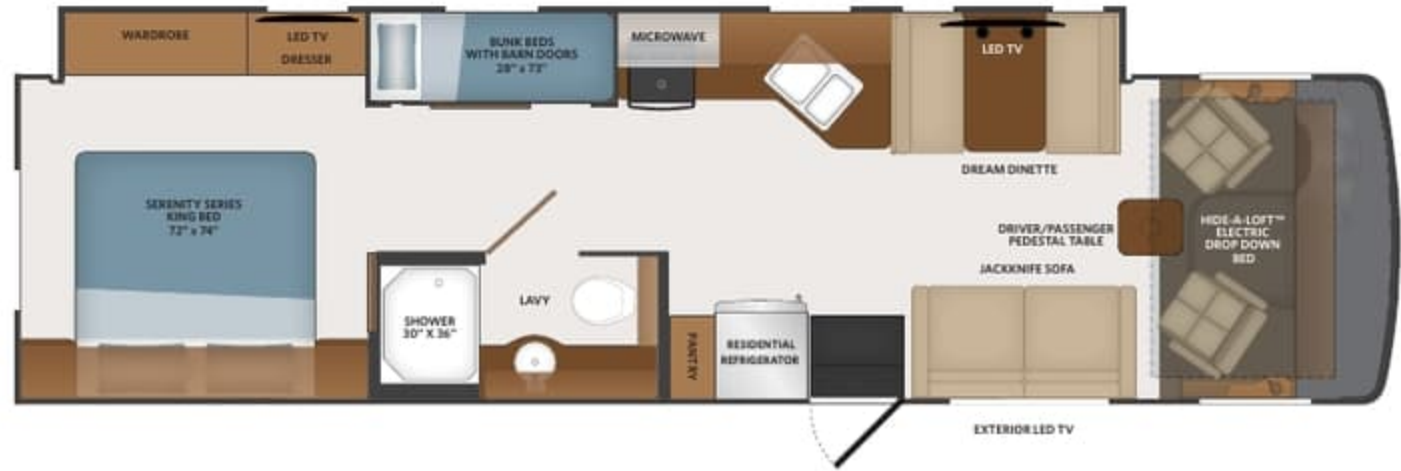

Options: 096, 105, 126, 131, 230, 435, 471

**TOP FLOORPLAN FEATURES**

**35R**

1. Sleeps up to 6
2. Spacious Living Area
3. Manual Theater Seating
4. Reduced Shower
5. Solid Surface Galley Top and Sink Covers
6. 2000W Inverter
7. Exterior Entertainment Center w/LED TV
8. 22,000K Chassis

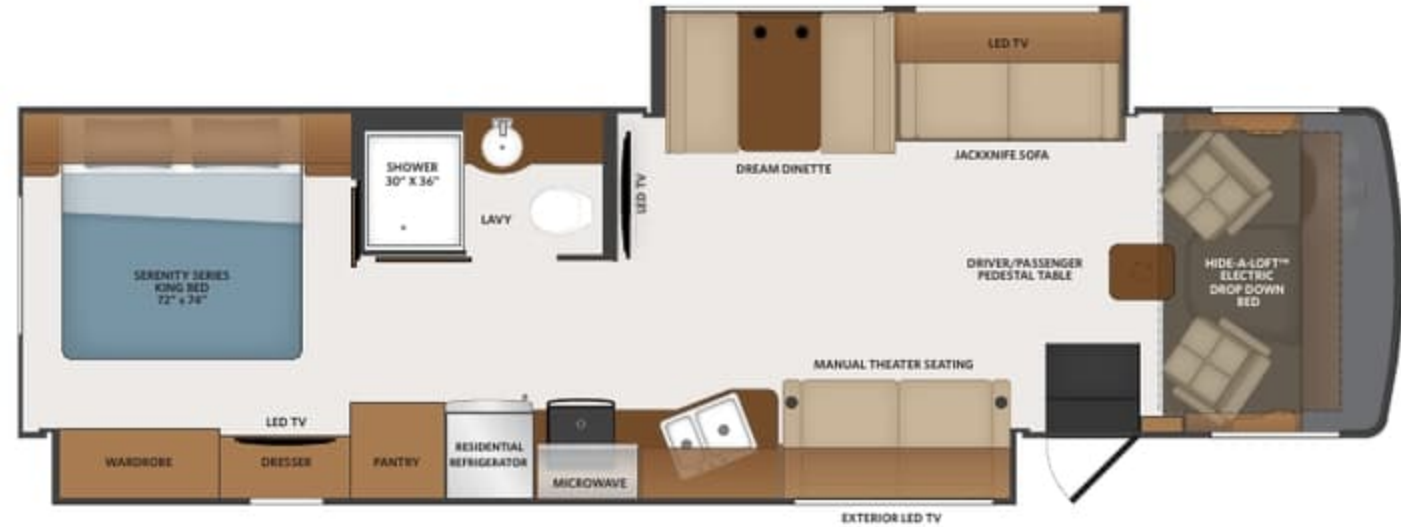

**FLAIR  
OPTIONS**

096	KING® Universal Satellite System	230	Roof Vent Rain Covers	435	Ford® CSA Package
105	Dometic 8CF Double Door Refrierator - LP	331	5.5KW Generator w/Dual A/C (29M, 32S)	471	Steering Stabilizer System
126	Washer/Dryer — All In One combo (35R)	342	Dual A/C w/EMS — LP Refrigerator (28A)	830	Dream Dinette
131	Stackable Washer/Dryer (35R)	343	Dual A/C w/EMS — Residential Refrigerator (28A)		
194	Manual Theater Seating (28A, 32S, 34J)				



DRIFTWOOD

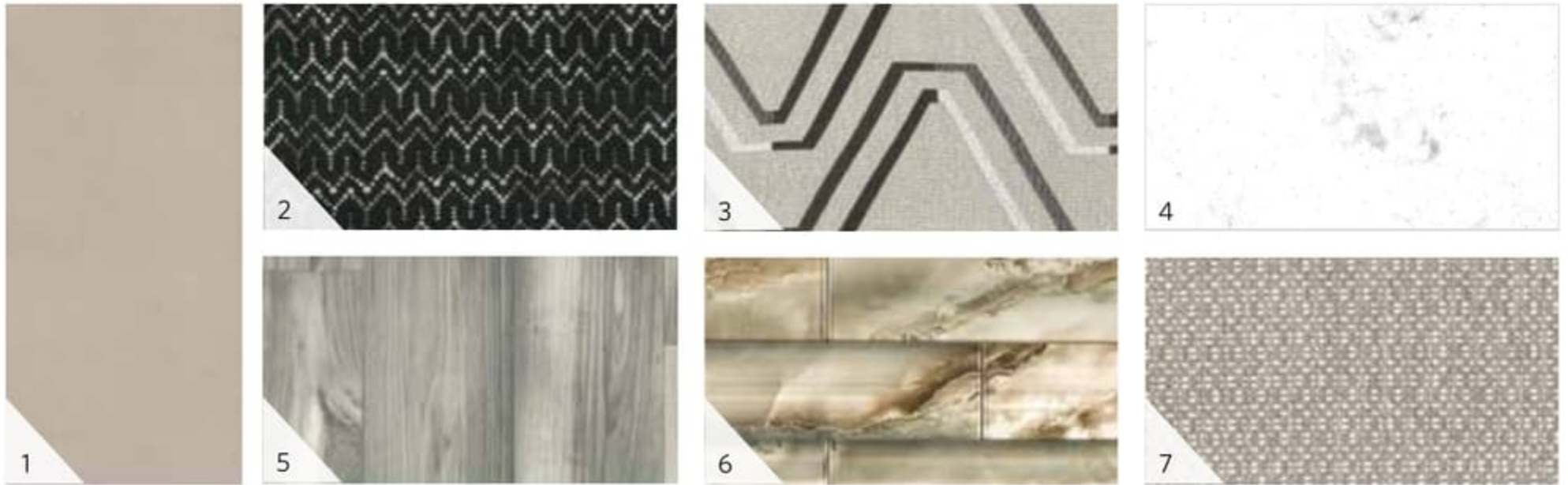

SILVER LAKE

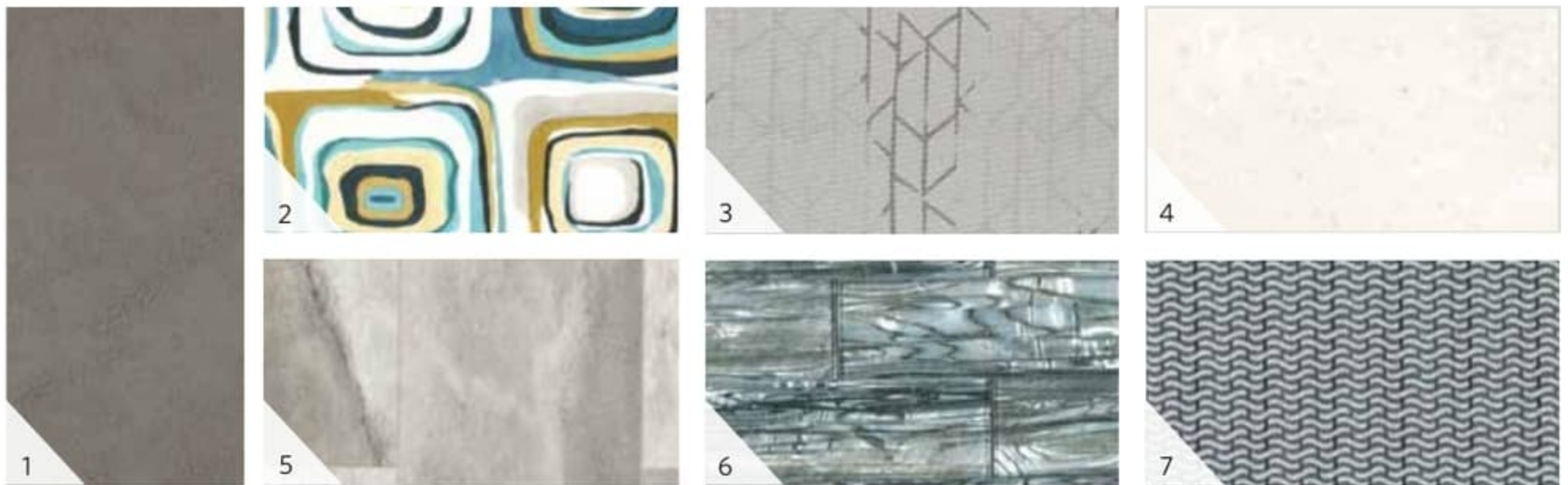

- |                 |              |              |           |
|-----------------|--------------|--------------|-----------|
| 1 SOFA          | 3 BEDDING    | 5 FLOORING   | 7 VALANCE |
| 2 LIVING ACCENT | 4 COUNTERTOP | 6 BACKSPLASH |           |



ENGLISH CHESTNUT



GREYSTONE



HERITAGE  
 (PAINTED CABINETRY)



WINTER FOG  
 (PAINTED W/GLAZED ACCENTS CABINETRY)



VINYL GRAPHICS



AUTUMN



GRANITE



PARTIAL PAINT - (NA 28A)



AUTUMN  
PARTIAL PAINT — NA 28A



GRANITE  
PARTIAL PAINT — NA 28A



FULL BODY PAINT - (32S, 34J, 35R)



CALIENTE  
FULL BODY PAINT — NA 28A & 29M



CAVALRY  
FULL BODY PAINT — NA 28A & 29M





CHASSIS	28A	29M	32S	34J	35R
Wheelbase (inches)	190"	190"	208"	228"	228"
GVWR (lbs)	16,000	18,000	22,000	22,000	22,000
Front GAWR (lbs)	6,500	7,000	8,000	8,000	8,000
Rear GAWR (lbs)	11,000	12,000	15,000	15,000	15,000
GCWR (lbs) - 350HP	21,000	23,000	26,000	26,000	26,000
Hitch Rating Weight (lbs)	8,000	8,000	8,000	8,000	8,000
Tongue Weight (lbs)	800	800	800	800	800
Fuel Capacity (gal)	80	80	80	80	80

DIMENSIONS AND CAPACITIES	28A	29M	32S	34J	35R
Overall Length (inches)	29' 3"	31' 0"	31' 6"	36' 0"	36' 0"
Overall Height (with A/C)	12' 4"	12' 4"	12' 4"	12' 4"	12' 4"
Overall Width (maximum)	100"	100"	100"	100"	100"
Interior Height (maximum)	82"	82"	82"	82"	82"
Interior Width (maximum)	96"	96"	96"	96"	96"
Patio Awning Width (ft./in.)	20' 0"	20' 0"	14' 0"	22' 0"	18' 0"
Interior Storage (cu. ft.)	81	92	97	110	130
Exterior Storage (cu. ft.)	70	45	83	82	160
Fresh Water Holding Tank (gal)	50	50	50	50	50
Grey Water Holding Tank (gal)	37	37	74	37	37
Black Water Holding Tank (gal)	37	37	37	37	37
Appliance Propane Tank (gal) (WC)	14	14	14	14	14
Water Heater Tank (gal)	6	6	10	6	6

**FORD® CHASSIS**



Model: Ford®  
 Engine: 7.3L Triton V8  
 Transmission: Ford® 6-Speed, Automatic w/Overdrive  
 Alternator: 175 Amp  
 Torque: 468 lb.-ft. @ 3,000 RPM  
 Horsepower: 350HP @ 3,900 RPM



All 2022 REV Recreation Group motorhomes include a limited one year/15,000-mile coach warranty and three-year/45,000-mile structural warranty, whichever occurs first, and is fully transferable for the first 12 months.

Product information, photography and illustrations included in this publication were as accurate as possible at the time of printing. For further product information and changes, please visit our website at [www.fleetwoodrv.com](http://www.fleetwoodrv.com) or contact your local Fleetwood dealer. Prices, materials, design and specifications are subject to change without notice. All weights, fuel, liquid capacities and dimensions are approximate. Fleetwood RV has designed its recreational vehicles to provide a variety of uses for its customers. Each vehicle features optimal seating, sleeping, storage and fluid capacities. The user is responsible for selecting the proper combination of loads (i.e., occupants, equipment, fluids cargo, etc.) to ensure that the vehicle's capacities are not exceeded.