

ALPHA WOLF

CHEROKEE
LIGHTWEIGHTS

ALPHA WOLF

TRAVEL TRAILERS





TOUGHER. LIGHTER. BETTER.

WE ARE ALPHA.

For over 20 years, the Cherokee division of Forest River has produced quality products and has endured to become one of the RV industry's most widely respected and purchased towable products. The Cherokee Alpha Wolf offers the best mix floor plan diversity and top shelf amenities while at the same time creating a tougher, lighter, better insulated shell. Alpha Wolf is the next evolution in Cherokee's renowned quality, floor plan functionality and outstandingly affordable value proposition. Plainly speaking, we give you more for your hard earned dollar!





22SW-L



PERFECT FOR THE TWO OF YOU THAT WANT TO GET OUT AND TOUR!

Some interior appointments include an abundant interior storage capacity with two pantries, oversized rear bath, plush theatre seats with heat-light-and massage, removable dinner trays, farm style sink and dual barn style doors, large rear bath with linen. Some exterior refinements include an oversized 18' exterior awning and a deluxe outside kitchen for the camp chef!



22SW-L

FLOORPLAN SHEET

360 VIRTUAL TOUR

WALK THROUGH



33BH-L



BUNK ROOM



BUNK ROOM



MASTER BEDROOM



ALPHA WOLF'S FIRST TRIPLE SLIDE MULTI-SLEEPER. THIS AMAZING BATH AND 1/2 BUNKHOUSE CAN SLEEP 8 COMFORTABLY.

Some interior appointments include, abundant interior storage capacity, fully enclosed bunkroom with multiple sleeping surfaces, oversized u-dinette seating surface for all the kids, dual pots and pans drawers, farm-style sink, and barn door access to bunk room. Some exterior refinements include an oversized 20' exterior awning, dual entry, and a full outside kitchen with fridge/freezer.

33BH-L

FLOORPLAN SHEET

360 VIRTUAL TOUR

VIDEO WALK THROUGH

ALPHA WOLF

TRAVEL TRAILERS

CLICK A FLOORPLAN TO VIEW
ADDITIONAL DETAILS

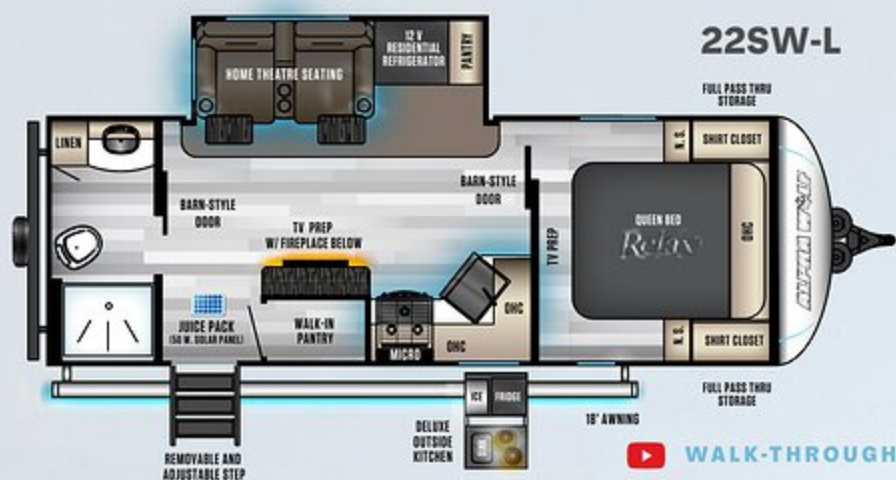

[WALK-THROUGH](#)

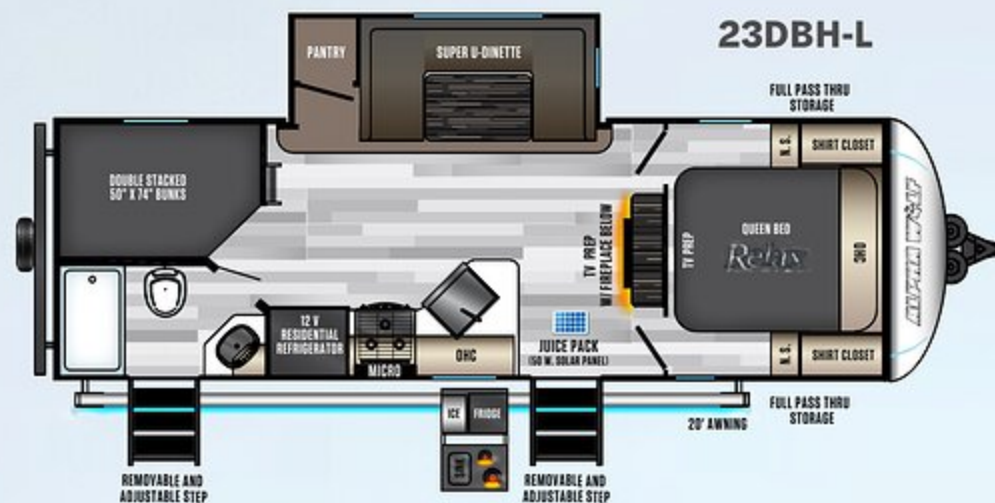

[WALK-THROUGH](#)



[WALK-THROUGH](#)

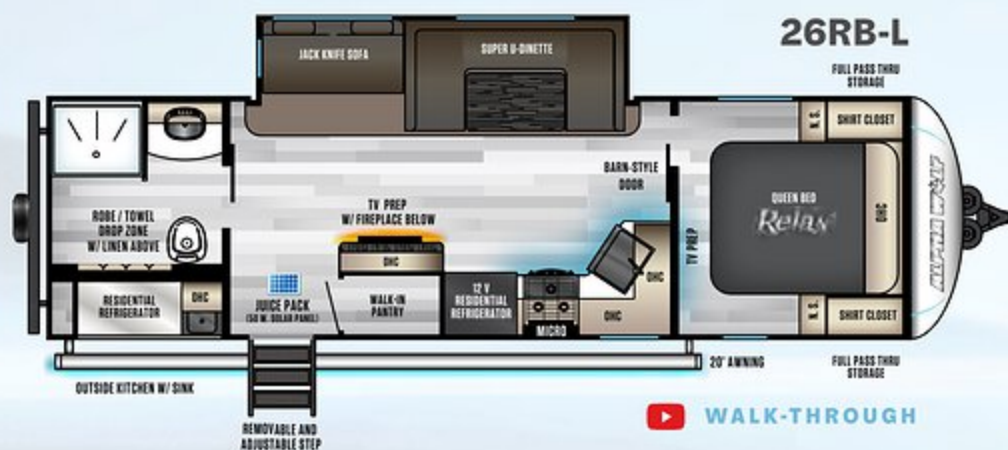

[WALK-THROUGH](#)

	22SW-L	23DBH-L	26DBH-L	26RL-L	26RB-L	26RK-L	28FK-L	30DBH-L	30RDB-L	33BH-L
▶ HITCH (LBS)	570	700	600	740	720	715	1,155	875	955	953
▶ UVW (LBS)	5,328	5,658	5,795	7,088	6,143	6,048	6,513	7,418	6,918	7,986
▶ CCC (LBS)	2,242	2,042	1,805	1,812	1,577	1,667	1,822	1,867	1,859	1,877
▶ EXT LENGTH (FT/IN)	27' 6"	29' 5"	31' 8"	34' 5"	32' 8"	32' 9"	32' 7"	37' 6"	37' 6"	37' 4"
▶ EXT HEIGHT W/STD AC (FT/IN)	11'	11'	11'	11' 2"	11'	11'	11' 2"	11' 2"	11' 2"	11' 2"
▶ EXT WIDTH (FT)	8'	8'	8'	8'	8'	8'	8'	8'	8'	8'
▶ FRESH WATER TANK (GAL)	49	49	49	49	49	49	49	49	49	49
▶ BLACK WATER TANK (GAL)	35	35	35	35	35	35	35	35	35	70
▶ GREY WATER TANK (GAL)	70	35	35	70	70	70	70	105	70	70
▶ AWNING (FT)	18'	20'	20'	20'	20'	20'	20'	20'	20'	20'

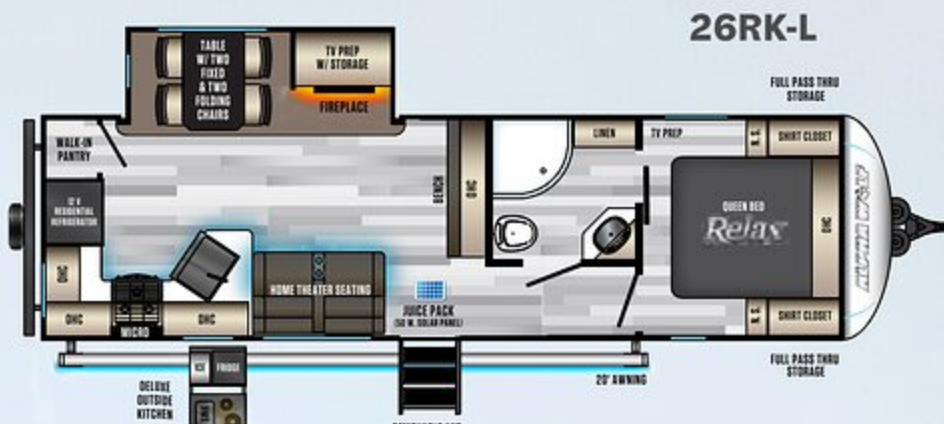

26RK-L

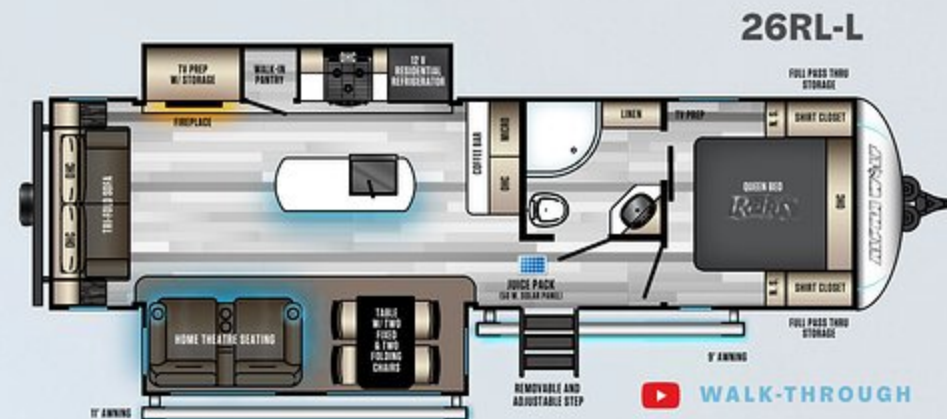

26RL-L

[WALK-THROUGH](#)

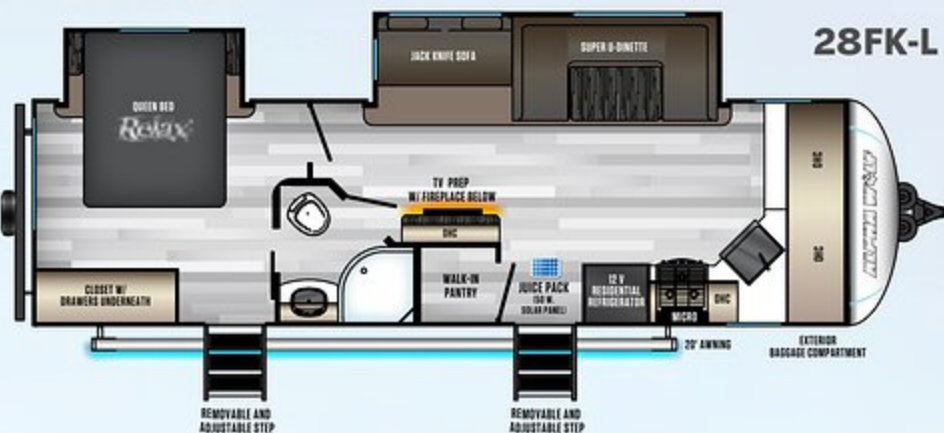

28FK-L



30DBH-L

[WALK-THROUGH](#)

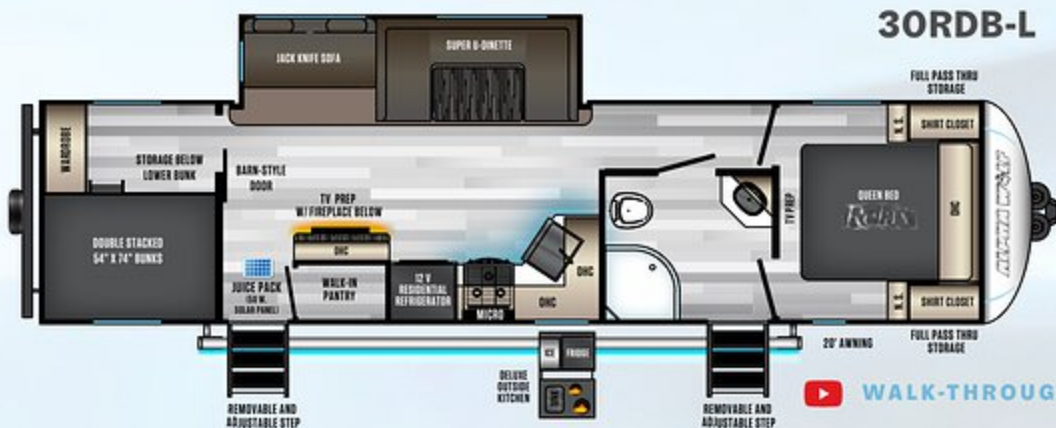

30RDB-L

[WALK-THROUGH](#)



33BH-L

[WALK-THROUGH](#)

ALPHA WOLF "TWELVE PACK" FEATURES

- One Piece Fiberglass, Gel-Coated, Front Cap With LED Strip Lights
- Alpha "Step Above" Entry Step
- Juice Pack Solar Power (50W Roof Mount Panel Series, Series 27 Battery, Battery Disconnect and Box, Volt Meter and 30 Amp Solar Charger)
- Wireless Rear Observation Camera With Microphone/Speaker And Night Mode Operation
- Power Tongue Jack
- Tufflex™ PVC Roof Membrane
- Cannon™ 12v High Efficiency 11 Cu. Ft. Residential Refrigerator
- Total Control® Smart RV Technology
- Smart Monitor Panel
- Zebra Shades In Main Living Area
- Oversized 15,000 BTU Ducted Air Conditioner
- 200w Ceiling Mounted Sub Woofer

LIMITED PACKAGE

* OPTIONAL PACKAGE. NOT ALL ITEMS AVAILABLE ON ALL MODELS.
SEE PARTICIPATING DEALERS FOR DETAILS.



"Blackout" Kitchen Appliance and Hardware Package



"Zebra Shades" In Main Living Area
(Light Filtering with Blackout Capability)



Rear Observation Camera with
Bluetooth Connectivity and Operation



Dual Port USB Charging Stations
(Multiple Locations in Living, Kitchen,
Bed and Bunk Area)



Commercial Grade Spring Spout
Kitchen Faucet with Pull-out Sprayer

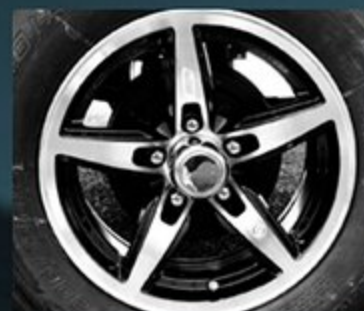

Aluminum Rims



8" Ceiling Mounted, 200W
Subwoofer with Accent Lighting

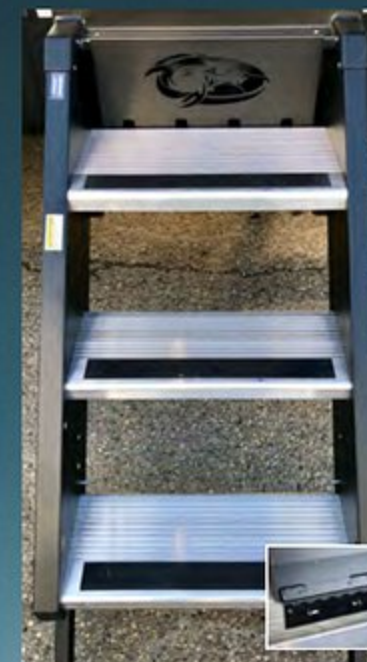

Cherokee Exclusive Exterior Step[s] with
Oversized Landing, 600LB. Capacity,
Quick Release and Kick Plate



LP Quick Connect for Optional Bumper
Mounted Swing Arm Grill



Slam Latch Compartment Doors
with "Safety Stay" Magnet Technology



"Total Control" Wireless Operation
of Auto Leveling, Multiple Light Zones,
Awning[s], Monitor Panel and All Slides



High Gloss Gel Coated Front Cap



100% Safety Glass Entry Door with
Dark Tint, Friction Hinge,
Viewing Window and Shade Prep



Residential, Oversized Farm Style
Kitchen Sink with Flush Mount Cover



"Clean Sweep" Floor Design
(No Heat Vents)



Cannon™ 12V, High Efficiency,
11 Cubic Foot Residential
Refrigerator with Travel Lock

ALPHA WOLF STANDARDS & OPTIONS

WEATHER GUARD PACKAGE

(Not all items available on all models)

- + Armored Underbelly Tank Enclosure and Forced Air Heat to All Holding Tanks
- + Oversized Bathroom Attic Fan for Increased Interior Air Flow
- + Seamless Roofing Membrane with Heat Reflectivity
- + High Capacity Electric Fireplace (5,200 BTU's) with Multiple Heat and Fan Settings with Remote
- + Supersized Air Conditioning Unit (15,000 BTU) with Immediate Quick Cool Dump Feature
- + High Efficiency "Super H" Duct Pattern and Cooling System
- + Upgraded 2" Thick Laminated Exterior Walls with Block Foam Insulation
- + Insulator Series (Non-Conductive Material) Wood Roof and Floor Superstructure

LIMITED PACKAGE

(Not all items available on all models)

- + Blackout™ Kitchen Appliance and Hardware Package
- + Cannon™ 12V, High Efficiency, 11 Cubic Foot Residential Refrigerator with Travel Lock
- + Total Control™ for Wireless Operation of Multiple Light Zones, Awning, Monitor Panel and All Slides
- + Zebra Shades™ (Light Filtering with Blackout Capability) In Main Living Area
- + Rear Observation Camera with Bluetooth Connectivity and Operation
- + Aluminum Rims
- + Commercial Grade Spring Spout Kitchen Faucet with Pull-out Sprayer
- + High Gloss Gel Coated Front Cap
- + Cherokee Exclusive Exterior Step(s) with Oversized Landing, 600LB. Capacity, Quick Release and Kick Plate
- + 8" Ceiling Mounted, 200W Subwoofer with Accent Lighting.

- + Residential, Oversized Farm Style Kitchen Sink with Flush Mount Cover
- + LP Quick Connect for Optional Bumper Mounted Swing Arm Grill
- + 100% Safety Glass Entry Door with Dark Tint, Friction Hinge, Viewing Window and Shade Prep
- + Slam Latch Compartment Doors with "Safety Stay" Magnet Technology
- + Dual Port USB Charging Stations (Multiple Locations in Living, Kitchen, Bed and Bunk Area)
- + Clean Sweep™ Floor Design (No Heat Vents)

CONVENIENCE PACKAGE

(Not all items available on all models)

- + Dual Zone, Bluetooth Stereo, Optimized for USB Flash Drives, iPods and Other MP3 Players
- + Large Exterior Folding Assist Grab Handle (Main Entry)
- + Laser Blue Ambient Interior Accent Lighting
- + Outside Shower with Hot and Cold Water
- + Power Front Jack with Light
- + Quick Clean Waste Tank Sprayer
- + Seamless Counter Tops Throughout
- + Tire Pressure Safety Sensors
- + LED Interior Lighting Package
- + Super-Plush Evergreen Mattress
- + Deluxe Bedding Package
- + Individual Reading Lights at Bed
- + Full Under Bed Storage with Strut Lift Assist
- + Pleated Shades in Bedroom and Bunkroom
- + Bedroom TV Prep
- + Shower/Tub Skylight
- + Porcelain Stool with Water Jet Assist and Foot Flush
- + Oversized Lav Sink
- + Motion Sensing Night Light in Bathroom

- + Deluxe Furniture Pack
- + Smart Monitor Panel with Smart Phone Bluetooth Connectivity
- + Large Pantry
- + Hand Sanitizer Station at Kitchen Sink
- + Butcher Block Style Cutting Board and Backsplash in Kitchen
- + (2) Fixed and (2) Foldable Free Standing Dinette Chairs with Seat Storage (26RK, 26RL)
- + Booth Dinette with Pots and Pans Drawers (Where Applicable)
- + "ToughBend" Rigid Skirt Metal Design
- + Dual Power Awnings (26RL)
- + Motion Sensing Lights in Pass Thru
- + Convenience Light at Utility Center
- + LED Exterior Lighting Package
- + Outside TV prep with Outlet and Mounting Bracket
- + Leash Latch Pet Safety Technology
- + 5/8" Tongue and Groove Plywood Floor Decking
- + 1x Engineered Wood "SuperTruss" Roof Structure with 3/8" Decking
- + 30AMP Marine Style Power Cord
- + Water Source and Sink for All Outside Kitchens

OPTIONS

- + Alpha Wolf Swing Arm Style Bumper Mount Grill
- + Large Residential Size LED TV
- + Rear Storage Travel Rack
- + Juice Pack - 50W Roof Mount Solar Panel (Expandable to 500W), Series 27 Battery, Battery Box, Battery Disconnect, Volt Meter and 30AMP Solar Charger (Mandatory)
- + Juice Pack Expansion Kit (100W Panel)
- + 4-Corner Power Stabilizer Jacks

A full-page photograph of a family hiking through a field of tall grass and wildflowers. In the foreground, a man with a beard and sunglasses carries a young boy on his shoulders. The boy is wearing a blue cap and sunglasses. In the background, a woman carries a young girl on her back. The girl is wearing a pink shirt and sunglasses. The scene is set in a lush, green field with mountains in the distance.

WE BUILD VACATIONS ONE ALPHA WOLF AT A TIME.

We would love to show you how different your camping experience can be with us at your side. Never feel alone on the road again. Join the pack today and let Alpha Wolf show you the outdoors you've been missing.

24/7 EMERGENCY ROADSIDE ASSISTANCE WITH VEHICLE PURCHASE*

TOWING
JUMP-STARTS
TIRE CHANGES
FLUID DELIVERY
LOCKOUT
SERVICE

WINCH-OUT
MOBILE MECHANIC
TECHNICAL
SUPPORT
DEALER LOCATOR
SERVICES



*VALID FOR 1 YEAR FROM DATE OF PURCHASE



PRE-DELIVERY INSPECTION FACILITY

20,000 square feet of quality assurance. The bare essentials for a premium product. This state-of-the-art facility gives immediate daily feedback to production for quality assurance in every unit built.

Specification Definitions :: GVWR (Gross Vehicle Weight Rating) - is the maximum permissible weight of the unit when fully loaded. It includes all weights, inclusive of all fluids, cargo, optional equipment and accessories. For safety and product performance do NOT exceed the GVWR. // **GAWR (Gross Axle Weight Rating)** - is the maximum permissible weight, including cargo, fluids, optional equipment and accessories that can be safely supported by a combination of all axles. // **UVW (Unloaded Vehicle Weight)** - is the typical weight of the unit as manufactured at the factory. It includes all weight at the unit's axle(s) and tongue or pin and LP Gas. The UVW does not include cargo, fresh potable water, additional optional equipment or dealer installed accessories. *Estimated average based on standard build optional equipment. // **CCC (Cargo Carrying Capacity)** - is the amount of weight available for fresh potable water, cargo, additional optional equipment and accessories. CCC is equal to GVWR minus UVW. Available CCC should accommodate fresh potable water (8.3 lbs per gallon). Before filling the fresh water tank, empty the black and gray tanks to provide for more cargo capacity. ** Estimated average based on standard build optional equipment. // Each Forest River RV is weighed at the manufacturing facility prior to shipping. A label identifying the unloaded vehicle weight of the actual unit and the cargo carrying capacity is applied to every Forest River RV prior to leaving our facilities. The load capacity of your unit is designated by weight, not by volume, so you cannot necessarily use all available space when loading your unit. // All information contained in this brochure is believed to be accurate at the time of publication. However, during the model year, it may be necessary to make revisions and Forest River, Inc., reserves the right to make all such changes without notice, including prices, colors, materials, equipment and specifications as well as the addition of new models and the discontinuance of models shown in this brochure. Therefore, please consult with your Forest River dealer and confirm the existence of any materials, design or specifications that are material to your purchase decision. Litho. U.S.A. FOR 1711 P&W: 2019.10.10

Alpha Wolf Warranty. Our promise to you.

FOR DETAILS ON ALPHA WOLF'S COMPLETE WARRANTY PROGRAM, SEE YOUR ALPHA WOLF DEALER. When it comes to backing products with the same quality and commitment it does when it begins the manufacturing process, the only name you have to remember when you're looking for a recreational vehicle is Alpha Wolf. Alpha Wolf offers the following additional limited warranties to the original purchasers. Consult written warranty for details.

1. Five-year roof warranty (Excludes Hard Sides). 2. Twenty-five-year floor warranty. 3. Five-year frame warranty. 4. Five-year tent warranty. 5. Ten-year torsion axle warranty. 6. Limited lifetime warranty of lifter system (Excludes Hard Sides).

CUSTOMER SATISFACTION



www.ForestRiverBuyLocal.com

FREE MEMBERSHIP
to Forest River Owners' Group

www.forestriverfrog.com



CHEROKEE'S ALPHA WOLF TEAM IS AN INCUBATOR WHERE NEW IDEAS THRIVE
AND FLOURISH AS WE STRIVE TO ADAPT TO THE EVER-CHANGING RV MARKET
AND CONSUMER QUALITY DEMANDS.

We are innovators, entrepreneurs, creators, designers, and visionaries working together for one common goal...happy campers! Our commitment goes beyond the manufacturing process as we invest in creating exceptional life moments of laughter and joy for our customers.



Learn More
Scan this barcode using
a QR Reader on your
smart phone to learn
more about Forest River.



A Berkshire Hathaway company

WWW.FORESTRIVERINC.COM

YOUR ALPHA WOLF DEALER