

FLAGSTAFF
MAC, LTD, SE, HARD SIDE
& HIGH WALL TENT CAMPERS

Flagstaff

MAC, LTD, SE, HARD SIDE & HIGH WALL TENT CAMPERS

PROVIDING OUTDOOR FUN SINCE 1974.



Limited

TIME TO RETIRE THE FAMILY TENT? When it is time to retire the trusty family tent because you are tired of sleeping on the hard ground, look no further than the Flagstaff LTD Tent Camper. Light on frills but an emphasis on quality and construction. The LTD is our entry-level line of tent campers that come with a limited lifetime warranty on the lift system and a 5 year tent warranty. Oh, and don't forget the standard heated mattresses that will keep you warm and comfortable on those chilly Fall nights.

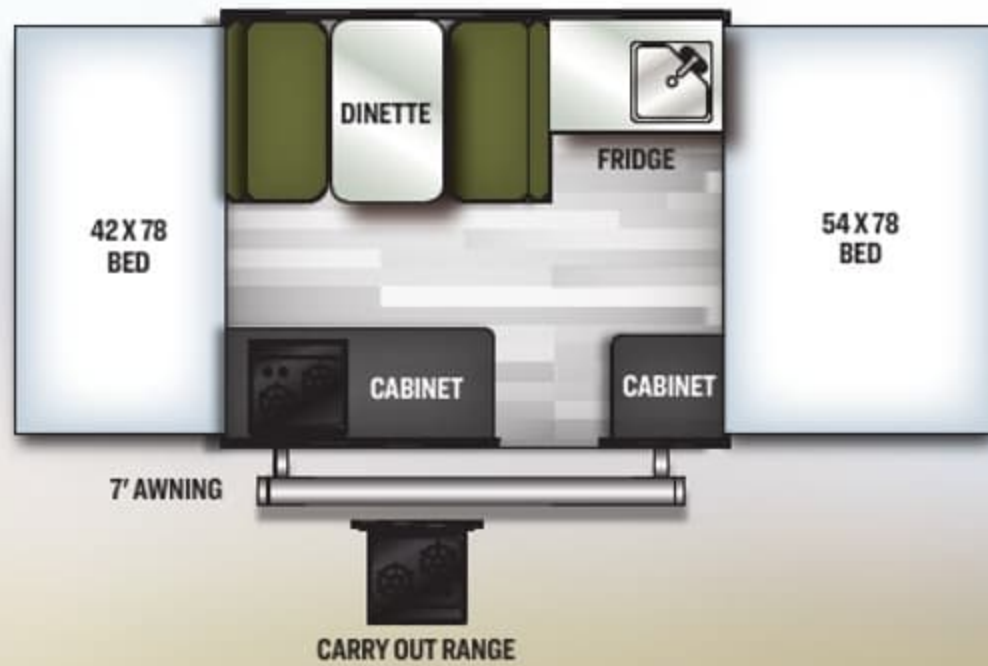

176LTD
LIMITED

UVW: 1465 HITCH: 162 AXLE: 1284 CCC: 793
 BOX SIZE: 8' CLOSED LENGTH W/ HITCH: 12' 4" CLOSED HEIGHT: 5' 4"
 OPEN LENGTH: 17' 2" FRESH: 10 GRAY: N/A BLACK: N/A



206LTD

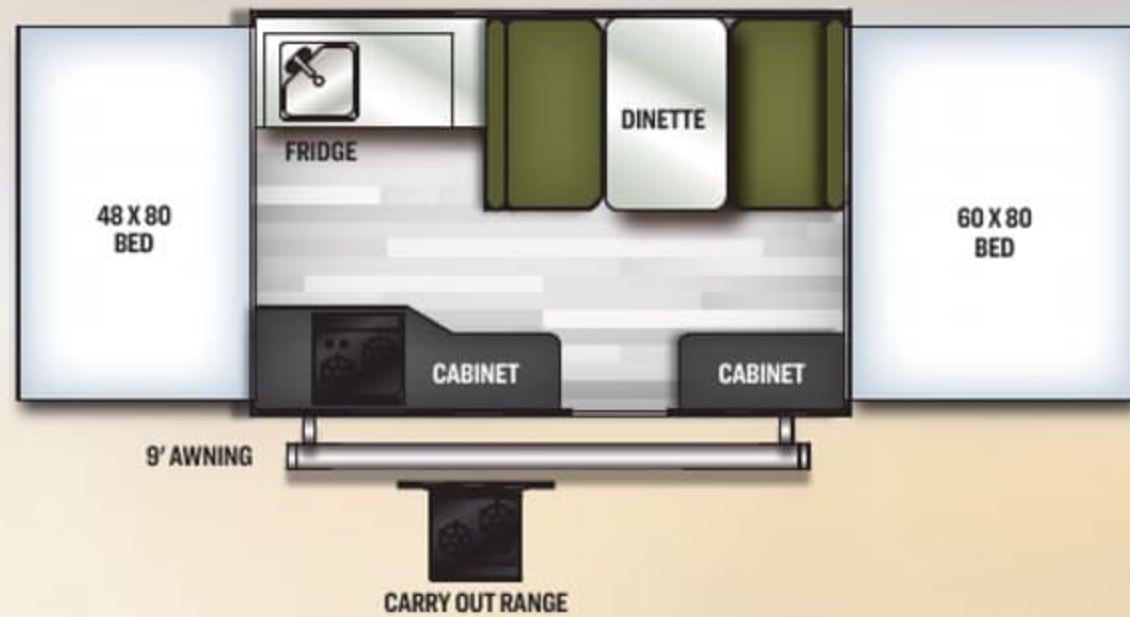

206LTD
LIMITED

UVW: 1608 HITCH: 195 AXLE: 1394 CCC: 683
 BOX SIZE: 10' CLOSED LENGTH W/ HITCH: 14' 4" CLOSED HEIGHT: 5' 4"
 OPEN LENGTH: 20' 2" FRESH: 10 GRAY: N/A BLACK: N/A

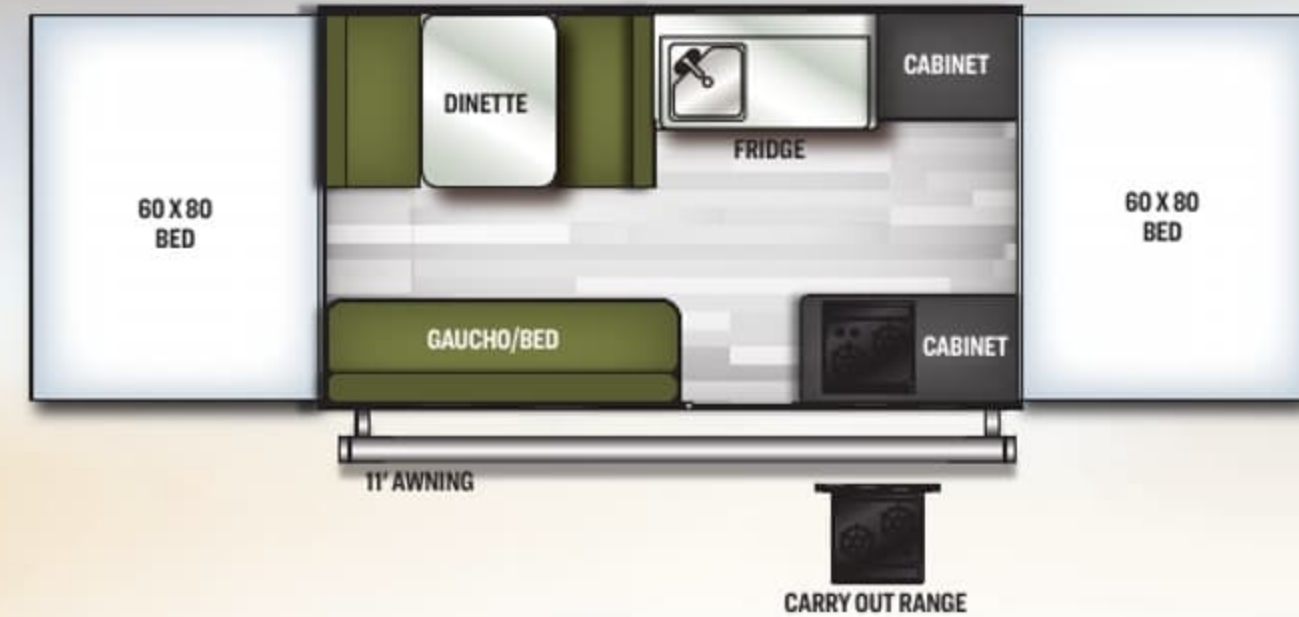

228LTD
LIMITED

UVW: 2049 HITCH: 225 AXLE: 1805 CCC: 1176
 BOX SIZE: 12' CLOSED LENGTH W/ HITCH: 16' 5" CLOSED HEIGHT: 5' 6"
 OPEN LENGTH: 23' 1" FRESH: 10 GRAY: N/A BLACK: N/A

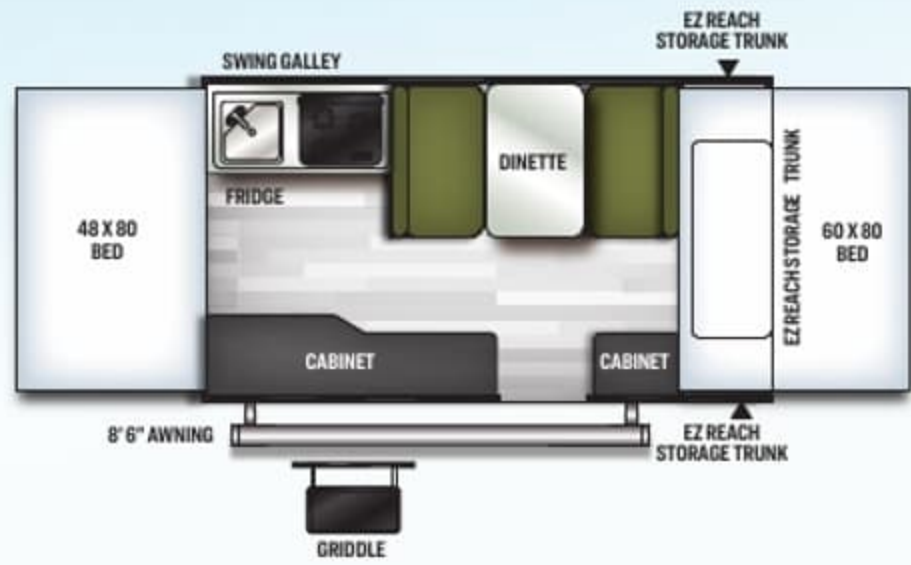

206M
MAC

UVW: 2204 HITCH: 240 AXLE: 1945 CCC: 1036
 BOX SIZE: 12' CLOSED LENGTH W/ HITCH: 17' 3" CLOSED HEIGHT: 5' 6"
 OPEN LENGTH: 20' 2" FRESH: 20 GRAY: N/A BLACK: N/A

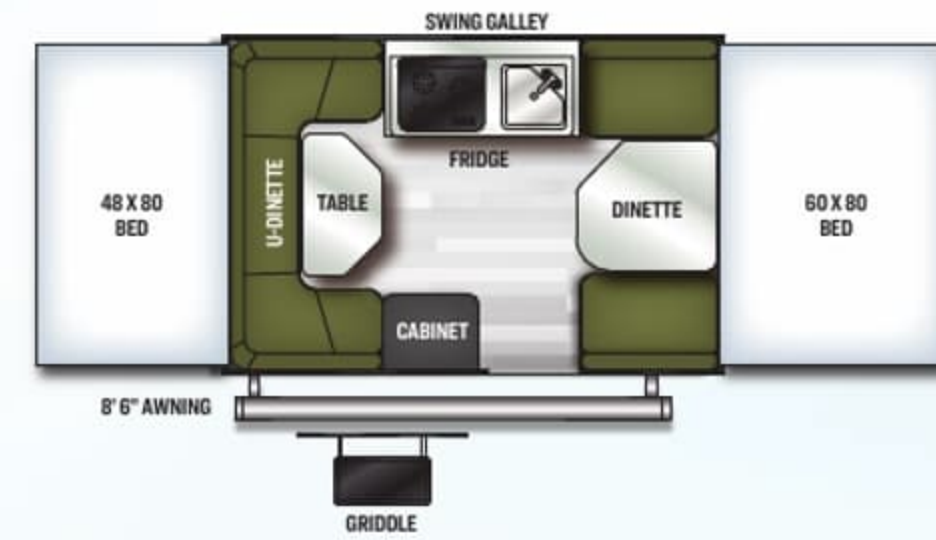

208
MAC

UVW: 1896 HITCH: 255 AXLE: 1622 CCC: 1359
 BOX SIZE: 10' CLOSED LENGTH W/ HITCH: 15' 7" CLOSED HEIGHT: 5' 6"
 OPEN LENGTH: 20' 2" FRESH: 20 gal GRAY: N/A BLACK: N/A

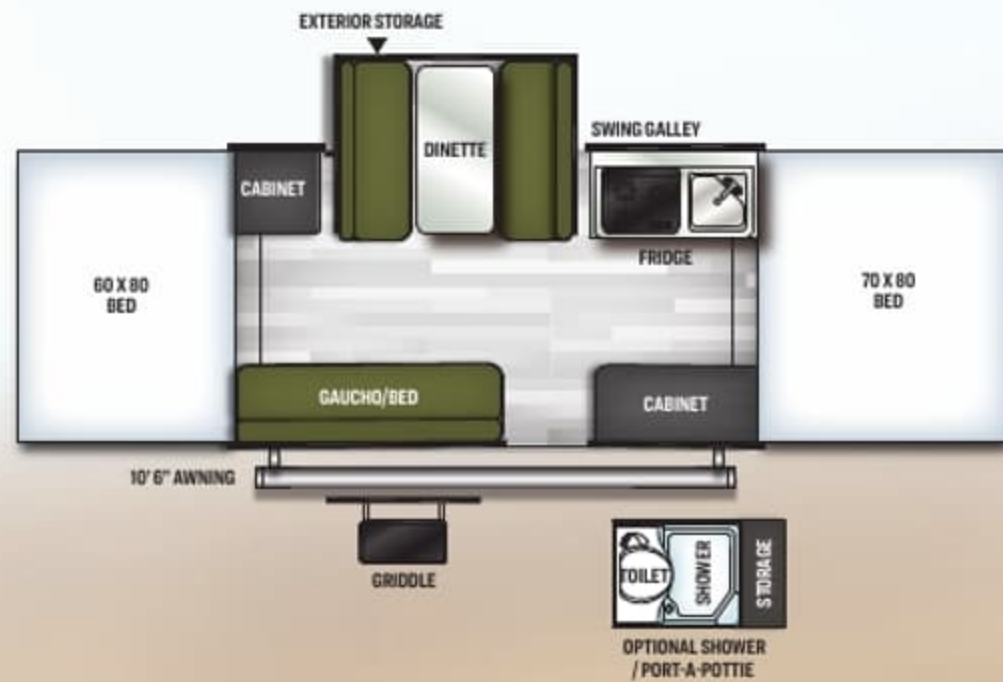

228D
MAC

UVW: 2439 HITCH: 263 AXLE: 2157 CCC: 824
 BOX SIZE: 12' CLOSED LENGTH W/ HITCH: 17' 6" CLOSED HEIGHT: 5' 6"
 OPEN LENGTH: 23' 11" FRESH: 20 GRAY: N/A BLACK: N/A

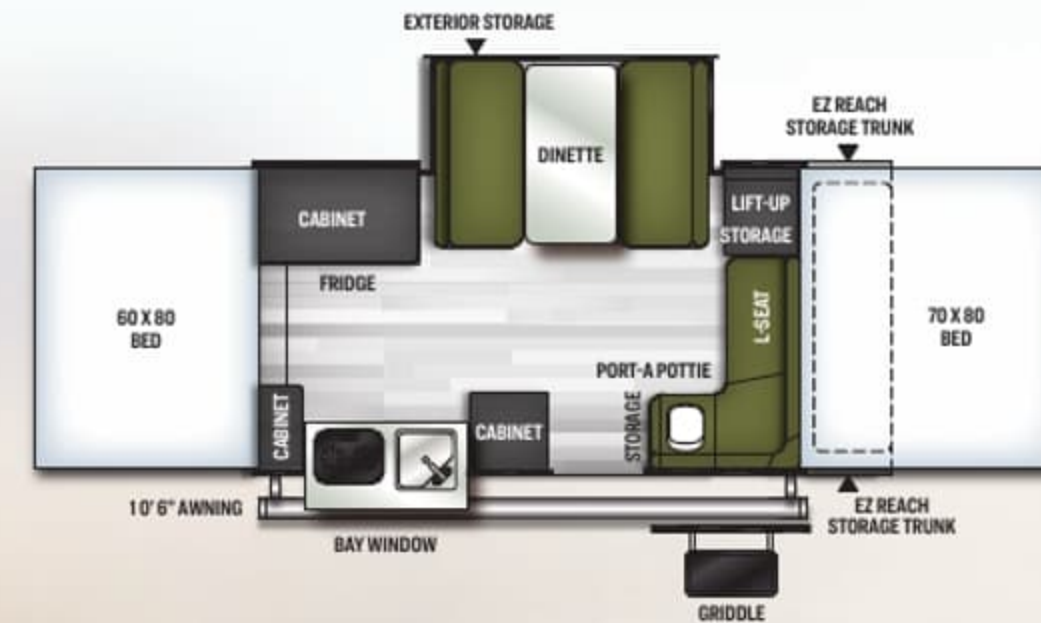

425M
MAC

UVW: 2654 HITCH: 295 AXLE: 2340 CCC: 641
 BOX SIZE: 12' CLOSED LENGTH W/ HITCH: 19' 1" CLOSED HEIGHT: 6'
 OPEN LENGTH: 23' 9" FRESH: 20 GRAY: N/A BLACK: N/A

MAC

MAKING YOUR INVESTMENT GO A LONG WAY. Flagstaff takes pride in packing the most value possible into our MAC series. Finding the perfect fit for the specific needs of your active family is made easier by the wide variety of floor plans available. While each model comes standard with many features, you still have flexibility to incorporate as many options as you choose to fit your camping preferences.



425M



228BHSE



Sports Enthusiast Package

WELCOME TO THE FLAGSTAFF SPORTS ENTHUSIAST PACKAGE (SE), a camper designed for active couples and families. Whatever the preference; mountain biking, canoeing, paddle boarding or surfing, the SE camping trailers are designed to allow you to make the most of your outdoor experience. Built for 21st century camping. The SE package includes a AM/FM stereo with Bluetooth technology, USB auxiliary ports for streaming and recharging, LED lighting, a WiFi Ranger WiFi booster and a 100W solar panel with 1000W inverter to supply renewable energy to your batteries while camping "off the grid."

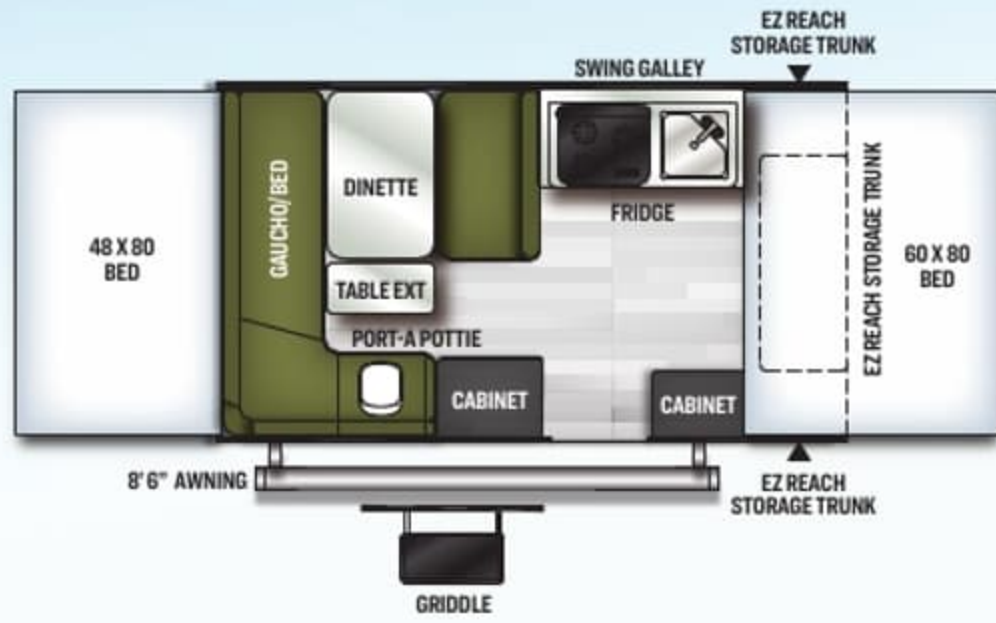

206STSE
SE

UVW: 2180 HITCH: 254 AXLE: 1907 CCC: 724
BOX SIZE: 10' CLOSED LENGTH W/ HITCH: 17' 6" CLOSED HEIGHT: 5' 11"
OPEN LENGTH: 20' 4" FRESH: 20 GRAY: N/A BLACK: N/A

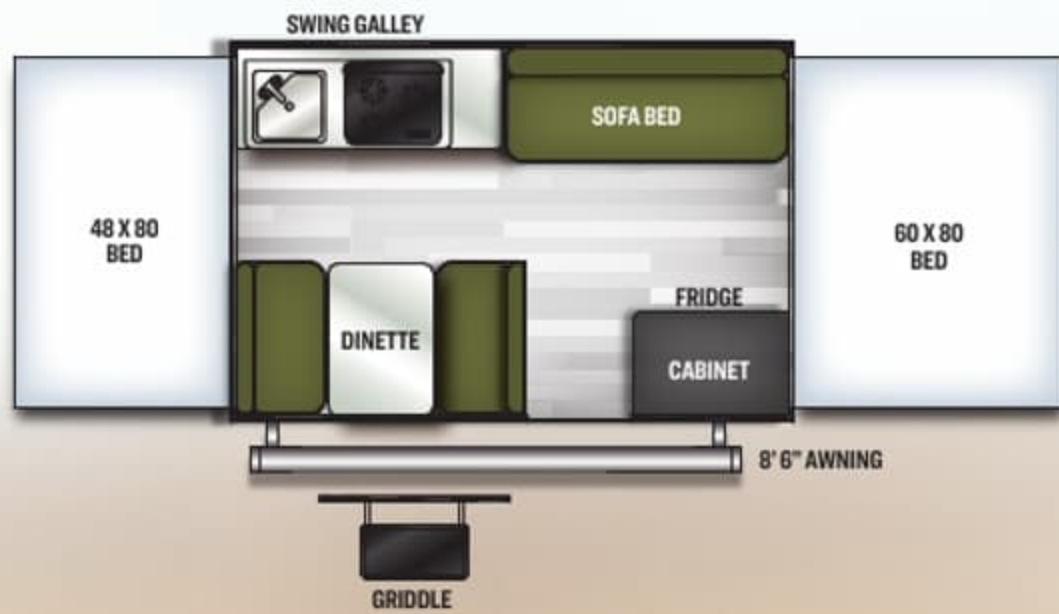

207SE
SE

UVW: 2076 HITCH: 234 AXLE: 1823 CCC: 808
BOX SIZE: 10' CLOSED LENGTH W/ HITCH: 15' 8" CLOSED HEIGHT: 5' 11"
OPEN LENGTH: 20' 1" FRESH: 20 GRAY: N/A BLACK: N/A

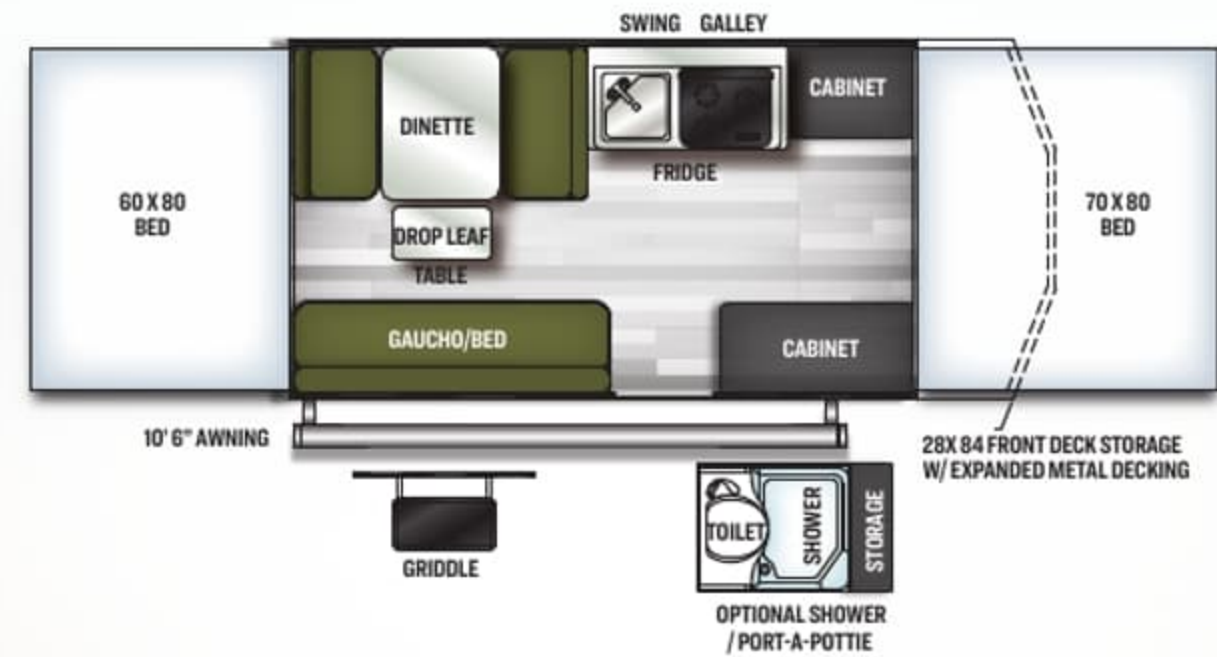

228BHSE
SE

UVW: 2559 HITCH: 338 AXLE: 2202 CCC: 1279
BOX SIZE: 12' CLOSED LENGTH W/ HITCH: 19' 4" CLOSED HEIGHT: 6' 2"
OPEN LENGTH: 23' 11" FRESH: 20 GRAY: N/A BLACK: N/A

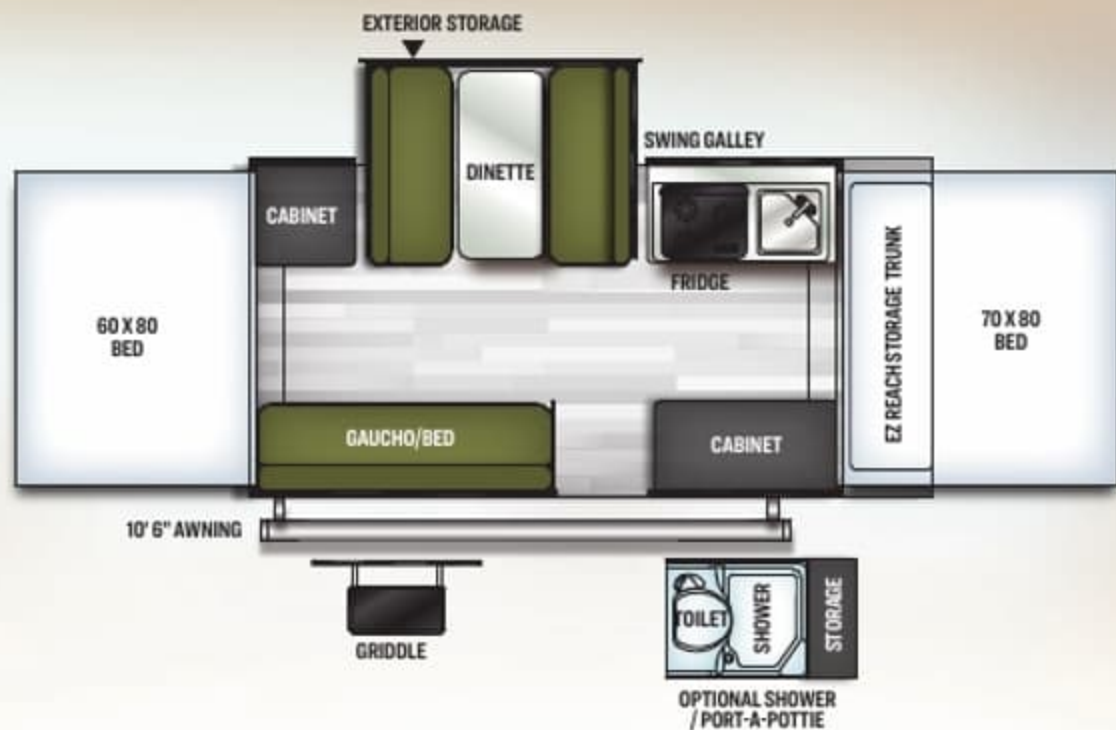

228SE
SE

UVW: 2849 HITCH: 375 AXLE: 2455 CCC: 1026
BOX SIZE: 12' CLOSED LENGTH W/ HITCH: 19' 4" CLOSED HEIGHT: 6' 2"
OPEN LENGTH: 23' 11" FRESH: 20 GRAY: N/A BLACK: N/A

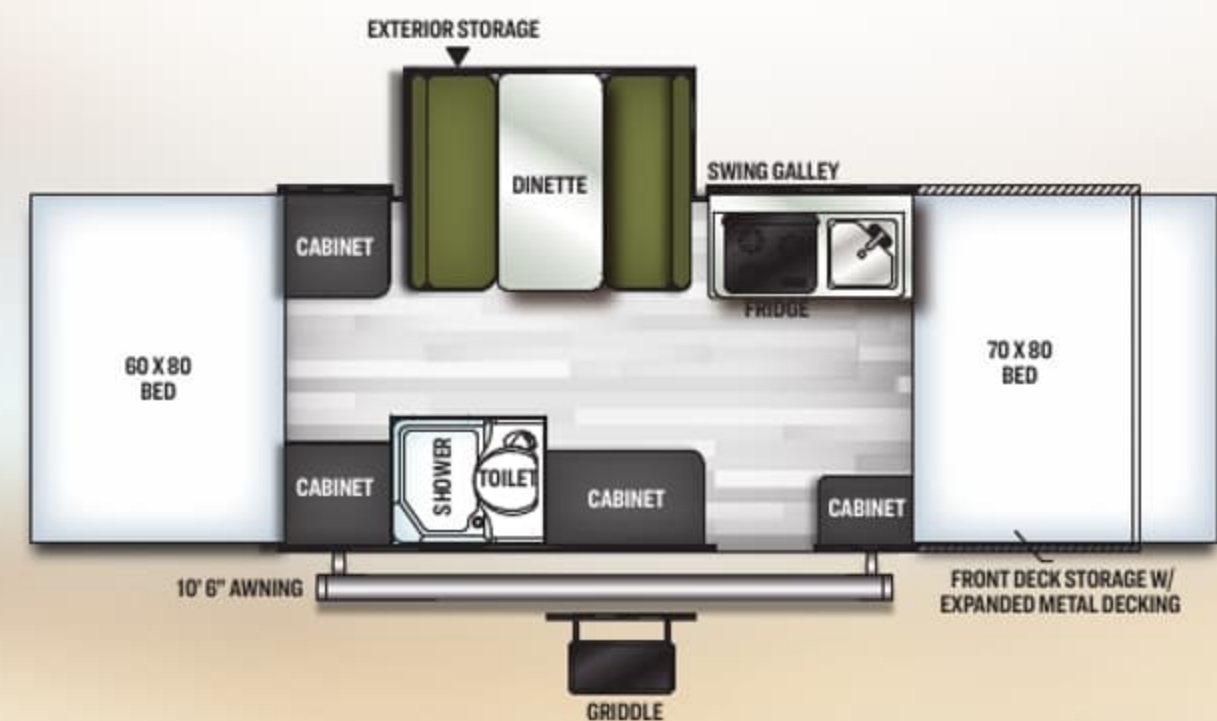

23SCSE
SE

UVW: 2933 HITCH: 294 AXLE: 2620 CCC: 861
BOX SIZE: 12' CLOSED LENGTH W/ HITCH: 22' 3" CLOSED HEIGHT: 6' 2"
OPEN LENGTH: 26' 5" FRESH: 20 GRAY: N/A BLACK: N/A



HW29SC

High Wall

WE MAKE CAMPING COMFORTABLE. We have designed this series for the camping family who wants the refinement of larger vacationing units in a light-weight camper. Ample counterspace, upgraded appliances, convenient, easy opening decorative curtains provide a wide view of the surroundings and tasteful interiors make this camper a gorgeous option to experience.

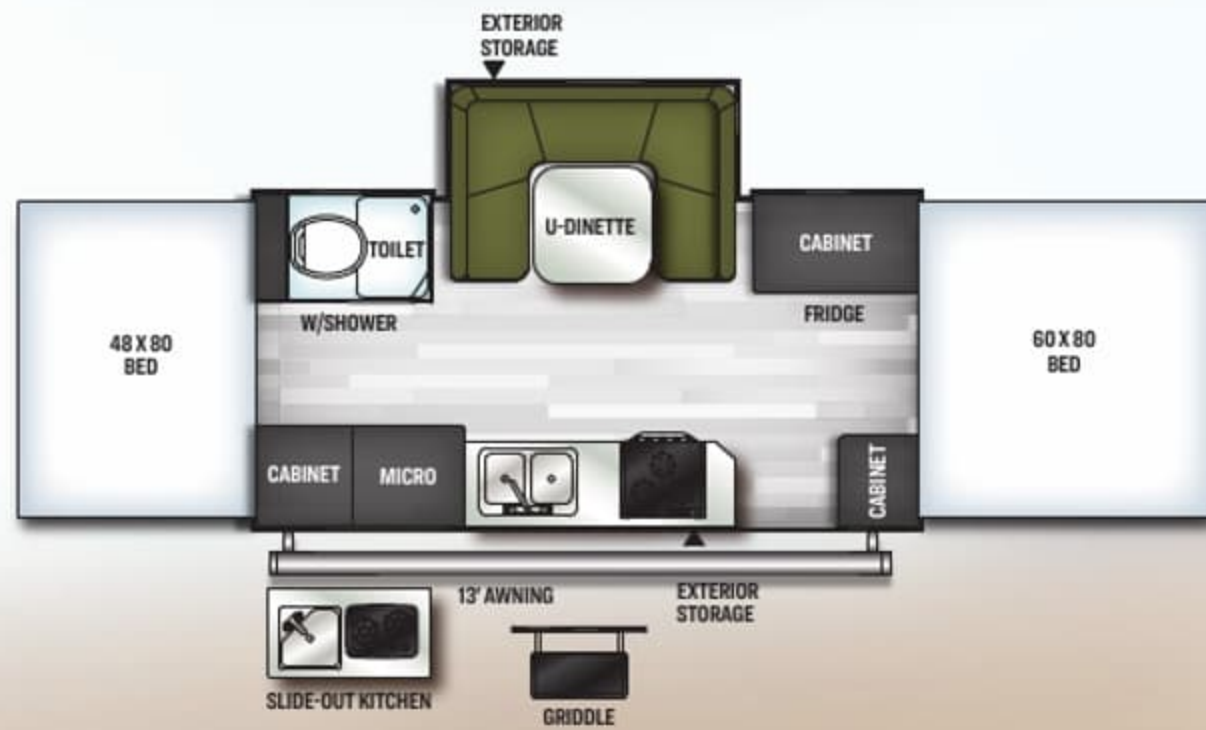

HW27KS

HIGH WALL

UVW: 3334 HITCH: 380 AXLE: 2916 CCC: 546
 BOX SIZE: 14' CLOSED LENGTH W/ HITCH: 19' 6" CLOSED HEIGHT: 6' 7"
 OPEN LENGTH: 25' 9" FRESH: 20 GRAY: 12 BLACK: 12

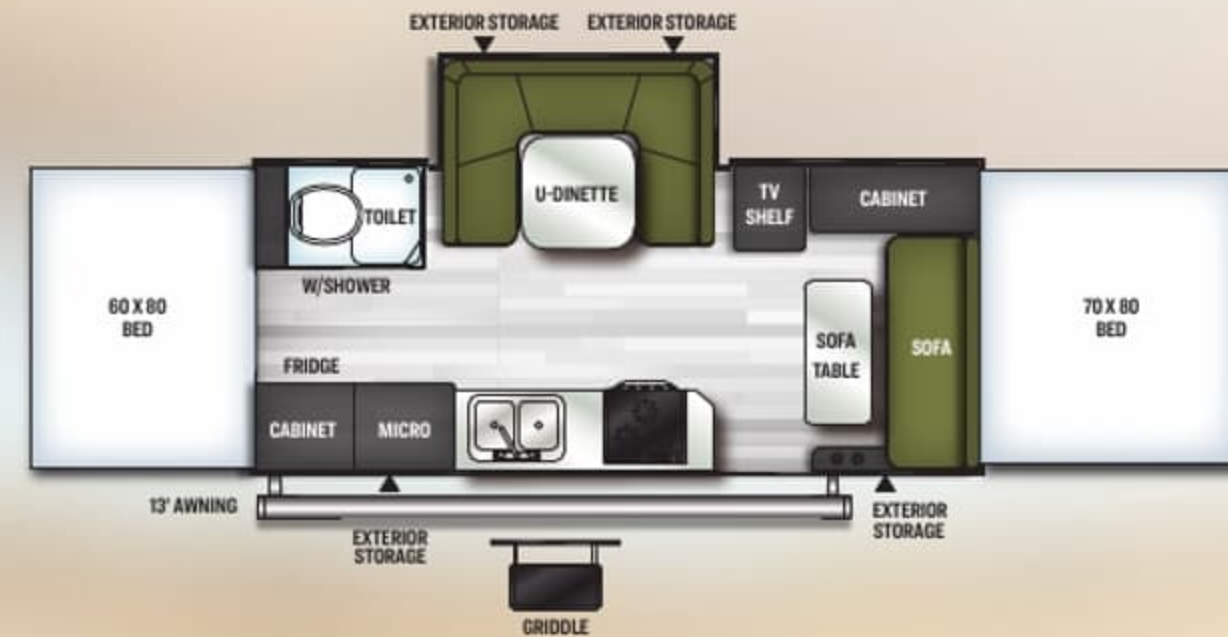

HW29SC

HIGH WALL

UVW: 3721 HITCH: 371 AXLE: 3312 CCC: 1278
 BOX SIZE: 16' CLOSED LENGTH W/ HITCH: 21' 6" CLOSED HEIGHT: 6' 9"
 OPEN LENGTH: 27' 9" FRESH: 20 GRAY: 12 BLACK: 12



T12RBST



Hard Sides

QUITE POSSIBLY THE BEST OF BOTH WORLDS. When you combine the solid exterior of a travel trailer with a tent camper, you get the Flagstaff Hard Side Series, giving your camping experience the best of both worlds. Bringing a smooth fiberglass vacuum bonded exterior with a quick, easy set up, while retaining the towing and storage advantages of a tent camper, the Hard Side camper is the perfect blend.

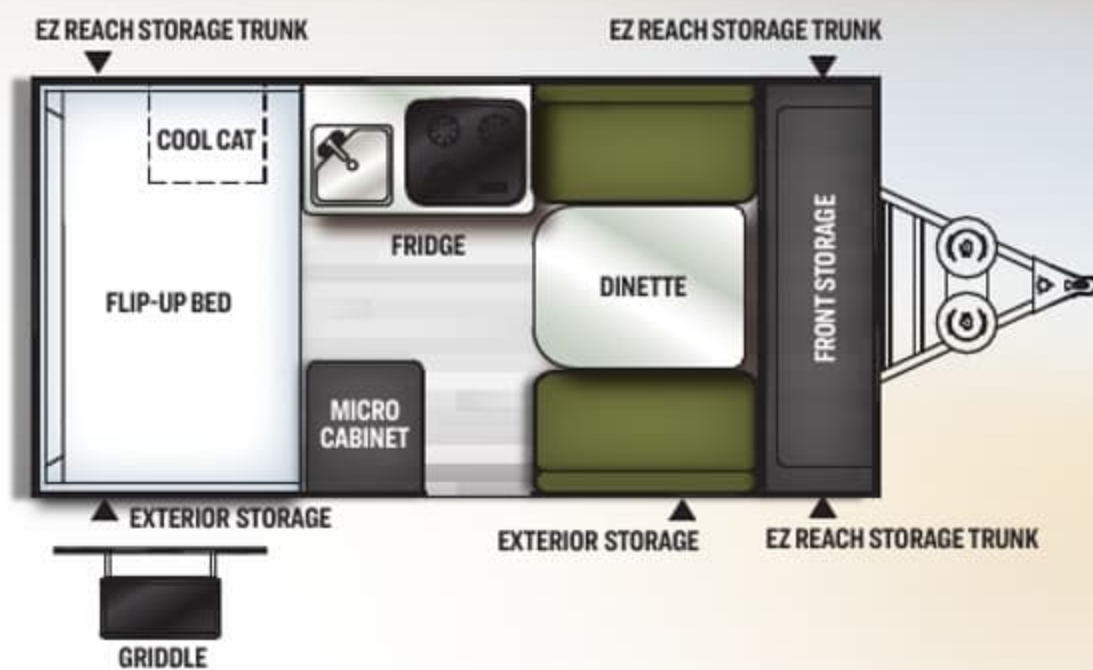

T12RBST
HARD SIDE

UVW: 2120 HITCH: 284 AXLE: 1798 CCC: 1164
 BOX SIZE: 12' CLOSED LENGTH W/ HITCH: 19' 2" CLOSED HEIGHT: 5' 1"
 FRESH: 20 GRAY: N/A BLACK: N/A



Tent Camper Construction

- A** Three Stage Double Arm Lifter Posts (NA Hard Side)
- B** Fiberglass Vacuum Bonded Radius Roof w/ No Center Seam (NA Hard Side)
- C** Five-Piece Vinolon Supreme Tenting (NA Hard Side)
- D** E-Z Crank Down Stabilizer Jacks w/ Sand Pads
- E** Full Perimeter Aluminum Bed Frames (NA Hard Side)
- F** Plywood Bunk Ends (NA Hard Side)
- G** Seven-Way Pigtail Wiring
- H** Under Floor 20 Gallon Fresh Water Tank (LTDs 10 Gallon Above Floor)

- I** Powder Coated Tubular Steel Frame
- J** Powder Coated Rafter Poles and Bed Bows (NA Hard Side)
- K** Air Conditioner Reinforcing Laminated Into Roof (NA Hard Side)
- L** Nitrogen Filled Steel Belted Radial Tires
- M** Easy Lube Axle System (Except LTDs)
- N** Smooth Fiberglass Vacuum Bonded Exterior (NA on Macs & SEs)
- O** One-Piece Door (Except Hard Side)
- P** Under Awning LED Lighting (Except LTD's & Hard Sides)



TORFLEX
RUBBER TORSION SUSPENSION AXLES

Dexter Torflex Axles

- (STANDARD ON HIGH WALL AND HARD SIDE MODELS)**
- Independent wheel suspension and self-damping action
 - Rubber cushioning eliminates metal-to-metal contact.
 - Forged torsion arm for maximum strength

Most models are also equipped with E-Z Lube® System and Nev-R-Adjust® Brakes.



Hand-checked for the best quality.

CAI (CUSTOMER ASSURANCE INSPECTION) Each Flagstaff production line has a complete online PDI staff that is responsible for double checking all function and code test on every Flagstaff Trailer. CAI is an independent facility that takes Flagstaff trailers from each line and inspects them to ensure that the online PDI staff and system is functioning to the standards that Flagstaff has set along with all governing code groups. This ensures we are putting the best product into the hands of our selling dealers.



Flagstaff Warranty. Our Promise.

FOR DETAILS ON FLAGSTAFF'S COMPLETE WARRANTY PROGRAM, SEE YOUR FLAGSTAFF DEALER. When it comes to backing products with the same quality and commitment it does when it begins the manufacturing process, the only name you have to remember when you're looking for a recreational vehicle is Flagstaff. Flagstaff offers the following additional limited warranties to the original purchasers. Consult written warranty for details.

1. Five-year roof warranty (Excludes Hard Sides).
2. Twenty-five-year floor warranty.
3. Five-year frame warranty.
4. Five-year tent warranty.
5. Ten-year torsion axle warranty.
6. Limited lifetime warranty of lifter system (Excludes Hard Sides).



24/7 EMERGENCY ROADSIDE ASSISTANCE WITH VEHICLE PURCHASE*

TOWING
JUMP-STARTS
TIRE CHANGES
FLUID DELIVERY
LOCKOUT
SERVICE

WINCH-OUT
MOBILE MECHANIC
TECHNICAL
SUPPORT
DEALER LOCATOR
SERVICES



*VALID FOR 1 YEAR FROM DATE OF PURCHASE



PRE-DELIVERY INSPECTION FACILITY

20,000 square feet of quality assurance. The bare essentials for a premium product. This state-of-the-art facility gives immediate daily feedback to production for quality assurance in every unit built.

CUSTOMER SATISFACTION



www.ForestRiverBuyLocal.com

FREE MEMBERSHIP
to Forest River Owners' Group

www.forestriverfrog.com



Specification Definitions :: GVWR (Gross Vehicle Weight Rating) - is the maximum permissible weight of the unit when fully loaded. It includes all weights, inclusive of all fluids, cargo, optional equipment and accessories. For safety and product performance do NOT exceed the GVWR. // **GAWR (Gross Axle Weight Rating)** - is the maximum permissible weight, including cargo, fluids, optional equipment and accessories that can be safely supported by a combination of all axles. // **UVW (Unloaded Vehicle Weight)** - is the typical weight of the unit as manufactured at the factory. It includes all weight at the unit's axle(s) and tongue or pin and LP Gas. The UVW does not include cargo, fresh potable water, additional optional equipment or dealer installed accessories. *Estimated average based on standard build optional equipment. // **CCC (Cargo Carrying Capacity)**** - is the amount of weight available for fresh potable water, cargo, additional optional equipment and accessories. CCC is equal to GVWR minus UVW. Available CCC should accommodate fresh potable water (8.3 lbs per gallon). Before filling the fresh water tank, empty the black and gray tanks to provide for more cargo capacity. ** Estimated average based on standard build optional equipment // Each Forest River RV is weighed at the manufacturing facility prior to shipping. A label identifying the unloaded vehicle weight of the actual unit and the cargo carrying capacity is applied to every Forest River RV prior to leaving our facilities. The load capacity of your unit is designated by weight, not by volume, so you cannot necessarily use all available space when loading your unit. // All information contained in this brochure is believed to be accurate at the time of publication. However, during the model year, it may be necessary to make revisions and Forest River, Inc., reserves the right to make all such changes without notice, including prices, colors, materials, equipment and specifications as well as the addition of new models and the discontinuance of models shown in this brochure. Therefore, please consult with your Forest River dealer and confirm the existence of any materials, design or specifications that are material to your purchase decision. Litho. U.S.A. FOR 1863 P&W: 2021.10.22

Look for our other popular lines of Flagstaff trailers.

YOUR **FLAGSTAFF** DEALER



FLAGSTAFF E-PRO



FLAGSTAFF FIFTH WHEELS



FLAGSTAFF TRAVEL TRAILERS



Learn More
Scan this barcode using
a QR Reader on your
smart phone to learn
more about Forest River.



A Berkshire Hathaway company.

FOLLOW THE JOURNEY



Follow us on these media platforms @FlagstaffRvs

201 WEST ELM MILLERSBURG, IN 46543
WWW.FORESTRIVERINC.COM/FLAGSTAFF 574.642.2640