

ROLLING ADVENTURE



BIGHORN
TRAVELER

 BROUGHT TO YOU BY
HEARTLAND

ROLLING ADVENTURE



BIGHORN
TRAVELER

BROUGHT TO YOU BY
HEARTLAND

TOP 5

EXTERIOR FEATURES

- 1 | "Store More" triple access door storage in main basement with 30% more storage
- 2 | MORryde strut-assisted "Step Above" folding aluminum tread entry staircase
- 3 | MORryde CRE3000 rubber suspension system with max vertical travel
- 4 | Lightweight Azdel laminated sidewalls with laminated slide-out and rear end walls
- 5 | MORryde 12V power cord reel mounted in front basement door space



BHTR 32RS

LENGTH: 36' 2" | **HEIGHT:** 13' 3" | **HITCH:** 2,120 LBS.
DRY: 11,043 LBS. | **GVWR:** 15,500 LBS. | **SLEEP CAPACITY:** 3-4

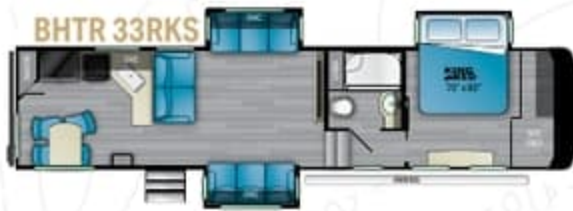

BHTR 33RKS

LENGTH: 37' 6" | **HEIGHT:** 13' 4" | **HITCH:** 3,475 LBS.
DRY: 10,910 LBS. | **GVWR:** 15,500 LBS. | **SLEEP CAPACITY:** 3-4



BHTR 35BK

LENGTH: 39' 0" | **HEIGHT:** 13' 4" | **HITCH:** 3,225 LBS.
DRY: 12,050 LBS. | **GVWR:** 15,500 LBS. | **SLEEP CAPACITY:** 3-4



BHTR 37RD

LENGTH: 40' 6" | **HEIGHT:** 13' 4" | **HITCH:** 2,780 LBS.
DRY: 12,545 LBS. | **GVWR:** 15,500 LBS. | **SLEEP CAPACITY:** 5-6



BHTR 37TB

LENGTH: 42' 5-1/4" | **HEIGHT:** 13' 4" | **HITCH:** 3,010 LBS.
DRY: 9,740 LBS. | **GVWR:** 16,000 LBS. | **SLEEP CAPACITY:** 7-8



BHTR 38FL

LENGTH: 42' 4" | **HEIGHT:** 13' 3" | **HITCH:** 2,970 LBS.
DRY: 13,450 LBS. | **GVWR:** 16,000 LBS. | **SLEEP CAPACITY:** 5-6

TOP 5 EXTERIOR FEATURES

- 1 | "Store More" triple access door storage in main basement with 30% more storage
- 2 | MORryde strut-assisted "Step Above" folding aluminum tread entry staircase
- 3 | MORryde CRE3000 rubber suspension system with max vertical travel
- 4 | Lightweight Azdel laminated sidewalls with laminated slide-out and rear end walls
- 5 | MORryde 12V power cord reel mounted in front basement door space



BHTR 32RS

LENGTH: 36' 2" | **HEIGHT:** 13' 3" | **HITCH:** 2,120 LBS.
DRY: 11,043 LBS. | **GVWR:** 15,500 LBS. | **SLEEP CAPACITY:** 3-4

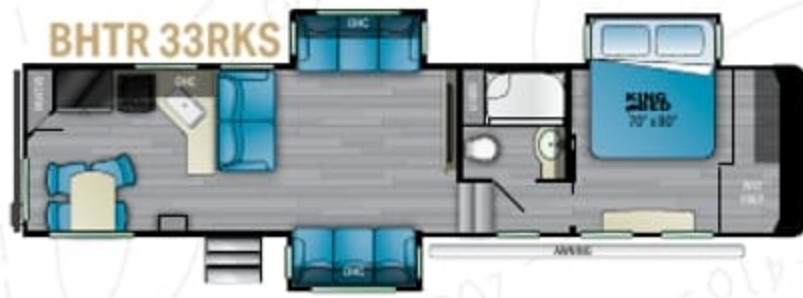

BHTR 33RKS

LENGTH: 37' 6" | **HEIGHT:** 13' 4" | **HITCH:** 3,475 LBS.
DRY: 10,910 LBS. | **GVWR:** 15,500 LBS. | **SLEEP CAPACITY:** 3-4



BHTR 35BK

LENGTH: 39' 0" | **HEIGHT:** 13' 4" | **HITCH:** 3,225 LBS.
DRY: 12,050 LBS. | **GVWR:** 15,500 LBS. | **SLEEP CAPACITY:** 3-4



BHTR 37RD

LENGTH: 40' 6" | **HEIGHT:** 13' 4" | **HITCH:** 2,780 LBS.
DRY: 12,545 LBS. | **GVWR:** 15,500 LBS. | **SLEEP CAPACITY:** 5-6



BHTR 37TB

LENGTH: 42' 5-1/4" | **HEIGHT:** 13' 4" | **HITCH:** 3,010 LBS.
DRY: 9,740 LBS. | **GVWR:** 16,000 LBS. | **SLEEP CAPACITY:** 7-8



BHTR 38FL

LENGTH: 42' 4" | **HEIGHT:** 13' 3" | **HITCH:** 2,970 LBS.
DRY: 13,450 LBS. | **GVWR:** 16,000 LBS. | **SLEEP CAPACITY:** 5-6



TOP 5 INTERIOR FEATURES

- 1 | "Triple Play" kitchens with solid surface countertops per floors plans (n/a 33RKS)
- 2 | "Barefoot Friendly" carpet free main and upper deck linoleum & marine flooring
- 3 | Oversized black stainless single basin farmhouse sink with front apron
- 4 | Dual wireless charging ports and dual Bluetooth speaker ports in every unit
- 5 | "Practical Pantry" floor to ceiling pantries in every kitchen of every floor plan



BHTR 37DB

LENGTH: 43' 0" | HEIGHT: 13' 4" | HITCH: 2,710 LBS.
 DRY: 13,650 LBS. | GVWR: 15,500 LBS. | SLEEP CAPACITY: 3-4



BHTR 37FB

LENGTH: 42' 4 1/8" | HEIGHT: 00' 0" | HITCH: TBD LBS.
 DRY: TBD LBS. | GVWR: TBD LBS. | SLEEP CAPACITY: 3-4



BHTR 39MB

LENGTH: 41' 10" | HEIGHT: 13' 3" | HITCH: 2,470 LBS.
 DRY: 13,210 LBS. | GVWR: 16,000 LBS. | SLEEP CAPACITY: 7-8





TOP 5 INTERIOR FEATURES

- 1 | "Triple Play" kitchens with solid surface countertops per floors plans (n/a 33RKS)
- 2 | "Barefoot Friendly" carpet free main and upper deck linoleum & marine flooring
- 3 | Oversized black stainless single basin farmhouse sink with front apron
- 4 | Dual wireless charging ports and dual Bluetooth speaker ports in every unit
- 5 | "Practical Pantry" floor to ceiling pantries in every kitchen of every floor plan



BHTR 37DB

LENGTH: 43' 0" | **HEIGHT:** 13' 4" | **HITCH:** 2,710 LBS.
DRY: 13,650 LBS. | **GVWR:** 15,500 LBS. | **SLEEP CAPACITY:** 3-4



BHTR 37FB

LENGTH: 42' 4 1/8" | **HEIGHT:** 00' 0" | **HITCH:** TBD LBS.
DRY: TBD LBS. | **GVWR:** TBD LBS. | **SLEEP CAPACITY:** 3-4

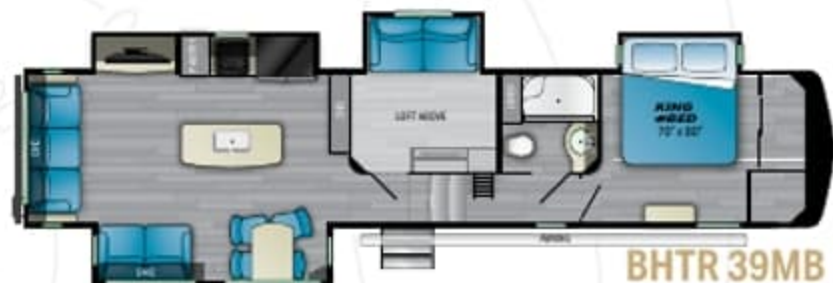

BHTR 39MB

LENGTH: 41' 10" | **HEIGHT:** 13' 3" | **HITCH:** 2,470 LBS.
DRY: 13,210 LBS. | **GVWR:** 16,000 LBS. | **SLEEP CAPACITY:** 7-8



BIGHORN TRAVELER DISCOVERY PACKAGE

- 50" LED flat screen TV with AM, FM, CD, and DVD stereo
- Padded vinyl headboard, mounted off the wall and backlit
- Gunmetal single basin stainless steel kitchen sink
- 1-piece fiberglass shower with glass shower door
- Maple Cabinetry with hidden hinges
- 1.6 Cu. Ft. stainless steel microwave
- Tri-fold sleep sofa and theatre seat
- Double height entry grab handle
- 5,000 BTU 40" electric fireplace
- 12V cold weather tank pads
- Recessed LED ceiling lights
- Ball bearing drawer glides
- Residential refrigerator
- King mattress
- 22" oven with 3-burner cooktop and tempered glass stove cover
- Aluminum framed upper deck with double-welded box tube aluminum
- Bluetooth speaker prep bracket mounted in main basement and bedroom

BIGHORN TRAVELER INTERSTATE PACKAGE

- Dual wireless charging stations in kitchen and bedroom
- 28,500 BTU ducted AC system with dual thermostats
- MORryde "Step Above" strut assisted entry step
- MOR/ryde CRE 3000 rubber suspension system
- 6-point "Level Up" hydraulic leveling system
- 7,000lb Dexter axles and NevR Adjust brakes
- 16" F range tires w/ aluminum style wheels
- MOR/ryde 12V detachable power cord reel
- Premium high gloss fiberglass sidewalls
- Upgraded exterior graphics with badge
- Partial paint fiberglass front cap
- Rear ladder with 300lb capacity
- Power awning w/ LED light strip
- Rear backup camera prep
- 32" LED Bedroom TV
- 2" Receiver hitch
- Spare tire and sliding rack

OPTIONAL EQUIPMENT UPGRADE

- 12 cu ft 4 door Gas / Electric Refer
- Generator Prep

SPECIAL FEATURES



Store-More Storage



MORryde detachable power cord reel

INTERIOR FABRIC DECOR OPTIONS



Cinderwood



Beechnut

VISIT US ONLINE



For more information and to take a virtual walk-through, visit www.heartlandrvs.com

Your authorized Heartland dealer:



Product information is as accurate as possible as of the date of publication of this brochure. Due to Heartland's commitment to continuous product improvement, floorplans, materials, components, features, measurements, specifications, options, etc. are subject to change at any time without notice or obligation. In certain conditions some additional equipment may be needed. Photos may show optional equipment or props used for photography purposes only. Heartland has listed the approximate base weight of the trailer without the optional equipment included. Optional equipment will impact the weight of the trailer. Please locate the weight sticker attached to the trailer you are considering for the most accurate trailer weight. Tow Vehicle Caution: Owners of Heartland recreational vehicles are solely responsible for the selection and proper use of tow vehicles. All customers should consult with the motor vehicle manufacturer or their dealer concerning the purchase and use of suitable tow vehicles for Heartland products. Heartland disclaims any liability or damages suffered as a result of the selection, operation, use or misuse of a tow vehicle. Heartland's limited warranty does not cover damage to the recreational vehicle or the tow vehicle as a result of the selection of the tow vehicle. Overall length for a Fifth Wheel is defined as the body length of the trailer excluding hitch meaning bumper to cap. The overall length for a Travel Trailer is defined as the body length of the trailer including hitch, meaning bumper to hitch (pin). It does not include rear ladder or spare tire. Optional pin boxes will affect overall length. SPRING 12/22 (REV 1)

BIGHORN TRAVELER DISCOVERY PACKAGE

- 50" LED flat screen TV with AM, FM, CD, and DVD stereo
- Padded vinyl headboard, mounted off the wall and backlit
- Gunmetal single basin stainless steel kitchen sink
- 1-piece fiberglass shower with glass shower door
- Maple Cabinetry with hidden hinges
- 1.6 Cu. Ft. stainless steel microwave
- Tri-fold sleep sofa and theatre seat
- Double height entry grab handle
- 5,000 BTU 40" electric fireplace
- 12V cold weather tank pads
- Recessed LED ceiling lights
- Ball bearing drawer glides
- Residential refrigerator
- King mattress
- 22" oven with 3-burner cooktop and tempered glass stove cover
- Aluminum framed upper deck with double-welded box tube aluminum
- Bluetooth speaker prep bracket mounted in main basement and bedroom

BIGHORN TRAVELER INTERSTATE PACKAGE

- Dual wireless charging stations in kitchen and bedroom
- 28,500 BTU ducted AC system with dual thermostats
- MORryde "Step Above" strut assisted entry step
- MOR/ryde CRE 3000 rubber suspension system
- 6-point "Level Up" hydraulic leveling system
- 7,000lb Dexter axles and NevR Adjust brakes
- 16" F range tires w/ aluminum style wheels
- MOR/ryde 12V detachable power cord reel
- Premium high gloss fiberglass sidewalls
- Upgraded exterior graphics with badge
- Partial paint fiberglass front cap
- Rear ladder with 300lb capacity
- Power awning w/ LED light strip
- Rear backup camera prep
- 32" LED Bedroom TV
- 2" Receiver hitch
- Spare tire and sliding rack

OPTIONAL EQUIPMENT UPGRADE

- 12 cu ft 4 door Gas / Electric Refer
- Generator Prep

SPECIAL FEATURES



Store-More Storage



MORryde detachable power cord reel

INTERIOR FABRIC DECOR OPTIONS



Cinderwood



Beechnut

VISIT US ONLINE



For more information and to take a virtual walk-through, visit www.heartlandrvs.com

Your authorized Heartland dealer:



Product information is as accurate as possible as of the date of publication of this brochure. Due to Heartland's commitment to continuous product improvement, floorplans, materials, components, features, measurements, specifications, options, etc. are subject to change at any time without notice or obligation. In certain conditions some additional equipment may be needed. Photos may show optional equipment or props used for photography purposes only. Heartland has listed the approximate base weight of the trailer without the optional equipment included. Optional equipment will impact the weight of the trailer. Please locate the weight sticker attached to the trailer you are considering for the most accurate trailer weight. Tow Vehicle Caution: Owners of Heartland recreational vehicles are solely responsible for the selection and proper use of tow vehicles. All customers should consult with the motor vehicle manufacturer or their dealer concerning the purchase and use of suitable tow vehicles for Heartland products. Heartland disclaims any liability or damages suffered as a result of the selection, operation, use or misuse of a tow vehicle. Heartland's limited warranty does not cover damage to the recreational vehicle or the tow vehicle as a result of the selection of the tow vehicle. Overall length for a Fifth Wheels is defined as the body length of the trailer excluding hitch meaning bumper to cap. The overall length for a Travel Trailer is defined as the body length of the trailer including hitch, meaning bumper to hitch/pin. It does not include rear ladder or spare tire. Optional pin boxes will affect overall length. SPRING 12/22 (REV 1)