

FIND YOUR  
TRUE NORTH



 **NORTH TRAIL**  
WEST COAST

 BROUGHT TO YOU BY  
**HEARTLAND**

FIND YOUR  
TRUE NORTH



  
**NORTH TRAIL**  
WEST COAST

 BROUGHT TO YOU BY  
**HEARTLAND**

## TOP 5

# EXTERIOR FEATURES

- 1 | Prepped for anything - Prepped for tire pressure monitoring system, back up camera, and slide out topper
- 2 | Super King Kong sized pass-through storage
- 3 | Solar and Polar package - 20 watt Solar panel with onboard charge controller
- 4 | 2" Thick Azdel fortified aluminum sidewall construction
- 5 | Secure ride equipped - Top of the line axles, galvanized metal wheel wells, Wide Trax suspension, Heated and enclosed underbelly



LENGTH - 22' 1/2" | HEIGHT - 11' 4" | HITCH - 538 LBS.

DRY - 4,534 LBS. | GVWR - 6,900 LBS. | SLEEP CAPACITY - 3-4



LENGTH - 26' 5-1/2" | HEIGHT - 11' 4" | HITCH - 700 LBS.

DRY - 5,260 LBS. | GVWR - 7,500 LBS. | SLEEP CAPACITY - 3-4



LENGTH - 27' 11" | HEIGHT - 11' 4" | HITCH - 550 LBS.

DRY - 5,400 LBS. | GVWR - 6,900 LBS. | SLEEP CAPACITY - 7-8



LENGTH - 30' 10-1/2" | HEIGHT - 11' 4" | HITCH - 700 LBS.

DRY - 6,278 LBS. | GVWR - 8,600 LBS. | SLEEP CAPACITY - 3-4



LENGTH - 31' 11-1/2" | HEIGHT - 11' 4" | HITCH - 720 LBS.

DRY - 6,340 LBS. | GVWR - 9,520 LBS. | SLEEP CAPACITY - 7-8



LENGTH - 30' 7-1/2" | HEIGHT - 11' 4" | HITCH - 820 LBS.

DRY - 6,380 LBS. | GVWR - 7,820 LBS. | SLEEP CAPACITY - 7-8

# TOP 5

## EXTERIOR FEATURES

- 1 | Prepped for anything - Prepped for tire pressure monitoring system, back up camera, and slide out topper
- 2 | Super King Kong sized pass-through storage
- 3 | Solar and Polar package - 20 watt Solar panel with onboard charge controller
- 4 | 2" Thick Azdel fortified aluminum sidewall construction
- 5 | Secure ride equipped - Top of the line axles, galvanized metal wheel wells, Wide Trax suspension, Heated and enclosed underbelly



NT 21RBSS

LENGTH - 22' 1/2" | HEIGHT - 11' 4" | HITCH - 538 LBS.  
 DRY - 4,534 LBS. | GVWR - 6,900 LBS. | SLEEP CAPACITY - 3-4



NT 22RBS

LENGTH - 26' 5-1/2" | HEIGHT - 11' 4" | HITCH - 700 LBS.  
 DRY - 5,260 LBS. | GVWR - 7,500 LBS. | SLEEP CAPACITY - 3-4



NT 24BHS

LENGTH - 27' 11" | HEIGHT - 11' 4" | HITCH - 550 LBS.  
 DRY - 5,400 LBS. | GVWR - 6,900 LBS. | SLEEP CAPACITY - 7-8

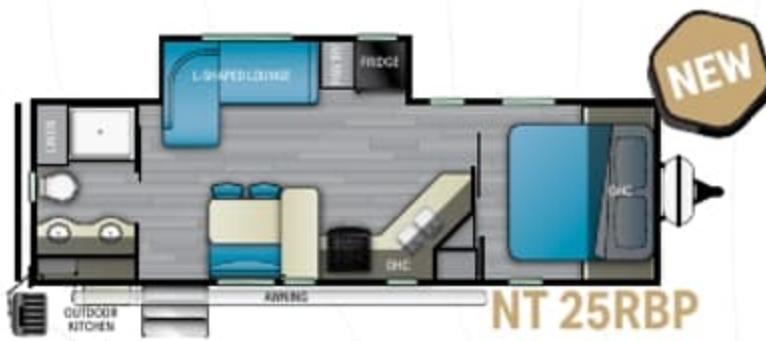

NT 25RBP

LENGTH - 30' 10-1/2" | HEIGHT - 11' 4" | HITCH - 700 LBS.  
 DRY - 6,278 LBS. | GVWR - 8,600 LBS. | SLEEP CAPACITY - 3-4



NT 26BHSS

LENGTH - 31' 11-1/2" | HEIGHT - 11' 4" | HITCH - 720 LBS.  
 DRY - 6,340 LBS. | GVWR - 9,520 LBS. | SLEEP CAPACITY - 7-8



NT 26DBS

LENGTH - 30' 7-1/2" | HEIGHT - 11' 4" | HITCH - 820 LBS.  
 DRY - 6,380 LBS. | GVWR - 7,820 LBS. | SLEEP CAPACITY - 7-8



## TOP 5 INTERIOR FEATURES

- 1 | Polar Shield Sidewall with tinted windows and nightshades
- 2 | Butcher block style kitchen countertops
- 3 | Stainless steel appliances
- 4 | Value hide - E - center with hidden valuable storage area (most models)
- 5 | Comfort select 72" x 80" gel infused residential king bed mattress



**LENGTH - 29' 4-1/2" | HEIGHT - 11' 4" | HITCH - 800 LBS.**  
**DRY - 6,040 LBS. | GVWR - 7,800 LBS. | SLEEP CAPACITY - 8**



**LENGTH - 30' 1" | HEIGHT - 11' 4" | HITCH - 660 LBS.**  
**DRY - 5,860 LBS. | GVWR - 7,660 LBS. | SLEEP CAPACITY - 5-6**



## TOP 5 INTERIOR FEATURES

- 1 | Polar Shield Sidewall with tinted windows and nightshades
- 2 | Butcher block style kitchen countertops
- 3 | Stainless steel appliances
- 4 | Value hide - E - center with hidden valuable storage area (most models)
- 5 | Comfort select 72" x 80" gel infused residential king bed mattress



**LENGTH - 29' 4-1/2" | HEIGHT - 11' 4" | HITCH - 800 LBS.**  
**DRY - 6,040 LBS. | GVWR - 7,800 LBS. | SLEEP CAPACITY - 8**



**LENGTH - 30' 1" | HEIGHT - 11' 4" | HITCH - 660 LBS.**  
**DRY - 5,860 LBS. | GVWR - 7,660 LBS. | SLEEP CAPACITY - 5-6**



## NORTH TRAIL UPGRADED KITCHEN (STANDARD):

- Upgraded door and cabinet hardware
- Oven range combo with glass top
- Upgraded Decorative Glass
- Removable Inside / Outside Dinette Table (Select Models)
- 12V Stainless Steel 10.7 CuFt Refer
- Stainless Steel Appliance Package (N/A gas electric refer)
- Large Viewing Window in Kitchen (Select Models)
- Stainless Steel ball bearing drawer guides
- Deep Pantry with Shelves (Most Models)
- Hidden Hinges

## ULTIMATE ENTERTAINMENT PACKAGE (SELECT MODELS ONLY):

- 50" HD TV
- 26" Fireplace

## POWER PACKAGE (FORCED ON ALL UNITS):

- Power Stab Jacks
- LED Lighting with Quick Charge USB Ports
- Power Tongue Jacks

## EXTERIOR UPGRADES:

- Front Cap with LED Lights (Forced)

## HEATING AND COOLING UPGRADES:

- 15K A/C in place of 13.5K A/C
- 50AMP service 2nd AC prep (select models only)

## NORTH TRAIL LIGHTWEIGHT PACKAGE:

- Laminated Crowned Roof
- Block Foam Brick Insulation
- 2" Laminated Sidewalls
- Enclosed & Heated Underbelly
- Tinted Safety Glass Windows
- Aluminum Rims
- Electric Awning W/ LED Lights
- Spare Tire
- Wide Trax Suspension System
- King Bed Standard
- Night Shades
- Dual 20# LP Tanks with Auto Change Over
- Dual Ducted 13.5 BTU A/C
- Wifi Prep
- Outside Shower
- Power Vent in Bathroom
- Skylight in Bathroom
- Slam Latch Storage Doors
- Black Tank Flush
- 6.0 Gallon DSI Gas / Electric Water Heater
- Under bed storage with quick store bed base.
- FM Stereo with HDMI pass through
- Cable Ready
- 55 AMP 12 Volt Power Converter
- Diamond Plate Front
- Solid Entry Steps
- Solar Prep
- Back Up Camera Prep
- Slide Topper Prep
- Tire Pressure Motoring Sensor Prepped

## SPECIAL FEATURES



USB port accessibility



Smooth Ride

## INTERIOR FABRIC DECOR OPTIONS



Urban Cottage

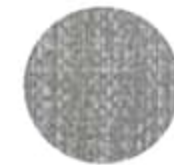

Crystal Bay

## VISIT US ONLINE



Your authorized Heartland dealer:



For more information and to take a virtual walk-through, visit [www.heartlandrvs.com](http://www.heartlandrvs.com)



## NORTH TRAIL UPGRADED KITCHEN (STANDARD):

- Upgraded door and cabinet hardware
- Oven range combo with glass top
- Upgraded Decorative Glass
- Removable Inside / Outside Dinette Table (Select Models)
- 12V Stainless Steel 10.7 CuFt Refer
- Stainless Steel Appliance Package (N/A gas electric refer)
- Large Viewing Window in Kitchen (Select Models)
- Stainless Steel ball bearing drawer guides
- Deep Pantry with Shelves (Most Models)
- Hidden Hinges

## ULTIMATE ENTERTAINMENT PACKAGE (SELECT MODELS ONLY):

- 50" HD TV
- 26" Fireplace

## POWER PACKAGE (FORCED ON ALL UNITS):

- Power Stab Jacks
- LED Lighting with Quick Charge USB Ports
- Power Tongue Jacks

## EXTERIOR UPGRADES:

- Front Cap with LED Lights (Forced)

## HEATING AND COOLING UPGRADES:

- 15K A/C in place of 13.5K A/C
- 50AMP service 2nd AC prep (select models only)

## NORTH TRAIL LIGHTWEIGHT PACKAGE:

- Laminated Crowned Roof
- Block Foam Brick Insulation
- 2" Laminated Sidewalls
- Enclosed & Heated Underbelly
- Tinted Safety Glass Windows
- Aluminum Rims
- Electric Awning W/ LED Lights
- Spare Tire
- Wide Trax Suspension System
- King Bed Standard
- Night Shades
- Dual 20# LP Tanks with Auto Change Over
- Dual Ducted 13.5 BTU A/C
- Wifi Prep
- Outside Shower
- Power Vent in Bathroom
- Skylight in Bathroom
- Slam Latch Storage Doors
- Black Tank Flush
- 6.0 Gallon DSI Gas / Electric Water Heater
- Under bed storage with quick store bed base.
- FM Stereo with HDMI pass through
- Cable Ready
- 55 AMP 12 Volt Power Converter
- Diamond Plate Front
- Solid Entry Steps
- Solar Prep
- Back Up Camera Prep
- Slide Topper Prep
- Tire Pressure Motoring Sensor Prepped

## SPECIAL FEATURES



USB port accessibility



Smooth Ride

## INTERIOR FABRIC DECOR OPTIONS



Urban Cottage

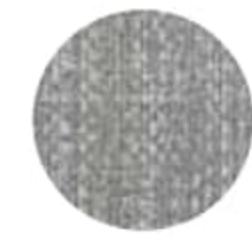

Crystal Bay

## VISIT US ONLINE



Your authorized Heartland dealer:



For more information and to take a virtual walk-through, visit [www.heartlandrvs.com](http://www.heartlandrvs.com)

