

**DYNAMAX**  
A DIVISION OF FOREST RIVER  
DIFFERENT BY DESIGN

2022



**FORCE**



**DYNAMAX**  
A DIVISION OF FOREST RIVER  
DIFFERENT BY DESIGN

2022



**FORCE**



# FORCE

Who says you can't take it with you? Most traditional Class C's give you all the living space for a family, but not much more. The Dynamax Force offers 33,000 lbs. of GVWR and 20,000 lbs. of towing capacity. Not only can you bring the whole family, but you can also bring all the toys, gear, clothes, groceries, and everything else needed for life on the go.



34KD



37BD



37TS

Key Dimensions	34KD	37BD	37TS
GVWR	33,000 lbs.	33,000 lbs.	33,000 lbs.
GCWR	54,000 lbs.	54,000 lbs.	54,000 lbs.
GAWR Front	12,000 lbs.	12,000 lbs.	12,000 lbs.
GAWR Rear	21,000 lbs.	21,000 lbs.	21,000 lbs.
UVW*	24,188 lbs.	25,083 lbs.	25,292 lbs.
Overall Length	36' 8"	39' 2"	39' 2"
Exterior Width	101"	101"	101"
Wheelbase	268"	268"	268"
Overall Exterior Height with 15,000 BTU A/C	12' 9"	12' 9"	12' 9"
Interior Height	7' 0"	7' 0"	7' 0"
Fuel Capacity	100 gal.	100 gal.	100 gal.
Water Capacities (Gal.) Fresh/Grey/Black	94/52/52	94/52/52	94/52/52
LP Capacity (WC)	20.3 gal./86 lb.	20.3 gal./86 lb.	20.3 gal./86 lb.
Awning Length	18'	13' 6"	18'

\* UVW is an estimate only based on standard equipment.

## OPTIONS



## STANDARD FEATURES & OPTIONS

### CHASSIS

- Freightliner® M2 106 Chassis (33,000-lbs. GVWR / 54,000-lbs. GCWR)
- Detroit DD8 7.7L Turbo Diesel Engine (375hp / 1,050 lb.-ft. of Torque)
- Allison® 3200 TRV Six-Speed Automatic Transmission
- 100-Gallon Fuel Capacity (Twin 50-Gallon Aluminum Fuel Tanks)
- 6-Gallon Diesel Exhaust Fluid Tank
- Trailer Hitch (20,000 Tow lbs. / 2,000 Tongue lbs.) with 7-Way Round Tow Connection
- Weigh Safe® Trailer Hitch Receiver
- Brake Controller
- Dual-Stage Compression Brake with High / Off / Low Braking Dash Switch
- Locking Differential
- Airliner® 21,000-lb. Rear Suspension
- Manual Air Suspension Dump Valve Switch on the Dash
- 275-Amp Alternator
- Quick Disconnect Fitting with Tire Inflation Kit
- Air Brakes with 4-Wheel ABS
- Bilstein® Gas-Charged Front Shock Absorbers
- Equiflo™ Inboard Fuel System (Dual Supply - Dual Return)
- Fuel Filter/Water Separator with Primer Pump
- Engine Block Heater
- Steel-Reinforced, Aluminum Cab
- Chrome Grille and Air Intake Grille
- Front and Rear Tires: Michelin® XZE2 275/80R22.5 (14 Ply Radials)
- Single Front Wheels: Alcoa® Aluminum (22.5" x 8.25") \*Outside Rims are Polished
- Dual Rear Wheels: Alcoa® Aluminum (22.5" x 8.25") \*Outside Rims are Polished
- Valve Extensions
- Tire Pressure Monitoring System
- 4.56 Rear Axle Ratio
- Daytime Running Lights

Cab-Over bunk with a 50" x 79" sleeping area.



- LED Headlights
- Tinted Door Glass and Operating Wing Windows
- Chassis Battery Shut Off Switch in Cab
- Leatherette Driver and Passenger Air Ride Seats with Swivel Bases
- Quad-View Camera System (Right Side, Left Side, Backup, Hitch, and Rear Horizon Views)
- Kenwood® 7" Touch Screen Dash Infotainment System with AM/FM, Bluetooth®, Sirius / XM® (tuner and antenna), Apple® CarPlay™ / Android® Auto™ Functionality, and Garmin® RV Navigation
- Air Horn
- 12V Accessory Ports
- One Valve Parking Brake System with Warning Indicator
- Engine After-Treatment Device, Automatic Over-the-Road Regeneration, and Dash-Mounted Regeneration Switch
- Momentary Battery Booster Switch for Connecting Chassis and House Batteries
- Marker Lights with Separate Interrupter Switch
- Low Air Pressure Light and Buzzer
- Cruise Control
- Adjustable Steering Column
- 18" Leather-Wrapped Steering Wheel
- Hydrographic Woodgrain Cab Accents
- Power and Heated Exterior Mirrors
- Power Windows and Locks
- 3-Point Seat Belts
- Dual Reading Lights
- Two (2) Cup Holders in Dash

### CONSTRUCTION

- 2" Aluminum-Framed, Laminated Sidewalls with Dow® Block Foam Insulation
- Gel-Coat Fiberglass Walls with Azdel® Backing
- Aluminum-Framed Floor
- Aluminum-Framed Roof Trusses
- Crowned, One-Piece Fiberglass Roof
- Foil-Lined Ductwork Throughout
- Fiberglass Front Cap, Rear Cap, and Front Wing Panels
- Automatic, 4-Point Hydraulic Leveling Jacks
- Dual-Pane, Dark-Tinted, Frameless Windows
- Seamless Rotocast Storage Compartments with LED Lighting
- Side-Hinged, Locking Aluminum Exterior Storage Doors with Paddle Latches

### EXTERIOR

- Custom Full Body Paint Package
- Premium Cut and Buffed Paint Finish
- Front-End Diamond Shield® Paint Protection
- Patio Awning with LED Lighting
- Aluminum-Wrapped Slideout Toppers
- LED Patio Light

- Entry Door with Rotary Latch Dark-Tinted, Frameless Window and Integrated Shade
- Keyless Entry Touch Pad at Entry Door
- Lighted Acrylic Entry Grab Handle
- Power Entry Steps
- Exterior Wall-Mounted Entertainment Center with 32" LED Smart TV
- Front and Rear LED Clearance and Marker Lighting
- Rear Docking Lights
- Polished Stainless Steel Cab Step Treads
- Rear "DYNAMAX" Rock Guard
- Chrome Exhaust Tip

### INTERIOR

- Front Cab-Over Bunk Area with Mattress (50" x 79") and Privacy Curtain
- Premium Vinyl Flooring Throughout
- Deluxe Carpet with Pad in Select Living Area Slide Rooms
- Entry with Non-Skid Rubber Steps and Risers
- Soft-Touch Padded Vinyl Ceiling
- LED Recessed Ceiling Lights
- Sprung, Residential Style Dinette Seats with Lift Up Storage
- Tri-Fold Sleeper Sofa
- Coordinating Window Treatments
- Day/Night Roller Shades
- Hardwood Shaker-Style Cabinetry
- Full Extension, Soft-Closing Drawer Guides (where applicable)
- Hidden Hinges
- 39" LED Smart TV (Living Area)
- Entertainment Center with Fireplace (37BD Only)
- Sound Bar
- Thermal, Reflective Front Privacy Shades
- USB Charging Ports

### KITCHEN

- 16 cu. ft. Residential Refrigerator with Ice Maker (Double-Door)
- Sealed Gas Range with Glass Cover
- Convection Microwave Oven
- Solid Surface Countertops with LED Edge Lighting and Backsplash
- Stainless Steel Sink with Solid Surface Covers
- Residential Stainless Steel Spring Gooseneck Faucet
- Pantry
- Under-Cabinet Lighting
- MaxxAir® Power Vent with Built-In Rain Cover

### BEDROOM

- King Bed (72"x75") with Gel-Infused Memory Foam Mattress
- Deluxe Padded Headboard
- Designer Bedding Package
- 32" LED Smart TV



# FORCE

Who says you can't take it with you? Most traditional Class C's give you all the living space for a family, but not much more. The Dynamax Force offers 33,000 lbs. of GVWR and 20,000 lbs. of towing capacity. Not only can you bring the whole family, but you can also bring all the toys, gear, clothes, groceries, and everything else needed for life on the go.

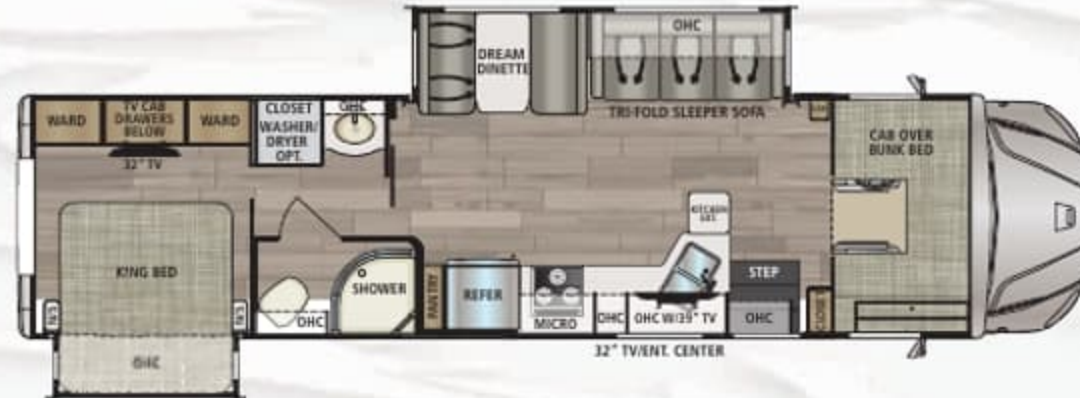

34KD



37BD



37TS

Key Dimensions	34KD	37BD	37TS
GVWR	33,000 lbs.	33,000 lbs.	33,000 lbs.
GCWR	54,000 lbs.	54,000 lbs.	54,000 lbs.
GAWR Front	12,000 lbs.	12,000 lbs.	12,000 lbs.
GAWR Rear	21,000 lbs.	21,000 lbs.	21,000 lbs.
UVW*	24,188 lbs.	25,083 lbs.	25,292 lbs.
Overall Length	36' 8"	39' 2"	39' 2"
Exterior Width	101"	101"	101"
Wheelbase	268"	268"	268"
Overall Exterior Height with 15,000 BTU A/C	12' 9"	12' 9"	12' 9"
Interior Height	7' 0"	7' 0"	7' 0"
Fuel Capacity	100 gal.	100 gal.	100 gal.
Water Capacities (Gal.) Fresh/Grey/Black	94/52/52	94/52/52	94/52/52
LP Capacity (WC)	20.3 gal./86 lb.	20.3 gal./86 lb.	20.3 gal./86 lb.
Awning Length	18'	13' 6"	18'

\* UVW is an estimate only based on standard equipment.

## OPTIONS



## STANDARD FEATURES & OPTIONS

### CHASSIS

- Freightliner® M2 106 Chassis (33,000-lbs. GVWR / 54,000-lbs. GCWR)
- Detroit DD8 7.7L Turbo Diesel Engine (375hp / 1,050 lb.-ft. of Torque)
- Allison® 3200 TRV Six-Speed Automatic Transmission
- 100-Gallon Fuel Capacity (Twin 50-Gallon Aluminum Fuel Tanks)
- 6-Gallon Diesel Exhaust Fluid Tank
- Trailer Hitch (20,000 Tow lbs. / 2,000 Tongue lbs.) with 7-Way Round Tow Connection
- Weigh Safe® Trailer Hitch Receiver
- Brake Controller
- Dual-Stage Compression Brake with High / Off / Low Braking Dash Switch
- Locking Differential
- Airliner® 21,000-lb. Rear Suspension
- Manual Air Suspension Dump Valve Switch on the Dash
- 275-Amp Alternator
- Quick Disconnect Fitting with Tire Inflation Kit
- Air Brakes with 4-Wheel ABS
- Bilstein® Gas-Charged Front Shock Absorbers
- Equiflo™ Inboard Fuel System (Dual Supply - Dual Return)
- Fuel Filter/Water Separator with Primer Pump
- Engine Block Heater
- Steel-Reinforced, Aluminum Cab
- Chrome Grille and Air Intake Grille
- Front and Rear Tires: Michelin® XZE2 275/80R22.5 (14 Ply Radials)
- Single Front Wheels: Alcoa® Aluminum (22.5" x 8.25") \*Outside Rims are Polished
- Dual Rear Wheels: Alcoa® Aluminum (22.5" x 8.25") \*Outside Rims are Polished
- Valve Extensions
- Tire Pressure Monitoring System
- 4.56 Rear Axle Ratio
- Daytime Running Lights

Cab-Over bunk with a 50" x 79" sleeping area.



- LED Headlights
- Tinted Door Glass and Operating Wing Windows
- Chassis Battery Shut Off Switch in Cab
- Leatherette Driver and Passenger Air Ride Seats with Swivel Bases
- Quad-View Camera System (Right Side, Left Side, Backup, Hitch, and Rear Horizon Views)
- Kenwood® 7" Touch Screen Dash Infotainment System with AM/FM, Bluetooth®, Sirius / XM® (tuner and antenna), Apple® CarPlay™ / Android® Auto™ Functionality, and Garmin® RV Navigation
- Air Horn
- 12V Accessory Ports
- One Valve Parking Brake System with Warning Indicator
- Engine After-Treatment Device, Automatic Over-the-Road Regeneration, and Dash-Mounted Regeneration Switch
- Momentary Battery Booster Switch for Connecting Chassis and House Batteries
- Marker Lights with Separate Interrupter Switch
- Low Air Pressure Light and Buzzer
- Cruise Control
- Adjustable Steering Column
- 18" Leather-Wrapped Steering Wheel
- Hydrographic Woodgrain Cab Accents
- Power and Heated Exterior Mirrors
- Power Windows and Locks
- 3-Point Seat Belts
- Dual Reading Lights
- Two (2) Cup Holders in Dash

### CONSTRUCTION

- 2" Aluminum-Framed, Laminated Sidewalls with Dow® Block Foam Insulation
- Gel-Coat Fiberglass Walls with Azdel® Backing
- Aluminum-Framed Floor
- Aluminum-Framed Roof Trusses
- Crowned, One-Piece Fiberglass Roof
- Foil-Lined Ductwork Throughout
- Fiberglass Front Cap, Rear Cap, and Front Wing Panels
- Automatic, 4-Point Hydraulic Leveling Jacks
- Dual-Pane, Dark-Tinted, Frameless Windows
- Seamless Rotocast Storage Compartments with LED Lighting
- Side-Hinged, Locking Aluminum Exterior Storage Doors with Paddle Latches

### EXTERIOR

- Custom Full Body Paint Package
- Premium Cut and Buffed Paint Finish
- Front-End Diamond Shield® Paint Protection
- Patio Awning with LED Lighting
- Aluminum-Wrapped Slideout Toppers
- LED Patio Light

- Entry Door with Rotary Latch Dark-Tinted, Frameless Window and Integrated Shade
- Keyless Entry Touch Pad at Entry Door
- Lighted Acrylic Entry Grab Handle
- Power Entry Steps
- Exterior Wall-Mounted Entertainment Center with 32" LED Smart TV
- Front and Rear LED Clearance and Marker Lighting
- Rear Docking Lights
- Polished Stainless Steel Cab Step Treads
- Rear "DYNAMAX" Rock Guard
- Chrome Exhaust Tip

### INTERIOR

- Front Cab-Over Bunk Area with Mattress (50"x79") and Privacy Curtain
- Premium Vinyl Flooring Throughout
- Deluxe Carpet with Pad in Select Living Area Slide Rooms
- Entry with Non-Skid Rubber Steps and Risers
- Soft-Touch Padded Vinyl Ceiling
- LED Recessed Ceiling Lights
- Sprung, Residential Style Dinette Seats with Lift Up Storage
- Tri-Fold Sleeper Sofa
- Coordinating Window Treatments
- Day/Night Roller Shades
- Hardwood Shaker-Style Cabinetry
- Full Extension, Soft-Closing Drawer Guides (where applicable)
- Hidden Hinges
- 39" LED Smart TV (Living Area)
- Entertainment Center with Fireplace (37BD Only)
- Sound Bar
- Thermal, Reflective Front Privacy Shades
- USB Charging Ports

### KITCHEN

- 16 cu. ft. Residential Refrigerator with Ice Maker (Double-Door)
- Sealed Gas Range with Glass Cover
- Convection Microwave Oven
- Solid Surface Countertops with LED Edge Lighting and Backsplash
- Stainless Steel Sink with Solid Surface Covers
- Residential Stainless Steel Spring Gooseneck Faucet
- Pantry
- Under-Cabinet Lighting
- MaxxAir® Power Vent with Built-In Rain Cover

### BEDROOM

- King Bed (72"x75") with Gel-Infused Memory Foam Mattress
- Deluxe Padded Headboard
- Designer Bedding Package
- 32" LED Smart TV





Force 37TS with Driftwood cabinetry and Carbon décor, is shown with these options: power theater seats, entertainment center with 50" LED TV and fireplace.

- Cedar-Lined Wardrobe
- Nightstands with Solid Surface Countertops
- LED Reading Lights
- USB Charging Ports
- Bunk Bed Mattresses (28"x76") and Privacy Partition (37BD)
- Two Bunk CD/DVD Players with Monitors (37BD)

#### BATHROOM

- Fiberglass Shower with Skylight
- Glass Shower Door
- Oxygenics Body Spa® RV Shower Head
- Solid Surface Countertop with LED Edge Lighting and Backsplash
- Under-Mount Sink with Residential Brushed Nickel Faucet
- Porcelain Foot-Flush Toilet
- MaxxAir® Power Vent with Built-In Rain Cover

#### UTILITIES

- Dual 12V 8D AGM Deep-Cycle, Maintenance-Free Batteries
- Multiplex® Wiring with Touch Screen Command Center, Switch Panels, and Bluetooth® Smart Phone App Control
- Battery Disconnect
- 50-Amp Service with Power Cord Reel
- 3,000W Hybrid Pure Sine Wave Inverter/Charger (3,500 Peak Watts)
- 8kW Onan® Diesel Generator with Auto Transfer Switch (Mounted on Isolator Pads)

- Automatic Generator Start
- Solar Panels – Two 100 Watt with 30 Amp Controller
- Dual Ducted, Low-Profile 15,000-BTU Air Conditioners with Heat
- 40,000-BTU LP Furnace with Electronic Ignition (34KD & 37BD: 2 x 20,000-BTU)
- 60,000-BTU Truma® Aqua Go Comfort™ On-Demand Water Heater (LP)
- 20.3-Gallon LP Tank (WC)
- LP Quick Connect
- Water Filtration System
- Exterior Shower in Service Bay
- Exterior GFCI Receptacle
- Winegard® AIR 360+™ Dome Antenna (WiFi Extender, 4G LTE, Omnidirectional VHF/UHF OTA, FM, SIM Card Port)
- 4X4 HDMI Matrix
- Cable TV/Satellite Hookup in Service Bay
- Thetford® Sani-Con Turbo Macerator System
- Black Tank Flush
- Furnace-Heated Utility Compartment
- Enclosed and Furnace-Heated Holding Tanks
- Upgraded 12V On-Demand Water Pump (4 gallons per minute)
- Carbon-Monoxide, LP, and Smoke Detectors
- Fire Extinguisher
- Winegard® In-Motion T4 Satellite (Dish® SD-HD, DirecTV® SD, BellTV® SD-HD)

#### OPTIONS

- Black Out Package (Cab Entry Steps, Side Mirrors, Rock Guard, Wheels, Headlight Bezels, Exterior Grab Handle Trim, Custom Grill and Vent)
- Chrome Appearance Package (Custom Grill and Vent, Dual Chrome Air Horns, Rock Guard, and Baggage Door Handles)
- 12 cu. ft. 2-Way Refrigerator in place of Standard Refrigerator and Side Pantry
- Washer/Dryer
- Dual, Power Reclining Theater Seats in Place of Dinette (34KD: Three Seats - Only Outer Seats are Powered)
- Entertainment Center with 50" LED TV and Fireplace in Place of Loveseat & 39" TV (37TS Only)
- Innomax® Adjustable Comfort, Digital Smart Bed
- JBL® Premium Cab Sound System - JBL full range / tweeter coaxial speakers, dual voice coil subwoofer, and a high-efficiency, high-performing, 4-channel DSP amplifier, all "Tuned" specifically for the Freightliner M2
- Mobileye® Collision Avoidance System
- Low-Temp Lithium (600aH) in place of AGM Batteries

## FULL BODY PAINT PACKAGES

With Front-End Diamond Shield

### A WINNING COMBINATION OF SAFETY, SERVICEABILITY AND DRIVEABILITY.

Easy access to the engine makes service simple. There's no need to walk through the living room or bedroom.

Gas-Strut Assisted Hood Provides Easy Maintenance and Serviceability



Admiral Blue

Dual-Cockpit Entry Allows for Easy Entry and Exit



Granite

Airliner Heavy-Duty Rear Suspension



Magnetic

Bilstein® Gas-Charged Front Shock Absorbers

Automotive, crash-tested chassis offers up to 5' of crush zone protection.



Merlot

Front Sway Bar



Dynamax often makes running changes, (changes made outside of model year timing) to improve the reliability, performance or capacity. Please refer to [www.dynamaxcorp.com](http://www.dynamaxcorp.com) for the most current specifications.





Force 37TS with Driftwood cabinetry and Carbon décor, is shown with these options: power theater seats, entertainment center with 50" LED TV and fireplace.

- Cedar-Lined Wardrobe
- Nightstands with Solid Surface Countertops
- LED Reading Lights
- USB Charging Ports
- Bunk Bed Mattresses (28"x76") and Privacy Partition (37BD)
- Two Bunk CD/DVD Players with Monitors (37BD)

#### BATHROOM

- Fiberglass Shower with Skylight
- Glass Shower Door
- Oxygenics Body Spa® RV Shower Head
- Solid Surface Countertop with LED Edge Lighting and Backsplash
- Under-Mount Sink with Residential Brushed Nickel Faucet
- Porcelain Foot-Flush Toilet
- MaxxAir® Power Vent with Built-In Rain Cover

#### UTILITIES

- Dual 12V 8D AGM Deep-Cycle, Maintenance-Free Batteries
- Multiplex® Wiring with Touch Screen Command Center, Switch Panels, and Bluetooth® Smart Phone App Control
- Battery Disconnect
- 50-Amp Service with Power Cord Reel
- 3,000W Hybrid Pure Sine Wave Inverter/Charger (3,500 Peak Watts)
- 8kW Onan® Diesel Generator with Auto Transfer Switch (Mounted on Isolator Pads)

- Automatic Generator Start
- Solar Panels – Two 100 Watt with 30 Amp Controller
- Dual Ducted, Low-Profile 15,000-BTU Air Conditioners with Heat
- 40,000-BTU LP Furnace with Electronic Ignition (34KD & 37BD: 2 x 20,000-BTU)
- 60,000-BTU Truma® Aqua Go Comfort™ On-Demand Water Heater (LP)
- 20.3-Gallon LP Tank (WC)
- LP Quick Connect
- Water Filtration System
- Exterior Shower in Service Bay
- Exterior GFCI Receptacle
- Winegard® AIR 360+™ Dome Antenna (WiFi Extender, 4G LTE, Omnidirectional VHF/UHF OTA, FM, SIM Card Port)
- 4X4 HDMI Matrix
- Cable TV/Satellite Hookup in Service Bay
- Thetford® Sani-Con Turbo Macerator System
- Black Tank Flush
- Furnace-Heated Utility Compartment
- Enclosed and Furnace-Heated Holding Tanks
- Upgraded 12V On-Demand Water Pump (4 gallons per minute)
- Carbon-Monoxide, LP, and Smoke Detectors
- Fire Extinguisher
- Winegard® In-Motion T4 Satellite (Dish® SD-HD, DirecTV® SD, BellTV® SD-HD)

#### OPTIONS

- Black Out Package (Cab Entry Steps, Side Mirrors, Rock Guard, Wheels, Headlight Bezels, Exterior Grab Handle Trim, Custom Grill and Vent)
- Chrome Appearance Package (Custom Grill and Vent, Dual Chrome Air Horns, Rock Guard, and Baggage Door Handles)
- 12 cu. ft. 2-Way Refrigerator in place of Standard Refrigerator and Side Pantry
- Washer/Dryer
- Dual, Power Reclining Theater Seats in Place of Dinette (34KD: Three Seats - Only Outer Seats are Powered)
- Entertainment Center with 50" LED TV and Fireplace in Place of Loveseat & 39" TV (37TS Only)
- Innomax® Adjustable Comfort, Digital Smart Bed
- JBL® Premium Cab Sound System - JBL full range / tweeter coaxial speakers, dual voice coil subwoofer, and a high-efficiency, high-performing, 4-channel DSP amplifier, all "Tuned" specifically for the Freightliner M2
- Mobileye® Collision Avoidance System
- Low-Temp Lithium (600aH) in place of AGM Batteries

## FULL BODY PAINT PACKAGES

With Front-End Diamond Shield

### A WINNING COMBINATION OF SAFETY, SERVICEABILITY AND DRIVEABILITY.

Easy access to the engine makes service simple. There's no need to walk through the living room or bedroom.

Gas-Strut Assisted Hood Provides Easy Maintenance and Serviceability



Admiral Blue

Dual-Cockpit Entry Allows for Easy Entry and Exit



Granite

Airliner Heavy-Duty Rear Suspension



Magnetic

Bilstein® Gas-Charged Front Shock Absorbers

Automotive, crash-tested chassis offers up to 5' of crush zone protection.



Merlot

Front Sway Bar



Dynamax often makes running changes, (changes made outside of model year timing) to improve the reliability, performance or capacity. Please refer to [www.dynamaxcorp.com](http://www.dynamaxcorp.com) for the most current specifications.



## DÉCOR SELECTIONS

### CHAMPAGNE

Main



Valance with Accent

### CARBON

Main



Valance with Accent

### DUSK

Main



Valance with Accent

### DRIFTWOOD II

Drawers

Flooring

### SHADOW

Drawers

## UPGRADE YOUR FORCE WITH THESE OPTION PACKAGES

### Blackout Package



### Chrome Package



Factory Video Tour

<https://www.youtube.com/watch?v=q5cG43PD7SE>

Paint Video

<https://www.youtube.com/watch?v=sLgLoR26jfs>

### Dynamax Owner "Digital Kit" App

Now you can have your Owner's Manual with you wherever you are. Download our FREE App from the App Store or Google Play and you'll have the information right at your fingertips.



**GVWR (Gross Vehicle Weight Rating)** - is the maximum permissible weight of the unit when fully loaded. It includes all weights, inclusive of all fluids, occupants, cargo, optional equipment and accessories. For safety and product performance do NOT exceed the GVWR.

**GCWR (Gross Combined Weight Rating)** - is the maximum permissible loaded weight of your motor home and any towed trailer or towed vehicle. Actual GCWR of this vehicle may be limited by the sum of the GVWR and the installed hitch receiver maximum capacity rating; see hitch rating label for detail.

**GAWR (Gross Axle Weight Rating)** - is the maximum permissible weight, including cargo, fluids, optional equipment and accessories that can be safely supported by each axle.

**UVW (Unloaded Vehicle Weight)** - is the typical weight of the unit as manufactured at the factory. It includes all weight at the unit's axle(s), including full fuel, all fluids and LP Gas. The UVW does not include cargo, fresh potable water, additional optional equipment or dealer installed accessories.

**CCC (Cargo Carrying Capacity)** - is the amount of weight available for fresh potable water, cargo, passengers, additional optional equipment and accessories. CCC is equal to GVWR minus UVW. Available CCC should accommodate fresh potable water (8.3 lbs per gallon). Before filling the fresh water tank, empty the black and gray tanks to provide for more cargo capacity.

**\*\*Estimated average based on standard build optional equipment.**

Each Forest River RV is weighed at the manufacturing facility prior to shipping. A label identifying the unloaded vehicle weight of the actual unit and the cargo carrying capacity is applied to every Forest River RV prior to leaving our facilities.

The load capacity of your unit is designated by weight, not by volume, so you cannot necessarily use all available space when loading your unit.

Actual towing capacity is dependent upon your particular loading and towing circumstances, which includes the GVWR, GAWR and GCWR as well as adequate trailer brakes. Please refer to the Operator's Manual of your vehicle for further towing information.



### PRE-DELIVERY INSPECTION FACILITY

20,000 square feet of quality assurance. The bare essentials for a premium product. This state-of-the-art facility gives immediate daily feedback to production for quality assurance in every unit built.

### 24/7 EMERGENCY ROADSIDE ASSISTANCE WITH VEHICLE PURCHASE\*

TOWING  
JUMP-STARTS  
TIRE CHANGES  
FLUID DELIVERY  
LOCKOUT  
SERVICE

WINCH-OUT  
MOBILE MECHANIC  
TECHNICAL  
SUPPORT  
DEALER LOCATOR  
SERVICES



\*VALID FOR 1 YEAR FROM DATE OF PURCHASE



**FREE MEMBERSHIP**  
to Forest River Owners' Group

[www.forestriverfrog.com](http://www.forestriverfrog.com)



All information contained in this brochure is believed to be accurate at the time of publication. However, during the model year, it may be necessary to make revisions and Forest River, Inc., reserves the right to make all such changes without notice, including prices, colors, materials, equipment and specifications as well as the addition of new models and the discontinuance of models shown in this brochure. Therefore, please consult with your Forest River dealer and confirm the existence of any materials, design or specifications that are material to your purchase decision. ©2022 Dynamax, a Division of Forest River, Inc., a Berkshire Hathaway company. All Rights Reserved. 1/22

Find us on Facebook



**Learn More**  
Scan this barcode using a QR Reader on your smart phone to learn more about Forest River.



A Berkshire Hathaway company.

Your Authorized FORCE Series Dealer



**DYNAMAX**  
A DIVISION OF FOREST RIVER

DIFFERENT BY DESIGN

2745 Northland Dr. ■ Elkhart IN 46514  
888-295-7859 ■ [www.dynamaxcorp.com](http://www.dynamaxcorp.com)



## DÉCOR SELECTIONS

### CHAMPAGNE

Main



Valance with Accent

### CARBON

Main



Valance with Accent

### DUSK

Main



Valance with Accent



Drawers

Flooring



Drawers

## UPGRADE YOUR FORCE WITH THESE OPTION PACKAGES

### Blackout Package



### Chrome Package



Factory Video Tour

<https://www.youtube.com/watch?v=q5cG43PD7SE>

Paint Video

<https://www.youtube.com/watch?v=sLgLoR26jfs>

### Dynamax Owner "Digital Kit" App

Now you can have your Owner's Manual with you wherever you are. Download our FREE App from the App Store or Google Play and you'll have the information right at your fingertips.



**GVWR (Gross Vehicle Weight Rating)** - is the maximum permissible weight of the unit when fully loaded. It includes all weights, inclusive of all fluids, occupants, cargo, optional equipment and accessories. For safety and product performance do NOT exceed the GVWR.

**GCWR (Gross Combined Weight Rating)** - is the maximum permissible loaded weight of your motor home and any towed trailer or towed vehicle. Actual GCWR of this vehicle may be limited by the sum of the GVWR and the installed hitch receiver maximum capacity rating; see hitch rating label for detail.

**GAWR (Gross Axle Weight Rating)** - is the maximum permissible weight, including cargo, fluids, optional equipment and accessories that can be safely supported by each axle.

**UVW (Unloaded Vehicle Weight)** - is the typical weight of the unit as manufactured at the factory. It includes all weight at the unit's axle(s), including full fuel, all fluids and LP Gas. The UVW does not include cargo, fresh potable water, additional optional equipment or dealer installed accessories.

\*Estimated Average based on standard build optional equipment.

**CCC (Cargo Carrying Capacity)** - is the amount of weight available for fresh potable water, cargo, passengers, additional optional equipment and accessories. CCC is equal to GVWR minus UVW. Available CCC should accommodate fresh potable water (8.3 lbs per gallon). Before filling the fresh water tank, empty the black and gray tanks to provide for more cargo capacity.

\*\*Estimated average based on standard build optional equipment.

Each Forest River RV is weighed at the manufacturing facility prior to shipping. A label identifying the unloaded vehicle weight of the actual unit and the cargo carrying capacity is applied to every Forest River RV prior to leaving our facilities.

The load capacity of your unit is designated by weight, not by volume, so you cannot necessarily use all available space when loading your unit.

Actual towing capacity is dependent upon your particular loading and towing circumstances, which includes the GVWR, GAWR and GCWR as well as adequate trailer brakes. Please refer to the Operator's Manual of your vehicle for further towing information.



### PRE-DELIVERY INSPECTION FACILITY

20,000 square feet of quality assurance. The bare essentials for a premium product. This state-of-the-art facility gives immediate daily feedback to production for quality assurance in every unit built.



### 24/7 EMERGENCY ROADSIDE ASSISTANCE WITH VEHICLE PURCHASE\*

TOWING  
JUMP-STARTS  
TIRE CHANGES  
FLUID DELIVERY  
LOCKOUT  
SERVICE

WINCH-OUT  
MOBILE MECHANIC  
TECHNICAL  
SUPPORT  
DEALER LOCATOR  
SERVICES



\*VALID FOR 1 YEAR FROM DATE OF PURCHASE



All information contained in this brochure is believed to be accurate at the time of publication. However, during the model year, it may be necessary to make revisions and Forest River, Inc., reserves the right to make all such changes without notice, including prices, colors, materials, equipment and specifications as well as the addition of new models and the discontinuance of models shown in this brochure. Therefore, please consult with your Forest River dealer and confirm the existence of any materials, design or specifications that are material to your purchase decision. ©2022 Dynamax, a Division of Forest River, Inc., a Berkshire Hathaway company. All Rights Reserved. 1/22

Find us on Facebook



Learn More  
Scan this barcode using a QR Reader on your smart phone to learn more about Forest River.



A Berkshire Hathaway company.

Your Authorized FORCE Series Dealer



DIFFERENT BY DESIGN

2745 Northland Dr. ■ Elkhart IN 46514  
888-295-7859 ■ [www.dynamaxcorp.com](http://www.dynamaxcorp.com)