

2023 ENTEGRA COACH LAUNCH

# Launch

DIESEL CLASS B MOTORHOME



**ENTEGRA**  
COACH®







**19Y**

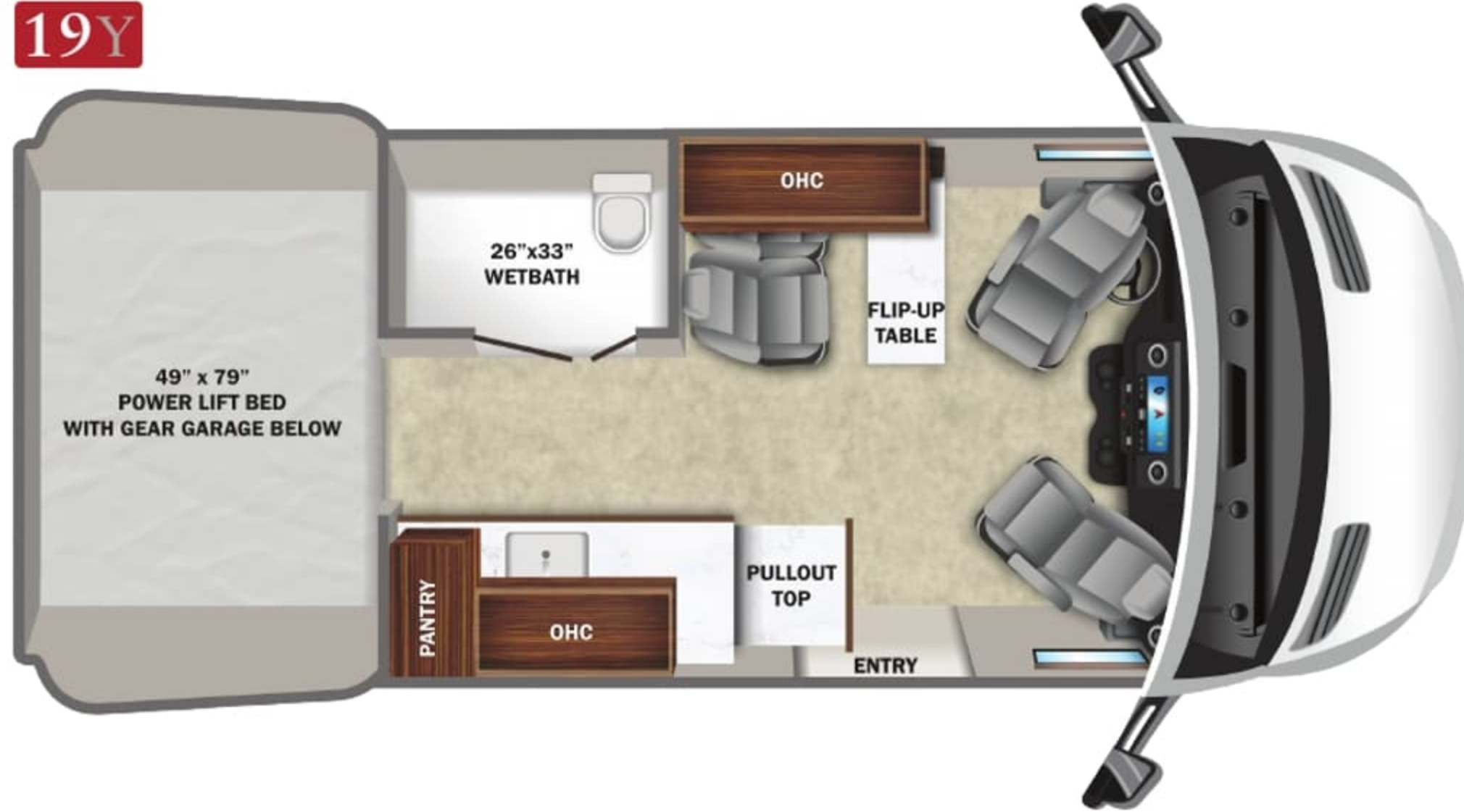

## EXTERIOR SELECTIONS



Silver Van



Sandstone Van



Blue-Grey Van



Aztec Partial Paint (Silver Van Only)



Forest Glade Partial Paint (Sandstone Van Only)



Mystic Tide Partial Paint (Blue-Grey Van Only)



## CUSTOMER VALUE PACKAGE

E-Z DRIVE™: Koni® shocks, heavy-duty rear stabilizer bar  
 Carefree® armless patio awning with LED light strip and wind sensor  
 Double roof rack and moveable roof ladder  
 Front and rear wind deflectors with front LED light bar  
 Timberline hydronic heating system with LED touchscreen control  
 13,500 BTU 48V Coleman®-Mach® 10 air conditioner  
 Black aluminum wheels with BFGoodrich® All-Terrain T/A® KO2® tires

## STANDARD EXTERIOR EQUIPMENT

Mercedes-Benz® Sprinter 2500 4x4 van with 144 in. wheelbase  
 GVWR - 9,050 lb.  
 GCWR - 13,930 lb.  
 3.0L V6 engine with 188HP and 325 ft.-lb. torque  
 7-speed automatic transmission  
 220 amp alternator  
 Daytime running headlamps  
 Power folding/heated side-view mirrors  
 5,000 lb. rear hitch receiver with 7 pin connector  
 12V chassis battery  
 24.5 gal. fuel tank (diesel)  
 5.8 gal DEF Tank  
 48V - 210 amp hour smart lithium battery providing 10KW hours of power  
 3,500W inverter  
 2nd alternator (48V) dedicated to lithium battery  
 30 amp electrical service with detachable power cord  
 200W of roof-mounted solar panels  
 Slow charge solar panel for chassis battery  
 Utility center with water controls and outside hose  
 City water connection  
 Winterization drain system  
 12V demand water pump  
 Water filtration system  
 House battery disconnect switch

Aqua View® SHOWERMISER™ water management system  
 Heated grey tank (12V pad) with skid plate  
 Interior-mounted fresh water tank  
 LED-lit running boards for cab and entry doors  
 110V exterior outlet  
 Portable solar plug  
 LED-lit holding tank valves  
 Side screen door with magnetic and zipper close offs  
 Rear screen door with roll-up and black out capabilities  
 Fold-down exterior table  
 On-board air compressor with front and rear chucks  
 Remote keyless entry

## STANDARD INTERIOR EQUIPMENT

10.25 in. MBUX infotainment center with GPS  
 Power windows and door locks  
 A/C and cruise control  
 Active distance assist DISTRONIC®  
 Active brake assist  
 Heated power swivel driver/passenger seats  
 Smartphone tray with wireless charging  
 Rain-sensing wiper system  
 Lane keeping assist  
 Blind spot assist  
 Traffic sign assist  
 Leather-wrapped tilt steering wheel with integrated controls  
 Cab area privacy shade  
 SoftFlex® interior wall panels  
 Soft-touch vinyl ceiling  
 High-intensity LED ceiling lights  
 Tecnoform® European-style, cabinetry  
 Tecnoform® pull-out kitchen countertop extension  
 Pantry  
 Durable rubber flooring  
 Firefly Multiplex system  
 (2) sliding vented windows  
 Rear dual-pane acrylic window with cassette shades  
 Removable privacy shade for sliding door window  
 MaxxAir Deluxe roof vent

(2) additional cab bucket seats with slide and recline features  
 Collapsible dinette table  
 3 cu.ft. DC refrigerator  
 Portable induction cooktop  
 Stainless steel sink  
 110V/USB outlets throughout  
 Drop-down overhead bed with 750 lb. capacity  
 Fiberglass side pods create larger sleeping surface  
 Rear garage under bed with L-track mounts for securing cargo  
 (2) recessed under-bed storage bags  
 All-in-one wet bath with shower and cassette toilet  
 Removable bamboo shelf in wet bath  
 Powered roof vent in bathroom  
 Retractable clothes line in shower  
 Seatbelts in all seating locations  
 Driver and passenger airbags  
 Smoke alarm  
 Carbon monoxide detector  
 Fire extinguisher

## WARRANTY



At Entegra Coach, we build our RVs to handle every adventure, then back them with an outstanding warranty. Our 2-year limited warranty has you covered for 2 camping seasons. That's 730 days. For a copy of our 2-year limited warranty with complete terms and conditions, please contact your local Entegra Coach dealer.

Floorplan	GVWR (lbs.)	GCWR (lbs.)	Wheel Base	Overall Length	Exterior Height w/ A/C & Satellite	Exterior Width	Interior Height	Fresh Water Capacity (gal.)	Grey Waste Water Capacity (gal.)	Black Waste Water Capacity (gal.)
19Y	9,050	13,930	144"	19' 7"	10' 1"	85"	73"	21	21	4.75

It is important for your safety and enjoyment that you are aware of the weights and tow ratings of the RV you select. Consult a competent advisor for questions or advice. Whether you are new to RVing or a veteran, get a feel for the performance of your RV before heading out on the roadways. When you tow a vehicle with your RV, you must drive differently than when you drive a single vehicle. Practice hooking up, driving, backing up and braking in a safe environment or seek out professional instruction. Jayco affixes a weight label to each RV which lists weight information for that vehicle. Refer to that label to verify the vehicle will meet your requirements. Gross Vehicle Weight Rating (GVWR): The maximum permissible weight of the motorhome, including the Unloaded Vehicle Weight (UVW) plus passengers, personal items, all cargo, fluids, options and dealer-installed accessories. The GVWR is equal to or greater than the sum of the UVW and the Cargo Carrying Capacity. Gross Combined Weight Rating (GCWR): The maximum allowable combined weight of the motorhome used as a tow vehicle and the attached towed vehicle.



Part of Jayco Family of Companies

Entegra Coach, Inc., P.O. Box 460, Middlebury, IN 46540, www.entegracoach.com. See dealer for further information and prices. All information in this brochure is the latest available at the time of publication approval. Entegra Coach reserves the right to make changes and to discontinue models without notice or obligation. Photos in this brochure may show optional equipment and props for photography purposes. RVs built for sale in Canada may differ to conform to Canadian codes. ©2023 Entegra Coach, Inc. Printed in U.S.A. 2032557.2023



entegracoach.com/launch