

**24B** Theater Sofa Option  
ILO Dinette

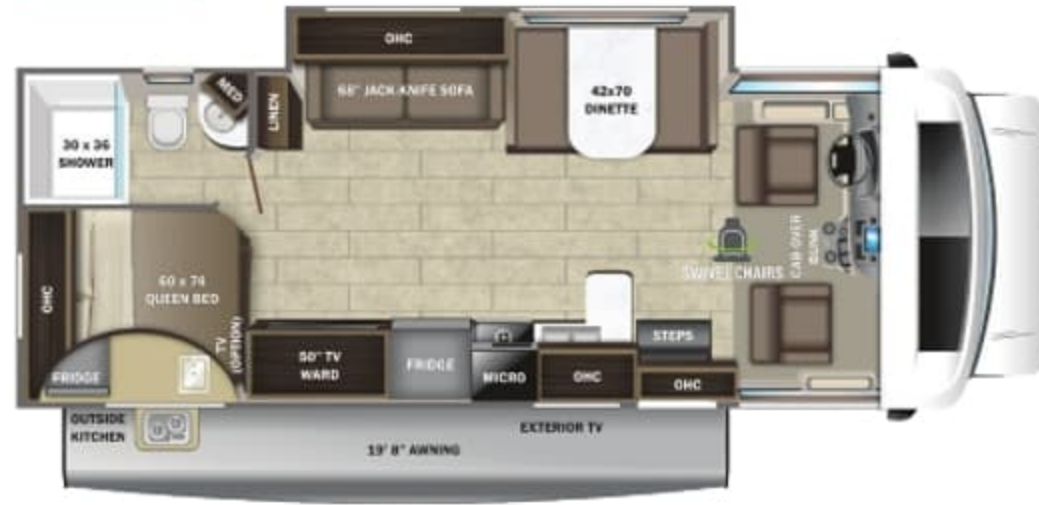

**25R** Theater Sofa Option



**26M** Theater Sofa Option  
ILO Dinette

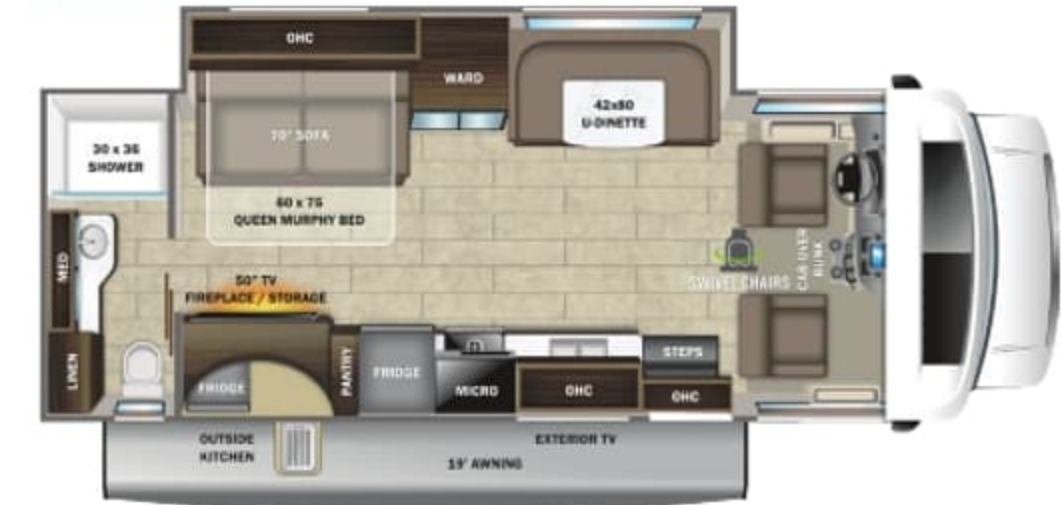

**27U**

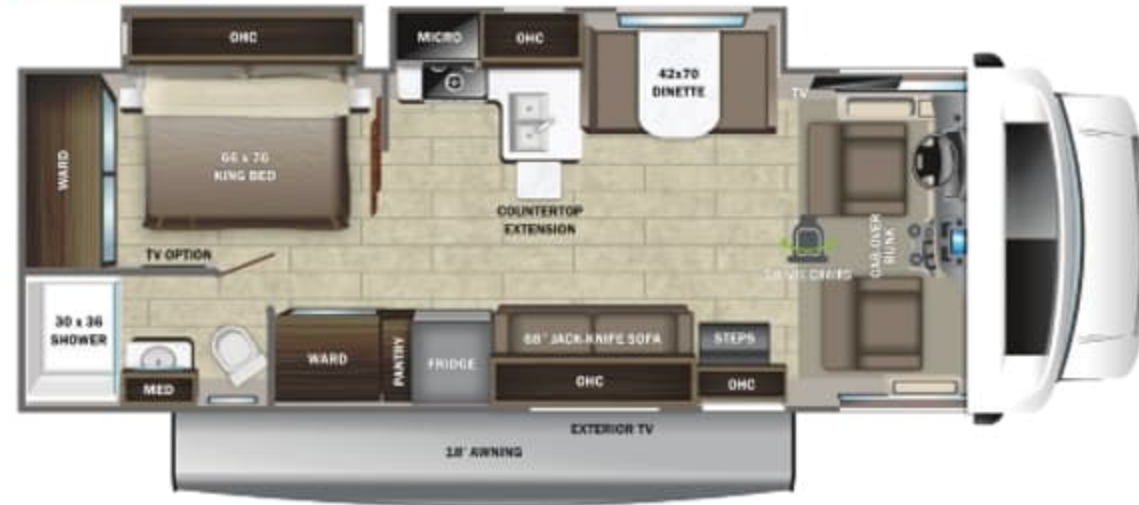

**29V** Theater Sofa Option

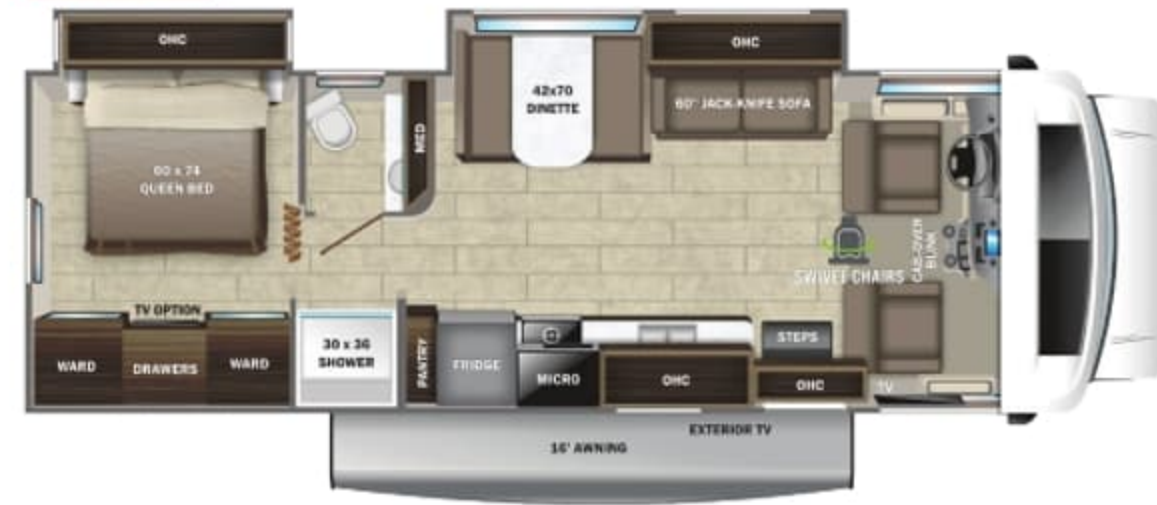

**30Z** Theater Sofa Option

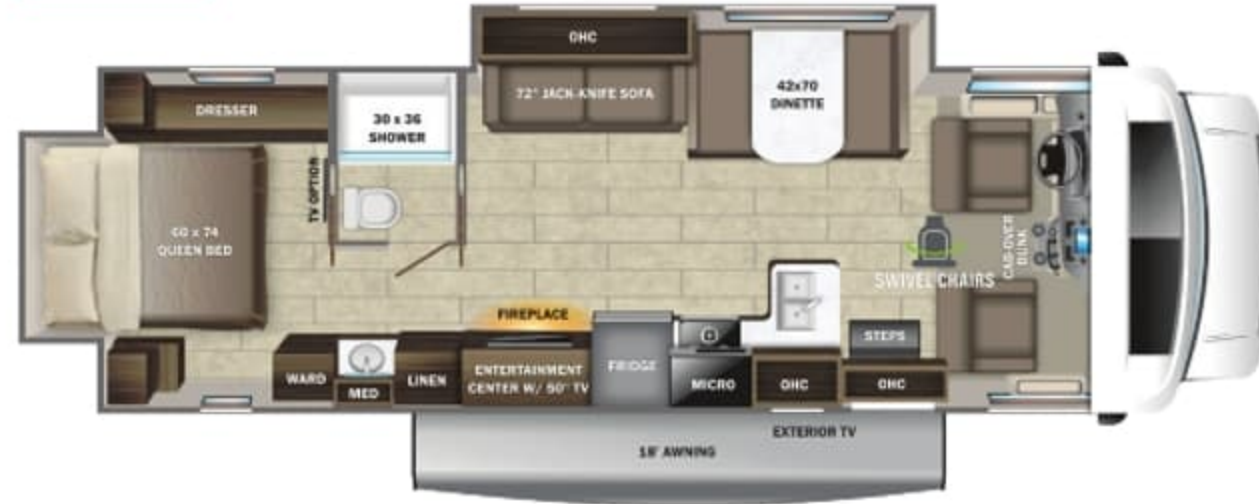

**31F**

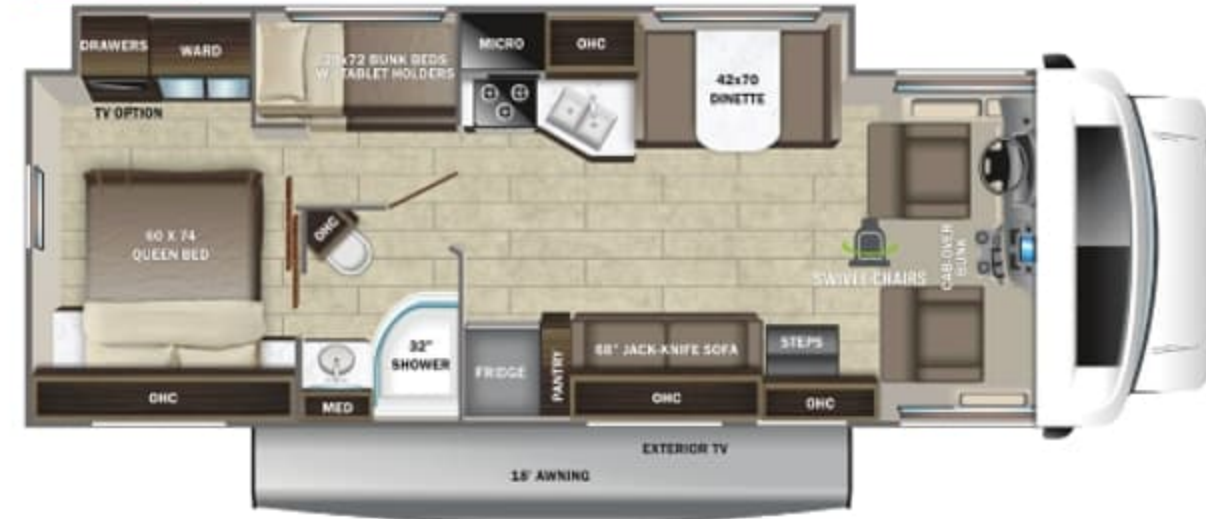

## INTERIOR DÉCOR

Carbon



Modern Farmhouse



## OPTIONS



Theater Sofa Option

## EXTERIOR SELECTIONS



Standard Graphics



Partial Paint Option



## CUSTOMER VALUE PACKAGE

E-Z DRIVE™: Computer-balanced driveshaft, standard front and rear stabilizer bars, Hellwig® helper springs, rubber isolation body mounts  
 One-piece, seamless fiberglass front cap  
 Automotive-bonded panoramic window in front cap with power shade  
 Frameless windows  
 Heated holding tanks (12V pads)  
 Electric patio awning with LED lights  
 Black tank flush  
 Sony® infotainment center with Apple CarPlay® and Android Auto™  
 Backup and side-view cameras  
 LED HD Smart TV in living area

## STANDARD EXTERIOR EQUIPMENT

Ford® E-450 chassis  
 GVWR - 14,500 lb.  
 GCWR - 22,000 lb.  
 7.3L V-8 350 HP engine with 468 ft.-lb. torque  
 6-speed TorqShift® series transmission with overdrive  
 210 amp alternator  
 E-rated highway tires- LT225/75R16  
 Power anti-lock brakes with power steering  
 7,500 lb. hitch with 750 lb. tongue capacity and 7-pin plug  
 12V chassis battery  
 55 gal. fuel tank  
 Onan® 4,000W MicroQuiet™ generator with auto-changeover  
 Transfer switch with reverse polarity protection  
 30 amp electrical service  
 12V house battery  
 1,000W inverter  
 Solar prep  
 15,000 BTU ducted A/C  
 30,000 BTU auto-ignition furnace  
 Electric fireplace (26M, 30Z)  
 6 gal. gas/electric DSI auto-ignition water heater  
 12.2 gal. propane tank (41 lb.)  
 LP quick-connect hookup  
 Exterior utility center  
 Winterization drain system  
 Outside shower  
 12V demand water pump  
 Water filtration system  
 TuffShell™ vacuum-bond laminated roof, floor and sidewalls  
 Bead-foam insulation (R-24 max roof, R-9 max floor, R-5 max walls)  
 One-piece, seamless, fiberglass roof

Aluminum running boards  
 Fiberglass exterior walls with vinyl graphics  
 Leveling jack prep  
 Remote-controlled, side-view mirrors  
 Entrance door with industry's largest travel-view window  
 Electric-powered entrance step with integrated house battery compartment  
 Slideout awning(s)  
 Pass-through storage compartment with light (select models)  
 Exterior LED HD Smart TV with (2) high-output, marine-grade exterior speakers  
 4 in. bumper tube sewer hose storage  
 Roof ladder (N/A 30Z)  
 Third brake light

## STANDARD INTERIOR EQUIPMENT

Remote keyless cab entry  
 Swivel driver and passenger seats  
 Tire pressure monitoring system (TPMS)  
 Power windows and door locks  
 A/C and cruise control  
 Tilt steering wheel  
 Auxiliary start switch  
 Privacy curtains for cab area  
 Custom-molded ABS surround in cab-over area  
 84 in. ceiling height  
 High-intensity recessed LED lights  
 LED-lit slideout fascia  
 Ball-bearing drawer guides  
 Pleated blackout shades  
 Interior command center  
 Entegra-exclusive, easy-operation legless dinette table  
 Interior entrance door grab handle  
 Prep for satellite dish  
 Cable TV hookup with RG-6 coax  
 Winegard 2.0 Wi-Fi/4G antenna  
 Furrion® all-in-one cooktop and oven  
 Residential-size microwave  
 LED-lit kitchen countertops  
 Recessed stainless steel kitchen sink with cutting board sink cover  
 Decorative kitchen backsplash  
 Pop-up charging station with 110 outlet and USB plugs  
 Shower with decorative surround, glass door, skylight and light  
 Recessed stainless steel bathroom sink  
 Porcelain toilet with foot flush  
 Powered roof vent in bathroom with wall switch  
 Queen-size bed with bedspread (king size in 27U only)

USB port and wireless charging in nightstands (27U, 29V, 30Z, 31F)  
 USB port in cabinet over bed (24B, 25R, 26M)  
 Under-bed storage (select models)  
 Bedroom TV prep  
 Large wardrobes  
 Overhead bunk with 750 lb. capacity and safety net  
 Bunks with industry-exclusive, 300 lb. capacity each (31F)  
 Wall-mounted tablet holder in each bunk (31F)  
 2-point lap safety belts in all designated seating locations  
 Driver and passenger airbags  
 Smoke alarm  
 Carbon monoxide detector

## OPTIONS

Theater seating (N/A 27U, 31F)  
 LED HD Smart TV in bedroom  
 Automatic hydraulic leveling jacks  
 190W solar panel with dual controller and second house battery  
 Dual A/C units with power management system (26M, 27U, 29V, 30Z, 31F)  
 Folding windshield sun shade

## WARRANTY



## NO ONE OFFERS A BETTER WARRANTY

At Entegra Coach, we build our RVs to handle every adventure, then back them with our industry-leading 2+3 limited warranty. Our 2-year limited warranty has you covered for 2 camping seasons. That's 730 days. In addition, our 3-year structural limited warranty has you covered for 3 camping seasons or 1,095 days. You won't find a better limited warranty in the business, because the only strings we attach are those that deliver the ultimate in reliability. For a copy of our 2-year limited + 3-year structural limited warranty with complete terms and conditions, please contact your local Entegra Coach dealer.

| Floorplan | GVWR (lbs.) | GCWR (lbs.) | Wheel Base | Overall Length | Exterior Height w/ A/C & Satellite | Exterior Width | Interior Height | Fresh Water Capacity (gal.) | Grey Waste Water Capacity (gal.) | Black Waste Water Capacity (gal.) |
|-----------|-------------|-------------|------------|----------------|------------------------------------|----------------|-----------------|-----------------------------|----------------------------------|-----------------------------------|
| 24B       | 14,500      | 22,000      | 181        | 26' 8"         | 11' 8"                             | 100            | 84              | 42.5                        | 40                               | 31                                |
| 25R       | 14,500      | 22,000      | 181        | 28' 8"         | 11' 8"                             | 100            | 84              | 38                          | 41                               | 32                                |
| 26M       | 14,500      | 22,000      | 181        | 28' 8"         | 11' 8"                             | 100            | 84              | 43.5                        | 40                               | 31                                |
| 27U       | 14,500      | 22,000      | 195        | 29' 11"        | 11' 8"                             | 100            | 84              | 42.5                        | 41                               | 31                                |
| 29V       | 14,500      | 22,000      | 223        | 32' 6"         | 11' 8"                             | 100            | 84              | 47                          | 41                               | 32                                |
| 30Z       | 14,500      | 22,000      | 223        | 32' 6"         | 11' 8"                             | 100            | 84              | 43.5                        | 41                               | 31                                |
| 31F       | 14,500      | 22,000      | 223        | 32' 6"         | 11' 8"                             | 100            | 84              | 47                          | 41                               | 31                                |

It is important for your safety and enjoyment that you are aware of the weights and tow ratings of the RV you select. Consult a competent advisor for questions or advice. Whether you are new to RVing or a veteran, get a feel for the performance of your RV before heading out on the roadways. When you tow a vehicle with your RV, you must drive differently than when you drive a single vehicle. Practice hooking up, driving, backing up and braking in a safe environment or seek out professional instruction. Jayco affixes a weight label to each RV which lists weight information for that vehicle. Refer to that label to verify the vehicle will meet your requirements. Gross Vehicle Weight Rating (GVWR): The maximum permissible weight of the motorhome, including the Unloaded Vehicle Weight (UVW) plus passengers, personal items, all cargo, fluids, options and dealer-installed accessories. The GVWR is equal to or greater than the sum of the UVW and the Cargo Carrying Capacity. Gross Combined Weight Rating (GCWR): The maximum allowable combined weight of the motorhome used as a tow vehicle and the attached towed vehicle.



Part of Jayco Family of Companies

Entegra Coach, Inc., P.O. Box 460, Middlebury, IN 46540, www.entegracoach.com. See dealer for further information and prices. All information in this brochure is the latest available at the time of publication approval. Entegra Coach reserves the right to make changes and to discontinue models without notice or obligation. Photos in this brochure may show optional equipment and props for photography purposes. RVs built for sale in Canada may differ to conform to Canadian codes. ©2022 Entegra Coach, Inc. Printed in U.S.A. 2032561.2023



entegracoach.com/odyssey