



Chart your own path.



Pleasure-Way | 2022
REKON **4x4**



Chart your own path.



Pleasure-Way | 2022
REKON **4x4**



MESSAGE FROM PW

Pleasure-Way Industries Ltd. is pleased to be celebrating its 36th year as a leader in the RV manufacturing industry. A family-owned and-operated business since its inception in 1986, Pleasure-Way is committed to building the highest-quality luxury motorhomes.

Pleasure-Way's unwavering commitment to quality, safety, and customer satisfaction is evident in the fact that we do not mass produce our motorhomes on assembly lines; rather each motorhome is hand-crafted and custom-fitted to exacting standards and rigorous quality inspections. Due to our meticulous, labour-intensive construction process, we are proud to have one of the lowest warranty claim rates in the entire RV industry. In fact, we are so confident in the quality of our motorhomes that we back each new Pleasure-Way with our Five Year Freedom Coach Warranty—one of the best and longest warranties in the industry.

We would never be where we are today without our team of dedicated and skilled employees, or without the enthusiastic support from our owners. We are deeply grateful for everyone that has been involved with Pleasure-Way over the past 36 years and we look forward to continuing to deliver a first-class RV experience.



WINNER OF TEN RVDA QUALITY CIRCLE AWARDS

This distinguished recognition reinforces our core company values of hard work, superior quality, and top-notch customer service.



MERCEDES-BENZ EXPERTUPFITTER

Pleasure-Way Industries Ltd. is recognized as an eXpertUpfitter by Mercedes-Benz.

MERCEDES-BENZ SPRINTER 2500 4x4



Fuel Type:	Diesel
Standard Engine:	3.0L V6 Diesel
Transmission:	7-Speed Automatic
Length: (bumper to bumper)	19' 5" / 593 cm
Overall Height:	9' 4" / 283.5 cm
Width:	7' 1" / 216 cm

Fresh Water Tank Capacity (heated):	40 US Gal / 151.4 L
Grey Water Tank Capacity (portable):	10 US Gal / 37.9 L
Towing Capacity:	5,000 lbs / 2,268 kg
O.C.C.C.:	1,650 lbs / 748 kg
Wheelbase:	144"
Ground Clearance:	11" / 28 cm





MESSAGE FROM PW

Pleasure-Way Industries Ltd. is pleased to be celebrating its 36th year as a leader in the RV manufacturing industry. A family-owned and-operated business since its inception in 1986, Pleasure-Way is committed to building the highest-quality luxury motorhomes.

Pleasure-Way's unwavering commitment to quality, safety, and customer satisfaction is evident in the fact that we do not mass produce our motorhomes on assembly lines; rather each motorhome is hand-crafted and custom-fitted to exacting standards and rigorous quality inspections. Due to our meticulous, labour-intensive construction process, we are proud to have one of the lowest warranty claim rates in the entire RV industry. In fact, we are so confident in the quality of our motorhomes that we back each new Pleasure-Way with our Five Year Freedom Coach Warranty—one of the best and longest warranties in the industry.

We would never be where we are today without our team of dedicated and skilled employees, or without the enthusiastic support from our owners. We are deeply grateful for everyone that has been involved with Pleasure-Way over the past 36 years and we look forward to continuing to deliver a first-class RV experience.



WINNER OF TEN RVDA QUALITY CIRCLE AWARDS

This distinguished recognition reinforces our core company values of hard work, superior quality, and top-notch customer service.



MERCEDES-BENZ EXPERTUPFITTER

Pleasure-Way Industries Ltd. is recognized as an eXpertUpfitter by Mercedes-Benz.

MERCEDES-BENZ SPRINTER 2500 4x4

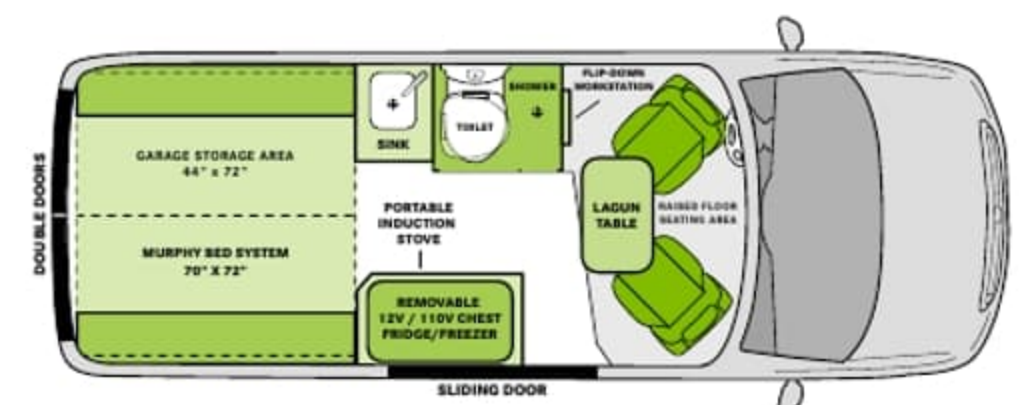

Fuel Type:	Diesel
Standard Engine:	3.0L V6 Diesel
Transmission:	7-Speed Automatic
Length: (bumper to bumper)	19' 5" / 593 cm
Overall Height:	9' 4" / 283.5 cm
Width:	7' 1" / 216 cm

Fresh Water Tank Capacity (heated):	40 US Gal / 151.4 L
Grey Water Tank Capacity (portable):	10 US Gal / 37.9 L
Towing Capacity:	5,000 lbs / 2,268 kg
O.C.C.C:	1,650 lbs / 748 kg
Wheelbase:	144"
Ground Clearance:	11" / 28 cm

THE 2022 REKON 4x4

Get ready to tackle uncharted terrain in the new Pleasure-Way REKON 4x4 adventure van. Built on the powerful Mercedes-Benz 2500 Sprinter 4x4 chassis, the REKON performs like nothing else in our line-up. Designed to satisfy the demand for a compact RV capable of extensive overlanding, the REKON offers the utmost freedom when choosing your next adventure.

A highlight of the REKON's practicality is the massive 40 gallon fresh water tank with ducted heat from the furnace. Paired with 3M Thinsulate insulation throughout the interior this combination will enhance your ability to remain off-the-grid in all weather conditions. Further support for off-grid living comes from the REKON's advanced power system. With a 400Ah lithium battery bank, 400-Watts of roof-mounted solar, and a 2000-Watt Pure-sine wave inverter, you can travel worry-free knowing your consumption needs will be fully backed. Gear up and get going effortlessly with the REKON's versatile storage solutions. The REKON Garage provides 124 cubic feet of storage with an integrated L-track tie-down system to easily secure your gear. Don't hesitate to utilize the 70" x 72" murphy bed as you will maintain 52 cubic feet of pass-through storage underneath. The REKON's dual-function wet bath/gear locker offers multiple storage configurations making optimal use of available space. All these innovative features add up to create the ultimate go-anywhere adventure van.

10-INCH TOUCHSCREEN CONTROL PANEL

CLIMATE CONTROL

The responsive touchscreen includes centralized control of the Truma VarioHeat furnace. Simply set your desired temperature and the control panel will automatically maintain from there.

BATTERY MONITORING

To enhance the already powerful 400Ah Eco-Ion lithium coach batteries, we have incorporated dynamic new features for smart, convenient and painless energy management.

12V Net Gain/Loss Amp Meter

This real-time amp meter shows you exactly how much 12V electricity you are consuming or how much free electricity you are gaining through your solar panels.

State-of-Charge Meter

View your current battery state-of-charge as a percentage in real-time.

Estimated Time Until Charge

While charging your coach batteries, the estimated time remaining until a full charge is achieved will be displayed.

Remaining Runtime for DC Power

You can now view the estimated time remaining on your coach battery charge with the current DC power draw of your motorhome. This feature pairs well with boondocking, as you now have an easy to understand read-out that will determine and even extend how long you can remain off-the-grid!

Battery Temperature Gauge

Located on the battery state-of-charge meter, the new gauge removes all guesswork to ensure the batteries are above freezing temperatures for safe charging.

GO POWER!® SOLAR INTEGRATION

Monitoring your solar panel charge volts and amps is now neatly included on the touchscreen. Additionally, inside the settings section of the solar charger module you can view the overall history of your solar panel amperage draw. This will give you an accurate picture of the average amount of amps the solar panels add to the coach batteries.



THE 2022 REKON 4x4

Get ready to tackle uncharted terrain in the new Pleasure-Way REKON 4x4 adventure van. Built on the powerful Mercedes-Benz 2500 Sprinter 4x4 chassis, the REKON performs like nothing else in our line-up. Designed to satisfy the demand for a compact RV capable of extensive overlanding, the REKON offers the utmost freedom when choosing your next adventure.

A highlight of the REKON's practicality is the massive 40 gallon fresh water tank with ducted heat from the furnace. Paired with 3M Thinsulate insulation throughout the interior this combination will enhance your ability to remain off-the-grid in all weather conditions. Further support for off-grid living comes from the REKON's advanced power system. With a 400Ah lithium battery bank, 400-Watts of roof-mounted solar, and a 2000-Watt Pure-sine wave inverter, you can travel worry-free knowing your consumption needs will be fully backed. Gear up and get going effortlessly with the REKON's versatile storage solutions. The REKON Garage provides 124 cubic feet of storage with an integrated L-track tie-down system to easily secure your gear. Don't hesitate to utilize the 70" x 72" murphy bed as you will maintain 52 cubic feet of pass-through storage underneath. The REKON's dual-function wet bath/gear locker offers multiple storage configurations making optimal use of available space. All these innovative features add up to create the ultimate go-anywhere adventure van.

10-INCH TOUCHSCREEN CONTROL PANEL

CLIMATE CONTROL

The responsive touchscreen includes centralized control of the Truma VarioHeat furnace. Simply set your desired temperature and the control panel will automatically maintain from there.

BATTERY MONITORING

To enhance the already powerful 400Ah Eco-Ion lithium coach batteries, we have incorporated dynamic new features for smart, convenient and painless energy management.

12V Net Gain/Loss Amp Meter

This real-time amp meter shows you exactly how much 12V electricity you are consuming or how much free electricity you are gaining through your solar panels.

State-of-Charge Meter

View your current battery state-of-charge as a percentage in real-time.

Estimated Time Until Charge

While charging your coach batteries, the estimated time remaining until a full charge is achieved will be displayed.

Remaining Runtime for DC Power

You can now view the estimated time remaining on your coach battery charge with the current DC power draw of your motorhome. This feature pairs well with boondocking, as you now have an easy to understand read-out that will determine and even extend how long you can remain off-the-grid!

Battery Temperature Gauge

Located on the battery state-of-charge meter, the new gauge removes all guesswork to ensure the batteries are above freezing temperatures for safe charging.

GO POWER!® SOLAR INTEGRATION

Monitoring your solar panel charge volts and amps is now neatly included on the touchscreen. Additionally, inside the settings section of the solar charger module you can view the overall history of your solar panel amperage draw. This will give you an accurate picture of the average amount of amps the solar panels add to the coach batteries.





STANDARD FEATURES



ECO-ION 400AH LITHIUM BATTERIES

The long-lasting, fast-charging and maintenance-free coach batteries offer superior power storage to support extended off-grid journeys.



2,000 WATT INVERTER

Allows you to power all the 120VAC outlets, including the induction stove, with the Eco-Ion lithium coach batteries when you are camping off-grid.



TRUMA VARIOHEAT FURNACE

This near-silent LP furnace features three automatic output levels, high air flow, and a three stage burner system, all combining to heat your coach quickly and efficiently.



FOUR SEASON COACH

With no water lines or tanks mounted on the exterior and 3M Thinsulate insulation providing a superior weather seal, the REKON is winter ready.



MURPHY BED SYSTEM

The 70" X 72" rear bed easily folds down while maintaining 52 cubic feet of storage below. Head room is maximized by using cargo nets as the rear storage solution.



STANDARD FEATURES



ECO-ION 400AH LITHIUM BATTERIES

The long-lasting, fast-charging and maintenance-free coach batteries offer superior power storage to support extended off-grid journeys.



2,000 WATT INVERTER

Allows you to power all the 120VAC outlets, including the induction stove, with the Eco-Ion lithium coach batteries when you are camping off-grid.



TRUMA VARIOHEAT FURNACE

This near-silent LP furnace features three automatic output levels, high air flow, and a three stage burner system, all combining to heat your coach quickly and efficiently.



FOUR SEASON COACH

With no water lines or tanks mounted on the exterior and 3M Thinsulate insulation providing a superior weather seal, the REKON is winter ready.



MURPHY BED SYSTEM

The 70" X 72" rear bed easily folds down while maintaining 52 cubic feet of storage below. Head room is maximized by using cargo nets as the rear storage solution.



40 GALLONS OF FRESH WATER

This massive holding tank is centrally located for proper weight distribution and heated from a dedicated furnace duct resulting in an extremely reliable fresh water source.



GARAGE WORKSTATION

Remove the cushions from the driver side bed to reveal the durable 22.5" x 72" workstation. This also acts as a significant expansion to your kitchen prep area.



TRUMA PORTABLE FRIDGE/FREEZER

This rugged, chest style refrigerator will fit 2.1 cubic feet of goods (or 96 cans) and is top-loading for convenient stocking.



TRUMA AQUAGO® COMFORT PLUS WATER HEATER

The 60k BTU stepless burner, recirculating water line, and mixing vessel deliver hot water on demand, at even temperatures, eliminating temperature spikes.



PRIVATE WET BATH & GEAR LOCKER

A cassette toilet, hand-held showerhead and heating vent make up the wet bath. Convert to a gear locker with the removable shelves and closet rods.



40 GALLONS OF FRESH WATER

This massive holding tank is centrally located for proper weight distribution and heated from a dedicated furnace duct resulting in an extremely reliable fresh water source.



GARAGE WORKSTATION

Remove the cushions from the driver side bed to reveal the durable 22.5" x 72" workstation. This also acts as a significant expansion to your kitchen prep area.



TRUMA PORTABLE FRIDGE/FREEZER

This rugged, chest style refrigerator will fit 2.1 cubic feet of goods (or 96 cans) and is top-loading for convenient stocking.



TRUMA AQUAGO® COMFORT PLUS WATER HEATER

The 60k BTU stepless burner, recirculating water line, and mixing vessel deliver hot water on demand, at even temperatures, eliminating temperature spikes.



PRIVATE WET BATH & GEAR LOCKER

A cassette toilet, hand-held showerhead and heating vent make up the wet bath. Convert to a gear locker with the removable shelves and closet rods.



GARAGE STORAGE AREA

The REKON Garage provides 124 cubic feet of customizable storage. The integrated L-Track tie-down system allows you to effectively secure all your gear.



SIDE ROLL-UP SCREEN

A magnetic closure system allows easy access in and out without the need to unzip the door. The super-fine mesh screen is constructed from flame-resistant nylon canvas, resulting in a long-lasting feature.



REAR ROLL-UP SCREEN

The heavy-duty nylon canvas screen precisely fits the rear opening and features a super-fine mesh, keeping insects out and only letting fresh air in. It rolls up and hides away when not needed.



GO POWER!® SOLAR

Extend your off-the-grid adventures with 400-Watts of solar power. This system will help keep your coach batteries charged for added peace of mind while camping.



BLACK RHINO WHEELS AND TOYO TIRES

This off-road package will support those who want maximum traction, long tread life, and extreme durability on all types of road conditions and terrain.



GARAGE STORAGE AREA

The REKON Garage provides 124 cubic feet of customizable storage. The integrated L-Track tie-down system allows you to effectively secure all your gear.



SIDE ROLL-UP SCREEN

A magnetic closure system allows easy access in and out without the need to unzip the door. The super-fine mesh screen is constructed from flame-resistant nylon canvas, resulting in a long-lasting feature.



REAR ROLL-UP SCREEN

The heavy-duty nylon canvas screen precisely fits the rear opening and features a super-fine mesh, keeping insects out and only letting fresh air in. It rolls up and hides away when not needed.



GO POWER!® SOLAR

Extend your off-the-grid adventures with 400-Watts of solar power. This system will help keep your coach batteries charged for added peace of mind while camping.



BLACK RHINO WHEELS AND TOYO TIRES

This off-road package will support those who want maximum traction, long tread life, and extreme durability on all types of road conditions and terrain.

COACH SPECIFICATIONS

INTERIOR

- Murphy bed system: 70" x 72"
- Lagun table mount system w/ 360° swivel tabletop
- Flip-down workstation (driver's seat)
- Privacy/sun shades for windshield & cab doors
- Side and rear door roll-up screens
- Soft close drawers
- Blum® cabinet hinges
- Flush-mount laminate cabinet doors
- Laminate-wrapped kitchen & wall partitions
- Premium vinyl flooring
- Fire extinguisher
- LP, CO & Smoke detectors

GALLEY

- 2.1 cu. ft. top-loading Truma 12V/110V portable fridge/freezer (holds 60L or 96 cans)
- Portable 1-burner induction stove
- 13" x 11" stainless steel sink
- Single-handle faucet
- 72" x 22.5" fold-down garage workstation

BATHROOM

- Private wet bath w/ handheld shower
- Swiveling cassette toilet
- Flexible shelving system w/ removable closet rods
- Ducted heat

GARAGE STORAGE

- Bed up garage storage area: 124 cu. ft.
- Bed down garage storage area: 52 cu. ft.
- Garage storage lighting
- L-track tie-down system
- Expansive cargo net storage system

HEATING & VENTILATION

- Truma VarioHeat 11,500 BTU furnace
- Dual bi-directional Fan-tastic Vent fans

PLUMBING & LP SYSTEMS

- Truma AquaGo® comfort plus instant water heater
- Shurflo® automatic demand water system
- LP BBQ quick connect
- Removable LP tank
- Portable grey water tanks

ELECTRICAL

- 4 x 100Ah Eco-Ion Earth Smart lithium (LiFePO4) batteries
- Xantrex™ 2000-Watt Pure-sine wave inverter
- Mastervolt Mac Plus DC-DC charger
- 80-amp lithium charger
- 12-volt coach battery disconnect
- Charge line disconnect (solar & alternator)
- Multiplex wiring
- Dimmable LED lighting
- 30-amp power cord
- USB charging ports
- 12V auxiliary power outlet
- 7 x 110-120V power outlets

TOUCHSCREEN CONTROL PANEL

- Dual 10-inch touchscreen control panels
- Coach battery state-of-charge meter
- Coach battery temperature gauge
- Estimated time until full charge read-out
- Remaining runtime for DC power read-out
- Solar charger controls and monitoring
- Real-time 12V net loss/gain amperage meter
- Tank level monitoring - fresh water
- Climate control center w/ thermostat
- Water pump and lighting controls
- DC electrical system diagnostics

EXTERIOR

- 400-Watt solar panel package
- GoPower!® MPPT solar controller
- Exterior perimeter lighting
- Power awning w/ LED lights
- Exterior shower w/ handheld wand
- City water connection
- 30-amp power outlet
- 110-120 volt power outlet
- Rear step above hitch
- Black Rhino Havasu wheels
- Toyo Open Country A/T III all-terrain tires (245/75R16)
- Tubular aluminum running boards

CHASSIS

- Mercedes-Benz Sprinter 2500 4x4
- Engine: 3.0 L V6 Diesel
- HP rating: 188 HP
- Torque rating: 325 ft-lb
- Transmission: 7-speed automatic
- Wheelbase: 144"
- Braking system: 4-wheel disc brakes w/ ABS
- Stability and traction control: Adaptive electronic
- Hitch and wiring: 4-pin / 7-pin connector
- Undermount spare tire

SAFETY FEATURES

- Active Brake Assist
- Active Distance Assist Distronic
- Traffic Sign Assist
- Attention Assist
- Active Lane Keeping Assist
- Blind Spot Assist
- Crosswind Assist

CAB CONVENIENCES

- MBUX Multimedia System w/ 10" Touchscreen
- Navigation
- Bluetooth® connectivity w/ audio streaming
- "Hey Mercedes" voice control
- Smartphone integration w/ hands-free function
- Multimedia interface w/ USB-C ports
- Driver and passenger swivel seats
- 360 degree rear view camera system
- Keyless ignition
- Air conditioning
- Power windows, door locks and mirrors
- Tilt / telescopic steering wheel
- Chassis battery quick-disconnect
- Overhead control panel w/ 2 reading lights

WEIGHTS AND MEASUREMENTS

- Length (bumper to bumper): 19' 5" / 593 cm
- Exterior Height: 9' 4" / 283.5 cm
- Exterior Width: 7' 1" / 216 cm
- Ground clearance height: 11" / 28 cm
- Fresh water tank (heated): 40 US Gal / 151.4 L
- Grey water tank (portable): 10 US Gal / 37.9 L
- Cassette toilet tank: 5 US gal / 18.9 L
- LP tank (removable): 20 lbs / 17.8 L
- Towing capacity: 5,000 lbs / 2,268 kg
- GVWR: 9,050 lbs / 4,100 kg
- GCWR: 13,930 lbs / 6,319 kg
- O.C.C.C: 1650 lbs / 748 kg

FOUR SEASON COACH

- Bathroom ducted heat for drying
- Interior fresh water tank with ducted heat
- 3M Thinsulate™ insulation
- No exterior water lines or tanks

PLEASE NOTE: Some Mercedes-Benz features listed may not be available on all chassis. Please see your Pleasure-Way dealer for complete details.

COACH SPECIFICATIONS

INTERIOR

- Murphy bed system: 70" x 72"
- Lagun table mount system w/ 360° swivel tabletop
- Flip-down workstation (driver's seat)
- Privacy/sun shades for windshield & cab doors
- Side and rear door roll-up screens
- Soft close drawers
- Blum® cabinet hinges
- Flush-mount laminate cabinet doors
- Laminate-wrapped kitchen & wall partitions
- Premium vinyl flooring
- Fire extinguisher
- LP, CO & Smoke detectors

GALLEY

- 2.1 cu. ft. top-loading Truma 12V/110V portable fridge/freezer (holds 60L or 96 cans)
- Portable 1-burner induction stove
- 13" x 11" stainless steel sink
- Single-handle faucet
- 72" x 22.5" fold-down garage workstation

BATHROOM

- Private wet bath w/ handheld shower
- Swiveling cassette toilet
- Flexible shelving system w/ removable closet rods
- Ducted heat

GARAGE STORAGE

- Bed up garage storage area: 124 cu. ft.
- Bed down garage storage area: 52 cu. ft.
- Garage storage lighting
- L-track tie-down system
- Expansive cargo net storage system

HEATING & VENTILATION

- Truma VarioHeat 11,500 BTU furnace
- Dual bi-directional Fan-tastic Vent fans

PLUMBING & LP SYSTEMS

- Truma AquaGo® comfort plus instant water heater
- Shurflo® automatic demand water system
- LP BBQ quick connect
- Removable LP tank
- Portable grey water tanks

ELECTRICAL

- 4 x 100Ah Eco-Ion Earth Smart lithium (LiFePO4) batteries
- Xantrex™ 2000-Watt Pure-sine wave inverter
- Mastervolt Mac Plus DC-DC charger
- 80-amp lithium charger
- 12-volt coach battery disconnect
- Charge line disconnect (solar & alternator)
- Multiplex wiring
- Dimmable LED lighting
- 30-amp power cord
- USB charging ports
- 12V auxiliary power outlet
- 7 x 110-120V power outlets

TOUCHSCREEN CONTROL PANEL

- Dual 10-inch touchscreen control panels
- Coach battery state-of-charge meter
- Coach battery temperature gauge
- Estimated time until full charge read-out
- Remaining runtime for DC power read-out
- Solar charger controls and monitoring
- Real-time 12V net loss/gain amperage meter
- Tank level monitoring - fresh water
- Climate control center w/ thermostat
- Water pump and lighting controls
- DC electrical system diagnostics

EXTERIOR

- 400-Watt solar panel package
- GoPower!® MPPT solar controller
- Exterior perimeter lighting
- Power awning w/ LED lights
- Exterior shower w/ handheld wand
- City water connection
- 30-amp power outlet
- 110-120 volt power outlet
- Rear step above hitch
- Black Rhino Havasu wheels
- Toyo Open Country A/T III all-terrain tires (245/75R16)
- Tubular aluminum running boards

CHASSIS

- Mercedes-Benz Sprinter 2500 4x4
- Engine: 3.0 L V6 Diesel
- HP rating: 188 HP
- Torque rating: 325 ft-lb
- Transmission: 7-speed automatic
- Wheelbase: 144"
- Braking system: 4-wheel disc brakes w/ ABS
- Stability and traction control: Adaptive electronic
- Hitch and wiring: 4-pin / 7-pin connector
- Undermount spare tire

SAFETY FEATURES

- Active Brake Assist
- Active Distance Assist Distronic
- Traffic Sign Assist
- Attention Assist
- Active Lane Keeping Assist
- Blind Spot Assist
- Crosswind Assist

CAB CONVENIENCES

- MBUX Multimedia System w/ 10" Touchscreen
- Navigation
- Bluetooth® connectivity w/ audio streaming
- "Hey Mercedes" voice control
- Smartphone integration w/ hands-free function
- Multimedia interface w/ USB-C ports
- Driver and passenger swivel seats
- 360 degree rear view camera system
- Keyless ignition
- Air conditioning
- Power windows, door locks and mirrors
- Tilt / telescopic steering wheel
- Chassis battery quick-disconnect
- Overhead control panel w/ 2 reading lights

WEIGHTS AND MEASUREMENTS

- Length (bumper to bumper): 19' 5" / 593 cm
- Exterior Height: 9' 4" / 283.5 cm
- Exterior Width: 7' 1" / 216 cm
- Ground clearance height: 11" / 28 cm
- Fresh water tank (heated): 40 US Gal / 151.4 L
- Grey water tank (portable): 10 US Gal / 37.9 L
- Cassette toilet tank: 5 US gal / 18.9 L
- LP tank (removable): 20 lbs / 17.8 L
- Towing capacity: 5,000 lbs / 2,268 kg
- GVWR: 9,050 lbs / 4,100 kg
- GCWR: 13,930 lbs / 6,319 kg
- O.C.C.C: 1650 lbs / 748 kg

FOUR SEASON COACH

- Bathroom ducted heat for drying
- Interior fresh water tank with ducted heat
- 3M Thinsulate™ insulation
- No exterior water lines or tanks

PLEASE NOTE: Some Mercedes-Benz features listed may not be available on all chassis. Please see your Pleasure-Way dealer for complete details.

EXTERIOR COLOR OPTIONS



Blue Grey



Tenorite Grey Metallic



Selenite Grey Metallic



WARRANTY

PLEASURE-WAY WARRANTY

All Pleasure-Way motorhomes are backed by our Five Year Freedom Warranty. Pleasure-Way Industries Ltd. warrants the specified new Pleasure-Way Motorhome free from defects in material and craftsmanship, on portions manufactured by Pleasure-Way Industries Ltd. under normal use and service.

Coverage - 5 years or 60,000 miles / 100,000 kms
Limited Warranty

MERCEDES-BENZ WARRANTY

Basic Limited Warranty

- Coverage - 3 years or
- 36,000 miles / 60,000 kms

Diesel Engine Limited Warranty

- Coverage - 5 years or
- 100,000 miles / 160,000 km

Roadside Assistance

- 3 years or 36,000 miles / 60,000 kms



PLEASURE-WAY PERSONAL ASSISTANT

We understand that it takes time to get completely familiarized with your new motorhome and all of its features. For this reason, you will be designated your very own Pleasure-Way Personal Assistant for the first 90 days of ownership!

Your P.A. is a specialized and knowledgeable member of the Pleasure-Way team who works right here in our manufacturing facility. Upon receiving the warranty registration of your new motorhome, your P.A. will provide you with their contact information. You will now have access to your Pleasure-Way P.A. six days a week, via a dedicated, toll-free phone number or email.

Your Pleasure-Way P.A. will be there to assist you in all matters pertaining to the operation of your Pleasure-Way motorhome. After your 90 day period expires, you will have all the confidence and knowledge to enjoy your new Pleasure-Way for years to come!



PLEASURE-WAY GOLIVE

You can now explore any current Pleasure-Way model from the comfort of your own home! This unique experience allows you to take a one-on-one personalized video tour with one of our friendly Pleasure-Way GoLive Agents. You will have full access to view any feature or component of our motorhomes via a one-way video call. Get expert advice and real time answers to all your questions with Pleasure-Way GoLive. Try it today! pleasureway.com/golive



302 Portage Avenue
Saskatoon, SK,
Canada S7J 4C6

Tel: 800.364.0189
www.pleasureway.com

facebook.com/PWindustries

youtube.com/user/pleasureway

@pleasurewayrv

@pleasurewayrv

Due to our policy of continuous improvements, Pleasure-Way Industries Ltd. reserves the right to make product changes at any time without notice and without incurring obligations whatsoever, including but not limited to: prices, styling, design, colors, construction, equipment, materials, and specifications. Some motorhomes depicted in the brochure may be shown with optional equipment. Please see your dealer for additional information or contact Pleasure-Way Industries Ltd. Estimated fuel consumption may vary depending on conditions and driving habits. Estimates are based on consumer feedback.

EXTERIOR COLOR OPTIONS



Blue Grey



Tenorite Grey Metallic



Selenite Grey Metallic



WARRANTY

PLEASURE-WAY WARRANTY

All Pleasure-Way motorhomes are backed by our Five Year Freedom Warranty. Pleasure-Way Industries Ltd. warrants the specified new Pleasure-Way Motorhome free from defects in material and craftsmanship, on portions manufactured by Pleasure-Way Industries Ltd. under normal use and service.

Coverage - 5 years or 60,000 miles / 100,000 kms

Limited Warranty

MERCEDES-BENZ WARRANTY

Basic Limited Warranty

- Coverage - 3 years or
- 36,000 miles / 60,000 kms

Diesel Engine Limited Warranty

- Coverage - 5 years or
- 100,000 miles / 160,000 km

Roadside Assistance

- 3 years or 36,000 miles / 60,000 kms



PLEASURE-WAY PERSONAL ASSISTANT

We understand that it takes time to get completely familiarized with your new motorhome and all of its features. For this reason, you will be designated your very own Pleasure-Way Personal Assistant for the first 90 days of ownership!

Your P.A. is a specialized and knowledgeable member of the Pleasure-Way team who works right here in our manufacturing facility. Upon receiving the warranty registration of your new motorhome, your P.A. will provide you with their contact information. You will now have access to your Pleasure-Way P.A. six days a week, via a dedicated, toll-free phone number or email.

Your Pleasure-Way P.A. will be there to assist you in all matters pertaining to the operation of your Pleasure-Way motorhome. After your 90 day period expires, you will have all the confidence and knowledge to enjoy your new Pleasure-Way for years to come!



PLEASURE-WAY GOLIVE

You can now explore any current Pleasure-Way model from the comfort of your own home! This unique experience allows you to take a one-on-one personalized video tour with one of our friendly Pleasure-Way GoLive Agents. You will have full access to view any feature or component of our motorhomes via a one-way video call. Get expert advice and real time answers to all your questions with Pleasure-Way GoLive. Try it today! pleasureway.com/golive



302 Portage Avenue
Saskatoon, SK,
Canada S7J 4C6

Tel: 800.364.0189
www.pleasureway.com

facebook.com/PWindustries

youtube.com/user/pleasureway

[@pleasurewayrv](https://twitter.com/pleasurewayrv)

[@pleasurewayrv](https://instagram.com/pleasurewayrv)

Due to our policy of continuous improvements, Pleasure-Way Industries Ltd. reserves the right to make product changes at any time without notice and without incurring obligations whatsoever, including but not limited to: prices, styling, design, colors, construction, equipment, materials, and specifications. Some motorhomes depicted in the brochure may be shown with optional equipment. Please see your dealer for additional information or contact Pleasure-Way Industries Ltd. Estimated fuel consumption may vary depending on conditions and driving habits. Estimates are based on consumer feedback.