

CLASS A

AFTERSHOCK



ELECTRIC BREEZE



HIGH VOLTAGE



RAZOR BLUE



38KB



38MB



CLASS C

WEATHERED CHERRY



29J



MOTOR CITY BLUES



ROCK N RED

OUTLAW®

CLASS A

AFTERSHOCK



ELECTRIC BREEZE



HIGH VOLTAGE



RAZOR BLUE



REGATTA



SANIBEL



38KB

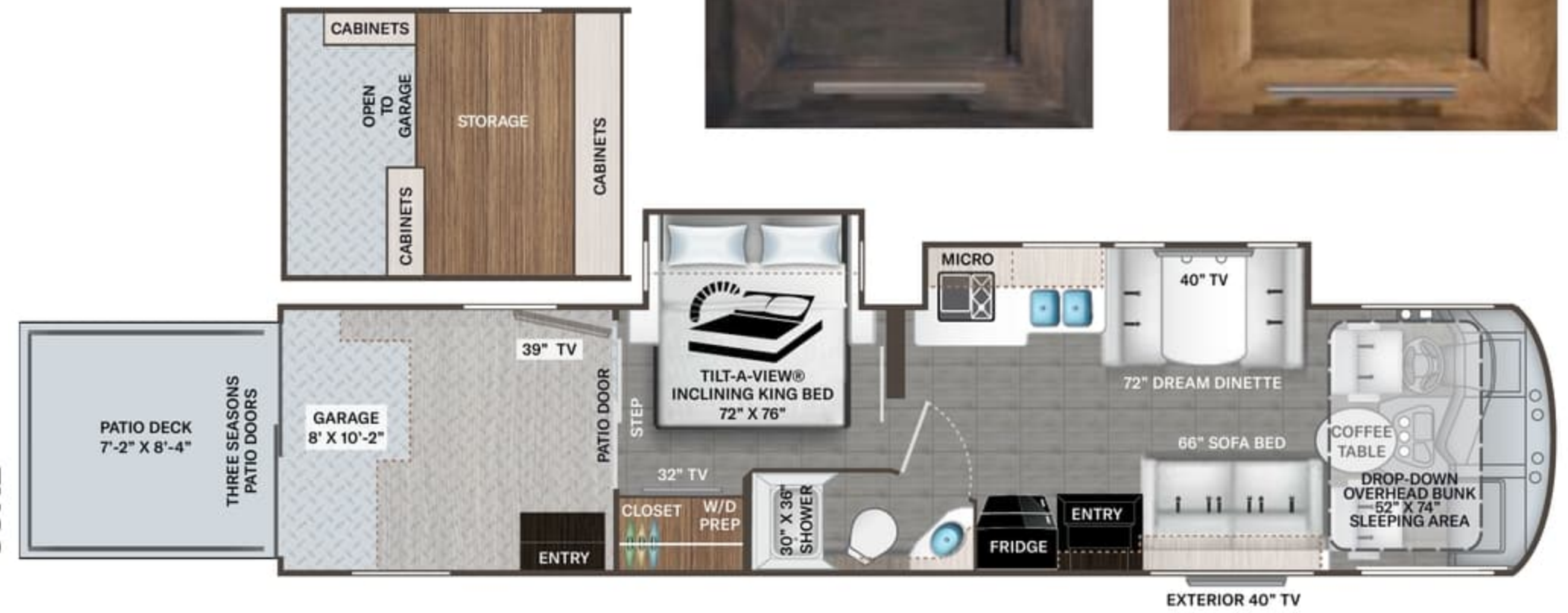

38MB



CLASS C

WEATHERED CHERRY



29J



MOTOR CITY BLUES



ROCK N RED

OUTLAW®

Class A Featured Highlights

CONSTRUCTION & EXTERIOR

- Ford® F-53 Chassis - 7.3L Triton® V8 Engine, 350HP, 468 lb.-ft. Torque - TorqShift® 6-Speed Automatic Transmission with Overdrive
- Full-Body Paint with Gel Coated Sidewalls & Invisible Front Mask Paint Protection
- Automatic Leveling Jacks with Touchpad Controls
- Basement Pass-Through Storage
- Power Patio Awning with Integrated LED Lighting
- Frameless Windows
- Pet-Link™ Multi-Purpose Tie-Down
- Remote Fuel Filling Station with Auxiliary Fuel Tank, Pump and Nozzle
- Garage Drop-Down Zero-G® Ramp Door, Snap-In Patio System & Power Patio Awning
- Three Seasons Patio Doors with Screen Privacy Panels
- Frameless Dual Pane Windows

AUTOMOTIVE & COCKPIT

- 10.1" Touchscreen Dash Radio with Bluetooth®, Apple CarPlay™, Android Audio® & Sirius/XM® Radio
- Steering Wheel Audio & Camera Control
- Back-Up Monitor
- Heated/Remote Exterior Mirrors with Integrated Side View Cameras
- Reclining/Swivel Leatherette Captain's Chairs with Stow-Away Coffee Table
- Tilt Steering Wheel
- Tilt and Telescoping Steering Wheel
- Automatic Headlights
- Emergency Engine Start Switch
- Power Roller Shade on Windshield
- Manual Roller Shades on Side Windows
- 22.5" Tires with Aluminum Wheels
- Valve Stem Extenders on Rear Wheels

- Dash Workstation with 110-volt & 12-volt Outlets
- Power Drop-Down Hide-Away Overhead Bunk with Cotton Cloud™ Mattress & Bunk Ladder

INTERIOR

- Residential Vinyl Flooring
- LED Lighting
- Satin Finish Cabinetry with Solid Wood Flat Panel Cabinet Doors & Nickel Finish Hardware
- Full Extension Metal Ball Bearing Drawer Guides
- Leatherette Sofa Bed
- Leatherette Dream Dinette® Booth with Cup Holders & Single Child Safety Tether
- Two (2) Opposing Jack-Knife Sofas in Garage
- Tread Plate Non-Slip Flooring, Tie Down Rings & Workshelf Storage Cabinet in Garage
- 12-volt Attic Fan in Garage
- Double Door Refrigerator
- 2-Burner High-Output Gas Range Top with Single Induction Cooktop
- 30" Over-the-Range Stainless Steel Convection Microwave Oven
- Kitchen Countertop LED Accent Lighting
- Solid Surface Countertops & Sink Cover
- Queen Size Bed with Bedsprad and Pillow Shams (38MB)
- King Size Bed with Tilt-A-View™ Inclining Bed Mechanism (38KB)
- Shower with Glass Door
- Oxygenics® Shower Head
- Showermiser® Hot Water Recycling System

ENTERTAINMENT

- 40" TV in Living Area
- Blu-Ray Player in Living Area
- 32" TV in Bedroom
- 40" TV in Garage with Swivel Bracket
- Exterior 40" TV on Swivel Bracket with Bluetooth® Soundbar & Radio

- USB Charging Ports - Bedroom & Living Area
- Winegard® Connect™ 2.0 WiFi / 4G / TV Antenna
- Satellite Mounting Backer in Roof

ELECTRICAL & PLUMBING

- Onan® RV QG 5500 Gas Generator
- Automatic Generator Start
- Automatic Transfer Switch with Power Protection
- 50-amp Shoreline Power Cord
- RapidCamp+® Multiplex Wiring Control System with 7" Screen & WiFi App-Enabled
- Dual Roof Air Conditioners
- 8,000 BTU Air Conditioner with Remote in Garage
- Four (4) Auxiliary House Batteries
- 100-watt Solar Charging System with Solar Controller
- 1800-watt Inverter
- 55-amp Converter
- Exterior LP Connection
- Enclosed & Heated Holding Tanks
- 360° Siphon® RV Holding Tank Vent Cap
- Black Tank Flush System
- Combo Washer/Dryer Prep (38KB)
- Outside Shower

For a complete listing of available features, visit thormotorcoach.com/outlaw-class-a.

Class C Featured Highlights

CONSTRUCTION & EXTERIOR

- Ford® E-Series Chassis
- Automatic Leveling Jacks with Touchpad Controls
- Slick Fiberglass Exterior with Graphics Package
- Power Patio Awning with Integrated LED Lighting
- Drop-Down Ramp Door, Patio Deck Railings & Manual Patio Awning
- Stainless Steel Storage Cabinet in Garage
- Bug Screen Curtain in Garage
- Removable Interior/Exterior Table for Garage & Patio

AUTOMOTIVE & COCKPIT

- 7" Touchscreen Dash Radio, Plug and Play Screen Mirroring with Back-Up Monitor
- Heated/Remote Exterior Mirrors with Integrated Side View Cameras
- Swivel Leatherette Captain's Chairs with Filler Cushions
- Valve Stem Extenders
- Stainless Steel Wheel Liners
- Aluminum Running Boards
- LED Taillights
- Dash Applique

INTERIOR

- High-Sheen Cabinet Doors with Nickel Finish Hardware
- Leatherette Jack-Knife Sofas and Removable Pedestal Table
- Wireless Phone Charger with USB Plug
- 12-volt Attic Fan with Cover in Cab-Over
- Queen Size Powered Drop-Down Bunk in Garage
- Shower with Anti-Bacterial Shower Curtain
- Double Door Refrigerator
- Recessed 3-Burner Gas Cooktop with Glass Cover
- Convection Microwave Oven

- 12-volt Vent in Kitchen
- 39" TV on Manual Swivel
- 32" TV in Living Area & Garage
- Exterior 32" TV on Swivel Bracket with Bluetooth® Built-in Sound Bar and Radio
- HDMI Video Distribution Box
- Bluetooth® Coach Radio System in Garage
- Power Charging Center for Electronics
- Winegard® Connect™ 2.0 WiFi / 4G / TV Antenna
- Satellite Mounting Backer in Roof

INTERIOR OPTION

- Cab-Over Child Safety Net

ELECTRICAL & PLUMBING

- 4000 kW Gas Generator
- 30-amp Shoreline Power Cord
- Automatic Transfer Switch with Power Protection
- Single Roof Air Conditioner
- 8,000 BTU Air Conditioner with remote in Garage
- Secondary Auxiliary House Battery
- Battery Tray for Four (4) Batteries
- 1,000-watt Entertainment Inverter
- Exterior LP Connection
- Tankless Water Heater
- Water Heater By-Pass
- Solar Prep - Includes Solar Controller
- Black Tank Flush System
- 360° Siphon® RV Holding Tank Vent Cap
- Holding Tanks with Heat Pads

For a complete listing of available features, visit thormotorcoach.com/outlaw-class-c.



	38MB	38KB
Chassis	Ford	Ford
Gross Vehicle (GVWR)	26,000	26,000
Gross Combined (GCWR)	30,000	30,000
Wheel Base	262"	262"
Exterior Length (w/o ladder)	39'-10"	39'-10"
Exterior Height (w/AC)	13'-3"	13'-3"
Exterior Width (w/o mirrors)	101"	101"
Interior Height (living area)	80" to 97"	80" to 97"
Awning Size	19'	18'
Fuel (gal)	80	80
LPG (lbs)	105	105
Fresh/Waste/Gray Water (gal)	150 / 40 / 40	150 / 40 / 40
Water Heater (gal)	Tankless	Tankless
Furnace (BTUs)	35,000	35,000
Exterior Storage Capacity (cu. ft.)	105	141
Garage Capacity (lbs)	1,400	1,200
Hitch Weight Rating (lbs)	8,000	8,000

	29J
Chassis	Ford
Gross Vehicle (GVWR)	14,500
Gross Combined (GCWR)	22,000
Wheel Base	219"
Exterior Length (w/o ladder)	31'-2"
Exterior Height (w/AC)	10'-10"
Exterior Width (w/o mirrors)	99"
Interior Height (living area)	84"
Awning Size	16'
Fuel (gal)	55
LPG (lbs)	40.9
Fresh/Waste/Gray Water (gal)	40 / 30 / 34.5
Water Heater (gal)	Tankless
Furnace (BTUs)	19,000
Exterior Storage Capacity (cu. ft.)	17.2
Garage Capacity (lbs)	1,000
Hitch Weight Rating (lbs)	8,000



IMPORTANT-PLEASE READ: This brochure reflects product design, fabrication, material, components and specifications at the date of printing, which date is disclosed below. Please visit us online at ThorMotorCoach.com or consult with your selling dealership for the latest in standards, options, specification and technical information. Photographs in the brochure may depict optional equipment or may only be available in certain floor plans. Components, appliances and the chassis may have been manufactured in a calendar year before the vehicle's designated model year. All capacities are approximate. The actual length of the vehicle may differ from that indicated in the brochure due to variances in the manufacturing processes and/or installed components. All dry weights are based on standard model features and do not include optional features or equipment. Component part and appliance manufacturers issue limited warranties covering portions of the vehicle not covered under the limited warranty we issue. Copyright Thor Motor Coach, Inc. © MY 04/01/2022

P.O. Box 1486, Elkhart, IN 46515 Sales Department: 800.860.5658

thormotorcoach.com/toy-haulers



Class A Featured Highlights

CONSTRUCTION & EXTERIOR

- Ford® F-53 Chassis - 7.3L Triton® V8 Engine, 350HP, 468 lb.-ft. Torque - TorqShift® 6-Speed Automatic Transmission with Overdrive
- Full-Body Paint with Gel Coated Sidewalls & Invisible Front Mask Paint Protection
- Automatic Leveling Jacks with Touchpad Controls
- Basement Pass-Through Storage
- Power Patio Awning with Integrated LED Lighting
- Frameless Windows
- Pet-Link™ Multi-Purpose Tie-Down
- Remote Fuel Filling Station with Auxiliary Fuel Tank, Pump and Nozzle
- Garage Drop-Down Zero-G® Ramp Door, Snap-In Patio System & Power Patio Awning
- Three Seasons Patio Doors with Screen Privacy Panels
- Frameless Dual Pane Windows

AUTOMOTIVE & COCKPIT

- 10.1" Touchscreen Dash Radio with Bluetooth®, Apple CarPlay™, Android Audio® & Sirius/XM® Radio
- Steering Wheel Audio & Camera Control
- Back-Up Monitor
- Heated/Remote Exterior Mirrors with Integrated Side View Cameras
- Reclining/Swivel Leatherette Captain's Chairs with Stow-Away Coffee Table
- Tilt Steering Wheel
- Tilt and Telescoping Steering Wheel
- Automatic Headlights
- Emergency Engine Start Switch
- Power Roller Shade on Windshield
- Manual Roller Shades on Side Windows
- 22.5" Tires with Aluminum Wheels
- Valve Stem Extenders on Rear Wheels

- Dash Workstation with 110-volt & 12-volt Outlets
- Power Drop-Down Hide-Away Overhead Bunk with Cotton Cloud™ Mattress & Bunk Ladder

INTERIOR

- Residential Vinyl Flooring
- LED Lighting
- Satin Finish Cabinetry with Solid Wood Flat Panel Cabinet Doors & Nickel Finish Hardware
- Full Extension Metal Ball Bearing Drawer Guides
- Leatherette Sofa Bed
- Leatherette Dream Dinette® Booth with Cup Holders & Single Child Safety Tether
- Two (2) Opposing Jack-Knife Sofas in Garage
- Tread Plate Non-Slip Flooring, Tie Down Rings & Workshelf Storage Cabinet in Garage
- 12-volt Attic Fan in Garage
- Double Door Refrigerator
- 2-Burner High-Output Gas Range Top with Single Induction Cooktop
- 30" Over-the-Range Stainless Steel Convection Microwave Oven
- Kitchen Countertop LED Accent Lighting
- Solid Surface Countertops & Sink Cover
- Queen Size Bed with Bedspread and Pillow Shams (38MB)
- King Size Bed with Tilt-A-View™ Inclining Bed Mechanism (38KB)
- Shower with Glass Door
- Oxygenics® Shower Head
- Showermi\$er Hot Water Recycling System

ENTERTAINMENT

- 40" TV in Living Area
- Blu-Ray Player in Living Area
- 32" TV in Bedroom
- 40" TV in Garage with Swivel Bracket
- Exterior 40" TV on Swivel Bracket with Bluetooth® Soundbar & Radio

- USB Charging Ports - Bedroom & Living Area
- Winegard® ConnecT™ 2.0 WiFi / 4G / TV Antenna
- Satellite Mounting Backer in Roof

ELECTRICAL & PLUMBING

- Onan® RV QG 5500 Gas Generator
- Automatic Generator Start
- Automatic Transfer Switch with Power Protection
- 50-amp Shoreline Power Cord
- RapidCamp+® Multiplex Wiring Control System with 7" Screen & WiFi App-Enabled
- Dual Roof Air Conditioners
- 8,000 BTU Air Conditioner with Remote in Garage
- Four (4) Auxiliary House Batteries
- 100-watt Solar Charging System with Solar Controller
- 1800-watt Inverter
- 55-amp Converter
- Exterior LP Connection
- Enclosed & Heated Holding Tanks
- 360° Siphon® RV Holding Tank Vent Cap
- Black Tank Flush System
- Combo Washer/Dryer Prep (38KB)
- Outside Shower

For a complete listing of available features, visit thormotorcoach.com/outlaw-class-a.

Class C Featured Highlights

CONSTRUCTION & EXTERIOR

- Ford® E-Series Chassis
- Automatic Leveling Jacks with Touchpad Controls
- Slick Fiberglass Exterior with Graphics Package
- Power Patio Awning with Integrated LED Lighting
- Drop-Down Ramp Door, Patio Deck Railings & Manual Patio Awning
- Stainless Steel Storage Cabinet in Garage
- Bug Screen Curtain in Garage
- Removable Interior/Exterior Table for Garage & Patio

AUTOMOTIVE & COCKPIT

- 7" Touchscreen Dash Radio, Plug and Play Screen Mirroring with Back-Up Monitor
- Heated/Remote Exterior Mirrors with Integrated Side View Cameras
- Swivel Leatherette Captain's Chairs with Filler Cushions
- Valve Stem Extenders
- Stainless Steel Wheel Liners
- Aluminum Running Boards
- LED Taillights
- Dash Applique

INTERIOR

- High-Sheen Cabinet Doors with Nickel Finish Hardware
- Leatherette Jack-Knife Sofas and Removable Pedestal Table
- Wireless Phone Charger with USB Plug
- 12-volt Attic Fan with Cover in Cab-Over
- Queen Size Powered Drop-Down Bunk in Garage
- Shower with Anti-Bacterial Shower Curtain
- Double Door Refrigerator
- Recessed 3-Burner Gas Cooktop with Glass Cover
- Convection Microwave Oven

- 12-volt Vent in Kitchen
- 39" TV on Manual Swivel
- 32" TV in Living Area & Garage
- Exterior 32" TV on Swivel Bracket with Bluetooth® Built-in Sound Bar and Radio
- HDMI Video Distribution Box
- Bluetooth® Coach Radio System in Garage
- Power Charging Center for Electronics
- Winegard® ConnecT™ 2.0 WiFi / 4G / TV Antenna
- Satellite Mounting Backer in Roof

INTERIOR OPTION

- Cab-Over Child Safety Net

ELECTRICAL & PLUMBING

- 4000 kW Gas Generator
- 30-amp Shoreline Power Cord
- Automatic Transfer Switch with Power Protection
- Single Roof Air Conditioner
- 8,000 BTU Air Conditioner with remote in Garage
- Secondary Auxiliary House Battery
- Battery Tray for Four (4) Batteries
- 1,000-watt Entertainment Inverter
- Exterior LP Connection
- Tankless Water Heater
- Water Heater By-Pass
- Solar Prep - Includes Solar Controller
- Black Tank Flush System
- 360° Siphon® RV Holding Tank Vent Cap
- Holding Tanks with Heat Pads

For a complete listing of available features, visit thormotorcoach.com/outlaw-class-c.

	38MB	38KB
Chassis	Ford	Ford
Gross Vehicle (GVWR)	26,000	26,000
Gross Combined (GCWR)	30,000	30,000
Wheel Base	262"	262"
Exterior Length (w/o ladder)	39'-10"	39'-10"
Exterior Height (w/AC)	13'-3"	13'-3"
Exterior Width (w/o mirrors)	101"	101"
Interior Height (living area)	80" to 97"	80" to 97"
Awning Size	19'	18'
Fuel (gal)	80	80
LPG (lbs)	105	105
Fresh/Waste/Gray Water (gal)	150 / 40 / 40	150 / 40 / 40
Water Heater (gal)	Tankless	Tankless
Furnace (BTUs)	35,000	35,000
Exterior Storage Capacity (cu. ft.)	105	141
Garage Capacity (lbs)	1,400	1,200
Hitch Weight Rating (lbs)	8,000	8,000



	29J
Chassis	Ford
Gross Vehicle (GVWR)	14,500
Gross Combined (GCWR)	22,000
Wheel Base	219"
Exterior Length (w/o ladder)	31'-2"
Exterior Height (w/AC)	10'-10"
Exterior Width (w/o mirrors)	99"
Interior Height (living area)	84"
Awning Size	16'
Fuel (gal)	55
LPG (lbs)	40.9
Fresh/Waste/Gray Water (gal)	40 / 30 / 34.5
Water Heater (gal)	Tankless
Furnace (BTUs)	19,000
Exterior Storage Capacity (cu. ft.)	17.2
Garage Capacity (lbs)	1,000
Hitch Weight Rating (lbs)	8,000



IMPORTANT—PLEASE READ: This brochure reflects product design, fabrication, material, components and specifications at the date of printing, which date is disclosed below. Please visit us online at ThorMotorCoach.com or consult with your selling dealership for the latest in standards, options, specification and technical information. Photographs in the brochure may depict optional equipment or may only be available in certain floor plans. Components, appliances and the chassis may have been manufactured in a calendar year before the vehicle's designated model year. All capacities are approximate. The actual length of the vehicle may differ from that indicated in the brochure due to variances in the manufacturing processes and/or installed components. All dry weights are based on standard model features and do not include optional features or equipment. Component part and appliance manufacturers issue limited warranties covering portions of the vehicle not covered under the limited warranty we issue. Copyright Thor Motor Coach, Inc. © MY 04/01/2022

P.O. Box 1486, Elkhart, IN 46515 Sales Department: 800.860.5658

thormotorcoach.com/toy-haulers

