

COACHMEN CHAPARRAL 5TH WHEELS 2024

CHAPARRAL



COACHMEN 5TH WHEELS
Leader to the Great Outdoors!



CHAPARRAL
LITE



CHAPARRAL
MID-PROFILE

2024

**RV'ING
MADE
SIMPLE**

“ For 2024, Coachmen 5th Wheels is setting a new bar in industry-leading quality & value for its customers. ”



WWW.COACHMENRV.COM/FIFTH-WHEELS

SCAN HERE FOR ADDITIONAL PHOTOS, 360 VIRTUAL TOURS, VIDEOS, EXTENDED LITERATURE DOWNLOADS, A COMPLETE LIST OF STANDARDS, OPTIONS AND MORE!



2024 COACHMEN CHAPARRAL 5TH WHEEL STAND-OUT FEATURES

2024



3RD DUCTED A/C PREP (368TBH LITE, 360IBL MID-PROFILE & LARGER)

(3RD DUCTED 15K BTU A/C OPTION 368TBH LITE, 360IBL MID-PROFILE & LARGER)

* = WHERE APPLICABLE

80% DARK TINTED WINDOWS

UV-RESISTANT FIBERGLASS CAP

TPO ROOF (12 YEAR WARRANTY)

ENERGY EFFICIENT LED LIGHTING

SIDE VIEW (X2) & REAR CAMERA PREP

3M[®] UV-TREATED DECALS (3-5 YEAR WARRANTY*)



WINEGUARD[®] AIR 360 +

ROOF-MOUNTED SOLAR PANEL

2" ACCESSORY RECEIVER HITCH*

PROTECTIVE SOLID REAR BUMPER

HEAVY DUTY GEAR-DRIVEN SLIDE ROOMS

SOLID STEP ENTRY (LARGER & WIDER TOP STEP!)

AZDEL 6X[™] SUPERIOR SIDEWALLS



A SOLID FOUNDATION

- LIONSHEAD[®] 5,2,1 NO EXCUSES GUARANTEE!
- ROAD ARMOR[®] SUSPENSION (360 DEGREE)
- ELECTRIC JACKS (AUTO-LEVEL OPTIONS)
- STEEL BELTED G-RATED TIRES (7K AXLE ONLY)



INTERIOR CONVENIENCE PACKAGE



GETAWAY+[™]

HEATED, INSULATED, & ENCLOSED UNDERBELLY

- RADIANT BARRIER INSULATION & CORRUGATED ARMOR
- SECTIONALIZED PANELS FOR EASE OF ACCESS
- 12V THERMAL TANK HEATERS (ALL SERIES)
- FURNACE-FORCED, RECIRCULATING HEAT
- HEATED & ENCLOSED GATE VALVES

EXTERIOR CONVENIENCE PACKAGE



ROAD GUARDIAN +[™]



WEATHER SHIELD +[™]



SOLAR PANEL PACKAGE



SOLAR SOURCE+[™]

AZDEL ON BOARD!



AZDEL 6X[™]

CHAPARRAL



LITE SERIES 5TH WHEELS LEADER TO THE GREAT OUTDOORS!



2024

CHAPARRAL LITE 5TH WHEELS



ALL NEW!

235RK

27'-3", 6,950# (UVW)



25RE

29'-10", 7,273# (UVW)



ALL NEW!

254RLS

30'-9", 7,512# (UVW)



274BH

35'-11", 8,692# (UVW)



284RL

34'-2", 8,908# (UVW)

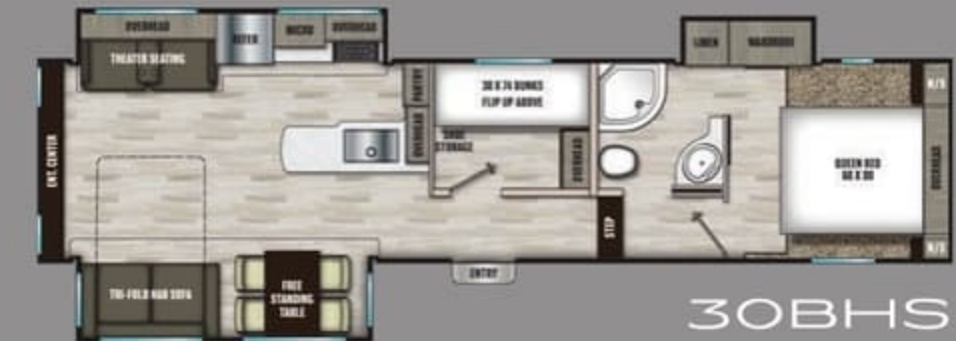

30BHS

37', 9,535# (UVW)



30RLS

34'-2", 8,981# (UVW)



ALL NEW!

368TBH

42', 9,850# (UVW)

* = WHERE APPLICABLE

SPECIFICATIONS

MODEL	235RK	25RE	254RLS	274BH	284RL	30BHS	30RLS	368TBH
CARRYING CAPACITY (LBS)	1890	2527	2288	2308	2592	1965	2019	2650
UVW (LBS)	6950	7273	7512	8692	8908	9535	8981	9850
GVWR (LBS)	8900	9800	9800	11000	11500	11500	11000	12500
HITCH WEIGHT	1194	1115	1388	1420	1434	1553	1445	1974
EXTERIOR HEIGHT (STANDARD A/C ONLY)	12'	12'	12'	12'	12'	12'	12'	12' 2"
FRESH WATER CAPACITY (GAL)	40	40	40	40	40	40	40	40
GREY WATER CAPACITY (GAL)	66	33	33	66	66	66	66	99
WASTE WATER CAPACITY (GAL)	33	33	33	33	33	33	33	66
AWNING LENGTH	18'	13'	20'	16'	11'	15'	11'	18'
WHEEL SIZE	15"	15"	15"	15"	15"	15"	15"	16"
EXTERIOR LENGTH (BUMPER TO CAP)	27' 3"	29' 10"	30' 9"	35' 11"	34' 2"	37'	34' 2"	42'
INTERIOR HEIGHT	81"	81"	81"	81"	81"	81"	81"	81"
AXLE RATING (LBS)	5100	5100	5100	5100	5100	5100	5100	7000
TIRE SIZE	15" E	15" E	15" E	15" E	15" E	15" E	15" E	16" G

• 2ND A/C OPTIONAL • AUTO-LEVEL OPTIONAL • 3RD A/C OPTIONAL (368TBH ONLY)

ALL INFORMATION CONTAINED IN THIS PUBLICATION IS BELIEVED TO BE ACCURATE AT THE TIME OF PRINT. HOWEVER, DURING THE MODEL YEAR, IT MAY BE NECESSARY TO MAKE REVISIONS AND COACHMEN RESERVES THE RIGHT TO MAKE ALL SUCH CHANGES WITHOUT NOTICE, INCLUDING PRICES, COLORS, MATERIALS, EQUIPMENT AND SPECIFICATIONS, AS WELL AS THE ADDITION OF NEW MODELS AND THE DISCONTINUANCE OF MODELS SHOWN. THEREFORE, PLEASE CONSULT WITH YOUR COACHMEN DEALER AND CONFIRM THE EXISTENCE OF ANY MATERIALS, DESIGN OR SPECIFICATIONS THAT ARE MATERIAL TO YOUR PURCHASE DECISION. STANDARDS, OPTIONS, AND PACKAGES MAY VARY BY SERIES. COPYRIGHT COACHMEN 5TH WHEELS 2024. *+ WHERE APPLICABLE. (REVISION 11-30-23)

CHAPARRAL

COACHMEN 5TH WHEELS
Leader to the Great Outdoors!



ALL NEW!



336TSIK SHOWN

SHIMMER DECOR



375BAF SHOWN

SLATE DECOR

2024 COACHMEN RV
A DIVISION OF FOREST RIVER, INC.,
A BERKSHIRE HATHAWAY COMPANY
ALL RIGHTS RESERVED.



Learn More
Scan this barcode using
a QR Reader on your
smart phone to learn
more about Forest River.



A Berkshire Hathaway company.

CUSTOMER SATISFACTION



PRE-DELIVERED INSPECTOR PICK!
13,107 square feet of quality craftsmanship. The best materials for a premium product.
The extra-deliverables include your personal deck, lockbox to protect your goods
and more... it's all here!

A LEADER IN QUALITY

WWW.COACHMENRV.COM/FIFTH-WHEELS

www.ForestRiverBuyLocal.com