

2024 ENTEGRA COACH ESTEEM

# Esteem

GAS CLASS C MOTORHOME



**ENTEGRA**  
COACH®





27U

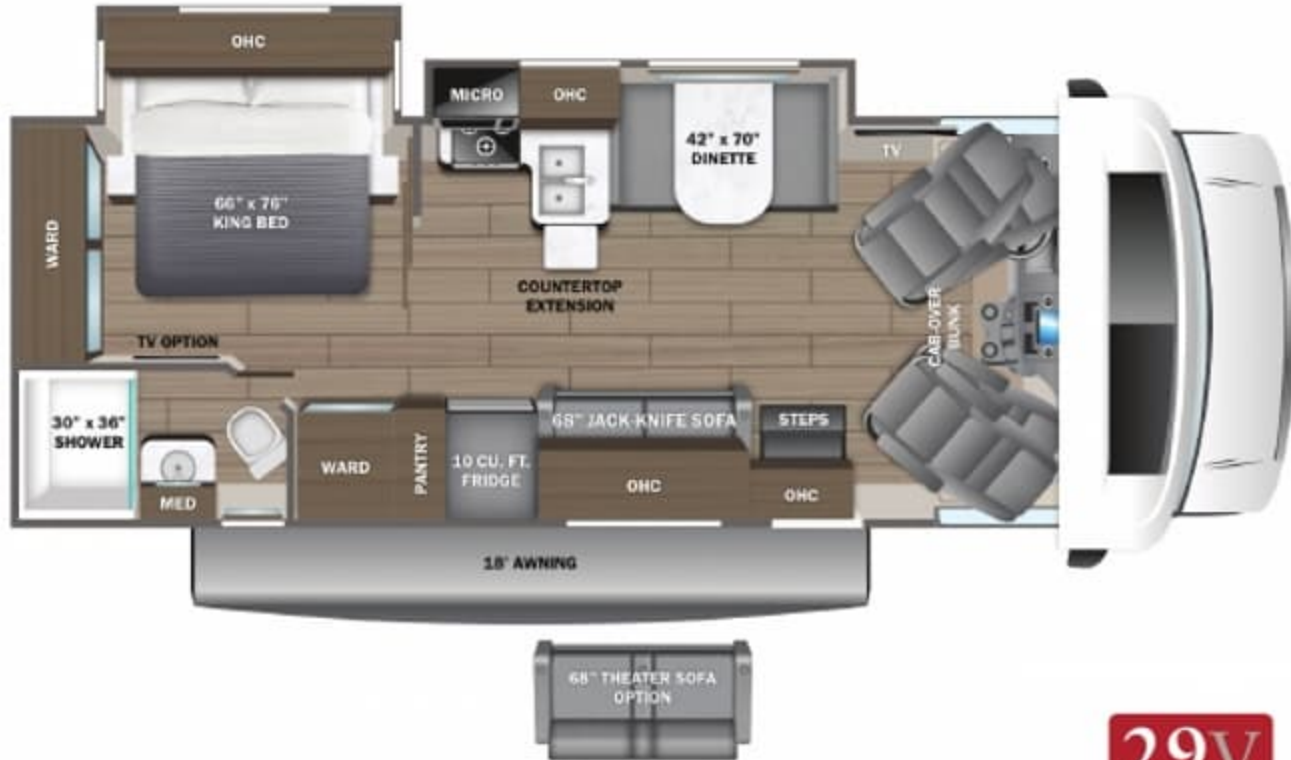

29V

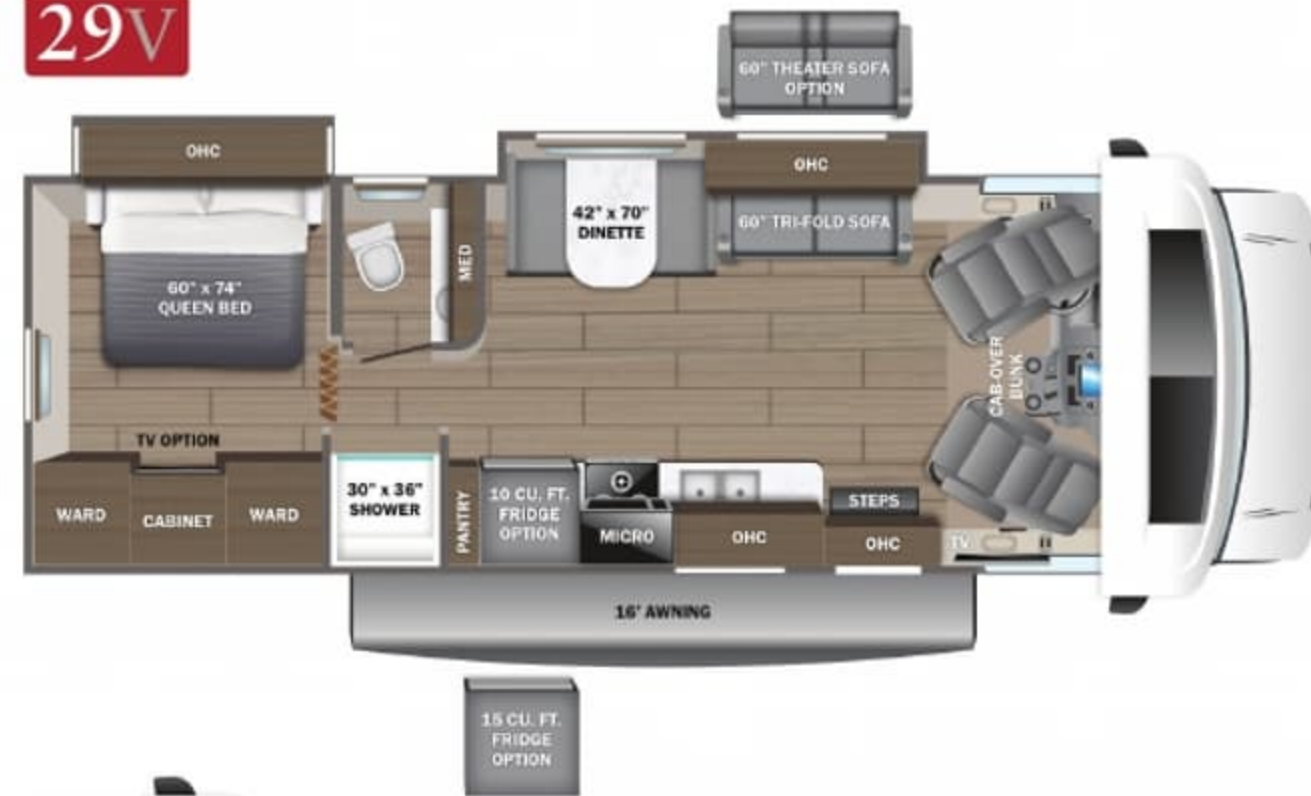

31F



## EXTERIOR SELECTIONS



Standard Partial Paint



North Star Full-Body Paint



Pearl Full-Body Paint



Stardust Full-Body Paint



Tidal Mist Full-Body Paint

## CUSTOMER VALUE PACKAGE

- E-Z Drive™ Elite: Computer-balanced driveshaft, Koni® FSD shocks, heavy-duty rear stabilizer bar, standard front stabilizer bar, Hellwig® helper springs, rubber isolation mounts
- One-piece, seamless fiberglass front cap
- Automotive-bonded panoramic window in front cap with power shade
- Automatic hydraulic leveling jacks
- Frameless windows
- Electric patio awning with LED lights
- Exterior LED HD Smart TV with (2) high-output, marine-grade exterior speakers
- 1,000W inverter
- Chrome, heated, remote-controlled, side-view mirrors
- Sony® infotainment center with Apple CarPlay® and Android Auto™
- Backup and side-view cameras
- LED-lit, solid-surface kitchen countertops

## CHASSIS

- Ford® E-450 chassis
- GVWR - 14,500 lb.
- GCWR - 22,000 lb.
- 7.3L V-8 325 HP engine with 450 ft.-lb. torque
- 6-speed TorqShift® series transmission with overdrive
- 210-amp alternator
- Catalytic converter theft protection
- E-rated highway tires- LT225/75R16
- Tire pressure monitoring system (TPMS)
- Power anti-lock brakes with power steering
- 7,500 lb. hitch with 750 lb. tongue capacity and 7-pin plug
- 12V chassis battery
- 55 gal. fuel tank

## EXTERIOR

- TuffShell™ vacuum-bond laminated roof, floor and sidewalls
- Bead-foam insulation (R-24 max roof, R-9 max floor, R-5 max walls)
- One-piece, seamless, fiberglass roof
- Fiberglass running boards
- Fiberglass side wings
- Fiberglass exterior walls with partial paint and vinyl graphics
- Remote keyless cab entry
- Entrance door with industry's largest travel-view window
- Electric-powered entrance step with integrated house battery compartment
- Slideout awning(s)
- Lockable storage compartments with slam latches
- Third brake light
- Roof ladder
- 4 in. bumper tube sewer hose storage
- Prep for satellite dish
- Cable TV hookup with RG-6 coax
- Winegard 2.0 Wi-Fi/4G antenna
- Onan® 4,000W MicroQuiet™ generator with auto-changeover
- 200W solar panel with dual controller and second house battery

- 12V house battery
- Transfer switch with reverse polarity protection
- 30-amp electrical service
- 16.5 gal. propane tank (56 lb.)
- LP quick-connect hookup
- Heated holding tanks (12V pads)
- Exterior utility center
- Winterization drain system
- Black tank flush
- Outside shower
- 12V demand water pump
- Water filtration system

## COCKPIT

- Swivel driver and passenger seats
- Tilt steering wheel
- Driver and passenger airbags
- Power windows and door locks
- Cruise control
- Hill start assist
- Electronic stability control
- Traction control
- Auxiliary start switch
- Custom-molded ABS surround in cab-over area
- Overhead bunk with 750 lb. capacity and safety net
- Privacy curtain for cab area

## INTERIOR

- BMAPRO total coach control system with wall-mounted touchscreen and mobile app
- 84 in. interior ceiling height with padded vinyl ceiling
- High-intensity recessed LED ceiling lights
- LED-lit fascia with decorative insert
- Hardwood cabinet doors and drawer fronts
- Ball-bearing drawer guides
- Blackout night roller shades
- 15,000 BTU A/C with heat pump
- 30,000 BTU auto-ignition furnace
- 6 gal. gas/electric DSI auto-ignition water heater
- Entegra-exclusive, easy-operation legless dinette table
- 2-point lap safety belts in all designated seating locations
- Car seat tethers (select floorplans)
- LED HD Smart TV in living area
- Smoke alarm
- Carbon monoxide detector
- Fire extinguisher

## KITCHEN

- 10 cu. ft. 12V refrigerator
- Furrion® all-in-one cooktop and oven
- Residential-size microwave
- Recessed stainless steel kitchen sink with solid-surface covers

- Flip-up countertop extension (select models)
- Decorative kitchen backsplash
- Pop-up charging station in kitchen with 120V outlets and USB ports

## BEDROOM

- Walk-around, queen-size bed with bedspread and nightstands (king size in 27U)
- USB port and wireless charging in nightstands
- Under-bed storage (select models)
- Large wardrobes
- Bunks with industry-exclusive 300 lb. capacity each (31F)
- Wall-mounted tablet holder in each bunk (31F)

## BATHROOM

- Shower with decorative surround, glass door, skylight and light
- Recessed stainless steel bathroom sink
- Porcelain toilet with foot flush
- Powered roof vent in bathroom with wall switch

## OPTIONS

- Power theater seating (29V)
- 15 cu. ft. 12V refrigerator (29V)
- LED HD Smart TV in bedroom
- Dual A/C units with energy management system
- Aluminum rims
- Folding windshield sun shade

## WARRANTY

**2+3**  
YEAR | YEAR  
LIMITED | STRUCTURAL  
WARRANTY

**NO ONE OFFERS  
A BETTER WARRANTY**

At Entegra Coach, we build our RVs to handle every adventure, then back them with our industry-leading 2+3 limited warranty. Our 2-year limited warranty has you covered for 2 camping seasons. That's 730 days. In addition, our 3-year structural limited warranty has you covered for 3 camping seasons or 1,095 days. You won't find a better limited warranty in the business, because the only strings we attach are those that deliver the ultimate in reliability. For a copy of our 2-year limited + 3-year structural limited warranty with complete terms and conditions, please contact your local Entegra Coach dealer.

It is important for your safety and enjoyment that you are aware of the weights and tow ratings of the RV you select. Consult a competent advisor for questions or advice. Whether you are new to RVing or a veteran, get a feel for the performance of your RV before heading out on the roadways. When you tow a vehicle with your RV, you must drive differently than when you drive a single vehicle. Practice hooking up, driving, backing up and braking in a safe environment or seek out professional instruction. Jayco affixes a weight label to each RV which lists weight information for that vehicle. Refer to that label to verify the vehicle will meet your requirements. Gross Vehicle Weight Rating (GVWR): The maximum permissible weight of the motorhome, including the Unloaded Vehicle Weight (UVW) plus passengers, personal items, all cargo, fluids, options and dealer-installed accessories. The GVWR is equal to or greater than the sum of the UVW and the Cargo Carrying Capacity. Gross Combined Weight Rating (GCWR): The maximum allowable combined weight of the motorhome used as a tow vehicle and the attached towed vehicle.

Floorplan	GVWR (lbs.)	GCWR (lbs.)	Wheel Base	Overall Length	Exterior Height w/ A/C & Satellite	Exterior Width	Interior Height	Fresh Water Capacity (gal.)	Grey Waste Water Capacity (gal.)	Black Waste Water Capacity (gal.)
27U	14,500	22,000	195	29' 11"	11' 8"	100	84	42.5	41	31
29V	14,500	22,000	223	32' 6"	11' 8"	100	84	47	41	32
31F	14,500	22,000	223	32' 6"	11' 8"	100	84	47	41	31



Part of Jayco Family of Companies

Entegra Coach, Inc., P.O. Box 460, Middlebury, IN 46540, www.entegracoach.com. See dealer for further information and prices. All information in this brochure is the latest available at the time of publication approval. Entegra Coach reserves the right to make changes and to discontinue models without notice or obligation. Photos in this brochure may show optional equipment and props for photography purposes. RVs built for sale in Canada may differ to conform to Canadian codes. ©2023 Entegra Coach, Inc. Printed in U.S.A. 2032825.2024



entegracoach.com/esteem