

2024 ENTEGRA COACH ETHOS

Ethos

GAS CLASS B MOTORHOME

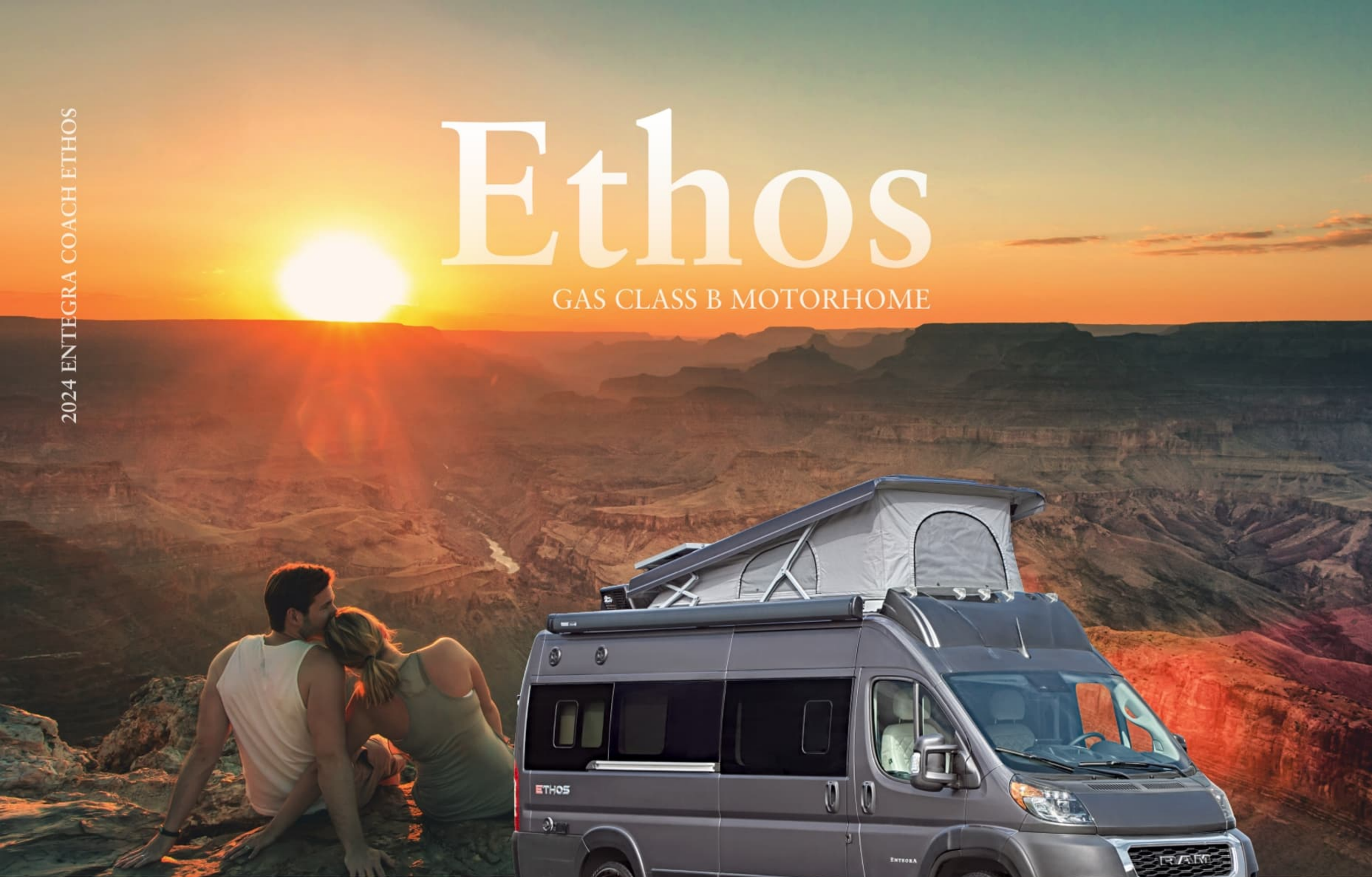

ENTEGRA
COACH®





20A

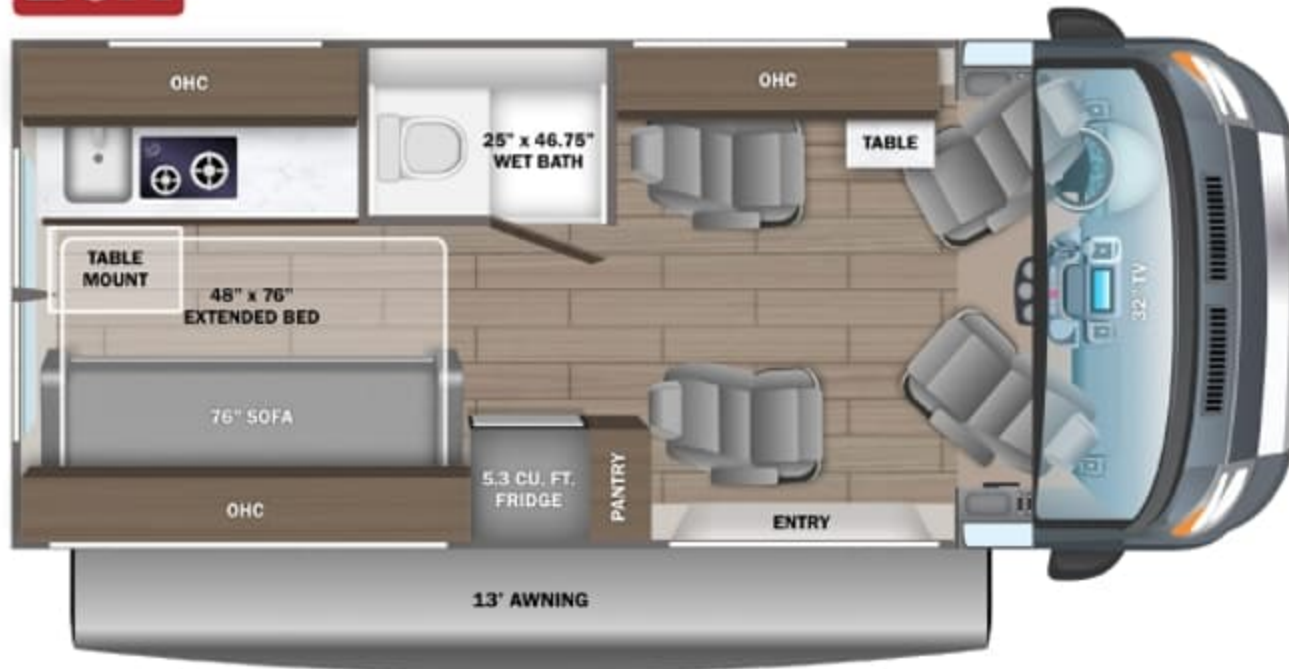

20D

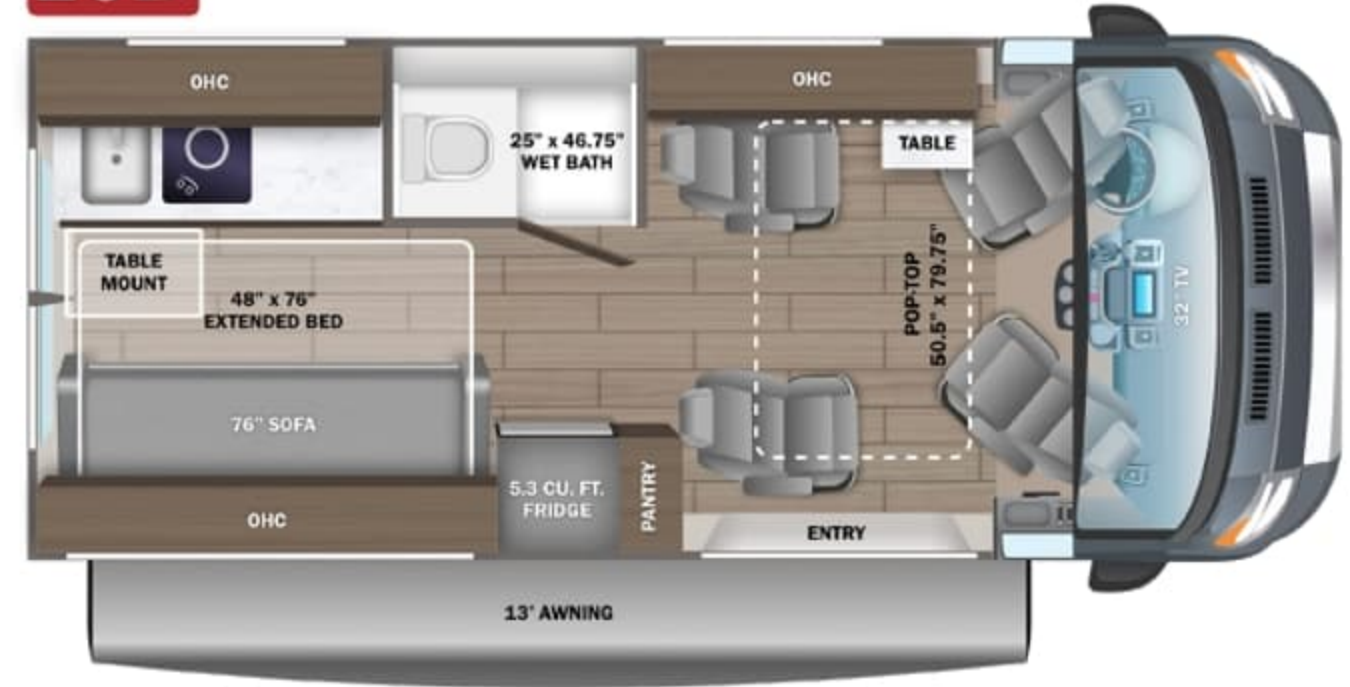

20T

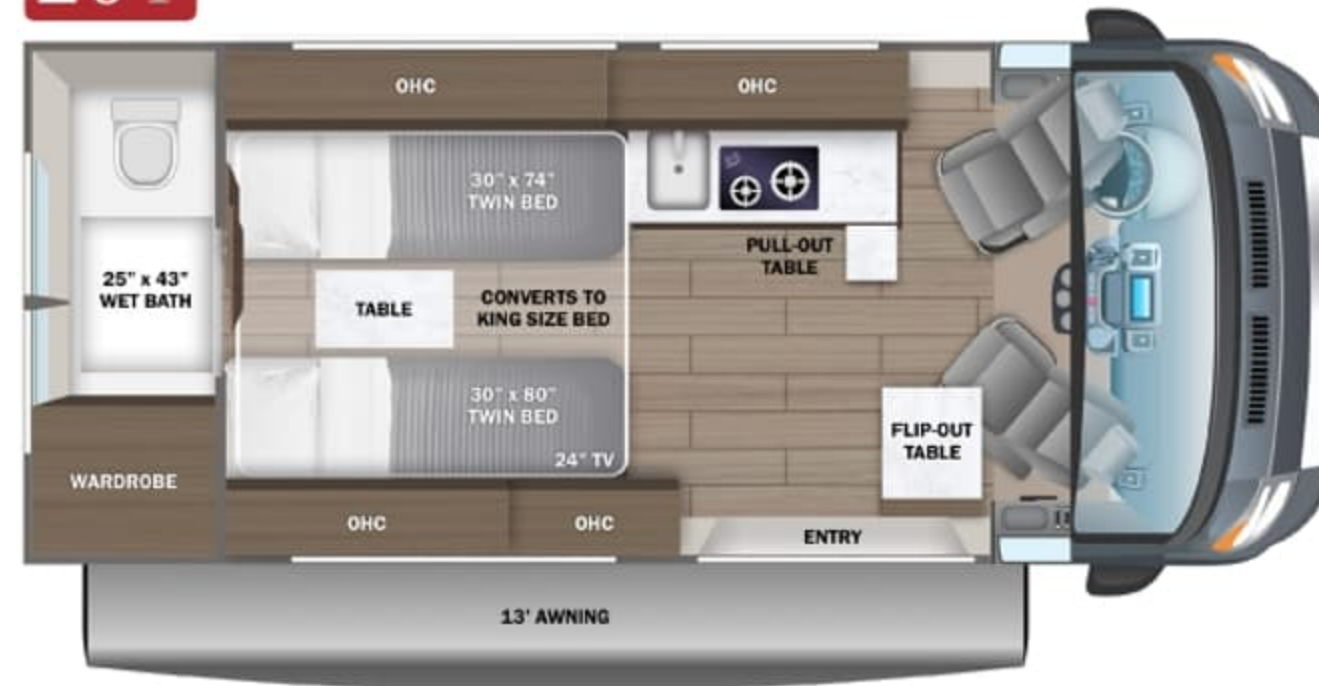

EXTERIOR SELECTIONS



Silver Van



Graphite Van

CUSTOMER VALUE PACKAGE

- E-Z Drive™: Hellwig helper springs, premium heavy-duty suspension
- Thule® armless patio awning with LED light strip
- Thule® roof rack (20A, 20T)
- Truma Combi Eco Plus water heater and furnace
- Swivel driver and passenger seats with 6-way lumbar adjustment
- Winegard® Connect 2.0 4G/Wi-Fi/digital TV antenna

CHASSIS

- RAM® ProMaster 3500 window van
- GVWR - 9,350 lb.
- GCWR - 11,500 lb.
- 3.6L V6 24V VVT 276HP engine with 250 ft.-lb. torque
- 9-speed automatic 948TE transmission
- 180-amp alternator
- LT225/75R 16E tires
- Aluminum wheels
- 3,500 lb. rear hitch receiver with dual 4/7 pin connector
- 12V chassis battery
- 24 gal. fuel tank (gas)

EXTERIOR

- LED-lit running boards for cab and entry doors
- Chrome grille package
- Cable TV hookup with RG-6 coax
- Onan® 2,800W generator with auto-gen start
- 200W roof-mounted GoPower® solar panel with integrated control panel
- Portable solar plug
- 1,000W inverter
- (2) 12V AGM house batteries
- House battery disconnect switch
- 30-amp electrical service with detachable power cord
- (2) 120V exterior outlets
- 6 gal. propane tank (20 lb.)
- LP quick-connect hookup
- Heated holding tanks (12V pads)
- LED-lit holding tank valves
- Black tank flush
- Gravity water fill (20T)
- Winterization drain system
- 12V demand water pump
- Water filtration system
- Outside shower

COCKPIT

- Uconnect® 5 NAV infotainment center with Apple CarPlay® and Android Auto™
- Power folding/heated side-view mirrors
- Push-button start
- ParkView® rear backup camera with dynamic gridlines
- Blind spot monitoring with rear cross path detection
- LaneSense® lane departure warning with lane keep assist

- Forward collision warning with active braking
- Crosswind assist
- Electronic stability control
- Pedestrian/cyclist emergency braking
- Traffic sign information
- Drowsy driver detection
- Rain-sensitive windshield wipers
- Automatic high-beam headlights
- Cruise control
- Driver and passenger airbags
- Wireless charging pad
- Power windows and door locks
- Privacy shades for cab windows
- Remote keyless entry

INTERIOR

- Custom-molded ABS interior wall panels
- Soft-touch vinyl ceiling
- High-intensity LED ceiling lights
- Tecnoform® European-style, high-gloss cabinetry
- Ball-bearing drawer guides
- Residential vinyl flooring
- Firefly Multiplex system - wall-mounted touchscreen and mobile app for total coach control
- 120V Coleman®-Mach® 10 13,500 BTU air conditioner
- Powered roof vent in living area
- Sliding screen door for entrance door
- Sliding vented windows
- Decorative window valances with day/night roller shades
- Rear magnetic privacy shades
- Removable privacy shade for sliding door window
- Expandable table at entry door with safety grab handle (20T)
- Adjustable table with multiple mounts
- (2) cab bucket seats (20A, 20D)
- Seatbelts for driver/passenger seats and select cab locations
- 32 in. front TV on drop-down bracket (20A, 20D)
- 24 in. living area TV on swivel bracket (20T)
- JBL® Flip 5 removable wireless Bluetooth speaker
- Smoke alarm
- Carbon monoxide detector
- Fire extinguisher

KITCHEN

- 5.3 cu.ft. DC refrigerator (20A, 20D)
- 3.1 cu.ft. AC/DC refrigerator (20T)
- Convection microwave
- 2-burner gas cooktop (20A, 20T)
- 1-burner induction cooktop (20D)
- Stainless-steel sink with cover
- Solid-surface kitchen countertop with pull-out extension
- Pop-up 120V/USB outlet in kitchen

BEDROOM

- (2) twin-size beds with filler cushion converts to king-size bed (20T)
- Under-bed storage (20T)
- 48 in. x 76 in. convertible sofa bed (20A, 20D)
- 50.5 in. x 79.5 in. pop-top (20D)

BATHROOM

- Bathroom wardrobe
- Shower with magnetic curtain surround
- Aqua View® SHOWERMISER™ water management system
- Toilet with foot flush
- Medicine cabinet with mirror
- Powered roof vent in bathroom (20A, 20T)

OPTIONS

Li Package

- 48V-210 amp hour smart lithium battery providing 10KW hours of power IPO 2,800W generator and (2) 12V AGM house batteries
- Auto engine start with high idle
- 3,500W inverter IPO 1,000W inverter
- 2nd 48V alternator dedicated to lithium battery
- Trickle charge solar panel for chassis battery
- Timberline hydronic heating system IPO Truma Combi Eco Plus water heater and furnace
- 48V Coleman®-Mach® 10 13.5K BTU air conditioner IPO 120V Coleman®-Mach® 10 13.5K BTU air conditioner
- 1-burner induction cooktop IPO 2-burner gas cooktop (20A, 20T)
- No propane - all-electric coach

WARRANTY



At Entegra Coach, we build our RVs to handle every adventure, then back them with an outstanding warranty. Our 2-year limited warranty has you covered for 2 camping seasons. That's 730 days. For a copy of our 2-year limited warranty with complete terms and conditions, please contact your local Entegra Coach dealer.

Floorplan	GVWR (lbs.)	GCWR (lbs.)	Wheel Base	Overall Length	Exterior Height w/ A/C & Satellite	Exterior Width	Interior Height	Fresh Water Capacity (gal.)	Grey Waste Water Capacity (gal.)	Black Waste Water Capacity (gal.)
20A	9,350	11,500	159	20' 11"	9' 3"	83	74	21	13/14	10
20D	9,350	11,500	159	20' 11"	9' 3"	83	74	21	13/14	10
20T	9,350	11,500	159	20' 11"	9' 3"	83	74	24	13	12

It is important for your safety and enjoyment that you are aware of the weights and tow ratings of the RV you select. Consult a competent advisor for questions or advice. Whether you are new to RVing or a veteran, get a feel for the performance of your RV before heading out on the roadways. When you tow a vehicle with your RV, you must drive differently than when you drive a single vehicle. Practice hooking up, driving, backing up and braking in a safe environment or seek out professional instruction. Jayco affixes a weight label to each RV which lists weight information for that vehicle. Refer to that label to verify the vehicle will meet your requirements. Gross Vehicle Weight Rating (GVWR): The maximum permissible weight of the motorhome, including the Unloaded Vehicle Weight (UVW) plus passengers, personal items, all cargo, fluids, options and dealer-installed accessories. The GVWR is equal to or greater than the sum of the UVW and the Cargo Carrying Capacity. Gross Combined Weight Rating (GCWR): The maximum allowable combined weight of the motorhome used as a tow vehicle and the attached towed vehicle.



Part of Jayco Family of Companies

Entegra Coach, Inc., P.O. Box 460, Middlebury, IN 46540, www.entegracoach.com. See dealer for further information and prices. All information in this brochure is the latest available at the time of publication approval. Entegra Coach reserves the right to make changes and to discontinue models without notice or obligation. Photos in this brochure may show optional equipment and props for photography purposes. RVs built for sale in Canada may differ to conform to Canadian codes. ©2023 Entegra Coach, Inc. Printed in U.S.A. 2032820.2024



entegracoach.com/ethos