

# FUZION

LUXURY TOY HAULERS



KEYSTONE  
RV COMPANY

CAMP BETTER  
KINDNESS · COMMUNITY · PLANET

# EXTRAORDINARY ADVENTURE

Embark on a journey beyond the ordinary with Keystone RV's Fuzion luxury toy haulers – where unyielding rugged performance meets the artistry of superior construction. Within these robust walls lies a sanctuary of indulgence, where opulence and comfort intertwine to create a haven that beckons the extraordinary. Seamlessly integrated innovative technology ensures that every moment is elevated, promising a best-in-class owner experience.

Whether you're an audacious RVer in search of versatile living spaces, including expansive open-air patios, or a power sports maverick in need of a secure haven for your prized UTVs and dirt bikes, Fuzion transcends expectations, catering to those who seek not just the remarkable, but the truly remarkable.

## FUZION FEATURES

- **NEW** Automotive Painted Front Cap w/ Exterior Lighting
- **NEW** Graphics Package w/ Multicolored Skirt Metal
- One-Piece Alpha Super Flex TPO Roof Membrane w/ Limited Lifetime Warranty
- **NEW** Lippert Titan Hydraulic Auto-Leveling System w/ Digital Touchscreen & Under Frame Led Lighting
- Maxturn™ Technology w/ Rota-Flex™ Pin Box
- Equalizer® Systems' EQ Smart Level
- Goodyear Tires w/ 8 Lug Aluminum Wheels
- Tire Pressure Monitoring System (TPMS) w/ Display on All Wheels Including the Spare Tire
- Upgraded MORryde® 3000 CRE Suspension w/ 1/2" Thick Shackles & Wet Bolts
- **NEW** Combined Pass-Through and Front Storage Allow Easier Access
- **NEW** Convenient LP Tank Location
- MORryde® StepAbove® Solid Entry Steps at Main Entry Door
- Extended Garage Lengths w/ Outside Storage to Haul Bigger Toys
- Beefy Adjust-A-Track™ Frame-Welded Tie Down System w/ 38 Points of Contact, Each Supporting 5,000 Lb.
- Water-Resistant, Zero-G MORryde® Ramp Door
- Two 30-Gallon Fuel Tanks w/ Fuel Station
- Optional Patent-Pending Convertible Garage Bar
- Omni-Chill® Cooling, Operates Three A/Cs Simultaneously
- 35K BTU Furnace
- iN-Command® w/ Global Connect® Smart RV Control System
- Girard® Tankless On-Demand Water Heater
- Onan 5500 Generator
- Wet Sounds™ Speaker Package in Garage and Exterior
- Jensen Entertainment Package w/ J-Control
- **NEW** Charcoal and Stone Decor Options (SEE KEYSTONERV.COM FOR DETAILS)
- Soft-Close Cabinet Doors
- Solid Surface Countertops
- Stainless Steel Appliances
- Washer & Dryer Prep in All Front Bedroom Closets
- East/West Bed Slides on All Models w/ Full-Size Front Closet & Washer/Dryer Prep
- SolarFlex™ Protect 220, Discover 440i, And Outlast 660i-L w/ Optional Dragonfly Energy Lithium-Ion Batteries
- 1-Year Limited Base Warranty & 3-Year Limited Structural Warranty (SEE KEYSTONERV.COM FOR DETAILS)

VISIT OUR WEBSITE FOR PHOTOS,  
360° TOURS, AND FULL PRODUCT DETAILS



The party is just getting started! Introducing the all-new Fuzion Convertible Garage Bar: now offered as an option on all Fuzion models. This patent-pending design folds from a bar down into a queen-sized bed, so you can party by day and still sleep soundly at night. This bar system easily connects to your HappiJac system when it's time to bring the toys in on travel days giving you the space you need to haul.

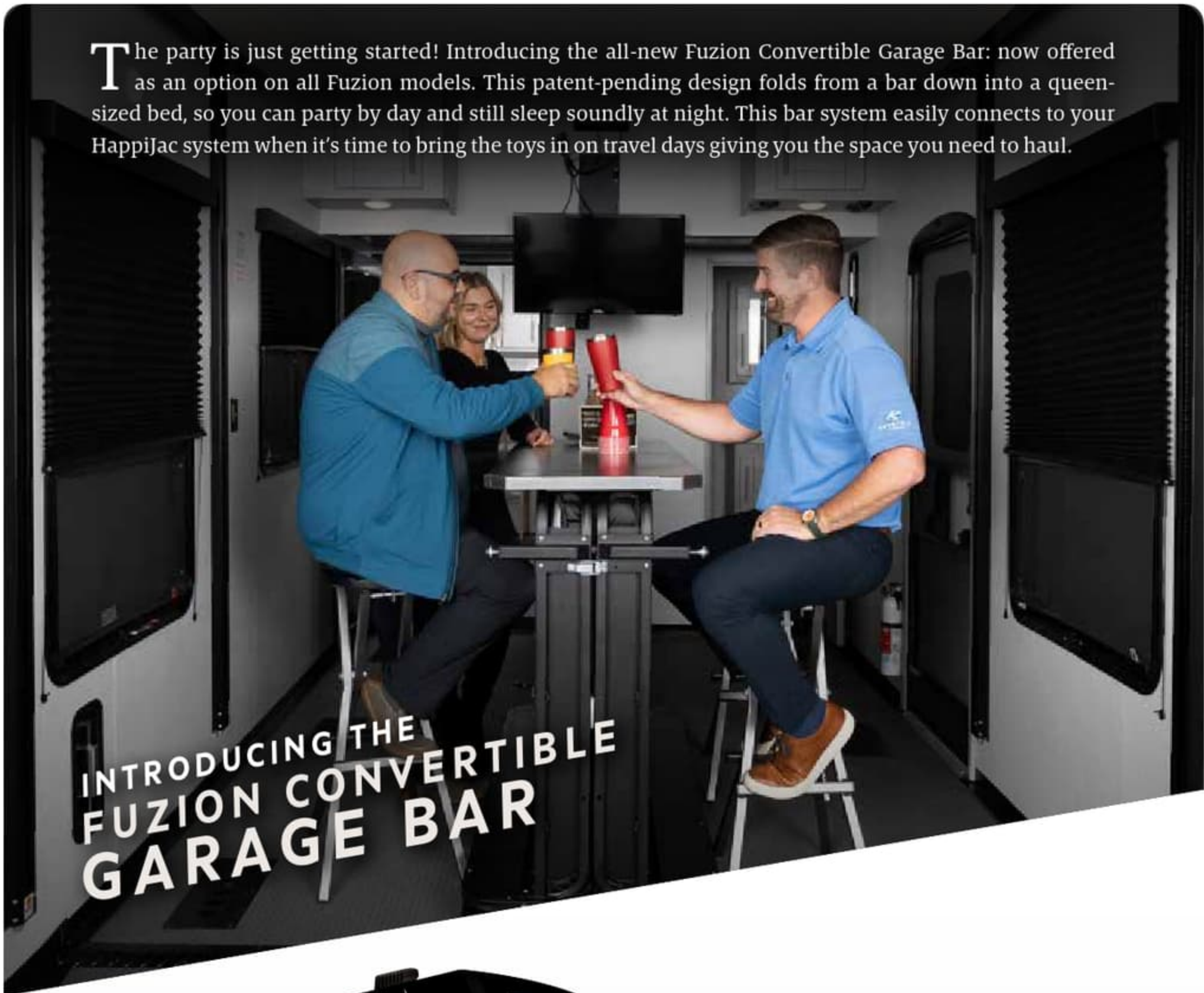

## INTRODUCING THE FUZION CONVERTIBLE GARAGE BAR



MAKE A STATEMENT WITH  
**FULL BODY PAINT**

Keystone's exclusive fade and peel-resistant automotive-grade paint is available as an optional package on all Fuzion floorplans. AVAILABLE IN TWO COLOR OPTIONS



▲ LEARN MORE ▲

# FUZION LUXURY TOY HAULERS

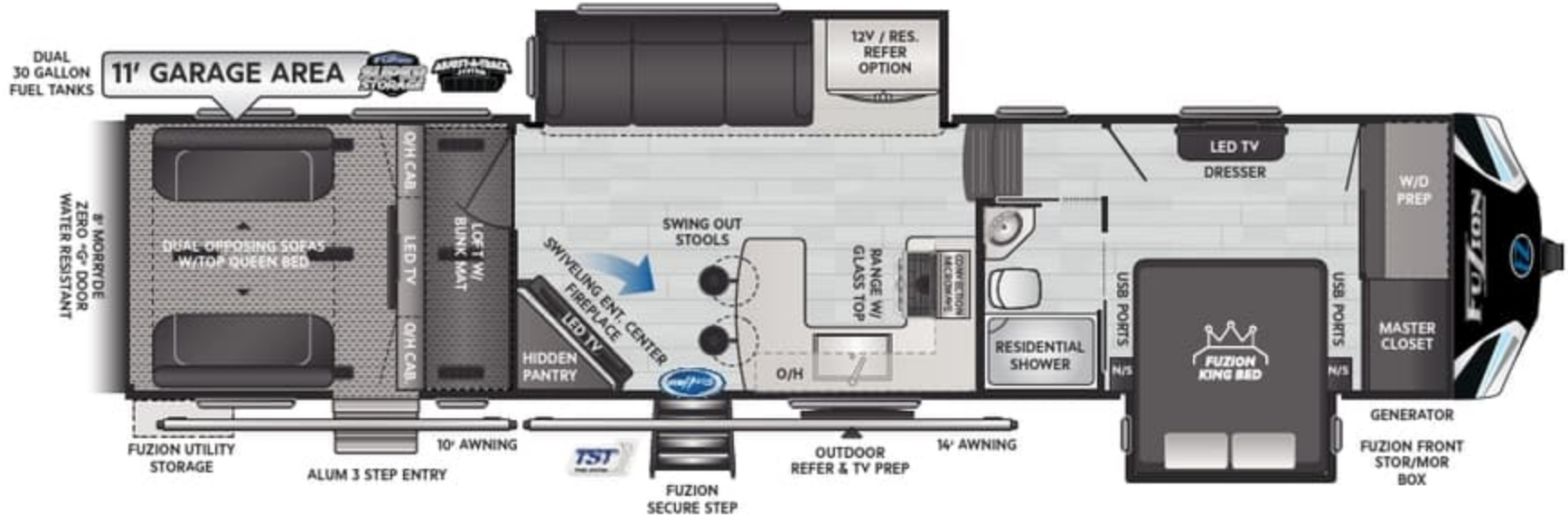

**369** | WEIGHT 13970 | LENGTH 39' 0"

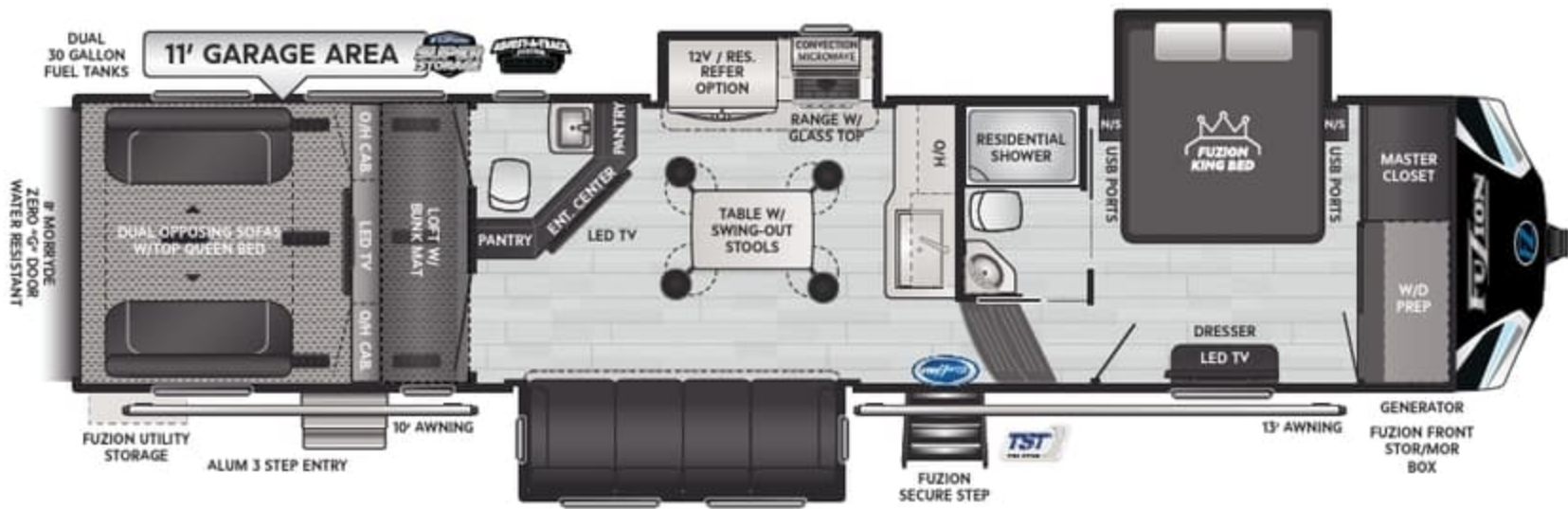

**373** | WEIGHT 14510 | LENGTH 39' 0"

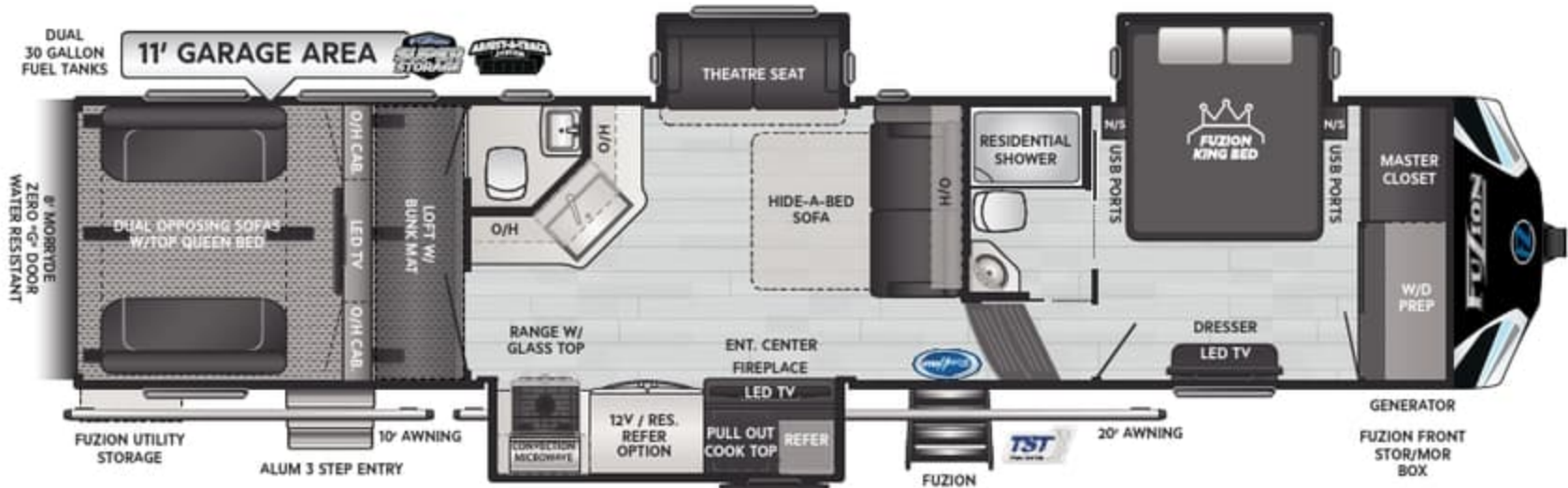

**379** | WEIGHT 14730 | LENGTH 39' 6"

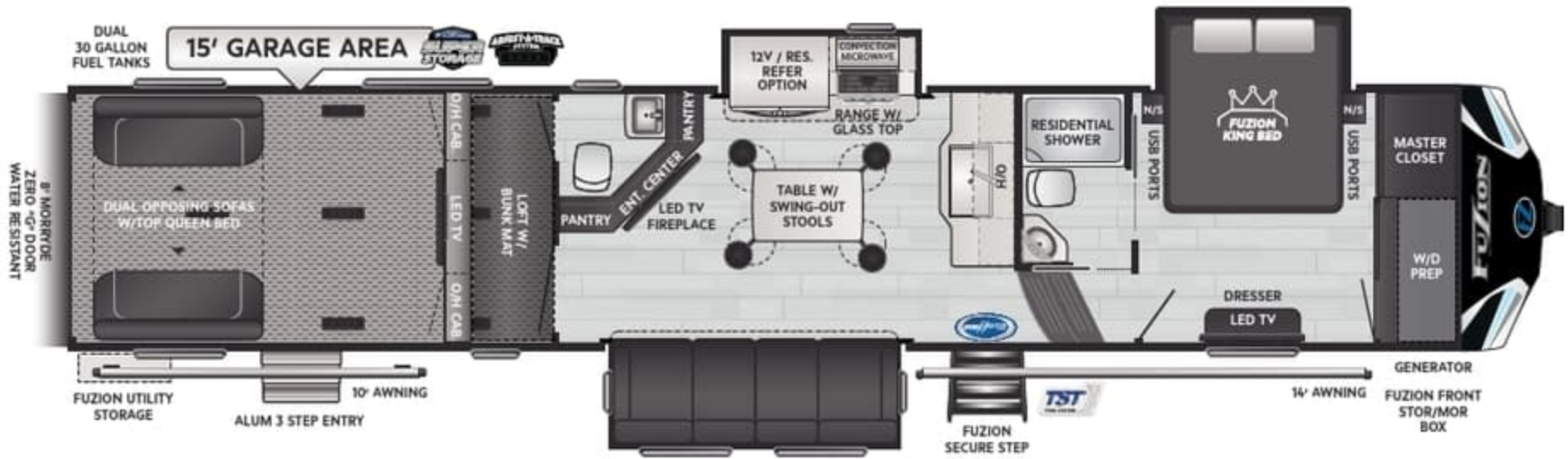

**419** | WEIGHT 15673 | LENGTH 44' 0"

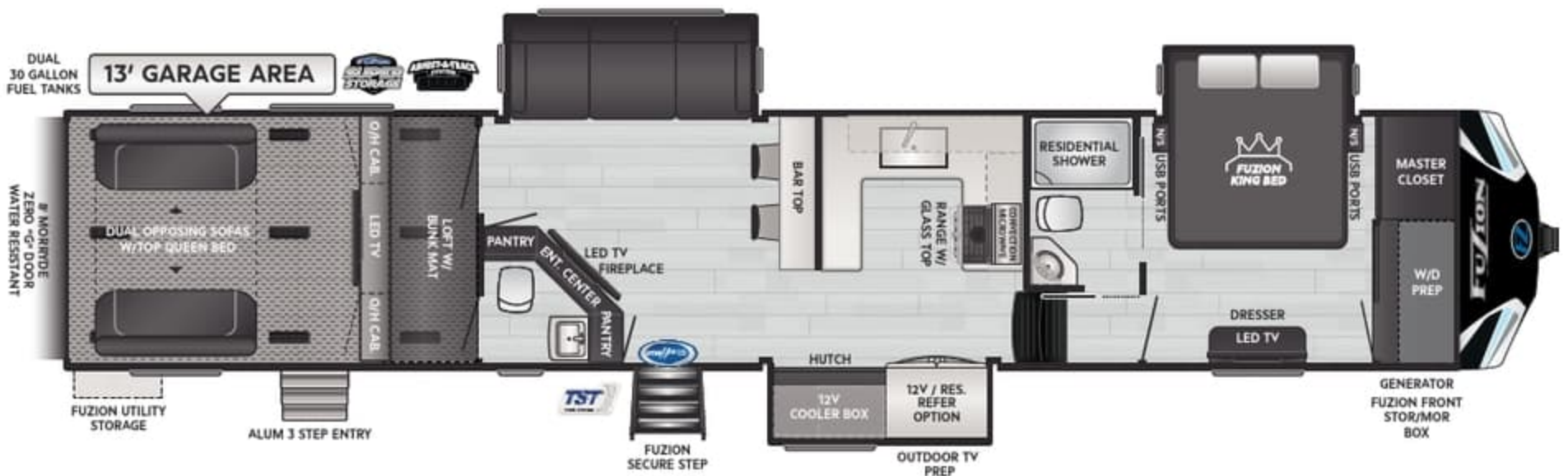

**421** | WEIGHT 15927 | LENGTH 44' 11"



The Fuzion fuses the best parts of RVing. Not only do we have a luxurious living space and kitchen, but we also have a very functional garage for hauling our toys. Plus, when our family visits us on our adventures, our garage doubles as a separate bedroom with two queen beds. If you want to see the country and ride on some of the best roads, the Fuzion is the way to go.

 @GETLARSONLOST — FUZION 369 OWNERS

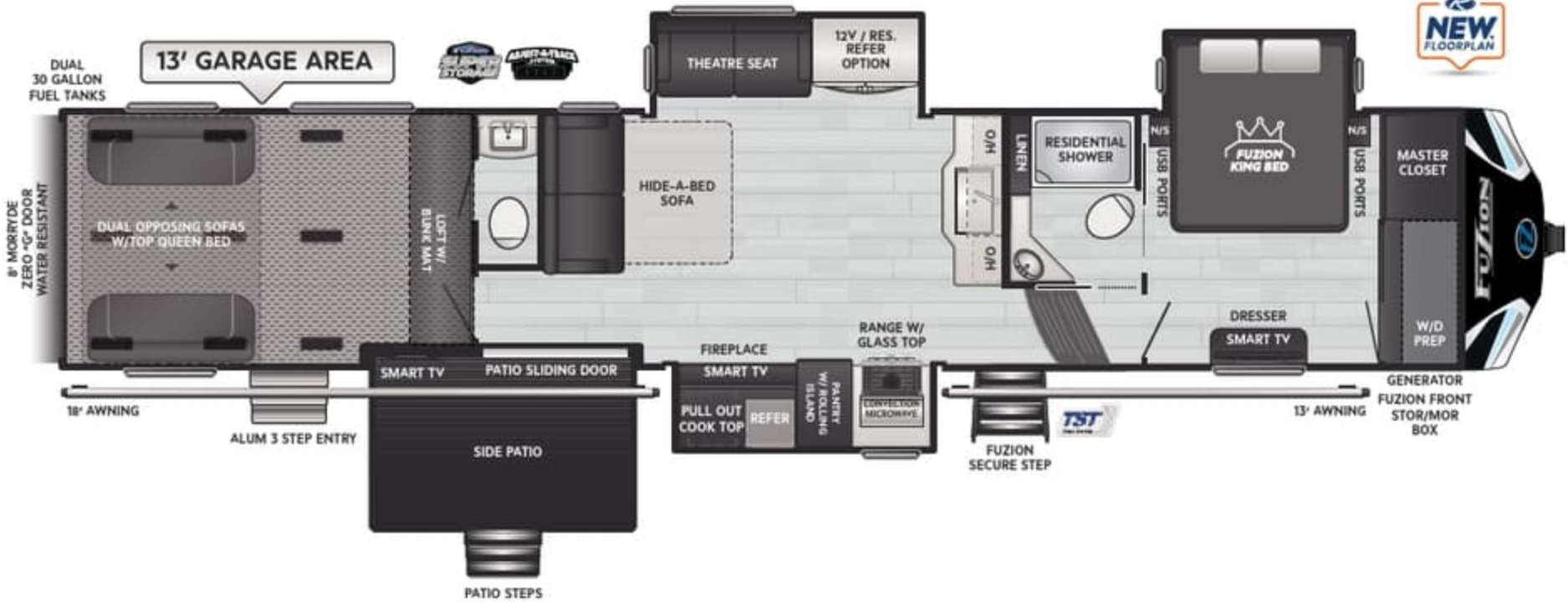

**425** | WEIGHT 16720 | LENGTH 44' 11"

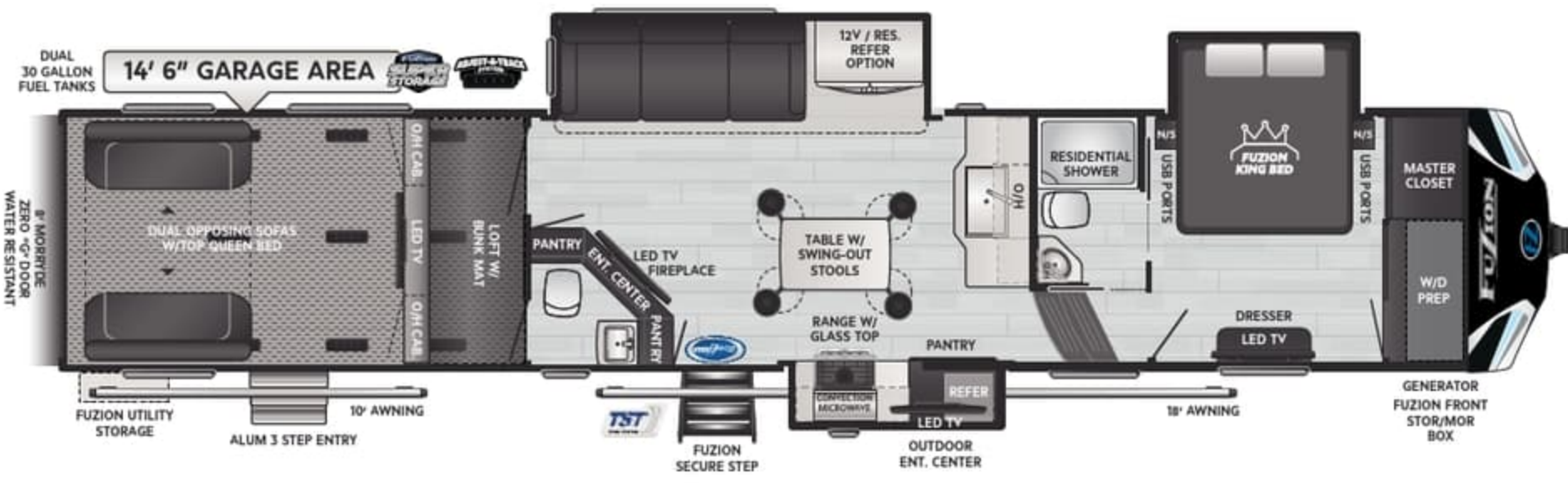

**427** | WEIGHT 16026 | LENGTH 44' 11"

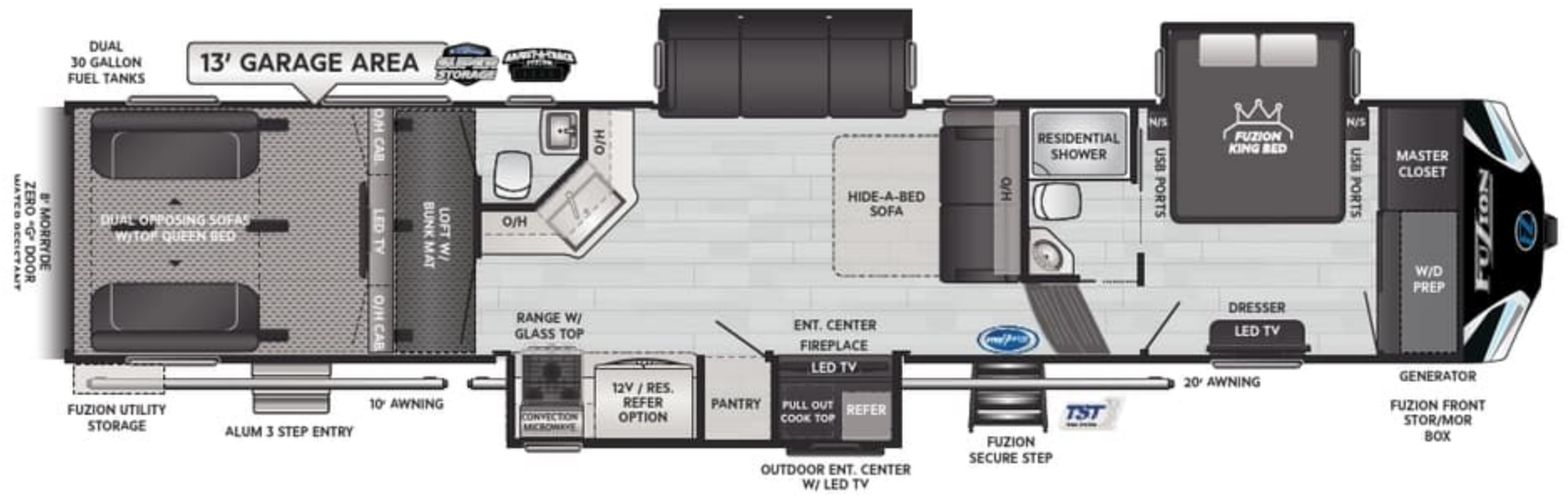

**428** | WEIGHT 16220 | LENGTH 44' 11"

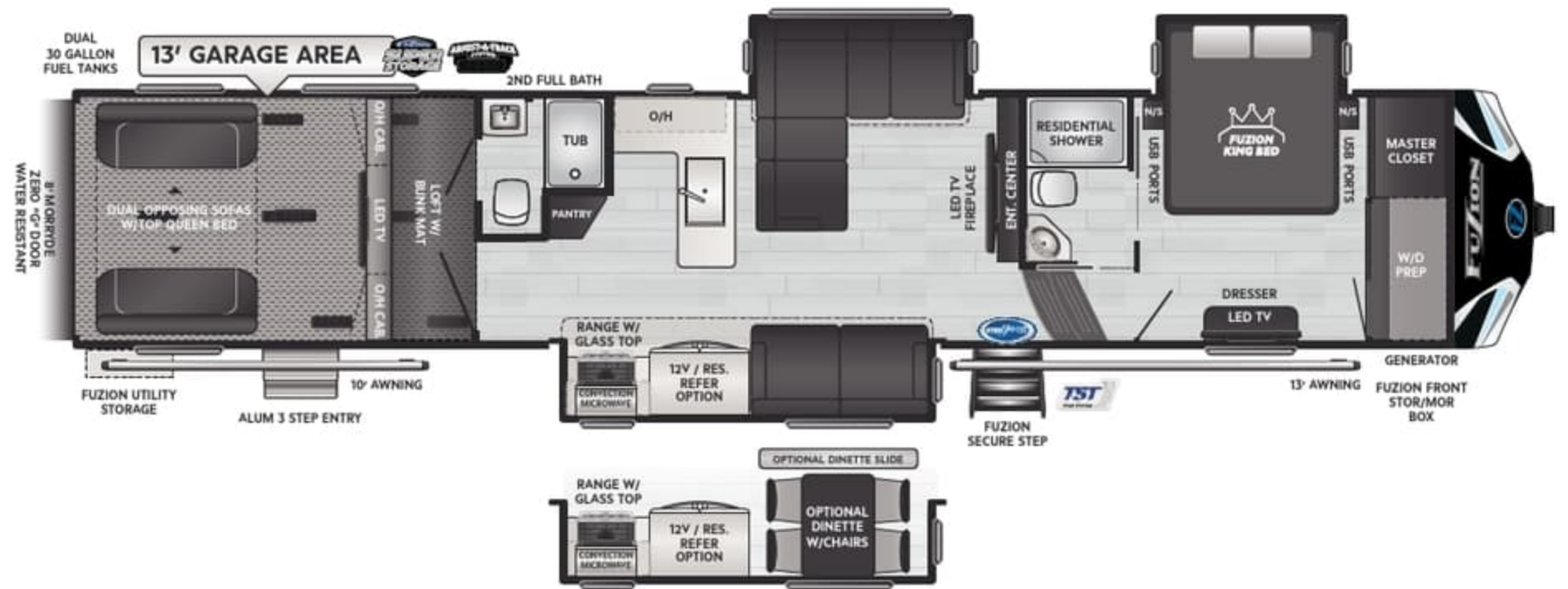
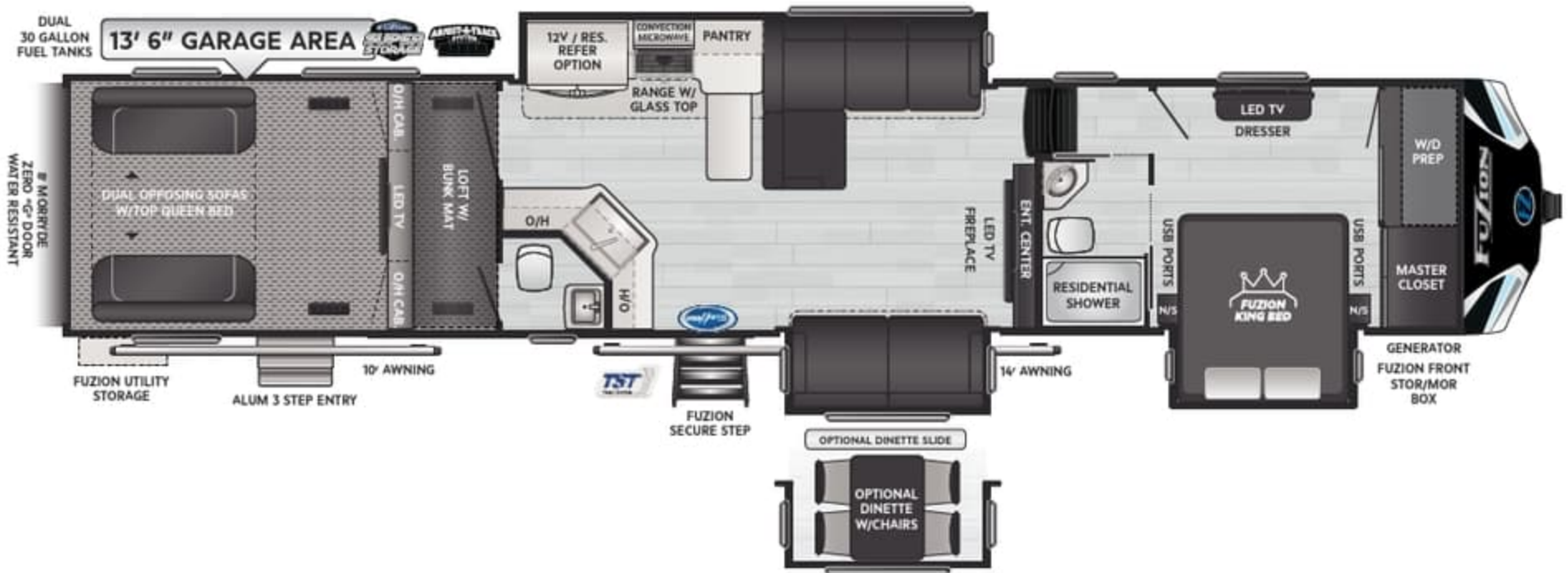

## FUZION SPECIFICATIONS

MODEL	WEIGHT	CARRYING CAPACITY	HITCH WEIGHT	FRESH WATER**	WASTE WATER	GRAY WATER	LPG	LENGTH*	WIDTH	HEIGHT	AWNING
369	13970	3030	3015	94	44	88	60	39' 0"	8' 4"	13' 3"	10'/14'
373	14510	2490	3155	94	88	88	60	39' 0"	8' 4"	13' 3"	10'/13'
379	14730	2270	3155	94	88	88	60	39' 6"	8' 4"	13' 4"	10'/20'
419	15673	4327	3330	94	88	88	60	44' 0"	8' 4"	13' 5"	10'/14'
421	15927	4073	3580	94	88	88	60	44' 11"	8' 4"	13' 5"	10'/20'
425	16720	3280	3805	94	88	88	60	44' 11"	8' 4"	13' 5"	18'/13'
427	16026	3974	3600	94	88	88	60	44' 11"	8' 4"	13' 5"	10'/18'
428	16220	3780	3595	94	88	88	60	44' 11"	8' 4"	13' 5"	10'/20'
429	16018	3982	3555	94	88	88	60	44' 11"	8' 4"	13' 5"	10'/14'
430	16070	3930	3440	94	88	88	60	44' 11"	8' 4"	13' 5"	10'/13'

# SOLAR<sup>TM</sup> FLEX



**NEW** 2024 PACKAGE UPDATES

For more information scan the QR code  
or visit [keystonerv.com](http://keystonerv.com).

## TAKE CHARGE OF HOW YOU CAMP

EXCEPTIONAL QUALITY, IMPOSSIBLY VERSATILE, SolarFlex<sup>TM</sup>  
IS SHATTERING CUSTOMER'S EXPECTATIONS OF FACTORY-INSTALLED SOLAR POWER.  
EXCLUSIVELY AVAILABLE ON ALL KEYSTONE RV MODELS.



Keystone RV is proud to partner with Dragonfly Energy to offer their legendary heated Lithium-ion batteries exclusively on all Keystone models.



FOLLOW US FOR THE LATEST!



DISCLAIMER: Product information is as accurate as possible as of the date of publication of this brochure. All features, floor plans, and specifications in this brochure are subject to change without notice. Please also consult Keystone's web site at [www.keystonerv.com](http://www.keystonerv.com) for more current product information and specifications. Tow Vehicle Disclaimer. CAUTION: Owners of Keystone recreational vehicles are solely responsible for the selection and proper use of tow vehicles. All customers should consult with a motor vehicle manufacturer or their dealer concerning the purchase and use of suitable tow vehicles for Keystone products. Keystone disclaims any liability or damages suffered as a result of the selection, operation, use or misuse of a tow vehicle. KEYSTONE'S LIMITED WARRANTY DOES NOT COVER DAMAGE TO THE RECREATIONAL VEHICLE OR THE TOW VEHICLE AS A RESULT OF THE SELECTION, OPERATION, USE OR MISUSE OF THE TOW VEHICLE. \*Length is defined as the distance from the centerline of hitch pin/coupler to rear bumper of trailer. \*\* Fresh water capacity includes water heater. Please review owner's manual prior to purchase for more information on service warranties, extended use, towing and maintenance. Owner's manuals can be found at [keystonerv.com](http://keystonerv.com).

PRINT 10.2023