

2024 LUXURY MOTORCOACH

# S U P R E M E A I R E



S

*A Super C that  
stands out from  
other Super Cs.*

Not all Super Cs are equal—and the 2024 Supreme Aire is a world apart from all of them. With exclusive features you'll only find on Newmar Super Cs like a step-free aisleway and full air-ride cab, the amenities are next-level. And from coast to coast, in resorts or campgrounds, it's sure to turn heads.





15K BTU Penguin™ Heat Pump  
Air Conditioners

50" Samsung 4K  
LED TV

Dishwasher in a  
Drawer (Optional)

Electric Radiant Heat Beneath  
Main Floor Tiles

Freightliner® M2 112 Chassis

Supreme Aire

# Freightliner® M2 112 Chassis



S U P R E M E A I R E

Detroit Diesel DD13  
12.8L Engine

525 HP

1850 lb./ft. torque

Kingston Full-Paint  
Masterpiece Finish™  
Exterior

40'-45' / 4 floor plans



# Cockpit

## Redesigned Dash\* and New Steering Wheel\*

### Air Ride Captain's Chairs

Lumbar Support with 12V Electric Controls

### Skylight

Power Shade

### Xite Dash Radio

9" Monitor

Nav-N-Go Navigation

Apple CarPlay®

## Harman/JBL 180-Watt Sound System and Subwoofer

### Detroit Assurance 5.0 Lane Departure Warning System\*

### Detroit Assurance Safety System\*

Object Detection

Active Brake Assist

Pedestrian Detection

Auto On/Off Headlights

Auto Rain Sense Wipers

Intelligent High Beams

### Tire Pressure Monitoring System

### HD 360 Camera System

\*New for 2024







Floor plan 4530 with Seahaven décor and Sable Maple cabinets  
*\*The backsplash in 2024 Supreme Aire models will differ from the one shown here*

# Cabin

**Four Décor Options:  
Barton\*, Haven, Linley, and Seahaven\***

**Villa Comfort Fit Hide-A-Bed Sofa  
and Jackknife Sofa\*\***

**50" Samsung® 4K LED TV**  
Bose® 900 Sound Touch Soundbar

**Power Stepwell Cover**

**Porcelain Tile Flooring**

*\*New for 2024  
\*\*See Features & Options for all available furniture configurations*



# Cabin

**15K BTU Penguin™ Heat Pump  
Air Conditioners\***

**Electric Radiant Heat Beneath  
Main Floor Tile**

**WiFiRanger Everest System  
with Aspen Router (Optional)**

**Silverleaf® Monitor**

**Mobile App**

(to control elements of the coach)



Floor plan 4530 with Seahaven décor and Sable Maple cabinets

*\*The backsplash in 2024 Supreme Aire models will differ from the one shown here*

*\*Two units on 40' models, three units on 45' models*





*\*The backsplash in 2024 Supreme Aire models will differ from the one shown here*

# Galley & Dinette

**All-Electric Flush Mount  
Induction Cooktop**

**Convection Microwave**

**Whirlpool® 19.7 Cu. Ft. Refrigerator**

**Dishwasher in a Drawer** (Optional)

**Glazed Maple Hardwood Cabinets\***

Available in Four High Gloss  
or Matte Finish Color Options

Soft-Close Drawers

Undermounted LED Lights

**Pantry**

Pull-Out Shelves

Push-to-Release Drawer Slides

**Super Polished  
Solid-Surface Countertops**

**Tile Backsplash**

**Booth Dinette\*\***

*\*Newly styled for 2024*

*\*\*Additional dinette configurations available; see Features & Options for details*









# Bedroom

## King Bed\* with Pillow Top Mattress

Adjustable Support Air Bed (Optional)

**Samsung® 4K LED TV**

**Bedroom Speakers**

**Lighted Wardrobe**

Safe

**Dimmable Reading Lights**



# Bathroom

**Tiled Shower Walls with Glass Door\***

**Super Polished Solid-Surface  
Countertops**

**Aqua Miser® Shower System**

**150-Gallon Fresh Water Tank**

**Linen Cabinet**





*\*The backsplash in 2024 Supreme Aire models will differ from the one shown here*

SUPREME AIRE



# Exterior & Storage

**Industry-Exclusive Full Paint  
Masterpiece Finish™ with Cut and Buff**

New Exterior Design and Color Combinations\*

**New Graphic Design and Color Options**

**Girard® Nova Side Awnings**

**Power Baggage Door Locks**

**Lighted Exterior Storage Compartments**

**Dometic® Freezer on Pullout Tray**

(Optional)

**Exterior Entertainment Center (Optional)**

43" Samsung® LED TV

Bose® Soundbar



# *Exterior*

**Rear Cap Storage**

**Exterior Shower**

**12.5 kW Cummins Onan®  
Diesel Generator**

**10 Watt Solar Panel**  
(to Charge Chassis Battery)





S U P R E M E A I R E

*interior & exterior*  
*Design Options*



# Aberdeen



Awning Color: Charcoal Tweed

**BARTON INTERIOR** a. Furniture/Fabric b. Flooring c. Counter Top



*\*Exterior colors and interior décor options can be matched to customer preference.*

**CABINET FINISHES**



*\*Available in Matte and High Gloss Finish*

# Coventry



Awning Color: Charcoal Tweed

## HAVEN INTERIOR a. Furniture/Fabric b. Flooring c. Counter Top



## CABINET FINISHES



\*Exterior colors and interior décor options can be matched to customer preference.

\*Available in Matte and High Gloss Finish

# Kingston



Awning Color: Charcoal Tweed

## LINLEY INTERIOR a. Furniture/Fabric b. Flooring c. Counter Top



\*Exterior colors and interior décor options can be matched to customer preference.

## CABINET FINISHES



\*Available in Matte and High Gloss Finish

# Wakefield



Awning Color: Linen Tweed

**SEAHAVEN INTERIOR** a. Furniture/Fabric b. Flooring c. Counter Top



**CABINET FINISHES**



\*Exterior colors and interior décor options can be matched to customer preference.

\*Available in Matte and High Gloss Finish





# Floor Plan Specifications



Length: 41' 2"

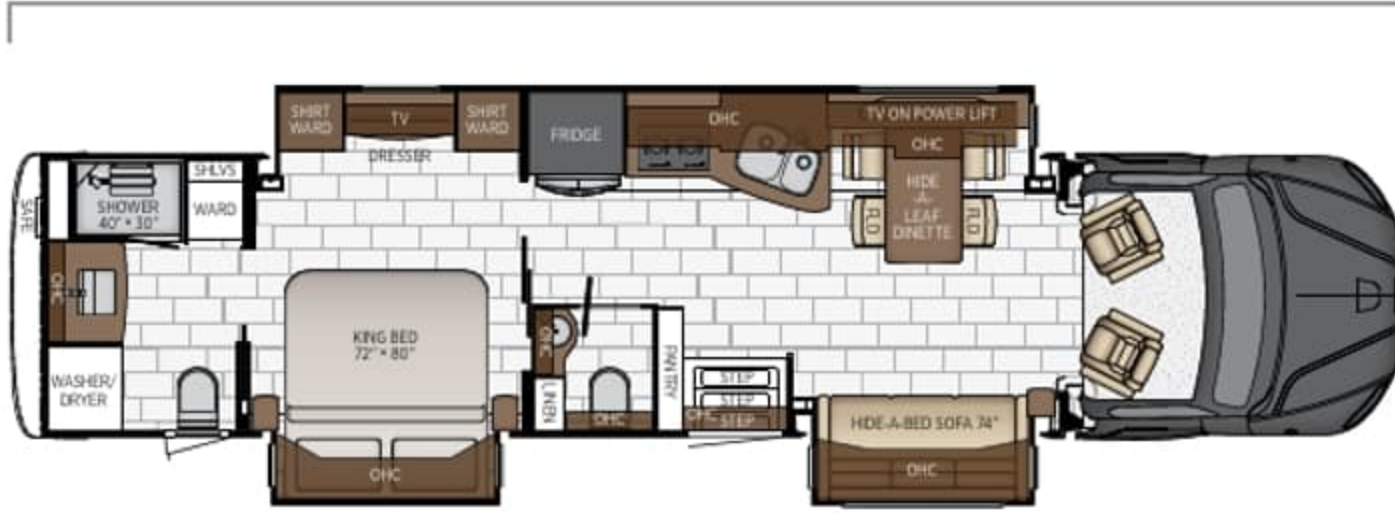

<b>4051</b>	Length	41' 02"	Grey Tank	60 gal.
	Width	101.5"	Sewage Tank	40 gal.
	App. Overall Height	13' 02"	Water Tank	150 gal.
	Interior Width	95.5"	Propane Tank	0 gal.
	Interior Height	83"	Furnace	50,000 btu

Length: 44' 11"



<b>4504</b>	Length	44' 11"	Grey Tank	60 gal.
	Width	101.5"	Sewage Tank	40 gal.
	App. Overall Height	13' 02"	Water Tank	150 gal.
	Interior Width	95.5"	Propane Tank	0 gal.
	Interior Height	83"	Furnace	50,000 btu

Length: 44' 11"



<b>4509</b>	Length	44' 11"	Grey Tank	60 gal.
	Width	101.5"	Sewage Tank	40 gal.
	App. Overall Height	13' 02"	Water Tank	150 gal.
	Interior Width	95.5"	Propane Tank	0 gal.
	Interior Height	83"	Furnace	50,000 btu

Length: 44' 11"



<b>4530</b>	Length	44' 11"	Grey Tank	60 gal.
	Width	101.5"	Sewage Tank	40 gal.
	App. Overall Height	13' 02"	Water Tank	150 gal.
	Interior Width	95.5"	Propane Tank	0 gal.
	Interior Height	83"	Furnace	50,000 btu



SupremeAire

NEWMAR

# Quality You Can Feel

Like a fine home, the 2024 Supreme Aire is framed 16 inches on center, and is covered by a fiberglass roof with an integrated gutter rail.

FREIGHTLINER®											
FLOOR PLAN	ENGINE HP	AXLE RATIO	FUEL CAP.	WHEEL BASE	FRONT GAWR	REAR GAWR	TAG GAWR	GVWR	GCWR	APP. UVW	APP. NCC
4051	525	3.58	100 gal.	285 + TAG	18000 lb.	20000 lb.	20000 lb.	58000 lb.	72000 lb.	41500 lb.	16500 lb.
4504	525	3.58	100 gal.	309 + TAG	18000 lb.	20000 lb.	20000 lb.	58000 lb.	72000 lb.	43500 lb.	14500 lb.
4509	525	3.58	100 gal.	309 + TAG	18000 lb.	20000 lb.	20000 lb.	58000 lb.	72000 lb.	43500 lb.	14500 lb.
4530	525	3.58	100 gal.	309 + TAG	18000 lb.	20000 lb.	20000 lb.	58000 lb.	72000 lb.	43500 lb.	14500 lb.

**The content in our literature depicts and describes products that are subject to change. For the most recent images and information, please visit [NewmarCorp.com](http://NewmarCorp.com).**

Lengths, heights, widths, and dry weights are approximate. Weight will vary based on optional equipment added to the above base weight.

**GAWR:** Gross Axle Weight Rating is the maximum permissible weight for an axle.

**GVWR:** Gross Vehicle Weight Rating is the maximum permissible weight for a fully loaded motor coach.

**GCWR:** Gross Combination Weight Rating is the value specified by the manufacturer of the vehicle as the maximum allowable loaded weight of this motor coach and any towed trailer or towed vehicle.

**UVW:** Unloaded Vehicle Weight is the weight of this motor coach as built at the factory with full fuel, engine oil, and coolants. Does not include cargo, fresh water, propane gas, or dealer-installed accessories.

**NCC:** Net Carrying Capacity is the maximum weight of all occupants, including the driver, personal belongings, food, fresh water, waste water, propane gas, tools, tongue weight of towed vehicle, dealer-installed accessories, etc., that can be carried by the motor coach.

**Specifications supplied by the chassis manufacturer.**

**Supreme Aire R-Values:**

Roof R-Value = 19

Sidewall R-Value = 11

Floor R-Value = 16

Basement R-Value = 4

# Features & Options



## EXTERIOR FEATURES

Full-Paint Masterpiece Finish™ Graphics with Cut and Buff and Beta Fusion Protection on Front Cap

Lighted Newmar Badge in Front Cap

Chrome Power Baggage Door Locks, Keyless Entry Door with Touch Pad and Door Bell

Convex Exterior Mirrors with Defrost and Remote Control

Automatic Triple Entrance Door Step-Hydraulic

Assist Handle at Entrance Door

Mud Flaps

Rear Protective Tow Guard with Stainless Steel Newmar Name Cutout

Undercoating

Hydraulic Leveling Jacks

Stainless Steel Exterior Trim Pieces and Entrance Door Kick Panel

Storage Bins in Pegboard Compartment

Power Lock Cockpit Doors

Rear Cap Storage

## OPTIONS

Storage Tray 39" X 56" Non-Power Location-Bay 6

Storage Tray 39" X 56" Non-Power Location-Bay 5

Stainless Steel Trim Kit for Exterior Compartment Doors

Flag Pole Bracket

## CONSTRUCTION FEATURES

Fiberglass Roof and Integrated Gutter Rail

Gelcoated Fiberglass Exterior Sidewalls, Front and Rear Caps

Aluminum-Frame Sidewalls and Roof Construction, 16" on Center

5/8" Foam Insulation Laminated in Sidewalls and Ceiling

Polar Pak R19 Batten Insulation on Roof

Automatic Lock Arms on Non Hydraulic Slideout Rooms-Paddle Style

Egress Door with Ladder System\*

HWH Flat Floor Slideout

## WINDOWS, AWNINGS, & VENTS

Frameless Double-Pane Tinted Safety-Glass Windows

Fan-Tastic® Vent with Rain Sensor in Kitchen, Bathroom and Enclosed Stool Room

Hardwood Louvered Cover on Fan-Tastic® Vent in Kitchen

Sky Window in Cockpit with Power Shade

Girard® Package-Two Nova Side Awnings, Slideout Covers and Power Window Awnings

Driver and Passenger Power Window

Bunk Windows\*

## OPTIONS

Kitchen Window

## CHASSIS FEATURES

100 Gallon Fuel Capacity

30K Rear Hitch for Towing-Includes Draw Bar with 2-5/16" Ball

Aluminum Wheels

Anti-Lock Braking System

Chassis Battery Disconnect

Electronic Stability Control

Cruise Control

Standard M-2 112 Chassis Detroit DD13-525 Engine 311" Wheel Base

Standard M-2 112 Chassis Detroit DD13-525 Engine 335" Wheel Base

Tandem Rear Drive Axles

Tire Pressure Monitoring System

D.A.S.S.-Auto On/Off Headlights, Intelligent High Beams, Auto Rain Sense Wipers

D.A.S.S.-Object Detection, Active Brake Assist, Pedestrian Detection

Detroit Assurance Lane Departure Warning System

## AIR CONDITIONING & HEATING

Two 15K BTU Penguin™ Heat Pump Air Conditioners with Remote Control Thermostat on 40'

Three 15K BTU Penguin™ Heat Pump Air Conditioners with Remote Control Thermostat on 45'

Chinook Dual Loop Heat with Continuous Hot Water

Dash Heater and Air Conditioner

Wall Mounted Sensors for Heating and Air Conditioning

Roof Air Conditioning Drainage System

Electric Radiant Heat Installed Below Main Floor Tile

## ELECTRICAL FEATURES

12.5 kW Onan® Diesel Generator

Generator Start/Stop Function on Touchscreen in Water Bay Compartment

50 Amp Electrical Service with Flexible Cord with Automatic Transfer Switch

Eight 6-Volt AGM House Batteries

Battery Disconnect Switch for House Battery

10 Watt Solar Panel to Charge Chassis Battery

3000 Watt True Sine Inverter

Integrated Block Heater

Energy Management System

Exterior Security Lights

Midship Side Turn Signals

LED Lights Recessed in Ceiling and Underneath Overhead Cabinets
Accent Lights in Feature Ceiling, Slideout Fascia Trim and Lambrequins
LED Lighting in Pull-Out Pantry, Kitchen and Bathroom Base Cabinets
LED Lights in Exterior Storage Compartments on Automatic Switches
LED Lights Installed Under Door Side Slideouts
Lights in Wardrobes
Manually Operated Hold-To-Run Slideout Switch
Automatic Generator Start on Low Battery or Temperature Setting
Cable TV Connection
Interior Courtesy Lights
USB Outlet at Dinette and Bedroom Night Stand
USB Outlet at Dash for Driver Use
Power Rewind Wheel with 50' Cord
Recessed Docking Lights
KIB Touch Screen Interior Light and Shade Controls
Secondary Multiple Touchscreen in Bedroom
Silverleaf® Multiplex Electrical Wiring System
Solar Prep with Six Gauge Wire from the Roof House Battery Compartment
Spare Fuses in Chassis and House Fuse Panels
110 Volt Recept in Bed Overhead with Two Pass-Through Ports
110 Volt/USB Outlet at Head of Each Bunk*
Transfer Switch with Surge Protector
Reading Lights at Head of Bed-Dimmable with Adjustable Aim
Multiplex Lighting Control System with LCD Display Touchscreen
System Control App to Control Numerous Features from Personal Device

<b>OPTIONS</b>
LED Strip Lighting Installed Under Off Door Side Slideouts
Four Flexible 110 Watt Solar Panels on Roof
Cord Connection 50 Amp/120/240 Volt for Stacker Trailer
Lithium Ion 640 AHR Battery System with Two 3000W Pure Sine Inverters
Lithium Ion 960 AHR Battery System with Two 3000W Pure Sine Inverters

**PLUMBING & BATH FEATURES**

Demand Water System
Sewage Holding-Tank Rinse
Dometic® 321 China Bowl Stool or Macerator Stool*
Aqua Miser® Shower System
Tiled Shower Walls with Glass Door
Fold-Down Shower Seat*
Water Filter for Entire Unit

Exterior Shower
Auto Fill for Fresh Water Tank
Power Water Hose Reel
12 Volt Dump Valves
150 Gallon Fresh Water Tank
Grey Holding Tank Rinse
Bladder Tank for Water Pump System
Hot Water Line Run to Front Off-Door Side Storage Bay

<b>OPTIONS</b>
Assist Handle in Each Shower
RV Sanicon Turbo System

**INTERIOR FEATURES**

Tile Floor in Kitchen, Bathroom, Bedroom and Living Areas
Auto Motion Power Shades and Lambrequins
Interior Assist Handle at Main Entry Door
Fitted Non-Quilted Bedspread with Accent Pillows
Safe Located in Bedroom Wardrobe
Wastebasket in Kitchen Base Under Sink
Shoe Storage Shelves Recessed in Rear Cap of Wardrobe*
Flush Handles on Swinging Bath Doors
Hardwood Raised Panel Interior Passage Doors
Padded Vinyl Ceiling with Designer Feature Panels
Power Stepwell Cover

**CABINETS & FURNITURE**

Bermuda Glazed Maple Hardwood Cabinets with Raised Panel Doors-Matte Finish
Concealed Hinges on Cabinet Doors
Super Polished Solid-Surface Countertop in Kitchen with Undermounted Stainless Steel Sink and Sink Covers
Super Polished Solid-Surface Countertop in Bathroom and Bedroom
Cooktop Cover Flush, Matching Countertop Material
Lifts on Bed Top
Pull-Out Pantry Shelves*
Push-to-Release Drawer Slides in Pantry
Pantry with Space for Serving Trays and Bakeware
Soft-Close Side Hinge Cabinet Doors
Drawers with Dove Tail Sides with Self-Closing Full Extension Ball Bearing Guides
Villa Furniture
Plush Pillow Top Mattress

Extended Rotation Concealed Hinge for Washer and Dryer Cabinet Door
Mesh Cell Phone Holder at Each Bunk Bed*
Molded Silverware Divider Tray
Driver and Passenger Seats Air Ride with Electric Lumbar

<b>OPTIONS</b>
Driftwood Glazed Maple Hardwood Cabinets with Raised Panel Doors-High Gloss or Matte Finish
Bermuda Glazed Maple Hardwood Cabinets with Raised Panel Doors-High Gloss Finish
Glacier Glazed Maple Cabinets with Raised Panel Doors-High Gloss or Matte Finish
Sable Maple Hardwood Cabinets with Raised Panel Doors-High Gloss or Matte Finish
R5 Radius Corner Air Mattress
Convertible Dinette with Two Fixed and Two Folding Chairs that Face to Window
Combination Desk/Dinette with Buffet Table, Two Fixed and Two Folding Chairs
Euro Booth Dinette with Two Table Leaves and Two Folding Chairs
Euro Booth/Hide-A-Bed Combo 162" with Two Table Leaves and Two Folding Chairs
Two Recliners with Lampstand and Reading Lights
Powered Theater Seating 74" with Reading Lights and Lighted Cup Holders
Powered Theater Seating 87" with Reading Lights and Lighted Cup Holders

## APPLIANCES & ACCESSORIES

Stainless Steel 30" Convection Microwave with Air Fryer Feature
Air Horns
Whirlpool® 19.7 Refrigerator
Splendide® Two-Piece Stacked Washer and Dryer
All Electric Flush Mount Induction Cooktop
Central Vacuum with Tool Kit

<b>OPTIONS</b>
Dishwasher in Drawer with Stainless Steel Front Located Below Cooktop
Freezer on Pull-Out Tray in Exterior Compartment
Beverage Center with Wine Cooler and Stemware Rack

## AUDIO, VIDEO & ACCESSORIES

Samsung® LED TV in Living and Bedroom Areas* (TV Sizes Vary Per Floor Plan)
Samsung® 50" 4K LED TV on Televator in Living Area*
Bose® 900 Sound Touch in Living Room
Xite Dash Radio with Apple CarPlay®, 9" Single Monitor with Nav-N-Go Navigation
Winegard Rayzar Automatic Digital TV Antenna
Satellite Dish Prep on Roof
Two Bedroom Radio Speakers
TV Jack and 110 Volt Recept in Door Side Exterior Storage Compartment
Cat 6 TV Cables
CB Prep with Antenna
Infrared Repeater System to Operate Audio/Visual Components
WiFiRanger Denali/Spruce LTE
10 Bc Fire Extinguisher, Smoke, Propane and Carbon Monoxide Detectors
Bose® 500 Subwoofer
Xite Triview Rear View Camera
HD 360 Camera System

<b>OPTIONS</b>
SiriusXM® Radio Capability with Antenna (Does Not Include Monthly Subscription)
Exterior Entertainment Center in Storage Compartment with Samsung® 43" 4K LED TV and Bose® Soundbar
Exterior Entertainment Center in Sidewall with Samsung® 43" 4K LED TV and Bose® Soundbar
Camera Rear (2) Prep for Use with Stacker Trailer
Two-19" Skyworth TV/DVD Monitors at each Bunk*
Universal Toll Module
WiFi System Everest with Aspen Interior Router
Winegard Automatic Open Face Satellite Dish for DISH HD and Bell HD TV
Winegard Automatic Open Face Satellite Dish for DISH and Winegard In-Motion for DISH Network
Winegard Automatic Open Face SWM Satellite Dish for DIRECTV STD/HD
Winegard In-Motion Dome Satellite Dish for DISH STD/HD, DIRECTV STD and Bell Canada

\*Check with dealership on floor plan availability

SupremeAire



SUPREME AIRE

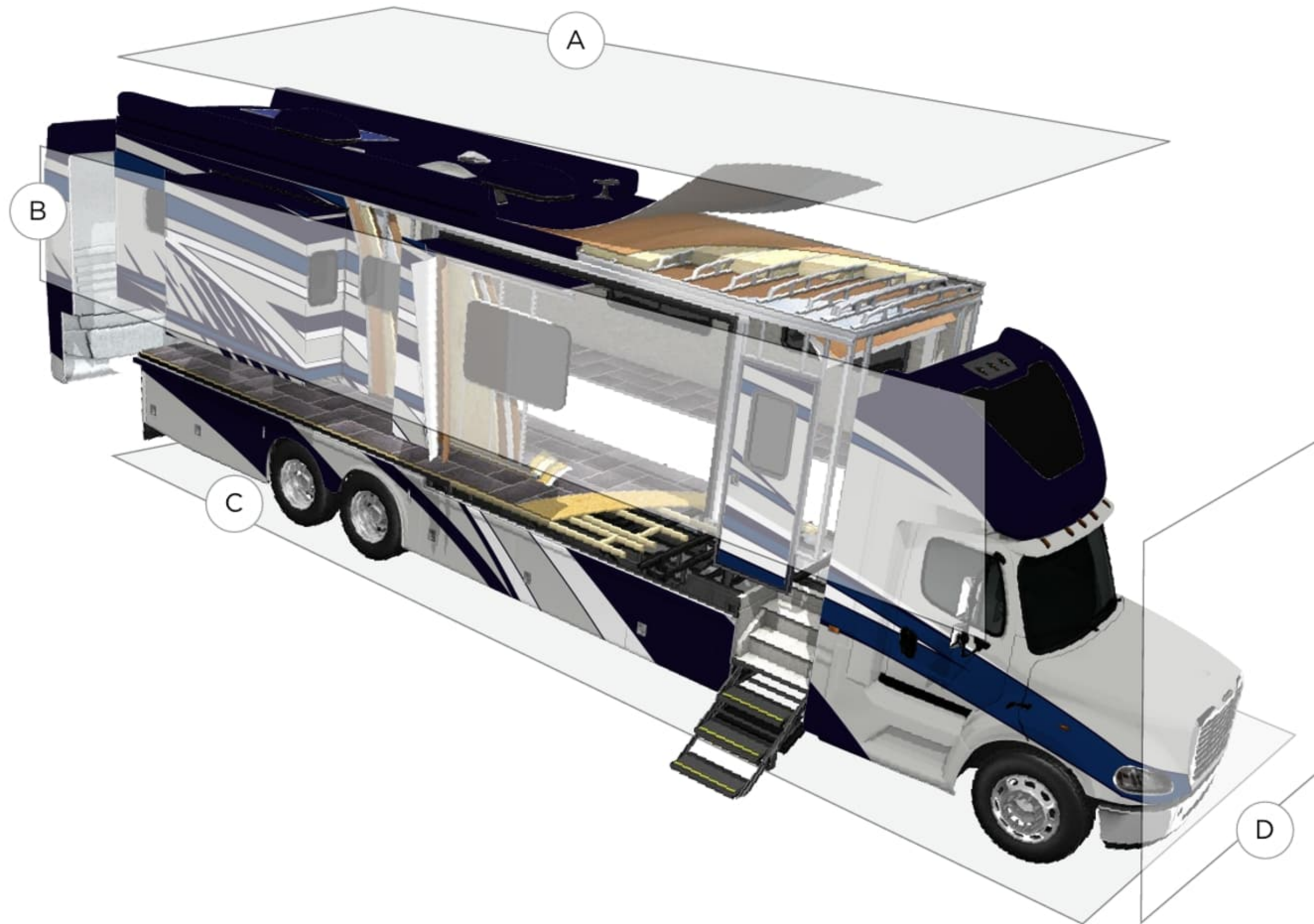

### A. ROOF

Fiberglass Roof  
 Batten Insulation  
 A/C Ducting  
 16" on Center Aluminum Rafter Framing  
 Kraft Paper Vapor Barrier  
 5/8" Bead Foam  
 3/16" Panel  
 Padded Vinyl Overlay

### B. SIDEWALL

Interior Wall Panel  
 5/8" Bead Foam  
 Kraft Paper Vapor Barrier  
 Batten Insulation  
 Composite One-Piece  
 Gelcoat Exterior Sidewall  
 Aluminum Framing

### C. FLOOR

Carpet/Tile  
 Carpet Padding  
 5/8" Floor Decking  
 Batten Insulation  
 16" on Center Wood Framing  
 Polyethylene Moisture Barrier

### D. EXTERIOR

15K BTU Penguin™ Heat Pump Central  
 Air Conditioner  
 One-Piece Bonded Windshield  
 Coated Aluminum Wheels  
 Frameless, Double-Pane,  
 Tinted Safety Glass Windows  
 Side-Hinged Baggage Doors with  
 Optional Pull-Out Tray

# The Newmar Customer Experience

The Newmar Difference™ goes beyond our industry-leading motor coaches to provide you with an unrivaled ownership experience.



## Quality from the Start

Every Newmar is crafted one at a time by folks who have spent an average of eight years building them. And each coach we assemble must undergo more than 1,000 tests and checks before ever leaving our factory.



## Carefully Selected Dealers

We view our dealership network in terms of quality, not quantity. Each of our dealers acts as a partner in our shared mission to exceed your highest of expectations, for an ownership experience that's second to none from day one.



## Everything in One Place

As a Newmar owner, you'll find resources specific to your coach through Newgle, an easy-to-use knowledge base that houses everything from user guides to technical support documents.



## Friends for Life

Meet fellow owners through the Newmar Kountry Klub, a top social club for RV travelers that hosts rallies and other special events throughout the U.S. and Canada.



## Seamless Service

When you join the Newmar family, we pair you with a dedicated service specialist with expert knowledge of your exact coach. Our service specialists guarantee dealer warranty authorizations within four business hours and ship all in-stock parts the same day, free of charge.



## Rock-Solid Protection

All models include a one-year/unlimited mileage limited warranty and a five-year, non-transferable structural warranty that covers your coach's superstructure in the event it fails to perform. Ask your Newmar dealer for more details.

*Our Partners*

The Newmar Difference™ begins with suppliers dedicated to providing our customers with unrivaled quality, comfort, and support.



*BASF*

The Coatings division of BASF is a global expert in the development and production of innovative and sustainable OEM and refinish coatings. Coatings by BASF—solutions beyond your imagination.



*Industrial Finishes*

Industrial Finishes has supported RV manufacturers for over four decades, offering paint products that deliver uncompromising quality and provide your coach with a true Masterpiece™ finish.



Driven By You

*Freightliner Custom Chassis*

Freightliner Custom Chassis are renowned for their exceptional ride, excellent maneuverability, advanced technology, and nationwide 24/7 factory-direct support.



*RiverPark*

From Samsung® 4K TVs and Xite Infotainment systems to Bose® soundbars and JBL and Infinity premium audio systems, RiverPark helps you experience a higher level of technology in your Newmar coach.



*Spartan RV Chassis*

An American company with over 30 years of experience in designing and manufacturing the premier motorhome chassis, Spartan delivers superior performance, exceptional safety ratings, and industry-leading technology.



WHEN YOU KNOW THE DIFFERENCE™