

Shasta

COACHMEN

2025 TRAVEL TRAILERS



Shasta
COACHMEN

AFFORDABLE QUALITY... RICH HERITAGE – SINCE 1941

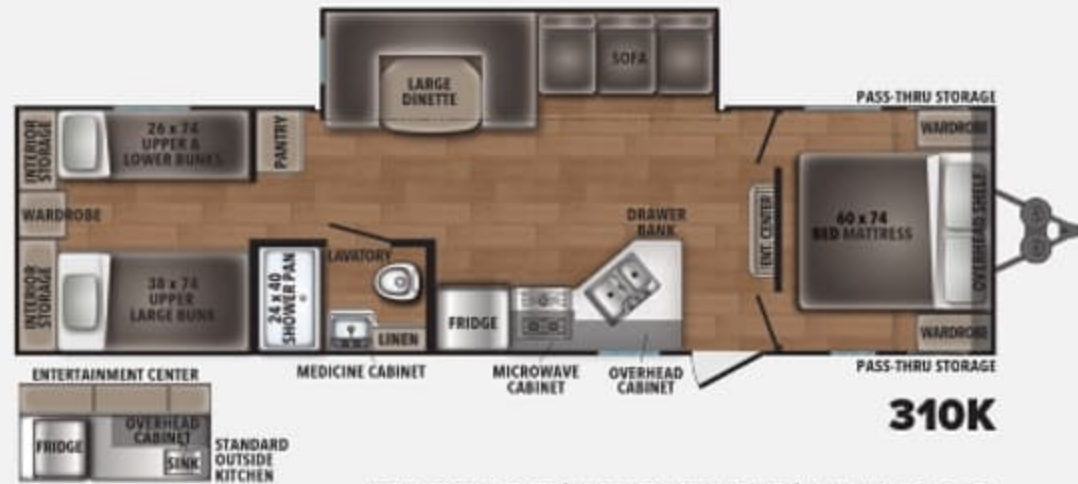

LENGTH 36' | HEIGHT 11'5" | UVW 6,459
GVWR 7,750 | HITCH WEIGHT 660
TANKS: FRESH 39, BLACK 30, GREY 30



FOR MORE
INFORMATION, PICTURES,
AND 360 VIRTUAL TOURS
VISIT SHASTARVING.COM



LENGTH 31'8" | HEIGHT 11'3" | UVW 5,318
GVWR 6,950 | HITCH WEIGHT 580
TANKS: FRESH 39, BLACK 30, GREY 30



LENGTH 36'7" | HEIGHT 11'8" | UVWR 7,278
GVWR 9,580 | HITCH WEIGHT 780
TANKS: FRESH 39, BLACK 30, GREY 30



LENGTH 24'2" | HEIGHT 11'3" | UVW 4,417
GVWR 6,350 | HITCH WEIGHT 455
TANKS: FRESH 39, BLACK 30, GREY 30



LENGTH 30'3" | HEIGHT 11'3" | UVW 5,238
GVWR 6,750 | HITCH WEIGHT 580
TANKS: FRESH 39, BLACK 30, GREY 30



FOLLOW US

STANDARDS, OPTIONS AND PACKAGES

STANDARDS EXTERIOR

- Full Pass-through Storage
- Front Colored Rock Guard
- Power Awning w/LED Light
- 200W Solar Panel
- Magnetic Baggage Door Catches
- Bumper with Drain Hose Carrier and End Caps
- Straight Axle with Electric Brakes
- E-7 Lube Hubs
- Radius Entry Door with Screen
- Molded Rain Gutter with Extra long Spouts
- Tinted Black-Framed Radius Safety Glass Windows
- XL Grab Handle
- Outside Shower
- Exterior Cable Hook Up
- Ladder Prep

STANDARDS INTERIOR

- Fireplace
- LED Interior Lights
- Pleated Shades
- Decorative Cabinet Pulls
- Pocket-Bored and Screwed Cabinets
- Full Extension Ball Bearing Drawer Guides
- Lounge Sofa

- King Wifi Prep
- Blackout Shades in Bedroom
- Box Valances in Living Area
- USB Charging Stations
- Cable TV Hook-up in Living Area and in Bedroom
- RG6 Coaxial Cable
- Congoleum Flooring
- Under Bed Storage with baskets
- Sink Cover
- Decorative Bedspread

STANDARDS KITCHEN

- 3-Burner Cook Top Stove with oven & Glass Cover
- Oversized Stainless Steel Residential Sink with Pull Down Sprayer
- Range Hood with Exhaust Fan
- Decorative Back Splash

STANDARDS BATHROOM

- Shower & Surround
- Powered Roof Vent
- Marine Foot Flush Toilet
- Medicine Cabinet with Mirror
- Large Sink
- Skylight
- Motion Sensor Lights

STANDARDS POWER SYSTEMS

- 12V Demand Water Pump
- Auto-Ignition Furnace with Wall Thermostat
- Water Heater Bypass
- Water System Winterization Kit
- 18K BTU or 25K BTU Furnace

STANDARDS CONSTRUCTION

- .030Aluminum Exterior Skin
- Radius Wood Rafters
- R-7 Fiberglass Insulation in All Walls, Floor and Roof
- Aerodynamic Radius Front Profile
- 16\" On Center Wood Wall Studs
- Electric Slide Rooms
- Tufflex PVC Roof Material with Lifetime Limited Warranty
- 8' Exterior Width
- Cambered Steel I-Beam Frame

STANDARDS SAFETY FEATURES

- Co2 Detector
- LP Leak Detector
- Fire Extinguisher
- Smoke Alarm
- CPAP Docking Station

OPTIONS EXTERIOR

- Electric Stabilizer Jacks
- Aluminum Wheels
- Grill/Griddle Combo
- 15K BTU A/C IPO 13,500
- 50 Amp Service with 2nd AC Prep
- 2nd 13.5K BTU AC with 50 AMP Service
- Three 13.5K BTU AC with 50 AMP Service 30 Foot and Up

OPTIONS INTERIOR

- 8 cu ft Gas/Electric Refrigerator
- Theater Seating (N/A 25RB)

STEP UP PACKAGE - REQUIRED

- Glass Cooktop/Oven
- Flipup Storage Rack
- Solid Step
- Power Tongue Jack
- Enclosed Underbelly

CAMPING WITH EASE PACKAGE (REQUIRED)

- Black Tank Flush
- Bluetooth Portable Speaker
- Tankless Water Heater
- Microwave Oven
- 13.5K BTU Ducted A/C (25' and above)
- Seamless Countertops
- (4) Stabilizer Jacks
- 10 cu ft Residential Refrigerator
- Double 20# LP Bottles w/ABS Cover
- Under-Mount Kitchen Sink with Cover
- Pulldown Faucet
- Spare Tire
- Battery Disconnect
- Roadside Assistance
- 200W Solar Panel w/30 Amp controller
- Backup Camera Prep

SPECIFICATION DEFINITIONS

GVWR (Gross Vehicle Weight Rating)— is the maximum permissible weight of the unit when fully loaded. It includes all weights, inclusive of all fluids, cargo, optional equipment and accessories. for safety and product performance do NOT exceed the GVWR.

GAWR (Gross Axle Weight Rating) — is the maximum permissible weight, including cargo, fluids, optional equipment and accessories that can be safely supported by a combination of all axles.

UVW (Unloaded Vehicle Weight)* — is the typical weight of the unit as manufactured at the factory. It includes all weight at the unit's axle(s) and tongue or pin and LP Gas. The UVW does not include cargo, fresh potable water, additional optional equipment or dealer installed accessories.

*Estimated Average based on standard build optional equipment.

CCC (Cargo Carrying Capacity)** — is the amount of weight available for fresh potable water, cargo, additional optional equipment and accessories. CCC is equal to GVWR minus UVW. Available CCC should accommodate fresh potable water (8.3 lbs per gallon). Before filling the fresh water tank, empty the black and gray tanks to provide for more cargo capacity.

**Estimated average based on standard build optional equipment. Each Forest River RV is weighed at the manufacturing facility prior to shipping. A label identifying the unloaded vehicle weight of the actual unit and the cargo carrying capacity is applied to every Forest River RV prior to leaving our facilities.



**CUSTOMER SERVICE IS
OUR #1 PRIORITY!**



PRE-DELIVERY INSPECTION

20,000 square feet of quality assurance. The bare essentials for a premium product. This state-of-the-art facility gives immediate daily feedback to production for quality assurance in every unit built.

FREE MEMBERSHIP
to Forest River Owners' Group

www.forestriverfrog.com



Learn More
Scan this barcode using
a QR Reader on your
smart phone to learn
more about Forest River.



SHASTA HISTORY

- 1941** – Robert Gray built the first Shasta to be used as mobile military housing in California.
- 1951** – Shasta produced what would become the most popular travel trailer of the era, The Toaster on Wheels, featuring the iconic Shasta Wings.
- 1972** – W.R. Grace Company buys Shasta from Robert Gray. At this time, Shasta was the largest seller of RV's in the US.
- 1976** – Coachmen Industries buys Shasta RV from W.R. Grace.
- 2010** – Shasta re-emerged as a division of Forest River.
- 2015** – Shasta introduced the 1961 Airflyte re-issue campers.
- 2021** – Celebrating 80 Years of Excellence!



FOLLOW US

SHASTA OWNER "DIGITAL KIT" APP

Now you can have your Owner's Manual with you wherever you are. Download our FREE App from the App Store or Google Play and you'll have the information right at your fingertips.



24/7 EMERGENCY ROADSIDE ASSISTANCE WITH VEHICLE PURCHASE*

| | |
|----------------|-----------------|
| TOWING | WINCH-OUT |
| JUMP-STARTS | MOBILE MECHANIC |
| TIRE CHANGES | TECHNICAL |
| FLUID DELIVERY | SUPPORT |
| LOCKOUT | DEALER LOCATOR |
| SERVICE | SERVICES |



*VALID FOR 1 YEAR FROM DATE OF PURCHASE

CUSTOMER SATISFACTION



www.ForestRiverBuyLocal.com

YOUR SHASTA DEALER:

All information contained in this brochure is believed to be accurate at the time of publication. However, during the model year, it may be necessary to make revisions and Forest River, Inc., reserves the right to make all such changes without notice, including prices, colors, materials, equipment and specifications as well as the addition of new models and the discontinuance of models shown in this brochure. Therefore, please consult with your Forest River, Inc., dealer and confirm the existence of any materials, design or specifications that are material to your purchase decision.
© Copyright 2024 Shasta, a Division of Forest River Inc – All Rights Reserved.

Shasta Recreational Vehicles
105 14th Avenue • Middlebury, IN 46540 • (574) 825.7178
www.ShastaRVing.com