

ISATA 6 2025



6 SERIES *isata*



Pictured with Optional Xplorer Dark Full Body Paint

FORESTRIVERINC.COM

ISATA 6 SERIES

In the Isata 6 Series driver's seat, you'll enjoy the confidence that comes with the control, comfort, and stability of the Ford F600 4x4 Chassis. Meanwhile, everywhere you look you'll see the extra touches - including cut and buffed paint, RV-friendly features, and luxury amenities. So wherever your journeys take you - along the busy highway or up the mountain pass, or even on the "roads less traveled", the Isata 6 Series will provide freedom and comfort like nothing else on the road.

OPTIONS



DUAL POWER
THEATER SEATS
IPO Sofa (30FW)

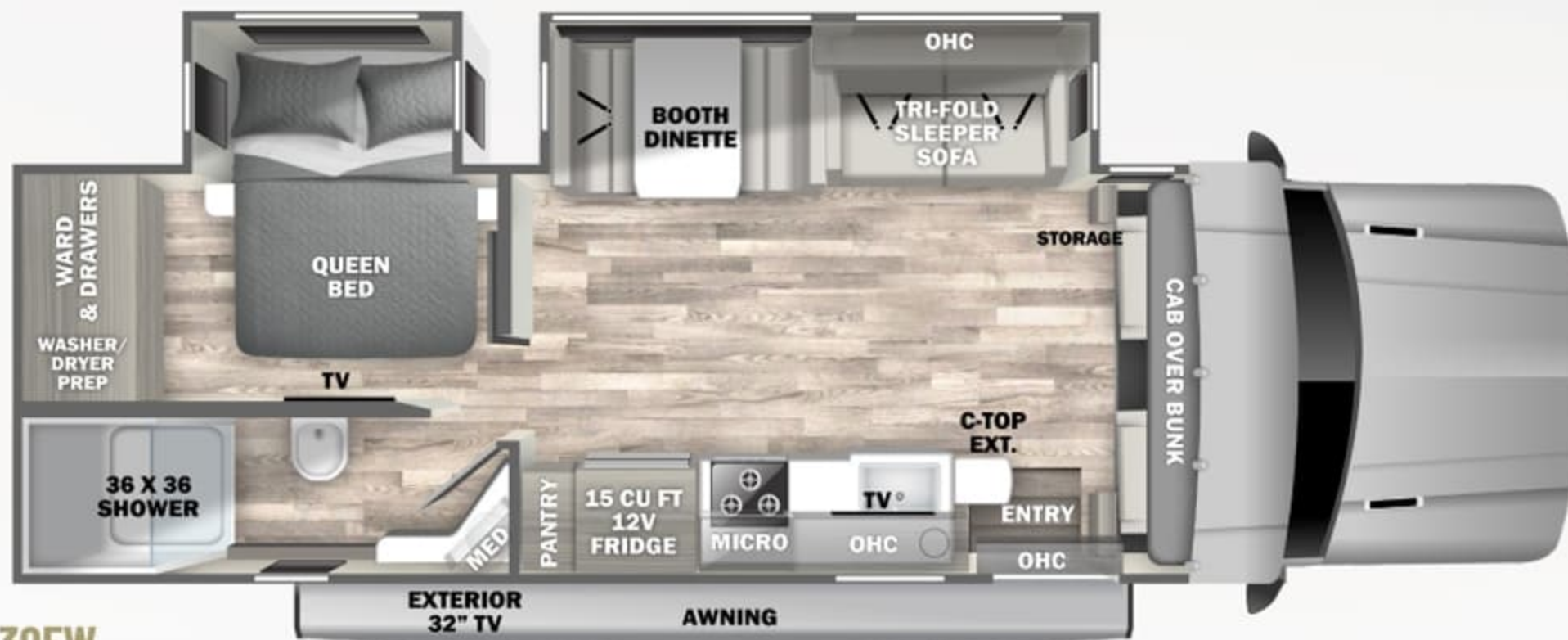

30FW
COMING SOON!

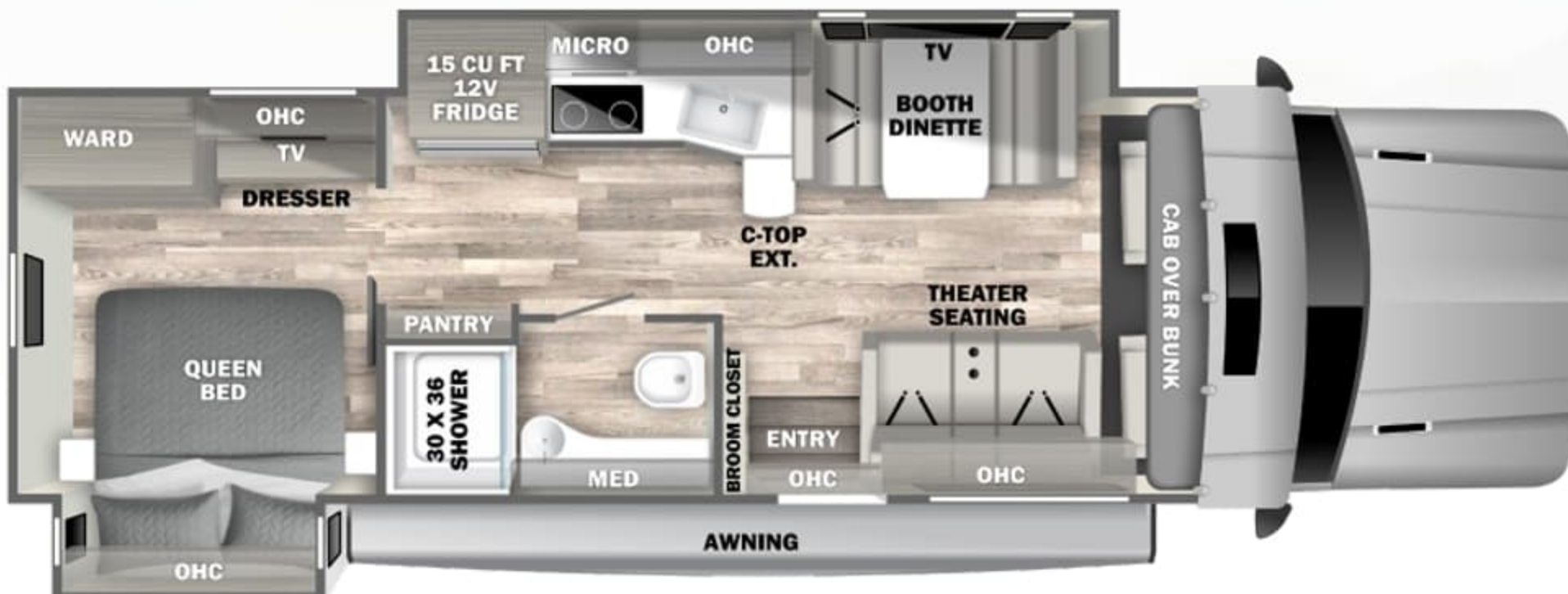

31KS

STANDARD FEATURES & OPTIONS

CHASSIS

- Ford® F600 XLT Chassis - Factory 4-Wheel Drive (22,000-lbs. GVWR / 43,500-lbs. GCWR)
- Power Stroke® 6.7L V8 Turbo Diesel (330hp / 950 lb-ft Torque)
- TorqueShift® 10-Speed Automatic Transmission
- 66.5-Gallon Fuel Capacity (Dual 40-Gallon and 26.5-Gallon Tanks)
- 7.2-Gallon Diesel Exhaust Fluid Tank
- Trailer Hitch (15,000 Tow lbs. / 1,500 Tongue lbs.) with 7-Way Round Tow Connection
- Ford® OEM Brake Controller
- Exhaust Brake
- Remote Start System
- Audible Lane Departure Warning
- AutoLamp - Auto On/Off Headlamps
- Cruise Control (Steering Wheel-Mounted)
- Pre-Collision Assist (PCA) with Automatic Emergency Braking (AEB)
- SOS Post-Crash Alert System™
- SecuriLock® Passive Anti-Theft System (PATS)
- Front and Rear Stabilizer Bars
- AdvanceTrac® with RSC® (Roll Stability Control™)
- DynaRide+ Upgraded Suspension System featuring Four-Point Bilstein® Gas-Charged Shock Absorbers and Rear MORryde® RSX™ Rubber Shear Springs with Heavy-Duty Rear Sway Bar
- Fog Lights
- Engine Block Heater
- Adjustable Gas/Brake Pedals
- Momentary Battery Booster Switch for Connecting Chassis and House Batteries
- Dual 12V Chassis Batteries

Dimensions:	30FW	31KS
GVWR	22,000 lbs.	22,000 lbs.
GCWR	43,500 lbs.	43,500 lbs.
GAWR - Front	7,250 lbs.	7,250 lbs.
GAWR - Rear	15,500 lbs.	15,500 lbs.
UVW*	TBD	TBD
Overall Length	TBD	34' 1"
Exterior Width	101"	101"
Wheelbase	244"	244"
Overall Exterior Height (w/15,000 BTU Roof A/C)	12' 6"	12' 6"
Interior Height	84"	84"
Fuel Capacity	66 Gal.	66 Gal.
Water Capacities (Gal.)		
Fresh/Gray/Black	78/45/45	78/45/45
LPG Capacity (WC)	20.3 Gal./86 lb.	20.3 Gal./86 lb.
Awning Length	16'	16'

*UVW is an estimate only based on standard equipment.

- 350-Amp Alternator
- 4-Wheel ABS
- B-20 Bio Diesel Capability
- Aluminum Running Boards
- Front and Rear Tires: 245/70RX19.5G BSW All Position
- Aluminum Single Front Wheels and Dual Rear Wheels (19.5" x 6.0")
 - *Outside Wheels are Black
- 4.30 Rear Axle Ratio
- Daytime Running Lights
- Leatherette Reclining Driver and Passenger Seats with Armrest
- 8-Way Power Driver Seat
- Quad-View Camera System (Right Side, Left Side, Hitch, and Rear Horizon Views)
- 12V and USB Accessory Ports
- 8" Touch Screen Dash Radio with SYNC® 4, Wireless Phone Connection, Cloud Connected, AppLink® with App Catalog,
- 911 Assist®, Apple CarPlay®, Android Auto®, FordPass™ Connect 5G, and Digital Owner's Manual
- Adjustable Steering Column
- Power and Heated Exterior Mirrors with Integrated Clearance Lamps and Turn Signals
- Power Windows and Locks
- 3-Point Seat Belts
- Front and Side Curtain Airbags
- Drink Holders

CONSTRUCTION

- 2" Aluminum-Framed, Laminated Sidewalls with High-Density Block Foam Insulation
- Composite Exterior Fiberglass (No Exterior Wood)
- Aluminum-Framed Floor
- Laminated Roof
- Crowned, One-Piece Fiberglass Roof
- Fiberglass Front Wing Panels
- Automatic, 4-Point Hydraulic Leveling Jacks
- Dual-Pane, Dark-Tinted, Frameless Windows with Integrated Day/Night Shades
- Seamless Rotocast Storage Compartments with LED Lighting
- Side-Hinged, Locking Aluminum Exterior Storage Doors with Paddle Latches

EXTERIOR

- Custom Full Body Paint Package
- Premium Cut and Buffed Paint Finish
- Front-End Diamond Shield® Paint Protection
- Armless Patio Awning with LED Lighting and Motion-Activated Retraction
- Slideout Toppers
- LED Patio Light
- Power Entry Steps with Upgraded SeaDek® Step Treads
- Entry Door with Rotary Latch; Dark-Tinted, Frameless Window; and Integrated Shade
- Keyless Entry Touch Pad at Entry Door

- Lighted Acrylic Entry Grab Handle
- Exterior Wall-Mounted Entertainment Center with 32" LED Smart TV and Sound Bar
- Front and Rear LED Clearance and Marker Lighting
- Rear Docking Lights
- Aluminum Running Boards
- Rear "DYNAMAX" Rock Guard

INTERIOR

- Front Cab-Over Bunk Area with Mattress (50" x 79") and Privacy Curtain
- Premium Vinyl Flooring Throughout
- Soft-Touch Padded Vinyl Ceiling
- Entry with Non-Skid Rubber Steps
- LED Recessed Ceiling Lights
- Sprung, Residential Style Dinette Seats with Lift Up Storage
- Tri-Fold Sofa (N/A - 31KS)
- Hardwood Shaker-Style Cabinetry
- Full Extension, Soft-Closing Drawer Guides (where applicable)
- Hidden Hinges
- 42" Smart LED TV (Living Area)
- Sound Bar
- Thermal, Reflective Front Privacy Shades
- USB Charging Ports

KITCHEN

- 12V 10 cu. ft Compressor-Driver Refrigerator (28SS Only)
- 12V 15 cu. ft. 3-Door Compressor-Driven Refrigerator (N/A - 28SS)
- Sealed Gas Range with Glass Cover (N/A - 31KS)
- Induction Range (31KS Only)
- Convection Microwave Oven
- Solid Surface Countertops with LED Edge Lighting and Backsplash
- Stainless Steel Sink with Solid Surface Covers
- Residential Black Spring Gooseneck Faucet
- Pantry
- Overhead Cabinet Accent Lighting
- Under-Cabinet Lighting
- MaxxAir® Power Vent with Built-In Rain Cover

BEDROOM

- Queen Bed (60" x 75") with Gel-Infused Memory Foam Mattress
- Designer Bedding Package
- 32" LED Smart TV
- Cedar-Lined Wardrobe
- LED Reading Lights
- USB Charging Ports

BATHROOM

- Designer Shower with Skylight
- Shower with Light-Weight, Soft-Sided Shower Door and Skylight
- Oxygenics Body Spa® RV Shower Head
- Top-Mount Sink with Residential Faucet
- Porcelain Foot-Flush Toilet (30FW Only)
- Porcelain Electronic-Flush Macerator Toilet (N/A - 30FW)
- MaxxAir® Power Vent with Built-In Rain Cover

UTILITIES

- Single 8D Lithium House Battery (300aH)
- Multiplex® Wiring with Touch Screen Command Center, Switch Panels, and Bluetooth® Smart Phone App Control
- Battery Disconnect
- Solar Panel - Single 200 Watt with 30 Amp Controller
- 50-Amp Service with Power Cord Reel
- 3,000W Hybrid Pure Sine Wave Inverter/Charger (3,500 Peak Watts)
- 8kW Onan® Diesel Generator with Auto Transfer Switch (Mounted on Isolator Pads)
- Automatic Generator Start
- Dual Ducted, Low-Profile 15,000-BTU Air Conditioners with Heat Pumps
- 40,000-BTU LP Furnace with Electronic Ignition
- 60,000-BTU Truma® AquaGo Comfort Plus™ On-Demand Water Heater (LP)
- 20.3-Gallon LP Tank (WC)
- LP Quick Connect
- Water Filtration System
- Exterior Shower in Service Bay
- Exterior GFCI Receptacle
- Prepped for Roof-Mounted Satellite
- KING® Jack™ Directional OTA HDTV Antenna
- 4X4 HDMI Matrix
- Cable TV/Satellite Hookup in Service Bay
- Thetford® Sani-Con Turbo Macerator System
- Black Tank Flush
- SureLevel® Tank Level Monitoring System
- Furnace-Heated Utility Compartment
- Enclosed and Furnace-Heated Holding Tanks
- Upgraded 12V On-Demand Water Pump (4 gallons per minute)
- Carbon-Monoxide, LP, and Smoke Detectors
- Fire Extinguisher

OPTIONS

- Dual, Power Reclining Theater Seats in Place of Sofa (Standard - 31KS)
- Xplorer Package - includes Insulated Cab Curtain; Two Lithium House Batteries (600aH Total); 1,000W Solar Package; and Insulated Utility Bay with Secondary Tank Heater and Temperature Sensor



Shown in Xplorer Dark Full Body Paint.
Additional Full Body Paint Options TBD.

DÉCOR SELECTIONS

DESERT

Main

Valance with Accent

MILANO

Main

Valance with Accent

DRIFTWOOD II

Kitchen
Countertop

Drawers

MINDFUL GRAY

Kitchen
Countertop

Drawers



Find us on
Facebook

FREE MEMBERSHIP
to Forest River Owners' Group

www.forestriverfrog.com



Dynamax Owner
"Digital Kit" App
Now you can have your Owner's
Manual with you wherever you are.
Download our FREE App from the
App Store or Google Play and
you'll have the information
right at your fingertips.



Paint Video
<https://www.youtube.com/watch?v=sLgLoR26jfs>

Factory Video Tour
<https://www.youtube.com/watch?v=q5cG43PD7SE>



DIFFERENT BY DESIGN



2745 Northland Dr. • Elkhart IN 46514
574-262-3474 • www.dynamaxcorp.com

GVWR (Gross Vehicle Weight Rating) - is the maximum permissible weight of the unit when fully loaded. It includes all weights, inclusive of all fluids, occupants, cargo, optional equipment and accessories. For safety and product performance do NOT exceed the GVWR.
GCWR (Gross Combined Weight Rating) - is the maximum permissible loaded weight of your motor home and any towed trailer or towed vehicle. Actual GCWR of this vehicle may be limited by the sum of the GVWR and the installed hitch receiver maximum capacity rating; see hitch rating label for detail.

GAWR (Gross Axle Weight Rating) - is the maximum permissible weight, including cargo, fluids, optional equipment and accessories that can be safely supported by each axle.

UVW (Unloaded Vehicle Weight)* - is the typical weight of the unit as manufactured at the factory. It includes all weight at the unit's axle(s), including full fuel, all fluids and LP Gas. The UVW does not include cargo, fresh potable water, additional optional equipment or dealer installed accessories.

*Estimated Average based on standard build optional equipment.

CCC (Cargo Carrying Capacity)** - is the amount of weight available for fresh potable water, cargo, passengers, additional optional equipment and accessories. CCC is equal to GVWR minus UVW. Available CCC should accommodate fresh potable water (8.3 lbs per gallon). Before filling the fresh water tank, empty the black and gray tanks to provide for more cargo capacity.

**Estimated average based on standard build optional equipment.

Each Forest River RV is weighed at the manufacturing facility prior to shipping. A label identifying the unloaded vehicle weight of the actual unit and the cargo carrying capacity is applied to every Forest River RV prior to leaving our facilities.

The load capacity of your unit is designated by weight, not by volume, so you cannot necessarily use all available space when loading your unit.

Actual towing capacity is dependent upon your particular loading and towing circumstances, which includes the GVWR, GAWR and GCWR as well as adequate trailer brakes. Please refer to the Operator's Manual of your vehicle for further towing information.

All information contained in this brochure is believed to be accurate at the time of publication. However, during the model year, it may be necessary to make revisions and Forest River, Inc., reserves the right to make all such changes without notice, including prices, colors, materials, equipment and specifications as well as the addition of new models and the discontinuance of models shown in this brochure. Therefore, please consult with your Forest River dealer and confirm the existence of any materials, design or specifications that are material to your purchase decision.

©2025 Dynamax, a Division of Forest River, Inc., a Berkshire Hathaway company. All Rights Reserved. 02/25



Learn More:

Scan this barcode
using a QR reader on
your smart phone to
learn more about
Forest River.



A Berkshire Hathaway Company

Your Authorized Isata 6 Series Dealer