

2026

DIESEL CLASS B MOTORHOME

# INSIGNIA



2026 ENTEGRA COACH INSIGNIA





## INTERIOR DECOR **RIGEL**

UPPER CABINET



LOWER CABINET

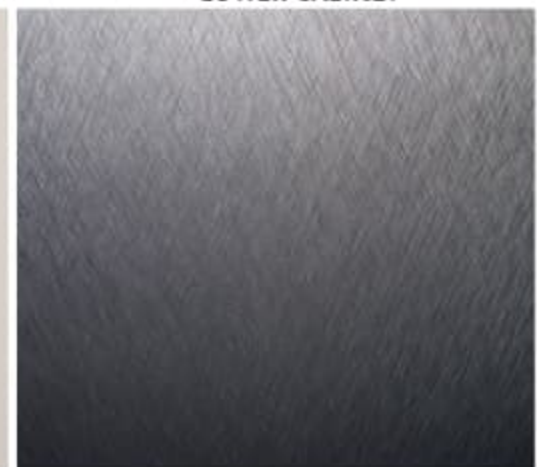

SEATING

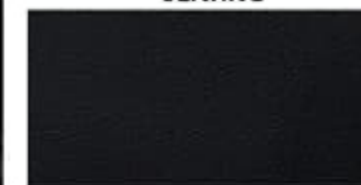

FLOORING



COUNTERTOP

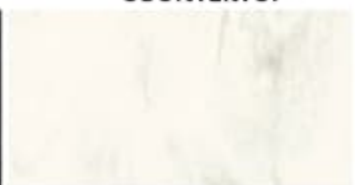

# INSIGNIA

2026 Diesel Class B Motorhome



24B

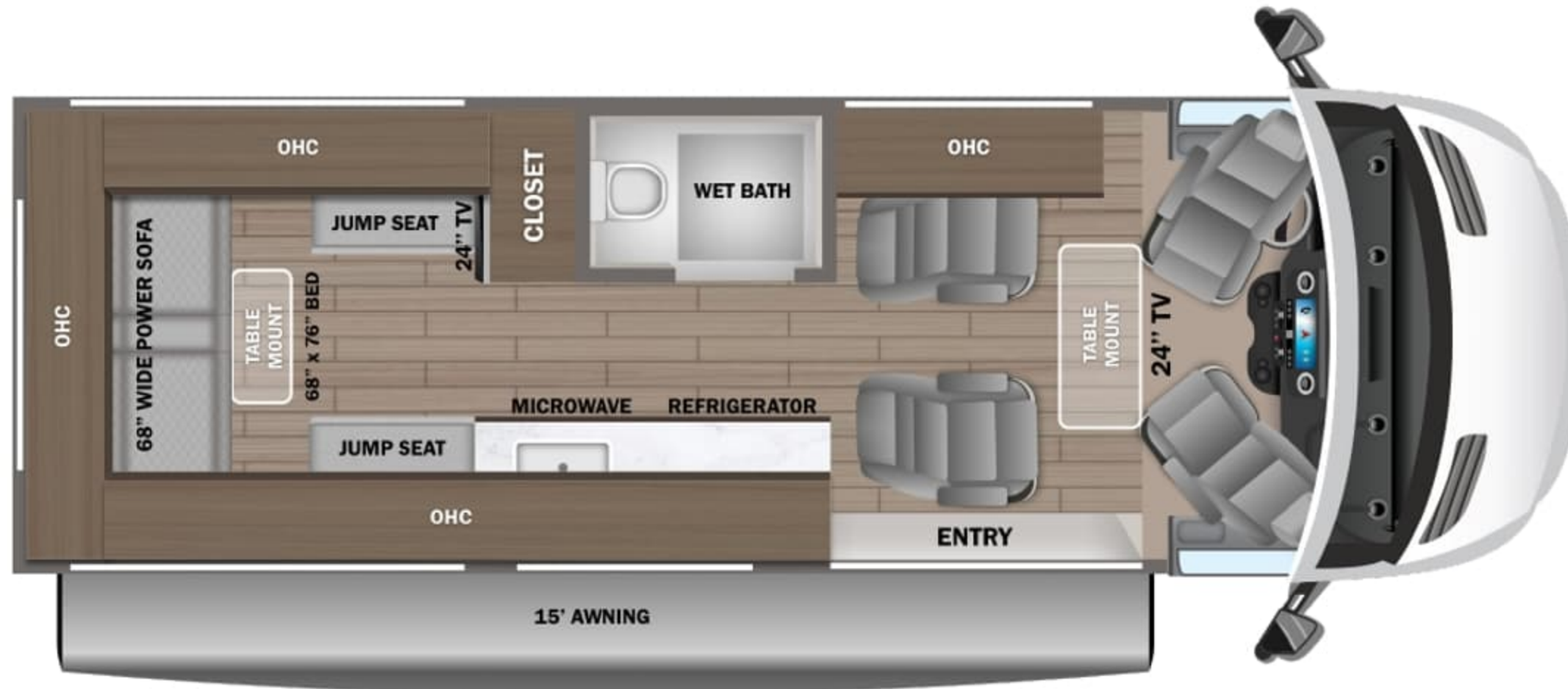

## EXTERIOR



Silver Van



## CUSTOMER VALUE PACKAGE

E-Z Drive™ Elite: Front and rear Koni® shocks, heavy duty rear stabilizer bar  
 Carefree® armless motion sensing patio awning with LED light strip  
 17,000 BTU Timberline Binar 5D hydronic heating system with LED touchscreen control  
 JBL Premium Audio experience  
 3 cu. ft. Vitri® stainless steel refrigerator  
 Winegard® Air 360 TV antenna  
 2,000W inverter

## STANDARD CHASSIS EQUIPMENT

Mercedes-Benz® Sprinter 3500 XD AWD van  
 170 in. wheelbase  
 GVWR - 11,030 lb.  
 GCWR- 15,250 lb.  
 2.0L inline 4-cylinder diesel engine with 211HP and 332 ft.-lb. torque  
 9-speed automatic transmission  
 250-amp alternator  
 AWD with torque-on-demand  
 LT215/85R16 all-season tires  
 Aluminum wheels  
 5,000 lb. rear hitch receiver with 7 pin connector  
 12V AGM chassis battery  
 24.5 gal. fuel tank (diesel)  
 5.8 gal DEF tank  
 10.25 in. integrated Mercedes-Benz® MBUX infotainment center with Apple® CarPlay™ and Android Auto™  
 Power folding/heated side-view mirrors  
 Heated power swivel driver/passenger seats  
 Leather-wrapped tilt steering wheel with integrated controls  
 Smartphone tray with wireless charging  
 12V power outlet in driver's seat base  
 Charging package in dashboard  
 Parking package with backup camera  
 Blind spot assist  
 Active Distance Assist DISTRONIC®  
 Active lane keeping assist  
 Crosswind assist  
 Hill start assist

Active brake assist  
 Traffic sign assist  
 Attention assist  
 Breakdown management  
 Emergency call system  
 Electronic stability program  
 Driver and passenger airbags  
 Rain-sensing windshield wipers  
 Rear window defrost  
 Third brake light  
 Power windows and door locks  
 Privacy shades for cab windows  
 Remote keyless entry

## STANDARD EXTERIOR EQUIPMENT

Custom fiberglass body kit  
 Fiberglass running boards for cab and entry doors  
 Chrome grille package  
 Headlight assistant  
 LED high performance headlights  
 Partial LED tail lights  
 Fog lamp with cornering light function  
 Mounting rails for roof rack  
 Cable TV hookup with RG-6 coax  
 Onan® 2,500W LP generator with auto-gen start  
  
 (2) 150W roof-mounted solar panels with dual controller  
 12V lithium house battery  
 House battery disconnect switch  
 30-amp electrical service with detachable power cord  
 120V exterior outlet  
 12.2 gal. propane tank (41 lb.)  
 LP quick-connect hookup  
 Heated grey holding tank (12V pad)  
 LED-lit concealed utility center  
 Black tank flush  
 Winterization drain system  
 12V demand water pump  
 Water filtration system

## STANDARD INTERIOR EQUIPMENT

Soft-touch vinyl ceiling  
 Dimmable high-intensity LED ceiling lights  
 Dimmable RGB accent lights throughout  
 Tecnoform® European-style cabinetry  
 Residential vinyl flooring  
 Firefly Multiplex system with (2) 7 in. wall-mounted touchscreens and mobile app for total coach control  
 120V Coleman®-Mach® 10 13,500 BTU air conditioner  
 Powered skylight above captains chairs with screen and night shade  
 Powered rear screen and blackout shade  
 Privacy shade for sliding door window  
 (2) additional cab bucket seats with slide and recline features  
 Power sofa converts to 68 in. x 76 in. bed  
 (2) jump seats in rear  
 Seatbelts in all seating locations  
 (2) 24 in. LED HD TVs  
 Adjustable table with multiple mounts  
 Induction cooktop  
 Convection microwave  
 Solid-surface kitchen countertop  
 Stainless steel sink with cover  
 Shower with magnetic curtain surround  
 Aqua View® SHOWERMISER™ water management system  
 Toilet with foot flush  
 Storage cubbies in bathroom  
 Powered roof vent in bathroom  
 Smoke alarm  
 Carbon monoxide detector  
 Fire extinguisher



At Entegra Coach, we build our RVs to handle every adventure, then back them with an outstanding warranty. Our 2-year limited warranty has you covered for 2 camping seasons. That's 730 days. For a copy of our 2-year limited warranty with complete terms and conditions, please contact your local Entegra Coach dealer.

| Floorplan | GVWR (lbs.) | GCWR (lbs.) | Wheel Base | Overall Length | Exterior Height w/ A/C & Satellite | Exterior Width | Interior Height | Fresh Water Capacity (gal.) | Grey Waste Water Capacity (gal.) | Black Waste Water Capacity (gal.) |
|-----------|-------------|-------------|------------|----------------|------------------------------------|----------------|-----------------|-----------------------------|----------------------------------|-----------------------------------|
| 24B       | 11,030      | 15,250      | 170"       | 24' 4"         | 9' 11"                             | 83"            | 74"             | 15                          | 21                               | 11                                |

It is important for your safety and enjoyment that you are aware of the weights and tow ratings of the RV you select. Consult a competent advisor for questions or advice. Whether you are new to RVing or a veteran, get a feel for the performance of your RV before heading out on the roadways. When you tow a vehicle with your RV, you must drive differently than when you drive a single vehicle. Practice hooking up, driving, backing up and braking in a safe environment or seek out professional instruction. Jayco affixes a weight label to each RV which lists weight information for that vehicle. Refer to that label to verify the vehicle will meet your requirements. Gross Vehicle Weight Rating (GVWR): The maximum permissible weight of the motorhome, including the Unloaded Vehicle Weight (UVW) plus passengers, personal items, all cargo, fluids, options and dealer-installed accessories. The GVWR is equal to or greater than the sum of the UVW and the Cargo Carrying Capacity. Gross Combined Weight Rating (GCWR): The maximum allowable combined weight of the motorhome used as a tow vehicle and the attached towed vehicle.



Part of Jayco Family of Companies

Entegra Coach, Inc., P.O. Box 460, Middlebury, IN 46540, www.entegracoach.com. See dealer for further information and prices. All information in this brochure is the latest available at the time of publication approval. Entegra Coach reserves the right to make changes and to discontinue models without notice or obligation. Photos in this brochure may show optional equipment and props for photography purposes. RVs built for sale in Canada may differ to conform to Canadian codes. ©2025 Entegra Coach, Inc. Printed in U.S.A. 2033067



entegracoach.com/ethos

LEGACY ISN'T LEFT,  
IT'S LIVED.