

JAY FEATHER SL TRAVEL TRAILER

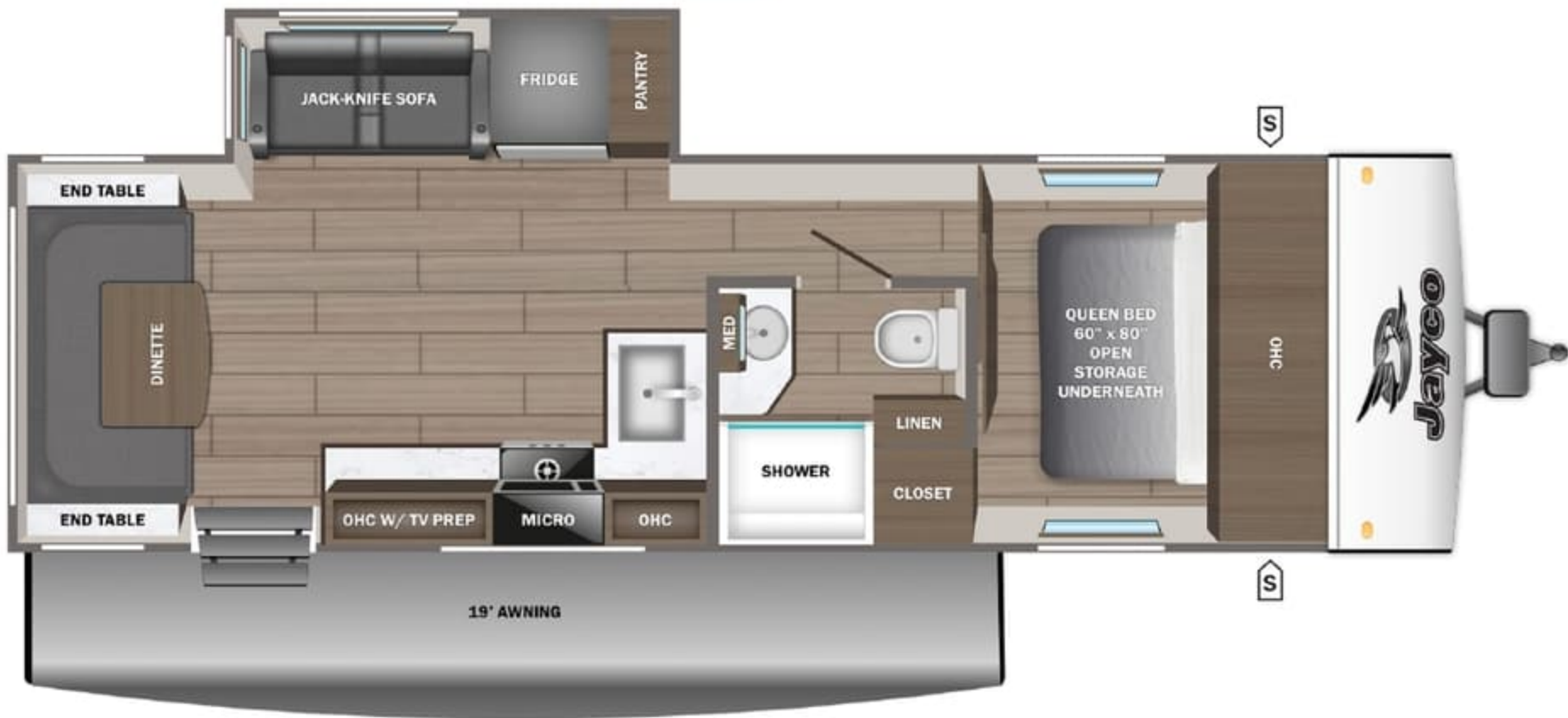

25RLSL OPTIONS: A, B



26BHSL OPTIONS: A, B

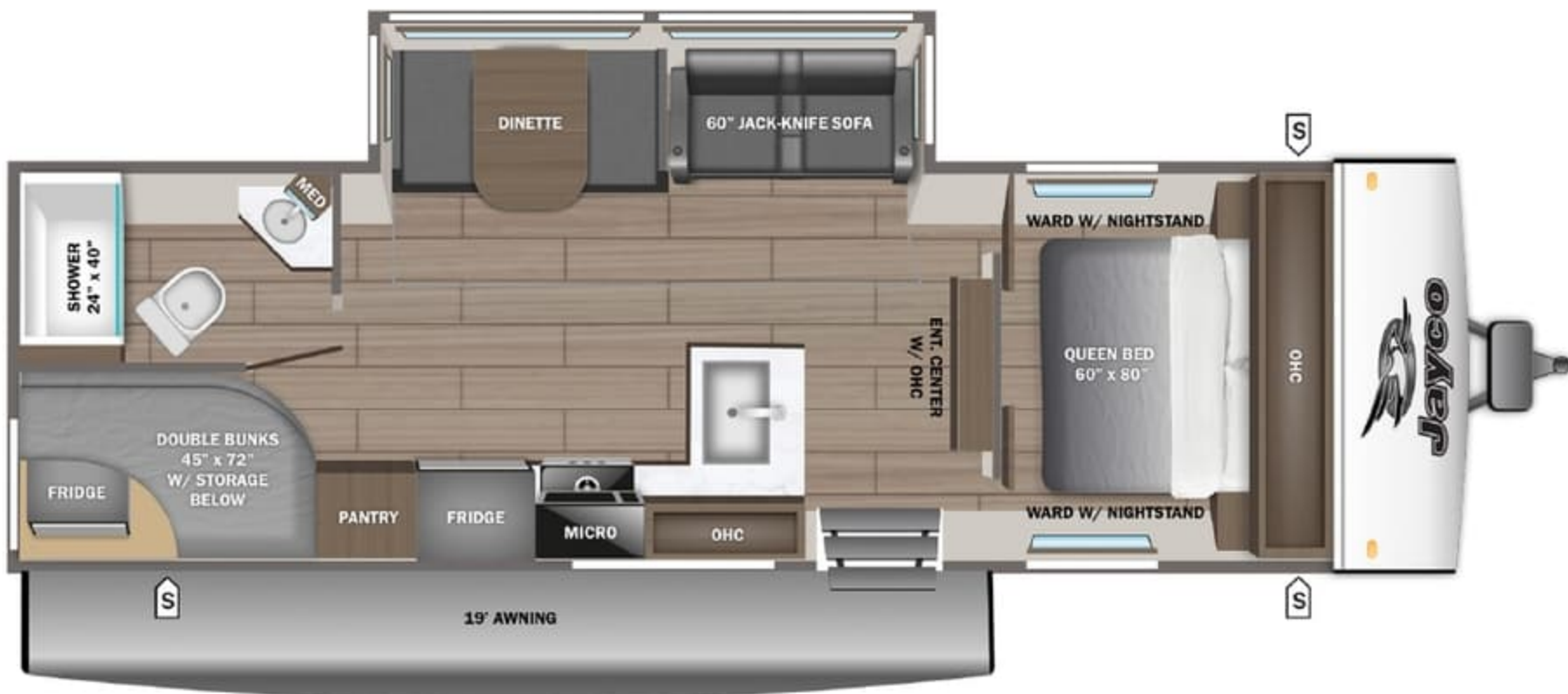

S	STORAGE
MICRO	MICROWAVE
OHC	OVERHEAD CABINETS
FRIDGE	REFRIGERATOR
WARD	WARDROBE

OPTIONS

A		B	
	Tri-fold Sofa		Theater Seat

STANDARDS & OPTIONS

EXTERIOR

- 120V power outlet
- 30-amp service
- Axles with electric, self-adjusting brakes and easy-lube hubs
- Fully-integrated A-frame
- Galvanized-steel, impact-resistant wheel wells
- Large exterior downspouts
- Magnum Truss™ Roof System
- Nitrogen-filled radial tires
- PVC roofing membrane (limited lifetime warranty)
- Slide topper prepped

INTERIOR

- 300 lb. rated single bunk beds / 600 lb. rated double bunk beds (bunk only models)
- Digital TV antenna
- Heavy-duty, 75 lb. full-extension steel ball-bearing drawer guides
- High-rise kitchen faucet
- Marine-grade toilet with foot flush
- Plywood bed platforms
- Queen mattress
- Residential-style kitchen countertops

- Solid hardwood cabinet doors with screwed-stile construction and hidden hinges
- Vinyl flooring throughout
- Wood-trimmed mirror in bathroom

CUSTOMER VALUE PACKAGE (MANDATORY)

- 11 cu. ft. 12V fridge
- 13.5K BTU Roof A/C
- 20 lb. LP bottle with auto regulator & fill gauge
- Automotive-style Aluminum Rims
- Bathroom skylight
- Detachable power cord
- Electric Fireplace Prep
- Electric vent in bathroom
- Entry door with window and shade prep
- G20 dark-tinted privacy windows
- Hidden cabinet hinges
- Inverter pre-wire outlets
- Keyed-Alike™ lock system
- Large folding entry door grab handle
- LED interior and exterior lights
- Microwave oven
- MORryde Step Above® Entry Steps
- On-demand Tankless Water Heater

- Pleated window shades
- Plywood dinette bases
- Power awning with LED lights
- Power tongue jack
- Range hood
- Rear 2 in. receiver prep
- Rear back-up camera prep
- Roof mounted solar prep
- Shower surround
- Stabilizer jacks
- Under-mount spare tire
- Vacuum-bonded sidewalls with interior and exterior Azdel® composite panels

OPTIONS

- 15K BTU roof mounted A/C
- 2nd 13,500 BTU roof mounted A/C
- 50-amp service
- Overlander 1 Solar Package: (1) 200W solar panel and 30-amp digital controller
- Tri-fold Sofa

* Indicates split tanks

FLOORPLAN	TOTAL EXTERIOR LENGTH	EXTERIOR WIDTH	EXTERIOR HEIGHT (WITH A/C)	INTERIOR HEIGHT	UNLOADED VEHICLE WEIGHT	DRY HITCH WEIGHT	GVWR	CARGO CARRYING CAPACITY	FRESH WATER CAPACITY	GRAY WASTE WATER CAPACITY	BLACK WASTE WATER CAPACITY	SLEEPING CAPACITY
25RLSL	TBD	TBD	TBD	TBD	TBD	TBD	TBD	TBD	TBD	TBD	TBD	TBD
26BHSL	30' 0"	8' 0"	10' 9"	6' 6"	5,675	765	7,200	1,525	55	38	38	8-10

Meet your Jayco Dealer



Scan QR code for specification definitions



Some specs at the time of print may include estimates. For the most updated information, please visit Jayco.com

Jayco, Inc. | P.O. Box 460 | Middlebury, IN 46540
See dealer for further information and prices. All information in this brochure and on www.jayco.com is the latest available at the time of publication approval. Jayco reserves the right to make changes and to discontinue models without notice or obligation. Photography may show optional equipment or props used for decoration purposes only. RVs built for sale in Canada may differ to conform to Canadian codes. JAYCO and the JAYCO BIRD IN FLIGHT are registered trademarks of Jayco, Inc. Printed in USA 10/25 ©2025 Jayco, Inc. 2033113

Jayco - Part of Jayco Family of Companies