

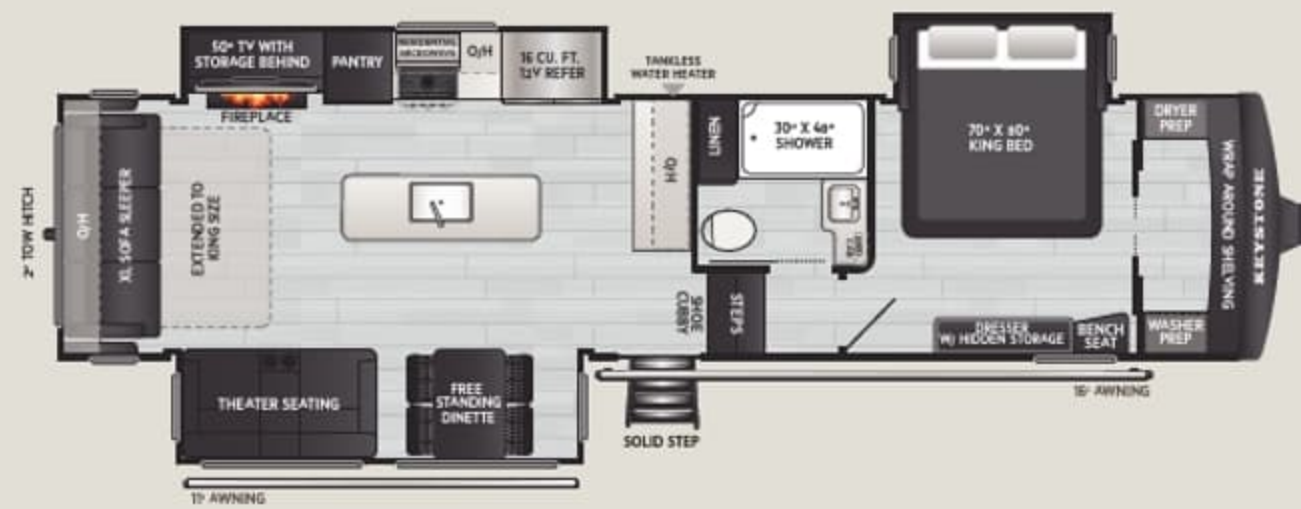

NEW



**FLOORPLAN
COMING SOON**

3260RL | WEIGHT 11080 | LENGTH 36' 4"

3790RO | WEIGHT TBD | LENGTH 41' 7"



STANDARD FEATURES & OPTIONS

INTERIOR

- ◆ NEW Elegant Two-Tone Interiors
- ◆ NEW Vinyl Roller Shades
- ◆ NEW Upgraded Wood Framed Window Trim
- ◆ Water Line Shut-Off Valves & Plumbing Fixtures
- ◆ HyperDeck™ Water-Resistant Floors
- ◆ Tankless On-Demand Water Heater
- ◆ Furrion 24" Range w/ Piezo Ignition & Glass Stove-Top Cover
- ◆ 16 cu. ft. 12V Double Door Refrigerator
- ◆ Tall Slides for Added Comfort and Headroom
- ◆ High Rise Chef's Faucet and Sprayer
- ◆ King Bed Slides
- ◆ Carpetless Flooring
- ◆ One-Piece Fiberglass Shower
- ◆ Washer/Dryer Prep
- ◆ Upgraded Qxygenics® Shower Head
- ◆ High Watt Shower Light w/ Wall Switch

EXTERIOR

- ◆ NEW ABS Brakes
- ◆ NEW Helux™ Pin Box
- ◆ NEW Safeview Smart Power Inlet
- ◆ NEW Water Filtration System
- ◆ NEW Tailights w/ LED Back-Up Light Feature
- ◆ NEW Exterior 3-Way Awning & Slide Control Switches
- ◆ Lippert SolidStep® on Main Entry Door
- ◆ Slam Latch Compartment Doors
- ◆ Dual 30lb. LP Tanks
- ◆ Winegard® Air 360+ Antenna w/ Exclusive Satellite Prep
- ◆ Exterior Stand Alone Convenience Center
- ◆ SolarFlex™ Protect
- ◆ Heated & Enclosed Underbelly w/ 12V Heated Tank Pads
- ◆ Nautilus Water Control Center
- ◆ Road Armor™ Upgraded Suspension
- ◆ Key-Alike Lock System

OPTIONS

- ◆ 2nd 15K Power Saver A/C
- ◆ Dual Pane Frameless Windows
- ◆ Factory Installed Slide Awnings
- ◆ SolarFlex™ Discover
- ◆ Dragonfly® Energy Lithium-Ion Batteries

