

3123RL WEIGHT 12881 LENGTH 35'1"

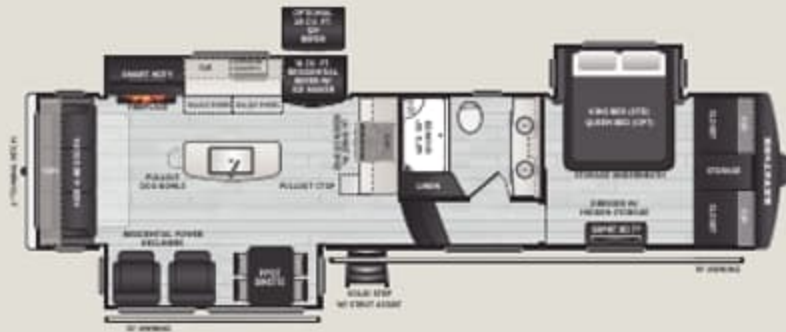

3231CK WEIGHT 13169 LENGTH 37'5"

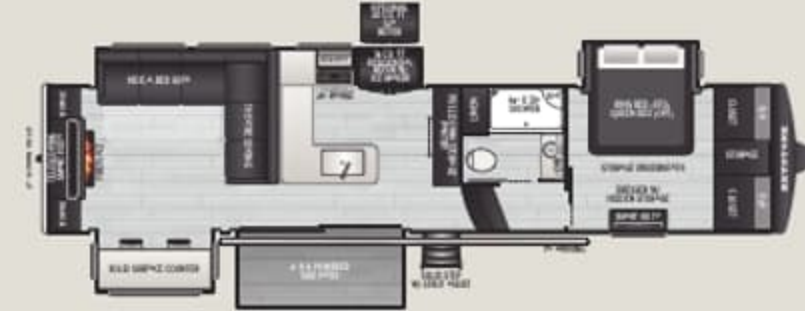

3532SP WEIGHT 14405 LENGTH 39'2"



3761FL WEIGHT 14951 LENGTH 41'0"



3781RL WEIGHT 13790 LENGTH 41'0"



3795FK WEIGHT 14030 LENGTH 39'11"



3857BR WEIGHT 14668 LENGTH 40'11"

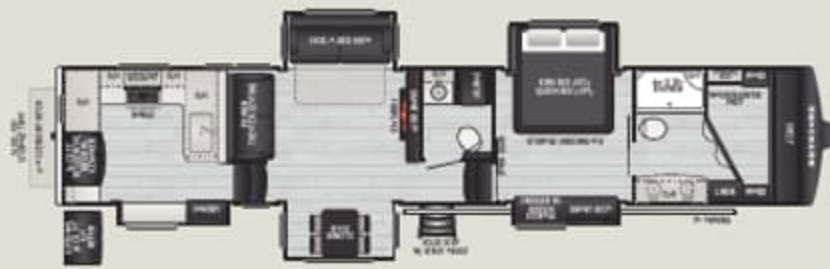

3901RK WEIGHT 15063 LENGTH 42'4"



3915TB WEIGHT 15222 LENGTH 43'0"



3941FO WEIGHT 15644 LENGTH 42'7"



STANDARD FEATURES & OPTIONS

INTERIOR

- ◆ La-Z-Boy® Furniture Package
- ◆ Manhattan Maple Interiors w/ Birch & White Accents
- ◆ Hardwood Cabinet Drawers, Doors, Stiles and Window Treatments
- ◆ Soft Close Cabinet Drawers and Doors
- ◆ Solid Surface Countertops
- ◆ Starlink Prep
- ◆ Belair Vinyl Flooring w/ 7-Year Cold Cracking Warranty
- ◆ Island Design w/ built in Dog Dishes (SELECT MODELS)
- ◆ Waterfall Sink with Added Attachments
- ◆ Dishwasher Prep (Select Models)
- ◆ 24" Furrion Stove w/ Matching Stainless Steel Drawer
- ◆ Stainless Steel Convection Microwave
- ◆ 18 cu. ft. Residential Refrigerator w/ Ice Maker (Opt. 20 cu. ft. 12V Refrigerator w/ Ice Maker)
- ◆ 50" Smart TV in the Living Room & 32" in Bedroom
- ◆ JBL® Stereo with Mizone Control & Subwoofer
- ◆ Central Vacuum with Toe Kick
- ◆ Adjustable Shelving in Pantry
- ◆ Flip Up Jewelry Box Storage Built into Bedroom Dresser Top
- ◆ Sliding Silverware Storage Built into Dinette Table
- ◆ Dual Suite Front Closet w/ Washer/Dryer Prep
- ◆ Bathroom Storage w/ Built-In Spot for Hair Dryer & Curling Iron
- ◆ Dual Sided Memory Foam Mattress
- ◆ 6'6" Main Floor Slide Box Height

EXTERIOR

- ◆ Square Frameless Windows w/ Built in Reflective Shades
- ◆ Fibrogloss™ High-Gloss Sidewalls
- ◆ MaxTurn™ Technology Front Cap
- ◆ 30" X 78" Oversized Entry Door
- ◆ MORryde Telescoping Entry Door Rail
- ◆ MORryde Strut Assist Flip Down Solid Steps
- ◆ Insulated Baggage Doors
- ◆ Split Baggage Doors on Off Door Side (SELECT MODELS)
- ◆ 3K lbs. Tow Hitch (3123RL, 3231CK, 3532SP, 3781RL, 3857BR)
- ◆ 300 lbs. Accessory Hitch (3761FL, 3795FK, 3901RK, 3941FO)
- ◆ Zero Degree Tested for 48 Hours
- ◆ Built in Water Filtration
- ◆ Exterior Lighting Package
- ◆ 220 Watt Future Solutions Solar Panel w/30 AMP Control
- ◆ 16 Gal Gas/Electric Hot Water Heater
- ◆ Dual Battery Box
- ◆ Triple 15k BTU Power Saver A/C's
- ◆ 16,500 BTU Heat Pump on Main A/C
- ◆ Dynamic Exterior Graphics (5 Year Warranty)
- ◆ MORryde CRE3000 Suspension
- ◆ MORryde Rubber Pin Box
- ◆ Upgraded 7K lb. Dexter® Gladiator Axles (8K lb. on 3761FL, 3901RK, 3915TB, 3941FO)
- ◆ 17.5" wheels w/ H-Rated Tires

OPTIONS

- ◆ Legacy Package: Disc Brakes, Power Cord Reel, Starlink Roof Panel, Winegard Router, Furrion Side/Rear Cameras, Surge Protector, Electric Dump Valves, Rear Fiberglass Cap (SELECT MODELS)
- ◆ Full Body Paint Options Available: NEW Glacier, Volcano, Sterling, Cobalt
- ◆ Dual Pane Frameless Windows
- ◆ Solar Flex Discover
- ◆ Solar Flex Outlast Extreme
- ◆ DragonFly® Energy Lithium-ion Heated Batteries
- ◆ MORryde Independent Suspension
- ◆ Generator Prep
- ◆ Onan Marque Gold 5.5kw LP Generator
- ◆ Slide-Out Awning Toppers
- ◆ Stackable Washer/Dryer
- ◆ Queen Bed

