

NEWMAR



SUPREME AIRE

2026 SUPER CLASS C MOTORCOACH

A Perfect Pairing of Bold Performance and Style

Your journey deserves more than ordinary travel—it demands the unrivaled capability and refined luxury of the 2026 Supreme Aire. When adventure calls beyond conventional routes, you'll appreciate the commercial-grade engineering beneath the Supreme Aire's elegant exterior. This Super C delivers the freedom to travel on your terms, with the stability and power to transform every excursion.



Cascadia 116 Single Axle Freightliner® Chassis

Cummins DD13 Diesel Engine | 525 HP | 1,850 lb./ft. torque | Sterling* Full-Paint Masterpiece Finish™ Exterior



38' - 41' / 2 floor plans

*2025 model with M2-112 chassis shown

Cascadia 126 Tandem Axle Freightliner® Chassis

Cummins DD16 Diesel Engine | 600 HP | 1,850 lb./ft. torque | Portage Full-Paint Masterpiece Finish™ Exterior



43' - 45' / 3 floor plans

COCKPIT

Full Air-Ride Cab

Driver and Passenger Seats with
Pneumatic Lumbar and Swivel

Sky Window

Power Shade

Xite Dash Radio

10" Infotainment Screen

Apple CarPlay®

HD 360 Camera System

Tri-View Rear Camera

Predictive Grid Lines

Detroit Assurance Safety System

Object Detection

Active Brake Assist

Pedestrian Detection

Auto On/Off Headlights

Auto Rain Sense Wipers

Intelligent High Beams

Adaptive Cruise Control







Floor plan 4505 shown with Palisades décor and Chestnut Glazed cabinets

CABIN

All-New Interior*

Three Décor Options: Brighton, Palisades, and Saguaro

MCD Window Shades

Designer Feature Ceiling

Villa Comfort Fit Furniture

87" Powered Theater Seating with
Enhanced Center Console*¹ (Optional)

50" Samsung® 4K LED TV

Bose® 900 Sound Touch Soundbar

WiFiRanger Denali/Spruce LTE (Optional)

Starlink Internet System (Optional)



*New for 2026

¹See Features & Options for all available furniture configurations

CABIN

Maple Hardwood Cabinets in Suede or High Gloss Finish

Available in Five Colors and Four Two-Tone Options
 New Chestnut Glazed Cabinet Color and Two-Tone Summit/Chestnut Option*

Soft-Close Cabinet Drawers
 Undermounted LED Lights

Tile Flooring

Electric Radiant Heat Beneath Main Floor Tile (Optional)

Fireplace** (Optional)

Power Stepwell Cover

15K BTU Heat Pump Central Air Conditioners¹

Remote Control Thermostat

10" Multiplex Monitor System with Interior Lighting and HVAC Controls

Connects via Bluetooth to the Newmar App*

*New for 2026

**Available on Floor Plan 4129 only

¹Two units on 38' and 41' models, three units on 43' and 45' models



Floor plan 4505 shown with Palisades décor and Chestnut Glazed cabinets



CABINET FINISHES





GALLEY & DINETTE

19.7 Cu. Ft. Whirlpool® Refrigerator

30" Stainless Steel Convection Microwave
Air Fryer Feature

All-Electric Flush Mount Induction Cooktop

Stainless Steel Dishwasher in a Drawer (Optional)

Large Pantry

Pullout Shelves
Push-to-Release Drawer Slides

Super-Polished Solid-Surface Countertops

Kitchen Window (Optional)

Williamsburg Sleeper Booth Dinette*

Drawers Underneath Seats

Central Vacuum with Tool Kit (Optional)



*Additional dinette configurations available; see Features & Options for details



BEDROOM

King-Size Bed with Pillow Top Mattress
Lifts on Bed Top

**Dimmable Reading Lights at
Head of Bed with Adjustable Aim**

**110V Outlet in Bed Overhead
with Two Pass-Through Ports**

Samsung® 4K LED TV

Lighted Wardrobe
Safe (Optional)

**Two-Piece Splendide®
Washer and Dryer (Optional)**



BATHROOM

Residential Shower*

- Solid-Surface Shower Walls with Tile Inlay**
- Fold-Down Shower Seat (Optional)
- Skylight Above Shower
- Glass Door

Aqua Miser® Shower System

- Chinook Dual Loop Heat
with Continuous Water

Super-Polished Solid-Surface Countertop

Linen Storage

*Shower size varies by floor plan
**New for 2026







EXTERIOR & STORAGE

**Industry-Exclusive Full-Paint Masterpiece
Finish™ with Clearcoat**
New Exterior Design with Five Color Combinations*

Artisan Series Custom Paint Process
Available on 45' Models*¹

Onyx Package* (Optional)

Entrance Door Automatic Step*

Girard® Nova Side Awnings

Wind Sensor
Remote Control
LED Lights

Keyless Entrance Door with Touchpad and Doorbell

Power Baggage Door Locks

Lights in Exterior Storage Compartments

Multiple Storage Tray Options by Floor Plan

Dometic® Freezer on Pullout Tray (Optional)

Rear Cap Storage

Standard Exterior Entertainment Center*

43" Samsung® 4K LED TV
Bose® Soundbar

*New for 2026
¹Only available on 45' floor plans



EXTERIOR

Industry-Exclusive STAR Foundation

Hydraulic Leveling Jacks

Rear Hitch for Towing

20K for 38' and 41' Floor Plans

30K for 43' and 45' Floor Plans

Exterior Shower

Four 6V AGM House Batteries

640 AHR or 960 AHR Lithium-Ion Battery System (Optional)

3000W Victron Multiplus Inverter*

12.5 kW or 8.0** kW Cummins Onan®

Diesel Quiet Series Generator

Four Flexible 120W Solar Panels on Roof (Optional)

10W Solar Panel (To Charge Chassis Battery)

**New for 2026*

***Equipped on 38' and 41' models*





DESIGN OPTIONS

INTERIOR AND EXTERIOR

BLANCO



Charcoal Tweed Awning



BRIGHTON INTERIOR



Furniture



Fabric



Fabric



Flooring



Counter Top

**Exterior colors and interior décor options can be matched to customer preference.*

HARDING



Charcoal Tweed Awning



PALISADES INTERIOR



Furniture



Fabric



Fabric



Flooring



Counter Top

LAUGHTITON



Charcoal Tweed Awning



SAGUARO INTERIOR



Furniture



Fabric



Fabric



Flooring



Counter Top

**Exterior colors and interior décor options can be matched to customer preference.*

PORTAGE



Hogan Sparrow Awning



SELDOMIA



Hogan Sparrow Awning

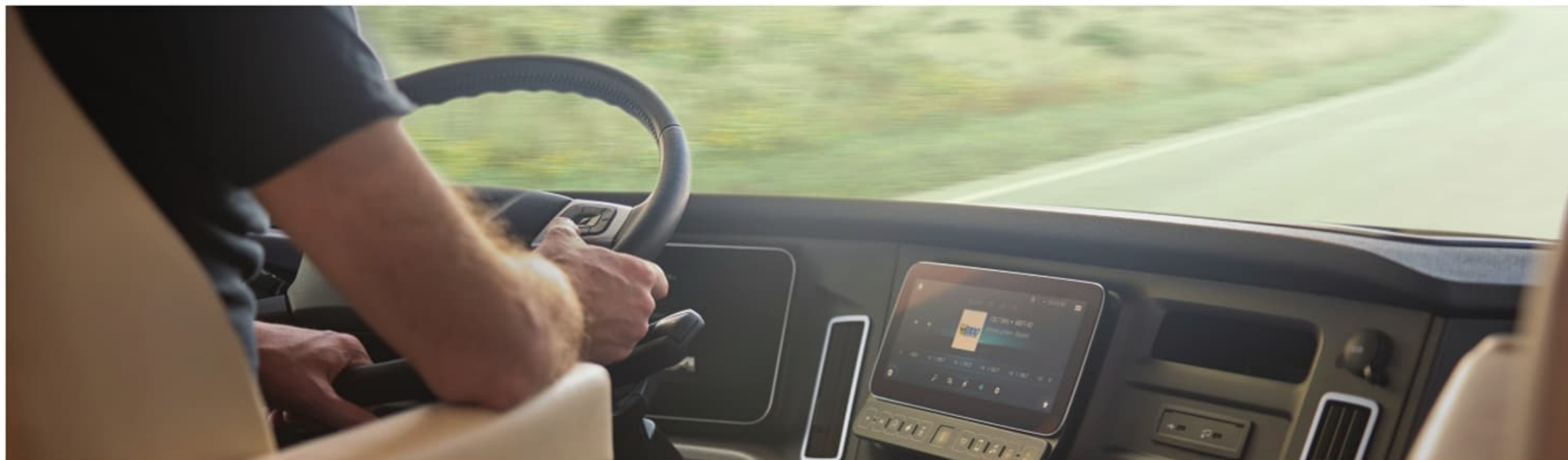

**Exterior colors and interior décor options can be matched to customer preference.*

FLOOR PLANS

AND SPECIFICATIONS



★ 3827

| | | | |
|---------------------|---------|-------------|------------|
| Length | 38' 11" | Grey Tank | 85 gal. |
| Width | 101.5" | Sewage Tank | 52 gal. |
| App. Overall Height | 13' 02" | Water Tank | 150 gal. |
| Interior Width | 95.5" | Furnace | 50,000 btu |
| Interior Height | 83" | | |

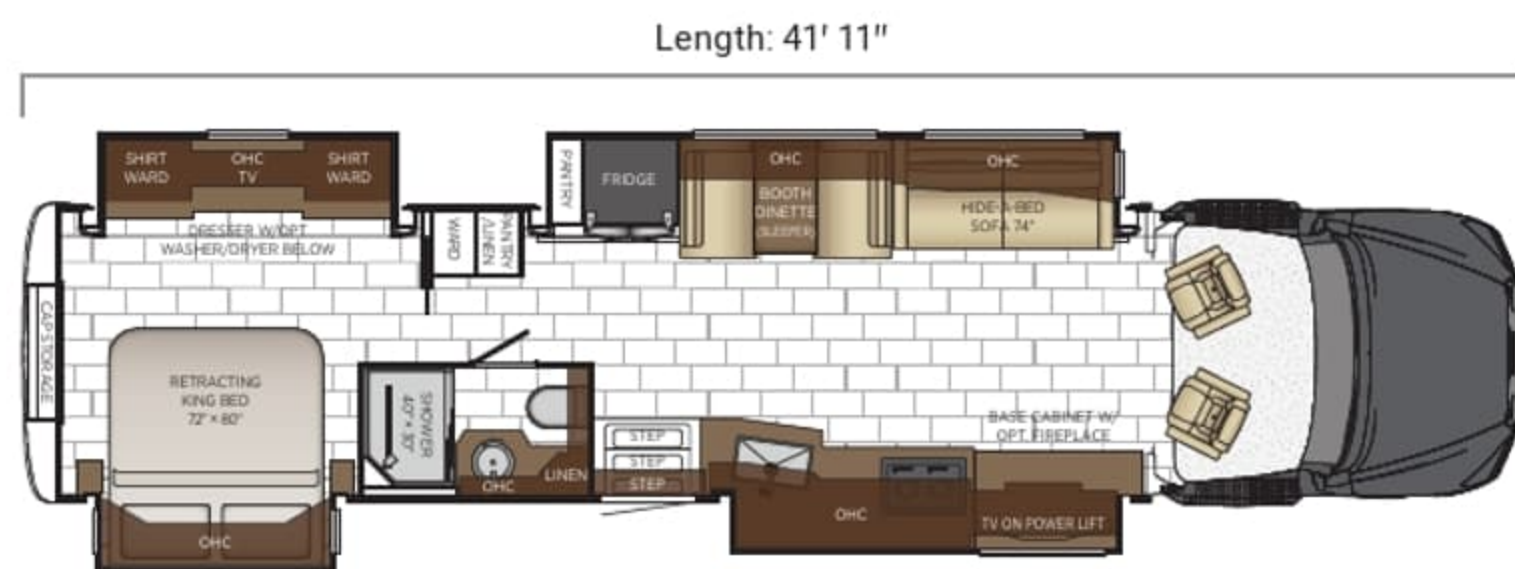

★ 4129

| | | | |
|---------------------|---------|-------------|------------|
| Length | 41' 11" | Grey Tank | 85 gal. |
| Width | 101.5" | Sewage Tank | 52 gal. |
| App. Overall Height | 13' 02" | Water Tank | 150 gal. |
| Interior Width | 95.5" | Furnace | 50,000 btu |
| Interior Height | 83" | | |

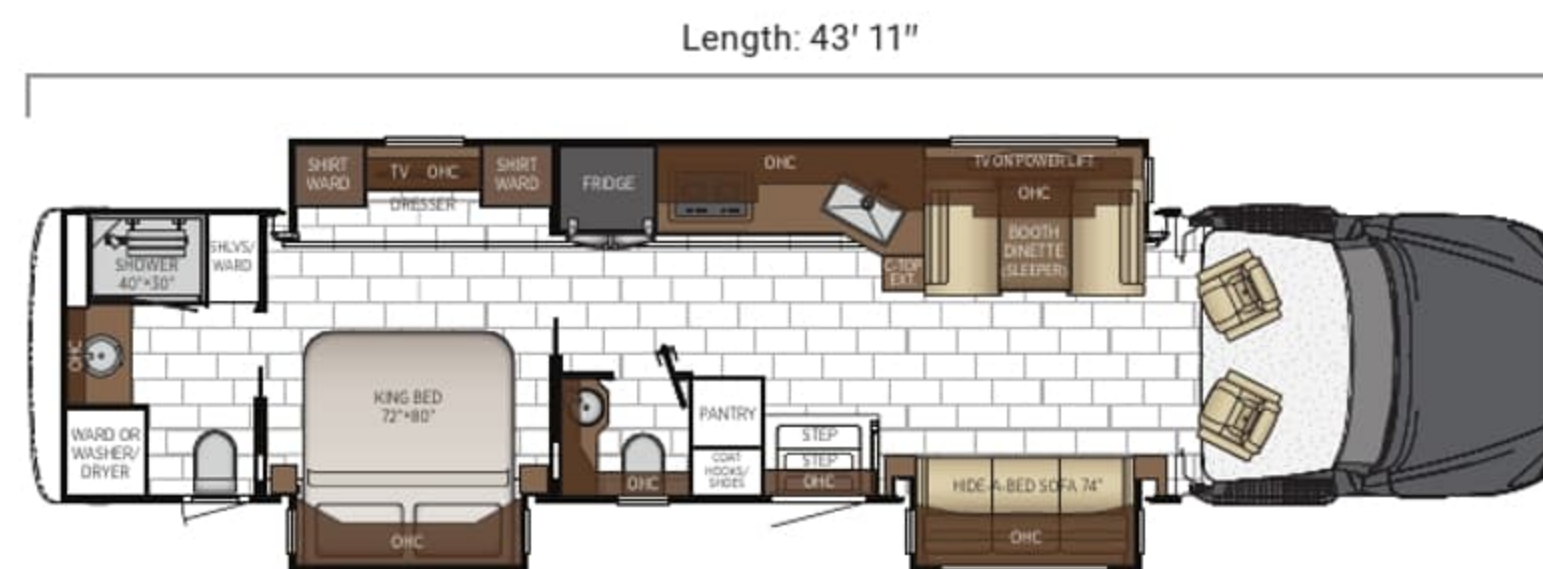

★ 4341

| | | | |
|---------------------|---------|-------------|------------|
| Length | 43' 11" | Grey Tank | 60 gal. |
| Width | 101.5" | Sewage Tank | 40 gal. |
| App. Overall Height | 13' 02" | Water Tank | 150 gal. |
| Interior Width | 95.5" | Furnace | 50,000 btu |
| Interior Height | 83" | | |

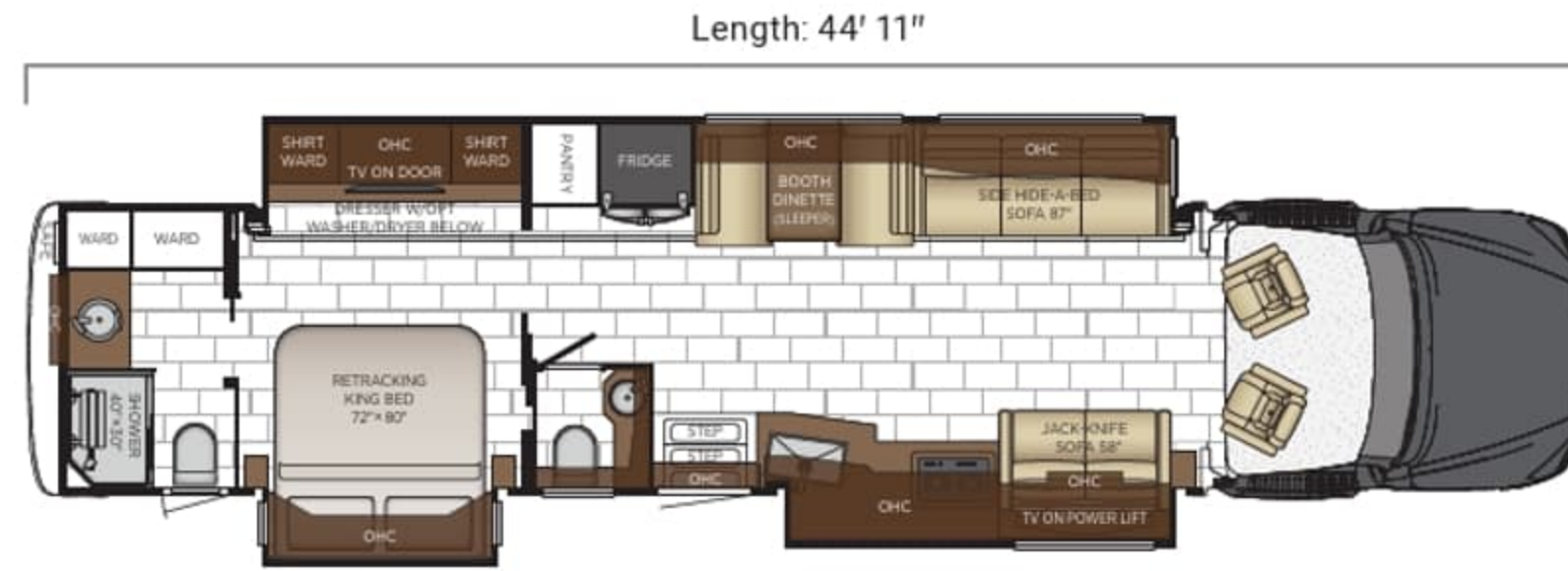

★ 4505

| | | | |
|---------------------|---------|-------------|------------|
| Length | 44' 11" | Grey Tank | 60 gal. |
| Width | 101.5" | Sewage Tank | 40 gal. |
| App. Overall Height | 13' 02" | Water Tank | 150 gal. |
| Interior Width | 95.5" | Furnace | 50,000 btu |
| Interior Height | 83" | | |

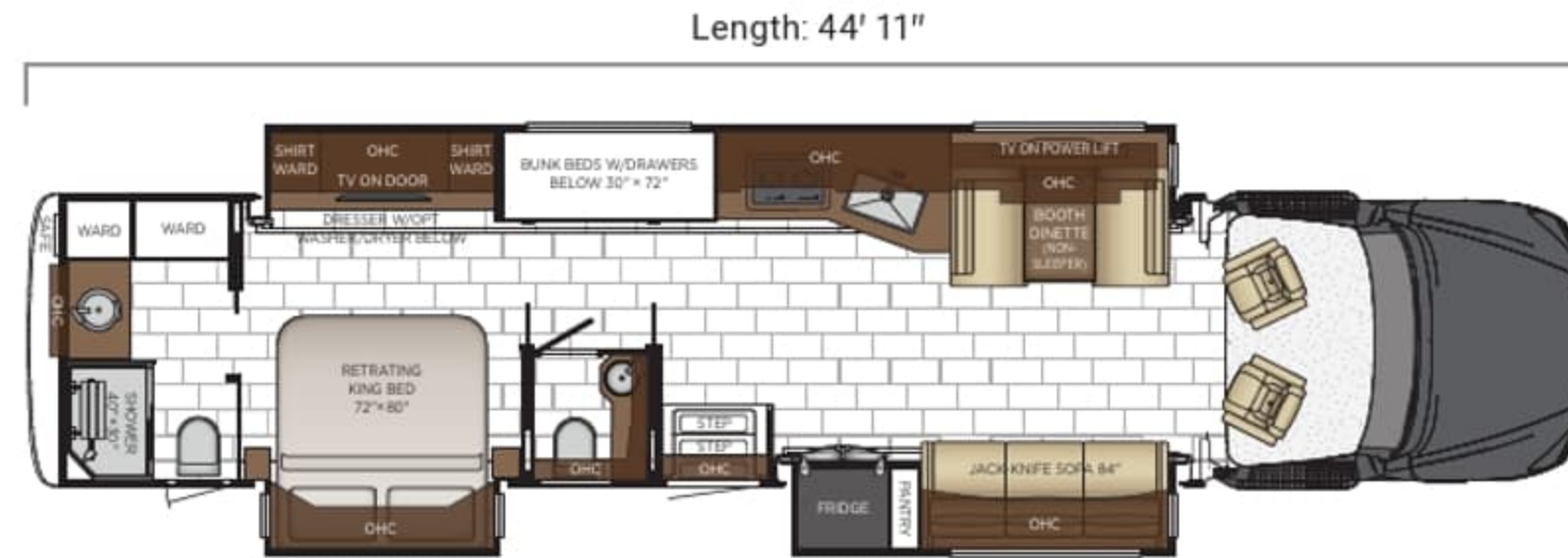

★ 4540

| | | | |
|---------------------|---------|-------------|------------|
| Length | 44' 11" | Grey Tank | 60 gal. |
| Width | 101.5" | Sewage Tank | 40 gal. |
| App. Overall Height | 13' 02" | Water Tank | 150 gal. |
| Interior Width | 95.5" | Furnace | 50,000 btu |
| Interior Height | 83" | | |

Quality You Can Feel

Like a fine home, the 2026 Supreme Aire is framed 16 inches on center, and is covered by a fiberglass roof with an integrated gutter rail.

| FREIGHTLINER® | | | | | | | | | | | |
|---------------|-----------|------------|-----------|------------|------------|-----------|-----------|-----------|-----------|-----------|-----------|
| FLOOR PLAN | ENGINE HP | AXLE RATIO | FUEL CAP. | WHEEL BASE | FRONT GAWR | REAR GAWR | TAG GAWR | GVWR | GCWR | APP. UVW | APP. NCC |
| 3827 | 525 | 3.07 | 120 | 328 | 18000 lb. | 23000 lb. | - | 41000 lb. | 61000 lb. | 35500 lb. | 5500 lb. |
| 4129 | 525 | 3.07 | 120 | 349 | 18000 lb. | 23000 lb. | - | 41000 lb. | 61000 lb. | 37000 lb. | 4000 lb. |
| 4341 | 600 | 3.08 | 120 | 302+TAG | 18000 lb. | 20000 lb. | 20000 lb. | 58000 lb. | 80000 lb. | 43000 lb. | 15000 lb. |
| 4505 | 600 | 3.08 | 100 | 310+TAG | 18000 lb. | 20000 lb. | 20000 lb. | 58000 lb. | 80000 lb. | 43500 lb. | 8500 lb. |
| 4540 | 600 | 3.08 | 120 | 310+TAG | 18000 lb. | 20000 lb. | 20000 lb. | 58000 lb. | 80000 lb. | 43500 lb. | 8500 lb. |

The content in our literature depicts and describes products that are subject to change. For the most recent images and information, please visit NewmarCorp.com.

Lengths, heights, widths, and dry weights are approximate. Weight will vary based on optional equipment added to the above base weight.

GAWR: Gross Axle Weight Rating is the maximum permissible weight for an axle.

GVWR: Gross Vehicle Weight Rating is the maximum permissible weight for a fully loaded motor coach.

GCWR: Gross Combination Weight Rating is the value specified by the manufacturer of the vehicle as the maximum allowable loaded weight of this motor coach and any towed trailer or towed vehicle.

UVW: Unloaded Vehicle Weight is the weight of this motor coach as built at the factory with full fuel, engine oil, and coolants. Does not include cargo, fresh water, propane gas, or dealer-installed accessories.

NCC: Net Carrying Capacity is the maximum weight of all occupants, including the driver, personal belongings, food, fresh water, waste water, propane gas, tools, tongue weight of towed vehicle, dealer-installed accessories, etc., that can be carried by the motor coach.

Specifications supplied by the chassis manufacturer.

Supreme Aire R-Values:

Roof R-Value = 19

Sidewall R-Value = 11

Floor R-Value = 16

Basement R-Value = 4

FEATURES

AND OPTIONS

EXTERIOR FEATURES

| |
|---|
| Exterior Full-Paint Masterpiece Finish™ with Clearcoat |
| Painted Power Baggage Door Locks, Keyless Entrance Door with Touchpad and Door Bell |
| Entrance Door Assist Handle |
| Entrance Door Automatic Step |
| Convex Exterior Mirrors with Defrost and Remote Control |
| Front Cap Beta Fusion Protection |
| Hydraulic Leveling Jacks |
| Mud Flaps |
| Power Lock on Cockpit Doors |
| Rear Cap Storage |
| Stainless Steel Exterior Trim Pieces on Rear Cap |
| Tow Guard Rear Protective with Stainless Newmar Name Cutout |
| Undercoating |

OPTIONS

| |
|--|
| Blanco Full-Painted Exterior Graphics |
| Harding Full-Painted Exterior Graphics |
| Laughton Full-Painted Exterior Graphics |
| Portage Full-Painted Exterior Graphics |
| Seldovia Full-Painted Exterior Graphics |
| Artisan Series Custom Paint Process Available on 45' Model |
| Black Aluminum Powder Coat Trim Kit For Exterior Compartment Doors, Onyx Package |
| Chrome Power Baggage Door Locks |
| Flag Pole Bracket |
| Stainless Steel Trim Kit For Exterior Compartment Doors |
| 34" x 56" Non-Power Storage Tray, Location - Bay 5 |
| 34" x 56" Non-Power Storage Tray, Location - Bay 6 |

CONSTRUCTION FEATURES

| |
|--|
| 16" On-Center Aluminum Frame Sidewalls and Roof Construction |
| Egress Door with Ladder System (Floor Plan Specific) |
| Fiberglass Roof and Integrated Gutter Rail |
| Foam Insulation 5/8" Laminated in Sidewalls and Ceiling |
| Gelcoated Fiberglass Exterior Sidewalls, Front and Rear Caps |
| Polar Pak R19 Batten Insulation in Roof |
| Slideout Automatic Lock Arms on Non Hydraulic - Paddle Style |
| HWH Flat Floor Slideout |

WINDOWS, AWNINGS, & VENTS

| |
|---|
| Bunk Windows (Floor Plan Specific) |
| Fan-Tastic® Vent with Rain Sensor in Kitchen and Bathroom |

| |
|---|
| Girard® G2000 Power Side Awning with Wind Sensor, Remote Control and LED Lights |
| Sky Window in Cockpit with Power Shade |
| Skylight Above Shower |
| Slideout Covers |
| Power Windows For Driver and Passenger |
| Frameless Double-Pane Tinted Safety-Glass Windows |

OPTIONS

| |
|---|
| Carefree® Window Awning Package of Three, One-Bedroom, One-Off Door Side Living Room, One-Door Side Living Room |
| Girard® Nova Two Side Awnings ILO Standard |
| Kitchen Window (Floor Plan Specific) |

CHASSIS FEATURES

| |
|--|
| Anti-Lock Braking System |
| Back-Up Alarm |
| Battery Disconnect For Chassis Battery |
| Cruise Control |
| D.A.S.S - Auto On/Off Headlights, Intelligent High Beams, Auto Rain Sense Wipers |
| D.A.S.S - Object Detection, Active Brake Assist, Pedestrian Detection, Adaptive Cruise Control |
| Detroit Assurance Lane Departure Warning System |
| Electronic Stability Control |
| 120 Gallon Fuel Capacity |
| 20K Rear Hitch For Towing with 2" Reducer and Drawbar with 2" and 2-5/16" Ball |
| 30K Rear Hitch For Towing Includes Draw Bar with 2-5/16" Ball |
| Remote Keyless Entry System For Cab Doors |
| Cascadia 116 Freightliner® Chassis, 525 HP, Single Axle, 38' and 41' Supreme Aire |
| Cascadia 126 Freightliner® Chassis, 600 HP, Tandem Axle, 43' and 45' Supreme Aire |
| Aluminum Wheels |

OPTIONS

| |
|---|
| Cascadia 116 Freightliner® Chassis, 525 HP, Single Axle, 38' and 41' Supreme Aire, Onyx Package |
| Cascadia 126 Freightliner® Chassis, 600 HP, Tandem Axle, 43' and 45' Supreme Aire, Onyx Package |

AIR CONDITIONING & HEATING

| |
|---|
| Two 15K BTU Air Heat Pump Conditioners with Remote Control Thermostat |
| Three 15K BTU Air Heat Pump Conditioners with Remote Control Thermostat |
| Air Conditioning Drainage System For Roof |
| Chinook Dual Loop Heat with Continuous Hot Water |
| Dash Heater and Air Conditioner |
| Wall Mounted Sensors For Heating and Air Conditioning |

OPTIONS

| |
|---|
| Electric Radiant Heat Installed Below Floor Tile |
| Electric Radiant Heat Installed Below Main Floor Tile |

ELECTRICAL FEATURES

| |
|--|
| Automatic Generator Start on Low Battery or Temperature Setting |
| Battery Disconnect Switch For House Battery |
| Cable TV Connection |
| 50 Amp Electrical Service with Flexible Cord and Automatic Transfer Switch |
| Energy Management System |
| Engine Block Heater |
| Exterior Security Light, One Installed on Door Side |
| Eight 6V AGM House Batteries |
| Interior Courtesy Lights |
| 3000W Pure Sine Inverter |
| LED Lights in Exterior Storage Compartments on Automatic Switches |
| Recessed LED Lights in Ceiling and Underneath Overhead Cabinets |
| Midship Side Turn Signals |
| Multiplex Lighting Control System |
| 10.1" Multiplex Monitor System in Center of Coach with Interior Lighting and HVAC Controls |
| Newmar App |
| 12.5 kW Cummins Onan® Diesel Generator |
| 8.0 kW Cummins Onan® Diesel Quiet Series Generator |
| Power Rewind Reel with 33' Cord (Floor Plan Specific) |
| Power Rewind Reel with 50' Cord (Floor Plan Specific) |
| Reading Lights at Head of Bed - Dimmable with Adjustable Aim |
| 110V Recept in Bed Overhead with Two Pass Through Ports |
| 110V/USB Recept at Head of Each Bunk Area (Floor Plan Specific) |
| Slideout Switch Manually Operated Hold To Run |
| 10W Solar Panel to Charge Chassis Battery |
| Solar Prep with 6 Gauge Wire Ran From Roof to House Battery Compartment (N/A with L020 Option) |
| Spare Fuses in Chassis Fuse Panel |
| Spare Fuses in House Fuse Panel |
| Transfer Switch with Surge Protector |
| USB Outlet at Dash For Driver Use |
| USB Outlet at Dinette and Bedroom Night Stand |

OPTIONS

| |
|---|
| 50 Amp/120/240V Cord Connection For Stacker Trailer |
| Exterior Security Lights, Two Door Side, Two Off Door Side, One Rear ILO Standard |
| 640 AHR Lithium Ion Battery System with Two 3000W Pure Sine Inverters |
| 960 AHR Lithium Ion Battery System with Two 3000W Pure Sine Inverters |
| Four 120W Flexible Solar Panels on Roof |

PLUMBING & BATH FEATURES

| |
|--------------------------------|
| Aqua Miser® Shower System |
| Auto Fill For Fresh Water Tank |
| Demand Water System |

| |
|---|
| Exterior Shower Located on Off Door Side |
| 150 Gallon Fresh Water Tank |
| Power Reel For Water Hose |
| Sewage Holding Tank Rinse |
| Solid-Surface Shower Walls with Glass Door |
| Dometic® 321 China Bowl or Macerator China Bowl Stool (Varies Per Floor Plan) |
| Water Filter for Entire Unit |

OPTIONS

| |
|---|
| Fold-Down Shower Seat |
| Hot Water Line Run To Front Door Side Storage Bay |

INTERIOR FEATURES

| |
|---|
| Fitted Non-Quilted Bedspread and Accent Pillows |
| Decorative Wall Art |
| Designer Feature Ceiling |
| Interior Passage Inlaid Three Panel Design Doors |
| Interior Assist Handle at Main Entry Door |
| MCD Window Shades |
| Power Stepwell Cover |
| Tile Floor in Kitchen, Bathroom, Bedroom and Living Areas |
| Wastebasket in Kitchen Base Under Sink |
| Integrated Window Blind System on Entry Door |

OPTIONS

| |
|---------------------------------|
| 900 Brighton Interior Decor |
| 910 Saguaro Interior Decor |
| 920 Palisades Interior Decor |
| Auto Motion Power Window Shades |
| Safe Located in Wardrobe |

CABINETS & FURNITURE

| |
|---|
| Sable Maple Hardwood Cabinets with Suede Finish |
| Concealed Cabinet Door Hinges |
| Extended Rotation Concealed Cabinet Door Hinges For Washer and Dryer |
| Soft-Close Cabinet Drawers |
| Cabinet Drawers with Dove Tail Sides with Self Closing Full Extension Ball Bearing Guides |
| Mesh Cell Phone Holder at Each Bunk Bed (Floor Plan Specific) |
| Flush Cooktop Cover, Matching Countertop Material |
| Super Polished Solid-Surface Countertop in Bathroom and Bedroom |
| Super Polished Solid-Surface Countertop in Kitchen, Undermount Sink and Sink Covers |
| Williamsburg Convertible Booth Dinette (Floor Plan Specific) |
| Drawers Underneath Dinette Booth Seats |
| Driver and Passenger Seat Covers To Match Interior Decor |
| Driver and Passenger Seats Air Ride with Pneumatic Lumbar and Swivel |

| |
|---|
| Lifts on Bed Top |
| Plush Pillow Top Mattress |
| Molded Silverware Divider Tray |
| Push-to-Release Pantry Drawer Slides |
| Pullout Pantry Shelves (See Floor Plans for Availability) |
| Ultrafabric Sofa and Front Seats |
| Villa Furniture |

| |
|---|
| OPTIONS |
| Chestnut Glazed Maple Hardwood Cabinets with High Gloss or Suede Finish |
| Morel Glazed Maple Hardwood Cabinets with High Gloss or Suede Finish |
| Sable Maple Hardwood Cabinets with High Gloss Finish |
| Sedona Glazed Maple Hardwood Cabinets with High Gloss or Suede Finish |
| Summit Maple Hardwood Cabinets with High Gloss or Suede Finish |
| Two-Tone Summit and Chestnut Glazed Maple Hardwood Cabinets with High Gloss or Suede Finish |
| Two-Tone Summit and Morel Glazed Maple Hardwood Cabinets with High Gloss or Suede Finish |
| Two-Tone Summit and Sable Maple Hardwood Cabinets with High Gloss or Suede Finish |
| Two-Tone Summit and Sedona Glazed Maple Hardwood Cabinets with High Gloss or Suede Finish |
| Bunk Beds To Convert To Wardrobe |
| Convertible Dinette with Two Fixed and Two Folding Chairs That Face to Window or Fore/Aft Seating |
| Euro Booth Dinette with Two Table Leaves and Two Folding Chairs |
| 48" Love Seat Sofa with TV Lift ILO of 48" Storage Cabinet with TV Lift |
| 84" Theater Seating (Powered) with Reading Lights ILO Jackknife on Door Side |
| 87" Theater Seating (Powered) with Reading Lights ILO Side Hide-A-Bed Sofa on Off Door Side, 58" Trifold Sofa ILO Jackknife Sofa on Door Side |
| 74" Theatre Seating (Powered) ILO Standard Sofa on Door Side, 35" Booth Dinette ILO 38" Booth Dinette on Off Door Side |
| 74" Theatre Seating (Powered) ILO Standard Sofa on Door Side, 35" Euro Dinette ILO 38" Booth Dinette on Off Door Side |
| 74" Theatre Seating (Powered) with Reading Lights and Lighted Cup Holders ILO Hide-A-Bed Sofa (Replaces Only Sofa) |

APPLIANCES & ACCESSORIES

| |
|---|
| Air Horns |
| All-Electric Flush Mount Induction Cooktop |
| 110V Heat Pads For Holding Tanks |
| 30" Stainless Steel Microwave Convection with Air Fryer Feature |
| 19.7 Cu. Ft. Whirlpool® Refrigerator |
| Washer and Dryer Prep |
| OPTIONS |
| Central Vacuum with Tool Kit |
| Dishwasher in A Drawer with Stainless Steel Front Located Below Cooktop |
| Fireplace in Living Area |

| |
|---|
| Freezer Electrical Prep (110V and 12V) Without Tray |
| Freezer on Pullout Tray in Exterior Compartment |
| Stacked Two-Piece Splendide® Washer and Dryer |

AUDIO, VIDEO & ACCESSORIES

| |
|--|
| Cat6 TV Cables |
| CB Prep with Antenna |
| Digital Dash Displays with 12" A-Panel Cluster and 10" B-Panel Infotainment with Xite Cam Monitor and Apple CarPlay® |
| Exterior Entertainment Center with 43" Samsung® 4K LED TV and Soundbar |
| 10 BC Fire Extinguisher, Carbon Monoxide, Smoke Detectors |
| High Definition Component Wiring |
| Rear View Color Monitor System with Audio |
| Satellite Dish Prep on Roof |
| Bose® Sound System Soundbar |
| TV Jack and 110V Recept in Door Side Exterior Storage Compartment |
| 50" Samsung® 4K LED TV on Televator in Living Area |
| Samsung® 4K LED TVs in Living and Bedroom Areas (TV Sizes Vary Per Floor Plan) |
| Winegard® Rayzar Automatic Digital TV Antenna |
| Xite HD 360 Camera System with Grid Lines and Tri-View Rear Camera |

| |
|---|
| OPTIONS |
| Two Camera Rear Prep For Use with Stacker Trailer |
| SiriusXM® Radio Capability with Antenna (Does Not Include Monthly Subscription) |
| Satellite Prep Ground Tripod Dish on Off Door Side with A/B Switch |
| Starlink Internet System |
| Two 19" Skyworth TV/DVD Monitors - One at Each Standard Bunk (Floor Plan Specific) |
| Universal Remote Control |
| Universal Toll Module |
| WiFiRanger Denali/Spruce LTE |
| WiFiRanger Everest with Aspen Interior Router |
| Winegard® Automatic Open Face SWM Satellite Dish - For DIRECTV® Standard/HD and In Motion DIRECTV® Standard with Auto Stow and Dash Indicator |
| Winegard® Automatic Open Face Satellite Dish and Winegard® In Motion - for DISH® with Auto Stow and Dash Indicator |
| Winegard® Automatic Open Face Satellite Dish - For DISH® HD and Bell HD TV SK2-100 with Auto Stow and Dash Indicator |
| Winegard® Automatic Open Face SWM Satellite Dish - For DIRECTV® Standard/HD SK2-300 with Auto Stow and Dash Indicator |
| Winegard® In Motion Dome Satellite Dish - For DISH® Standard/HD, DIRECTV® Standard and Bell Canada (RTL-20B) |

*Check with dealership on floor plan availability

THE NEWMAR CUSTOMER EXPERIENCE

The Newmar Difference™ goes beyond our industry-leading motor coaches to provide you with an unrivaled ownership experience.



Crafted with Purpose

Every Newmar is crafted one at a time by folks who have spent an average of eight years building them. Each coach we assemble must undergo more than 1,000 tests and checks before ever leaving our factory.



The Highest Standards

We view our dealership network in terms of quality, not quantity. Each of our dealers acts as a partner in our shared mission to exceed your highest of expectations, for an ownership experience that's second to none from day one.



Built Around You

As a Newmar owner, you'll find resources specific to your coach through Newgle, an easy-to-use knowledge base that houses everything from user guides to technical support documents.



More than a Number

Meet fellow owners through the Newmar Kountry Klub, a top social club for RV travelers that hosts rallies and other special events throughout the U.S. and Canada.



Seamless Service

When you join the Newmar family, we pair you with a dedicated service specialist with expert knowledge of your exact coach. Our service specialists guarantee dealer warranty authorizations within four business hours and ship all in-stock parts the same day, free of charge.



Without Compromise

All models include a one-year/unlimited mileage limited warranty and a five-year, non-transferable structural warranty that covers your coach's superstructure in the event it fails to perform. Ask your Newmar dealer for more details.

OUR PARTNERS

The Newmar Difference™ begins with suppliers dedicated to providing our customers with unrivaled quality, comfort, and support.



We create chemistry

BASF

The Coatings division of BASF is a global expert in the development and production of innovative and sustainable OEM and refinish coatings. Coatings by BASF—solutions beyond your imagination.



Industrial Finishes

Industrial Finishes has supported RV manufacturers for over four decades, offering paint products that deliver uncompromising quality and provide your coach with a true Masterpiece™ finish.



Driven By You

Freightliner® Custom Chassis

Freightliner® Custom Chassis are renowned for their exceptional ride, excellent maneuverability, advanced technology, and nationwide 24/7 factory-direct support.



RiverPark

From Samsung® 4K TVs and Xite Infotainment systems to Bose® soundbars and JBL and Infinity premium audio systems, RiverPark helps you experience a higher level of technology in your Newmar coach.



RV CHASSIS

Spartan® RV Chassis

An American company with over 30 years of experience in designing and manufacturing the premier motorhome chassis, Spartan® delivers superior performance, exceptional safety ratings, and industry-leading technology.



WHEN YOU KNOW THE DIFFERENCE™